



LOS ANGELES
**MISSION
COLLEGE**

Schedule of Classes **SUMMER 2007**

CONNECT WITH

YOUR FUTURE

A

Session begins
JUNE 11

B

Session begins
JULY 16



Dear Mission College Students:

Your college has made some major changes for the better since last summer. You made us aware of a number of problems and we have done our best to address those concerns. Thanks to your input, our registration system has been streamlined to allow you to enroll in more of the classes that you need to graduate or transfer. In addition, for this summer we have scheduled more of the classes that you requested. We hope that you will take this opportunity to perhaps add a class to your academic workload. Finally, our student services offices are here to assist you in being able to reach your educational goals. You will see many individuals on campus wearing ASK ME T-shirts. Don't be shy. Whatever problem you may encounter, these dedicated staff members are here to help.

During the summer, you will also notice that the face of LAMC will be changing. You can now park in our new parking structure and enjoy easy access to your classes. For those of you with children, our new Child Development Center is under construction. We are in the planning stages of building our new Health, Physical Education and Fitness Center just down the street from the main campus. Several other projects are in the planning stages, all of which are aimed at providing you with the best facilities for your classroom experiences.

Summer session at Mission College brings many first-time college students and university students who are here to take advantage of our excellent faculty and low tuition costs. For those in these groups, welcome! Our community college opens its doors to everyone. Even though you may be new to the higher education scene, or may be here only for a short time, please take the time to sample everything that we have to offer.

Our motto is OUR MISSION IS YOUR SUCCESS. I like to tell students that Mission College is YOUR GATEWAY TO THE FUTURE. For more than three decades, our graduates used Mission as a gateway to higher education and success in business, film, politics, culinary arts, vocational training and education. The summer is a time to advance your individual goals with our assistance. I believe that you have made a wise decision to join us. Together we can use the gateway of Mission College as your personal stepping stone to a successful future.

Sincerely,

*Ernest H. Moreno,
President*



Summer 2007 Calendar 2

Admissions and Enrollment Information 3

Student Telephone Enrollment Program (STEP) 4

California Non-Resident Tuition Exemption Request..... 9

How to Read the Schedule of Classes 10

Prerequisites, Corequisites and Advisories 11

ESL Program at Mission College 12

(Programa de Ingles Como Segundo Idioma)..... 12

Community Extension Programs 12

Financial Aid 13

SESSION A..... 14

Online Classes - Session A..... 31

PACE 33

ITV - The Weekend College 34

SESSION B 35

Online Classes - Session B..... 45

General Policies..... 47

Health Fee Information 54

Student I.D. 54

Student Services..... 55

Campus Map..... 57

Buildings and Classrooms 58

Directions to Mission College and Outreach Locations..... 60

Emergency Information..... 61

CALENDAR

Registration Dates

The following dates apply to all three Summer 2007 Sessions

EOPS & DSPS telephone registration appointments	April 16 to 21
Continuing students telephone registration appointments	April 23
New and re-entering students telephone registration start.....	April 28
Walk-in registration.....	May 29

Session “A” (5 weeks)

K to 8 student deadline	May 25
Classes begin	June 11
Last day for refund.....	June 14
Last day to add	June 14
Last day to drop without a “W”	June 20
Holiday.....	July 4
Last day to drop with a “W”	July 5
Final Exam	Last day of class
Session Ends.....	July 13

Session “B” (5 weeks)

K to 8 student deadline	June 29
Classes begin	July 16
Last day for refund.....	July 19
Last day to add	July 19
Last day to drop without a “W”	July 25
Last day to drop with a “W”	August 9
Final Exam	Last day of class
Session Ends.....	August 17

PACE 9 Week Summer Session

K to 8 student deadline	May 25
Classes begin	June 11
Last day for a refund	June 17
Last day to add	June 22
Last day to drop without a “W”	June 29
Last day to drop with a “W”	July 28
Final Exam	Last day of class
Session Ends.....	August 10

On-Line Registration..... www.lamission.edu/registration.html

Telephone Registration

818.988.2222
213.689.8888
310.605.0505
323.226.1999

Applications for Admission..... Year Round
 Assessment and Orientation

Enrollment fees are now only \$20 per unit for ALL California residents*



Now you can pay registration with your credit card.

*Fees subject to change by the California Legislature.

Administration & Enrollment Information

Who Can Attend Los Angeles Mission College?

LAMC has an open door admissions policy for students who:

- are 18 years of age or over, or
- have completed high school, or
- are under 18 years of age and have their parents' and high school principal's permission to attend.

Apply at the Admission & Records Office if you...

- are a new student. Complete an application form. Bring proof of your social security number. If you do not have a social security number, we will issue a student ID number.
- did not attend LAMC last semester. Complete an application form. Bring proof of your social security number.

Enroll in Classes

After you complete the college application process, you can conveniently enroll by phone by following the STEP program on the next pages. You can also enroll in person at the Admissions & Records office on campus.

Assessment & Orientation

Upon submitting an application to the college, all new non-exempt (see Matriculation Steps to Success for matriculation exemptions) students are required to go through the assessment process. The results from the assessment process will help place students into the appropriate level of English or ESL & Math courses for their first semester.

All new students are encouraged to participate in orientation. Students will learn about the college, educational programs, services, degree requirements and more.

For more detailed information please consult the current college catalog which is available in the College Bookstore and on the college's official website, www.lamission.edu



Student Telephone Enrollment Program (STEP)

All Los Angeles Mission College students can now enroll by telephone.

Continuing students' appointments to enroll were mailed to their home of record in mid-April. This is a priority registration date based on the number of units you have completed at Mission College. You may enroll by telephone anytime after your appointment until one day prior to the start of classes.

New students will receive their priority telephone enrollment appointments when they complete Assessment testing and Advisement counseling.

Before Registering by Phone:

- clear any holds or find out what type of holds, or financial obligations in the LA Community Colleges. Contact the Business Office (818.364.7783).
- contact the Counseling Office (818.364.7655) for help in planning your program.
- contact the Financial Aid Office (818.364.7648) if you need fee assistance.

The registration system will enforce all English, Math, and ESL prerequisites. Students will only be permitted to enroll in courses for which they are eligible. If, after registering, you feel the system has made an error, please bring your permit of proof of eligibility to a counselor.

To Enroll by Phone:

- Carefully read these instructions.
- Complete the attached worksheet with both your first and second choices of classes.
- Call the STEP system using a touch-tone telephone at the date and time of your enrollment appointment or anytime after your appointment until one day prior to start of classes.

STEP System Hours:

Monday through Saturday from 8:00 am to 11:00 pm

STEP Telephone Numbers:

818.988.2222
213.689.8888
310.605.0505
323.226.1999

STEP Ahora también en Español! STEP is now in Spanish.

El sistema para inscribirse por teléfono ahora también es en español.

TRANSFER CENTER

818/364-7827 • www.lamission.edu/counseling/transfercenter

Lower-Level Campus Center #1518



GET ON TRACK
TO TRANSFER!

GO to the four-year, college/university of your choice!

Fill in all of this information BEFORE calling to make the best use of your telephone enrollment call. (Form continues on next 3 pages.)

STEP ITEM DIRECTIONS

1. **College selection:** Press **4** for Mission.

2. **Semester:** Press **1** for Spring.

3. **Student ID Number:** Enter your Student ID number.
 -

4. **PIN**
 (Personal Identification Number) This is the month and date of your birth.
 (Example: If your birthday is March 5, press 0 3 0 5;
 if your birthday is October 25, press 1 0 2 5)

5. **Enroll for classes:** Press **1**

6. **Major code:** Enter your 6-digit major code without the decimal point.

0502.00	Accounting	0901.00	Engineering/Transfer	0509.50	Marketing
2104.40	Addiction Studies	0924.00	Engineering	1305.00	Marriage and Family Life Studies
2105.00	Administration of Justice	0924.01	Engineering Assistant	1701.00	Mathematics
9922.02	Anthropology (Transfer)	0953.00	Engineering CADD and CAM (Manufacturing)	0701.02	Microcomputer Applications Management
1002.00	Art	1501.00	English	0701.03	Microcomputer Programming
1306.10	Bilingual Food Service Technology	1305.14	Family Child Care Provider	1099.00	Multimedia
1305.15	Bilingual/Bicultural Pre School	1303.10	Fashion Design	9910.04	Music (Transfer)
9904.00	Biological Sciences (Transfer)	0504.00	Finance	0514.01	Office Assistant
0501.00	Business Administration	1306.12	Food Management Production Services and Related Techniques	1002.10	Painting and Drawing
0506.00	Business Management	1306.00	Foods and Nutrition	1509.00	Philosophy
1305.13	Child Care - School-Age	9922.06	Geography (Transfer)	1011.00	Photography
1305.10	Child Development	1305.30	Gerontology	1901.00	Physical Science
1305.11	Child Development - Infant/Toddler	1260.00	Health Sciences	9922.07	Political Science (Transfer)
1305.12	Child Development - Pre-School	9922.05	History (Transfer)	2105.20	Probation Officer Candidate
0701.00	Computer Science	4903.00	Humanities	1303.11	Professional Custom Clothier
0701.01	Computer Science - Business Emphasis	4901.00	Interdisciplinary Studies	2001.00	Psychology
0514.00	Computer and Office Applications	1302.00	Interior Design	2105.30	Security Systems Specialist
1304.00	Consumer Education and Management	1009.10	Jewelry	0506.01	Small Business Management
1306.11	Culinary Arts/Food Services Management	9914.00	Law (Transfer)	1105.00	Spanish
9922.04	Economics (Transfer)	2105.50	Law Enforcement Academy	9928.08	Sociology (Transfer)
9908.00	Education (Liberal Studies Transfer)	2105.51	Law Enforcement Officer Candidate	2107.50	Teacher's Assistant
		1402.00	Legal Assisting (Paralegal)	2107.51	Teacher's Assistant - Bilingual/Bicultural
		9949.01	Liberal Arts (Transfer)	0809.00	Teacher's Assistant - Exceptional Children
				0003.00	Undecided

7. **Hours worked:** Enter the number of paid hours per week you will be working this semester followed by the pound # sign. If you are working 4 hours each week press **0 4**; if you are working 40 hours each week, press **4 0**. The # sign is located on the lower right hand key of your telephone pad.



STUDENT ENROLLMENT SCHEDULE WORKSHEET

Schedule				Alternate			
Sec. No.	Course Name	Time/Days	Units	Sec. No.	Course Name	Time/Days	Units

STEP	ITEM	DIRECTIONS
------	------	------------

8. Add classes: Press **1** to add classes.

If a class you select is full and you choose to be placed on standby, you will not be enrolled in the class and you will not be charged for the class. Your standby status will be printed on your Registration/Fee receipt. The class instructor will receive a printout of the standby list prior to the first class meeting. Names are placed on that list in the order of registration. Attend the first class meeting. Instructors will issue Add Permits to students on the standby list as space in the class permits.

Before adding classes, fill out the Student Enrollment Schedule Worksheet (above) with your first choice and second choice of classes. This will help you through the enrollment procedure. Follow the directions for enrolling in classes. Choose your classes from the Schedule of Classes and enter the correct 4-digit section number. Listen carefully to the messages after each selection. If you enroll for any of the English or mathematics courses that require prerequisites, your enrollment will be blocked if you have not completed the prerequisites.

If you have questions concerning prerequisites call 818.364.7868.

9. Press **#** when you are finished adding classes.

10. Press **3** to review your program.

11. Press **9** to review fees. Do not hang up.



DETERMINING YOUR RESIDENCY STATUS

For enrollment fee purposes you are considered a RESIDENT of the state of California if you are:

1. a citizen of the United States **OR** have permanent resident status, are a holder of an asylum or refugee visa, **AND**
2. have lived in the state of California for at least one year and one day.

For enrollment fee purposes you are considered a NON-RESIDENT of the state of California if you are:

1. a citizen of the United States **OR** have permanent resident status, are a holder of an asylum or refugee visa, **AND**
2. have NOT lived in the state of California for at least one year and one day.

For enrollment fee purposes you are considered an international student if you hold an F-1 Visa or other non-resident visa.

auditing a course...enables you to attend class but not receive a grade or credit. The enrollment fee for auditing a class is \$15 per unit. Be sure to see a counselor because there are certain restrictions on auditing.

12. FEE CARD

Name _____

Student ID No: -

Enrollment Fee: \$20 per unit per semester* (all students pay this fee) units x \$20* =

Non-resident Tuition†* (see definition on page 6) units x \$154* =

International student tuition* (see definition on page 6) units x \$164* =
Additional \$25 Report Fee due once per semester.

Health Fee (see information on page 77) \$8.00 per semester =

Student Representation Fee: \$1.00 per semester =

Optional Fees:

Associated Student Organization Membership** \$3.00 per semester =

Parking Fee*** (FREE for Summer 2007) \$0 per semester =

TOTAL (Pay this amount) =

Attention Board of Governors Fee Waiver Students:

Beginning Fall 2006, all students will be charged the health fee (\$11 for Fall and Spring and \$8 for Summer and Winter). This fee will no longer be waived for students who are eligible for a waiver. Please feel free to contact the Financial Aid Office on extension 2412 if you have any questions. Students are required to pay for classes enrolled in beyond the refund deadline.

***ALL FEES ARE SUBJECT TO CHANGE BY THE CALIFORNIA LEGISLATURE.**

**The Associated Student Organization represents students and supports college programs including extended library hours, tutoring, and college activities such as cultural events and commencement.

A parking permit is required to park in campus, including Saturdays. All parking is on a space available basis.

***There are no student parking fees in 2006-07 but you must still obtain a parking permit.

† **Non-resident tuition is due upon registration. Students who have not paid all non-resident tuition will be dropped from all classes on the Friday of the fourth week of the semester.**

STEP ITEM DIRECTIONS

13. Payment: Press **1** if you **WILL pay by credit card**. Pay your fees by credit card over the phone and avoid lines at the Business Office. If you choose to pay now by credit card, your semester Registration/Fee Receipt, ID verification sticker, and parking permit (if purchased) will be mailed to you.

14. Credit Card Payment: If you are paying by credit card, enter the card type and number.

American Express VISA Discover Mastercard

Card No:

Expiration Date:

15. Other payment: Press **2** if you **WILL NOT pay by credit card**.
If you are not paying by credit card, you may pay in person at the Business Office or by mail to:
LOS ANGELES MISSION COLLEGE BUSINESS OFFICE • 13356 ELDRIDGE AVENUE • SYLMAR, CA 91342
Send **FEE CARD** (#12) with a check or money order. **Do not send cash**. Print your Student ID number and semester on the face of your check. Your semester fee receipt, student ID validation, and parking permit (if purchased) will be mailed to you when payment is complete.



STEP	ITEM	DIRECTIONS
16.	Program Changes:	You may change your program by telephone or through the STEP and Web system anytime after you enroll through one day prior to the start of classes. You may also change your program in-person in the Admissions & Records Office.
17.	Dropping Classes:	It is your responsibility to drop any classes you stop attending. Do not rely on the instructor to exclude you. You will be liable for all enrollment fees, health fees, and non-resident tuition for any class not dropped by the <u>third day of the session</u> . You can use the STEP and web system at https://eweb2.laccd.edu to drop classes through the 4th week.
18.	ATTENTION! It is the student's responsibility to meet the prerequisites for all courses. Students who fail to do so may be dropped from the class.	

Dropping a Course & Enrollment Fee Refund

If you want to drop a course in which you have enrolled you must complete an official drop card available in the Admissions & Records Office. **It is your responsibility to do this. FEES ARE DUE AT TIME OF ENROLLMENT.** (You may also drop a class by telephone – using the STEP system and through the web system at <https://eweb2.laccd.edu>.)

The date you drop a course determines whether you will receive a refund of your enrollment fee. Normally, the last day to request a refund of your enrollment fee for full-term classes is the Friday of the second week of the semester. **Exceptions are PACE classes and other short-term classes.** Please check the calendar for the official date(s).

TO OBTAIN A REFUND:

- Drop the course by the deadline at the Admissions & Records Office, (may also be done by through the STEP system)
- **Request refund at Business Office (refunds are not automatically issued).**
- If you paid your fees by **CHECK**, a refund check will be issued.
- If you paid your fees by **CREDIT CARD**, the refund will be credited to your credit card.
- If you paid by **CASH**, refunds up to \$100 will be made in cash; if your refund is more than \$100 a refund check will be issued.

BOARD OF GOVERNORS FEE WAIVER PROGRAM – BOGFW-B

Do you need assistance paying for enrollment fees?

The Board of Governors Fee Waiver Program (commonly referred to as BOGG) is a California state program that waives enrollment fees. This waiver does not have to be repaid.

Eligibility: Students must be residents of California, and they must receive state assistance or meet minimum income standards or demonstrate financial need as determined by the federal financial aid application (FAFSA).

How to apply: Fill out the Free Application for Federal Student Aid (FAFSA) form available in the Financial Aid Office or fill out the online application at www.fafsa.ed.gov

NEW! Effective Fall 2006 semester, the Health Fee will not be waived for all Fee Waiver eligible students.

Note: Audited classes are not covered by the Board of Governor's Fee Waiver Program. Students are solely responsible for payment of enrollment fees for audited classes. No exception to this policy can be made.

California Non-Resident Tuition Exemption Request For Eligible California High School Graduates

Complete and sign the form to request an exemption from Non-resident Tuition. You must submit any documentation required by the College or University (for example, proof of high school attendance in California). Contact the California Community College, University of California or California State University campus where you intend to enroll (or are enrolled) for instructions on documentation, additional procedures and applicable deadlines.

ELIGIBILITY:

I, the undersigned, am applying for a California Non-Resident Tuition Exemption for eligible California high school graduates at (specify college or university) _____ and I declare the following:

Check YES or NO boxes:

- YES NO I have graduated from a California high school or have attained the equivalent thereof, such as a High School Equivalency Certificate, issued by the California State GED Office or a Certificate of Proficiency, resulting from the California High School Proficiency Examination.
- YES NO I have attended high school in California for three or more years.

Provide information on all school(s) you attended in grades 9-12:

SCHOOL	CITY	STATE	DATES FROM - Month/Year TO - Month/Year

Documentation of high school attendance and graduation (or its equivalent) is required by the University of California, the California State University and some California Community Colleges. Follow campus directions.

Check the box that applies to you (check only one box):

- I am a non-immigrant alien as defined by federal law (including, but not limited to, a foreign student [F visa] or exchange visitor [J visa]).
- I am NOT a non-immigrant alien (including, but not limited to, a U.S. citizen, permanent resident, or an alien with out lawful immigration status).

AFFIDAVIT:

I, the undersigned, declare under penalty of perjury under the laws of the State of California that information I have provided on this form is true and accurate. I understand that this information will be used to determine my eligibility for the non-resident tuition exemption for eligible California high school graduates. I hereby declare that, if I am an alien without lawful immigration status, I have filed an application to legalize my immigration status or will file an application as soon as I am eligible to do so. I further understand that if any of the above information is untrue, I will be liable for payment of all non-resident charges from which I was exempted and may be subject to disciplinary action by the College or University.

Print Full Name (as it appears on your campus student records)	Campus/Student Identification Number
Print Full Mailing Address (number, street, city, state, zip code)	Email address (optional)
	Phone number (optional)
Signature	Date

How to Read the Schedule of Classes

Classes are listed in alphabetical order from Administration of Justice to Supervised Learning Assistance. Check Real Time Schedule on the Web.

BUSINESS - ACCOUNTING

Business & Law

Course Number	Course Name	Transferability	Units
001	INTRODUCTORY ACCOUNTING 1	(UC:CSU)	5 UNITS
Prerequisite: None.			
All sections may be taken for honors credit.			
0125	10:40-1:10 MW	Bommer, T	INST-2006
0126	10:40-1:10 TTh	Bommer, T	INST-2006
EVENING CLASSES			
3149	4:20-6:50 MW	Bommer, T	INST-2006
3150	7:00-9:50 MW	Brashear, C	INST-2006
3151	7:00-9:50 TTh	Ordonez, R	CSB-206
	Section No. Time & Day(s)	Instructor	Building Room

Bold print indicates
Classes that begin at
3:30 pm or later

015 TAX ACCOUNTING (CSU) - 3 UNITS

Italics indicates
Saturday Classes

Short-Term Classes

<i>0128</i>	<i>9:00-5:30 S</i>	<i>Staff</i>	<i>INST-1013</i>
(8 Week Class - Starts 11/02/2004, Ends 12/21/2004)			

BUILDING KEY

BUNG: Annex Building (student parking lot)

CAC: Cultural Arts Center, 1300 Sayre St.
top of hill)

CMPC: Campus Center Building (college campus)

CSB: Collaborative Studies Building,
Northeast section of campus

FOOT: Physical Education Building,
12843 Foothill Blvd., Suite B

INST: Instructional Building (college campus)

LRC: Library Building (college campus)

Prerequisites, Corequisites and Advisories

Prerequisite: A requirement that must be satisfied before enrolling in the target course.

Corequisite: A requirement that must be taken simultaneously with the target course. However, in some instances the corequisite may be satisfied before enrolling into the target course.

Advisory: A course or condition that a student is advised (but not required) to meet prior to enrolling in the target course.

Registration Limitation

All students need to demonstrate meeting the prerequisite or corequisite requirement in order to enroll into the target course.

- If the student satisfies the requirement by completing a class with a grade of "C" or better at LAMC or through the assessment process, he/she will be cleared for registering into the target course.

- If the student has satisfied the prerequisite or corequisite and/or placement at another college or through another method, he/she must submit the appropriate documentation (i.e. an unofficial transcript and/or placement results) to the counseling office located in the Instructional and Student Services Building (818.364.7655).

Once a counselor reviews the documents and finds that the prerequisite or corequisite has been satisfied, the counselor will issue a course placement authorization form. This form, once signed by the counselor, needs to be turned into the Admissions office along with the necessary add slip by the student for processing.

Prerequisite Challenge

Students without transcripts or other proof of meeting the specified prerequisite or corequisite but believe that they have other clear and reliable evidence that they are adequately prepared to take the target course may go through the prerequisite or corequisite challenge process.

Prerequisite or Corequisite may be challenged based on the following:

1. The student has the knowledge or ability to succeed in the target course despite not meeting the prerequisite or corequisite. (Criteria for challenging based on knowledge or ability to succeed will be determined by each Academic Department.);
2. The prerequisite or corequisite is not valid because it has not been established in accordance with the District's policy;
3. The prerequisite or corequisite is being applied in an unlawfully discriminatory manner; and

4. The prerequisite or corequisite has not been made reasonably available causing the student undue delay in completing his/her educational goal.

Prerequisite Challenge Process

1. Pick up the challenge form at the Counseling Office. It is recommended that a student seeking to go through the challenge process meet with a counselor to discuss the process in further detail.

2. All challenge forms must be processed prior to the add deadline as stated in the Schedule of Classes (please note: the challenge process takes five working days to complete). Challenges filed after this deadline will be considered for the following semester. If space is available in a course when a student files a challenge to the prerequisite or corequisite, the student will be allowed to enroll into the course during the challenge process. If the challenge is approved or the college fails to resolve the challenge within 5 working days, the student shall be allowed to remain in the course. If the challenge is denied, the student will be notified and dropped administratively. If no space is available in the course when a challenge is filed and approved, the student shall be permitted to enroll for the following semester.

3. Students need to complete the challenge form, attach appropriate documentation and take the form to the Chair and/or Vice Chair of the department through which the course in question is being offered.

4. The Department Chair and/or Vice Chair will approve or deny the challenge. If the Chair and/or Vice Chair is the instructor of the course that the student wishes to enter, then the Chair and/or Vice Chair will identify another faculty member in the discipline to review and approve the challenge form.

- Once the challenge is approved/denied and signed, the Chair and/or Vice Chair of the department or designated faculty member will return the form to the Matriculation Coordinator.

- The Matriculation Coordinator will contact the student of the results of the challenge.

- If the challenge is approved, the student will be given a course placement authorization that the student will take to Admissions along with the necessary add form for processing.

5. If the challenge is denied, the student may appeal the decision to the Vice President of Academic Affairs. Notification of the appeal decision will be sent to the student within 5 working days after its receipt.

ESL Program at Mission College

Levels and Classes:

The ESL program at Mission College is very comprehensive. It has six levels, twelve units each. It is the philosophy of the department not to teach language skills in isolation, consequently some classes are combined. Students receive maximum benefit from taking all classes of each level concurrently.

Level 1: ESL 1 integrated (combined skills) -12 units

Level 2: ESL 2 integrated (combined skills) -12 units

Levels 3,4,5,6 have two segments:

1. A - Writing/Grammar - 6 units
2. B - Reading/Vocabulary - 3 units
C - Listening/Speaking - 3 units

Assessment - Which Level Should I Take?

Students must go through the assessment process which will show what level they should enroll in. All colleges use different systems, so students cannot rely on class levels from another college or adult school to choose the correct class. It will probably be different at Mission College.

After attending classes, students who believe they are in the wrong level should confer with their instructor. That is the person who can best judge the appropriateness of the level.

For information call: 818.364.7735

Programa de Ingles Como Segundo Idioma

El programa de inglés como segundo idioma (ESL) en Los Angeles Mission College se compone de seis niveles, cada nivel es de doce unidades. La filosofía del programa es la de enseñar las destrezas del idioma combinadas de acuerdo al nivel, para que los estudiantes reciban el máximo beneficio.

Nivel 1: ESL 1 integrado (habilidades combinadas) - 12 unidades

Nivel 2: ESL 2 integrado (habilidades combinadas) - 12 unidades

Niveles 3,4,5,6 se componen de dos segmentos:

1. A - Escritura/Gramática - 6 unidades
2. B - Lectura/Vocabulario - 3 unidades
C - Destrezas auditivas/Conversación - 3 unidades

Dias de clases: lunes, martes, miércoles y jueves

Horario: mañanas de 9:00 a 12:00

noches de 6:00 a 9:00, 7:00-10:10

Para información llamar al teléfono:

818.364.7735

Ayuda financiera a quienes califiquen

Community Extension

The Community Extension Program at Los Angeles Mission College offers a wide variety of non-credit courses and one-time seminars for personal and skill development, cultural enrichment and recreational enjoyment for all ages in our community. Courses and workshops are offered year-round in such areas as fine and handcrafted art, floral design, performing arts and music, personal power, dance exercise, money and business, careers, digital media production, languages, kids college, computers and more! For further information please call our office at 818.364.7387 from 8:00 a.m. to 6:00 p.m. Mon.-Thu. and 8:00 a.m. to 5:00p.m. on Fri.

Traffic School

For drivers who have received current traffic citations, the Community Extension Program provides Traffic Violators School on Saturdays only for eight hours. Pre-enrollment is necessary. Please call 818.364.7390 for registration information.

Escuela de Tráfico

Para aquellas personas que han recibido una infracción de tráfico recientemente, el programa "Community Extension" de Mission College ofrece ocho horas de clase de tráfico en español solo los sábados. Es necesario inscribirse con anticipación. Por favor llame al 818.364.7390 para más información.

Financial Aid

Do you need assistance paying your enrollment fees?

The Board of Governors Fee Waiver Program (commonly referred to as BOGG) is a California state program that waives enrollment fees. This waiver does not have to be repaid.

Eligibility: Students must be residents of California, and they must receive state assistance or meet minimum income standards or demonstrate financial need as determined by the federal financial aid application (FAFSA).

How to apply: Fill out 2007-2008 Free Application for Federal Student Aid (FAFSA) form available in the Financial Aid Office or fill out the online application at www.fafsa.ed.gov.

NEW! Effective Fall 2006 semester, the Health Fee will not be waived for all Fee Waiver eligible students

Note: Audited classes are not covered by the Board of Governors Fee Waiver Program. Students are solely responsible for payment of enrollment fees for audited classes. No exception to this policy can be made.

Financial Aid and Scholarships

818.364.7648

Email: lamcfinaid@lamission.edu

Financial aid is made available by federal, state and private sources in the form of grants, scholarships, loans, and employment. Most financial aid resources are intended to supplement, not replace, the financial resources of the family to help pay for the cost of college education.

The Financial Aid Office offers many services to our students including financial aid awareness and FAFSA hands on workshops. Financial Aid counseling is available by appointment with the Financial Aid Director. Our Financial Aid Staff will answer your questions in person and over the phone with FERPA regulations for student privacy. We are here to help you fund your cost of education. Stop by the Financial Aid Office or visit our Financial Aid website at www.lamission.edu/financialaid. Remember that you are in charge of your education; we are here to help you finance it.

How To Apply for Financial Aid:

To apply for Summer 2007 financial aid, you must use the 2006-2007 Free Application for Federal Student Aid (FAFSA) and must submit it before June 30, 2007.

Applying for financial aid is in two easy steps:

Step 1: Apply for a Personal Identification Number (PIN) at www.pin.ed.gov. If you already have a PIN assigned to you by the United States Department of Education, go to Step 2.

Step 2: Apply for financial aid at www.fafsa.ed.gov. Remember, to apply for Summer 2007 financial aid, use the 2006-2007 FAFSA. Our Federal School Code is 012550.

When Do I Apply?

We encourage our students to apply as early as January 1, 2006 and apply before March 2, 2006 for the 2006-2007 academic year.

Our priority deadline to submit all required documents is May 1, 2006. Students who have missed the priority date may still apply as funds may be available. If in doubt, please visit our Financial Aid Office. Staff members are available during regular office hours to answer your questions and assist you in completing any of the forms.

If you will be continuing your education for the Fall 2007, you must reapply for financial aid starting Jan 1, 2007 and you must submit your 2007-2008 Free Application for Federal Student Aid (FAFSA) before March 2, 2007 to apply for the Cal Grant Program.

Office Hours:

Monday and Thursday	10:00 am – 2:00 pm and 5:00 pm – 7:00 pm
Tuesday and Wednesday	10:00 am - 2:00 pm
Friday	Closed

Note: Financial Aid does not pay for audited classes.

A **ADMINISTRATION OF JUSTICE**
Business & Law

001 - INTRODUCTION TO ADMINISTRATION OF JUSTICE (UC:CSU) - 3.00 UNITS

Prerequisite: None.

The history and philosophy of administration of justice including the various subsystems---police, courts, corrections, etc.

Evening Classes

3020 4:45 -7:10 MTWTh Kovnator, G CSB 110
(5 Week Class - Starts 6/11/2007, Ends 7/13/2007)

002 - CONCEPTS OF CRIMINAL LAW

(UC:CSU) - 3.00 UNITS

Prerequisite: None.

The structure, definitions and most used sections of the Penal Code and other criminal statutes.

0139 1:15 -3:40 MTWTh Sinclair, R CSB 101
(5 Week Class - Starts 6/11/2007, Ends 7/13/2007)

004 - PRINCIPLES AND PROCEDURES OF THE JUSTICE SYSTEM (UC:CSU) - 3.00 UNITS

Prerequisite: None.

A study of the various agencies in the criminal justice arena.

Evening Classes

3021 4:45 -7:10 MTWTh Rocke, J CSB 111
(5 Week Class - Starts 6/11/2007, Ends 7/13/2007)

067 - COMMUNITY RELATIONS I

(UC:CSU) - 3.00 UNITS

Prerequisite: None.

A study of the various agencies of the justice system and their attempts to gain the confidence and support of the citizens they serve. Community-based policing is highlighted.

Evening Classes

3137 7:30 -9:55 MTWTh Staff CSB 111
(5 Week Class - Starts 6/11/2007, Ends 7/13/2007)

209 - DOMESTIC VIOLENCE - 3.00 UNITS

Prerequisite: None.

Theory and legal responsibilities of law enforcement and individual rights. Focus is on various types of battering and safety plans for victims.

Evening Classes

3134 4:45 -7:10 MTWTh Mahanay, L CSB 203
(5 Week Class - Starts 6/11/2007, Ends 7/13/2007)

921 - COOPERATIVE EDUCATION - ADMINISTRATION OF JUSTICE - 2.00 UNITS Rpt 3
9093 3:50 hrs TBA Raskin, E Schedule
(10 Week Class - Starts 6/11/2007, Ends 8/17/2007)

931 - COOPERATIVE EDUCATION - ADMINISTRATION OF JUSTICE - 3.00 UNITS Rpt 3
9094 5:50 hrs TBA Raskin, E Schedule
(10 Week Class - Starts 6/11/2007, Ends 8/17/2007)

941 - COOPERATIVE EDUCATION - ADMINISTRATION OF JUSTICE - 4.00 UNITS Rpt 3
Supervised training is conducted in the form of on-the-job training in an employment area that will enhance the student's educational goals.
9095 7:50 hrs TBA Raskin, E Schedule
(10 Week Class - Starts 6/11/2007, Ends 8/17/2007)

A **ANATOMY**
Natural Sciences

Faculty Advisor: Mike Reynolds - 818.364.7695

001 - INTRODUCTION TO HUMAN ANATOMY (UC:CSU) - 4.00 UNITS

Prerequisite: Bio 3 with a grade of C or better.

Advisory: English 28 or ESL 8.

Equivalent to: CSUN Biology 211 and 212; CSULA Biology 200A + 200B with completion of Physiology 1.
0145 LEC 8:00 -9:25 MTWTh Ebnesahidi, A INST 2006
AND LAB 9:35 -11:05 MTWTh Ebnesahidi, A INST 2018
(8 Week Class - Starts 6/11/2007, Ends 8/2/2007)

A **ART**
Arts, Health & Physical Education

103 - ART APPRECIATION I (UC:CSU) - 3.00 UNITS

Prerequisite: None.

Advisory: English 21.

This class is an introductory course that involves the students in an exploration into the nature and appreciation of the visual arts.

All sections may be taken for honors credit. See the Honors Counselor.

Evening Classes

3103 4:45-7:10 pm MTWTh Scheib, G CSB 207
(5 Week Class - Starts 6/11/2007, Ends 7/13/2007)
Art 103 is also offered through PACE. See page 33.

109 - THE ARTS OF AFRICA, OCEANIA, AND ANCIENT AMERICA (UC:CSU) - 3.00 UNITS

Prerequisite: None.

This course is a survey of the painting, sculpture, architecture and craft of Africa, the Pacific Ocean areas and the Indians of North and South America in relation to their history, religion, and general culture.

0162 10:30-12:55 MTWTh Staff CSB 207
(5 Week Class - Starts 6/11/2007, Ends 7/13/2007)

201 - DRAWING I (UC:CSU) - 3.00 UNITS

Prerequisite: None.

Introductory problems in two-dimensional representation of nature with various drawing media; utilizing the elements of design, introductory perspective, with emphasis on the organization of vision and thought in terms of drawing techniques, composition and structure. Required of Art Majors and Multimedia Block I.

7104 LEC 7:45-9:20 MTWTh Zarcone, J CAC 2&3
AND LAB 9:45-11:05 MTWTh Zarcone, J CAC 2&3
(5 Week Class - Starts 6/11/2007, Ends 7/13/2007)

501 - BEGINNING TWO-DIMENSIONAL DESIGN

(UC:CSU) - 3.00 UNITS

Prerequisite: None.

A study of the elements and principles of design. A foundation course in design for application in all subsequent Art major courses. Emphasis is placed upon line, color, texture, shape and composition. Part of the Multimedia Studies Foundation Block I. Required for Art Majors.

Evening Classes

6109 LEC 6:35-8:10 MTWTh Ruppel, B CAC GALE
AND LAB 8:10-9:45 MTWTh Ruppel, B CAC GALE
(5 Week Class - Starts 6/11/2007, Ends 7/13/2007)

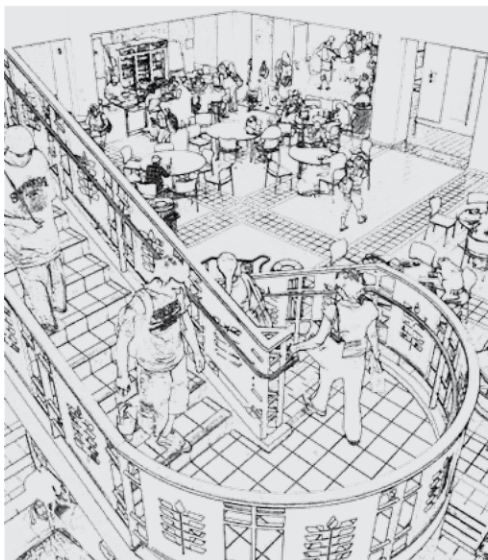

520 - DESIGN WORKSHOP - 3.00 UNITS

Prerequisite: Art 501.

This is a course in the principles of design. Emphasis is placed on individual research, experimentation, and the development of style. Students work with a variety of art materials.

Evening Classes

6110 LEC 6:35-8:10 MTWTh Ruppel, B CAC GALE
AND LAB 8:10-9:45 MTWTh Ruppel, B CAC GALE
(5 Week Class - Starts 6/11/2007, Ends 7/13/2007)

ASTRONOMY
Natural Sciences

Faculty Advisor: Richard Rains - 818.364.7702

001 - ELEMENTARY ASTRONOMY

(UC:CSU) - 3.00 UNITS

Advisory: English 21, or ESL 6.

All sections may be taken for honors credit. See the Honors Counselor.

Evening Classes

3033 4:45-7:10 pm MTWTh Rains, R INST 1015
(5 Week Class - Starts 6/11/2007, Ends 7/13/2007)

005 - FUNDAMENTALS OF ASTRONOMY

LABORATORY (UC:CSU) - 1.00 UNITS

Prerequisite or Corequisite: Astronomy 1.

Evening Classes

3124 LAB 7:30-9:55 pm MTWTh Rains, R INST 1015
(5 Week Class - Starts 6/11/2007, Ends 7/13/2007)

BIOLGY
Natural Sciences

Faculty Advisor: Michael Reynolds - 818.364.7695

003 - INTRODUCTION TO BIOLOGY

(UC:CSU) - 4.00 UNITS

Advisory: English 28 or ESL 8.

Equivalent to: CSUN Biology 101/100L; CSULA Biology 155 and 156.

Evening Classes

6506 LEC 5:25-7:15	T Th	Staff	CMPC 2
AND LAB 7:20-10:10	T	Staff	INST 2018
AND LAB 7:45-10:35	S	Staff	INST 2018
AND LEC 10:40-12:45	S	Staff	CMPC 2

(9 Week Class - Starts 6/11/2007, Ends 8/9/2007)

6507 LEC 5:25-7:15	T Th	Staff	CMPC 2
AND LAB 7:20-10:10	Th	Staff	INST 2018
AND LEC 10:40-12:45	S	Staff	CMPC 2
AND LAB 12:45-3:35	S	Staff	INST 2018

(9 Week Class - Starts 6/11/2007, Ends 8/9/2007)

Biology 3 offered through PACE. See page 33.

16 SUMMER 2007 Schedule OF CLASSES

040 - THE SCIENCE OF BIOTECHNOLOGY

(UC:CSU) - 3.00 UNITS

Prerequisite: Biology 6 and Chemistry 101 or equivalents.

Evening Classes

3152 LEC 5:30-7:30 MTW Echeverri, A INST 2016

AND LAB 7:35-9:35 pm MTW Coyle-Thompson INST 2016

(6 Week Class - Starts 6/11/2007, Ends 7/19/2007)

921 - COOPERATIVE EDUCATION - BIOLOGY

2.00 UNITS Rpt 3

9009 3:50 hrs TBA Raskin, E Schedule

(10 Week Class - Starts 6/11/2007, Ends 8/17/2007)

931 - COOPERATIVE EDUCATION - BIOLOGY

3.00 UNITS Rpt 3

9010 5:50 hrs TBA Raskin, E Schedule

(10 Week Class - Starts 6/11/2007, Ends 8/17/2007)

941 - COOPERATIVE EDUCATION - BIOLOGY

4.00 UNITS Rpt 3

Supervised training is conducted in the form of on-the-job training in an employment area that will enhance the student's educational goals.

9011 7:50 hrs TBA Raskin, E Schedule

(10 Week Class - Starts 6/11/2007, Ends 8/17/2007)

B BUSINESS - Economics & Law

001 - INTRODUCTION TO BUSINESS

(UC:CSU) - 3.00 UNITS

Prerequisite: None.

The student will learn the various forms of business organizations. The student will study business management, organization, financing and marketing, and also become acquainted with the risks involved in business and with government's role in business.

Hybrid Class

3018 4:45-7:10 MW Bernal, V CSB 205

AND 5:35 hrs TBA Bernal, V Internet

Web page: www.lamission.edu/business/bernal

(5 Week Class - Starts 6/11/2007, Ends 7/13/2007)

Evening Classes

3051 5:30-7:55 MTWTh Rush, C INST 2006

(5 Week Class - Starts 6/11/2007, Ends 7/13/2007)

005 - BUSINESS LAW I (UC:CSU) - 3.00 UNITS

Prerequisite: None.

Same as Law 1.

0213 10:30-12:55 MTWTh Rush, C INST 2006

(5 Week Class - Starts 6/11/2007, Ends 7/13/2007)

921 - COOPERATIVE BUSINESS - BUSINESS

2.00 UNITS Rpt 3

9013 3:50 hrs TBA Raskin, E Schedule

(10 Week Class - Starts 6/11/2007, Ends 8/17/2007)

931 - COOPERATIVE EDUCATION - BUSINESS

3.00 UNITS Rpt 3

9014 5:50 hrs TBA Raskin, E Schedule

(10 Week Class - Starts 6/11/2007, Ends 8/17/2007)

941 - COOPERATIVE EDUCATION - BUSINESS 4.00 UNITS Rpt 3

Supervised training is conducted in the form of on-the-job training in an employment area that will enhance the student's educational goals.

9015 7:50 hrs TBA Raskin, E Schedule

(10 Week Class - Starts 6/11/2007, Ends 8/17/2007)

B BUSINESS - Economics & Law

001 - PRINCIPLES OF ECONOMICS I

(UC:CSU) - 3.00 UNITS

Prerequisite: None.

This class may be taken for honors credit. See the Honors Counselor.

0141 10:30-12:55 MTWTh Yguado, A CSB 111

(5 Week Class - Starts 6/11/2007, Ends 7/13/2007)

Economics 1 also offered through ITV. See page 34.

002 - PRINCIPLES OF ECONOMICS II

(UC:CSU) - 3.00 UNITS

Prerequisite: None.

This class may taken for honors credit. See the Honors Counselor.

0133 1:15-3:40 MTWTh Yguado, A INST 2006

(5 Week Class - Starts 6/11/2007, Ends 7/13/2007)

Economics 2 is also offered through PACE. See page 33.

B BUSINESS - MANAGEMENT

013 - SMALL BUSINESS ENTREPRENEURSHIP

(CSU) - 3.00 UNITS

Prerequisite: None.

This course presents a systematic approach to successful small business operation.

Hybrid Class. Meeting dates: 6/11-7/12/2007.

Evening Classes

3101 7:30-9:55 MW Bernal, V CSB 207

AND 4:15 hrs TBA Bernal, V Internet

Web page: www.lamission.org

(6 Week Class - Starts 6/11/2007, Ends 7/17/2007)

921 - COOPERATIVE EDUCATION - MANAGEMENT

2.00 UNITS Rpt 3

9049 3:50 hrs TBA Raskin, E S Schedule
(10 Week Class - Starts 6/11/2007, Ends 8/17/2007)**931 - COOPERATIVE EDUCATION - MANAGEMENT**

3.00 UNITS Rpt 3

9050 5:50 hrs TBA Raskin, E S Schedule
(10 Week Class - Starts 6/11/2007, Ends 8/17/2007)**941 - COOPERATIVE EDUCATION - MANAGEMENT**

4.00 UNITS Rpt 3

Supervised training is conducted in the form of on-the-job training in an employment area that will enhance the student's educational goals.

9051 7:50 hrs TBA Raskin, E S Schedule
(9 Week Class - Starts 6/11/2007, Ends 8/17/2007)**CHEMISTRY**
Natural Sciences

Faculty Advisor: Said Pazirandeh - 818.364.7705

065 - INTRODUCTORY GENERAL CHEMISTRY

(UC:CSU) - 4.00 UNITS

Prerequisite: Math 125 with a grade of "C" or better, or appropriate Math placement results.

Equivalent to CSUN Chemistry 103 or 105.

This course covers the principles of general chemistry at an elementary level with special emphasis on the applications of chemical principles to everyday life and the development of a basic chemical vocabulary.

Evening Classes**3107 LEC 5:25-7:30 MTWTh Mallory, C INST 2003****AND LAB 7:40-9:45 MTWTh Mallory, C INST 2012**

(6 Week Class - Starts 6/11/2007, Ends 7/19/2007)

CHICANO STUDIES
*Foreign Languages & Chicano Studies***007 - THE MEXICAN-AMERICAN IN THE HISTORY OF THE UNITED STATES I** (UC:CSU) - 3.00 UNITS**Prerequisite:** None.

Traces the historical evolution of the Mexican- American to 1850.

0168 10:30 hrs TBA Maldonado, J Internet
Email: maldonja@lamission.edu
(5 Week Class - Starts 6/11/2007, Ends 7/13/2007)**037 - CHICANO LITERATURE**

(UC:CSU) - 3.00 UNITS

Prerequisite: None.0173 10:30 hrs TBA Maldonado, J Internet
Email: maldonja@lamission.edu
(5 Week Class - Starts 6/11/2007, Ends 7/13/2007)**047 - THE MEXICAN-AMERICAN WOMAN IN SOCIETY** (UC:CSU) - 3.00 UNITS**Prerequisite:** None.

The social historical development of the Mexican-American woman.

This class may be taken for honors credit. See the Honors Counselor.

0101 7:47-10:10 W Morales, J CSB 203
AND 6:05 hrs TBA Morales, J Internet
Email: moralejj@lamission.edu
(5 Week Class - Starts 6/11/2007, Ends 7/18/2007)**CHILD DEVELOPMENT**
*Professional Studies***001 - CHILD GROWTH AND DEVELOPMENT**

(UC:CSU) - 3.00 UNITS

Prerequisite: None.

Covers the development of a child from the prenatal stage through adolescence.

Evening Classes**3000 7:30-9:55 MTWTh Staff CSB 102B**

(5 Week Class - Starts 6/11/2007, Ends 7/13/2007)

002 - EARLY CHILDHOOD: PRINCIPLES AND PRACTICES - 3.00 UNITS**Prerequisite:** None.

Preschool principles, practices (including discipline and guidance) and philosophies.

Evening Classes**3001 4:45-7:10 MTWTh DeSilva, L INST 100B**

(5 Week Class - Starts 6/11/2007, Ends 7/13/2007)

003 - CREATIVE EXPERIENCES FOR CHILDREN I

3.00 UNITS

Advisory: Child Dev 1 and 2.

Arts, crafts, puppetry, dramatic play.

0110 1:15-3:40 MTWTh De Silva, L CSB 102A
(5 Week Class - Starts 6/11/2007, Ends 7/13/2007)

18 SUMMER 2007 Schedule OF CLASSES

010 - CHILD HEALTH (CSU) - 3.00 UNITS

Prerequisite: None.

Health and safety, communicable illness and management, safe environment, child nutrition. Pediatric First Aid and Cardio-Pulmonary-Respiration certificates will be issued.

0111 10:30-12:55 MTWTh Wada, J CSB 102A

(5 Week Class - Starts 6/11/2007, Ends 7/13/2007)

7002 1:00-4:30 TWTh Nasatir, D KIRK HSR3

(5 Week Class - Starts 6/11/2007, Ends 7/13/2007)

Class meets at 10500 Lindley St., Northridge 91326

045 - PROGRAMS FOR CHILDREN WITH

SPECIAL NEEDS II - 3.00 UNITS

Prerequisite: None.

Study of programs for exceptional children (special education) and "mainstreaming."

Evening Classes

3002 4:45-7:10 MTWTh Wada, J CSB 102B

(5 Week Class - Starts 6/11/2007, Ends 7/13/2007)

921 - COOPERATIVE EDUCATION -

CHILD DEVELOPMENT - 2.00 UNITS Rpt 3

9021 3:50 hrs TBA Raskin, E Schedule

(9 Week Class - Starts 6/11/2007, Ends 8/17/2007)

931 - COOPERATIVE EDUCATION -

CHILD DEVELOPMENT - 3.00 UNITS Rpt 3

9022 5:50 hrs TBA Raskin, E Schedule

(9 Week Class - Starts 6/11/2007, Ends 8/17/2007)

941 - COOPERATIVE EDUCATION -

CHILD DEVELOPMENT - 4.00 UNITS Rpt 3

Supervised training is conducted in the form of on-the-job training in an employment area that will enhance the student's educational goals.

9023 7:50 hrs TBA Raskin, E Schedule

(9 Week Class - Starts 6/11/2007, Ends 8/17/2007)

CINEMA

Arts, Health & Physical Education

003 - HISTORY OF MOTION PICTURES

(UC:CSU) - 3.00 UNITS

Prerequisite: None.

This course includes history of the development of motion pictures, with examples screened from the silent film to the present day. Emphasis is placed on American feature films.

All sections may be taken for honors credit. See the Honors Counselor.

Evening Classes

3026 LEC 6:35-8:10 MTWTh Staff LRC TCR

AND LAB 8:15-9:50 MTWTh Staff LRC TCR

(5 Week Class - Starts 6/11/2007, Ends 7/13/2007)

CITIZENSHIP CENTER

DAY CLASSES

8938 CIT 1 8:00-11:00 MTWTh J. Ruelas Maclay

8939 CIT 1 8:00-11:00 MTWTh M. Krawchuk Sara-Coug

8940 CIT 1 8:00-11:00 MTWTh Staff SFDO MS

(6 Week Classes -Starts 6/11/2007, Ends 7/21/2007)

Maclay= Maclay Middle School

Sara Coug= Sara Coughlin

SFDO MS= San Fernando Middle School

EVENING CLASSES

5938 CIT 1 6:00-9:00 MTWTh L. Galvez CC MS

5939 CIT 1 6:00-9:00 MW De La Cruz, J CC MS

6:00-9:00 TTh De La Cruz, L CC MS

5940 CIT 1 6:00-9:00 MTWTh Staff CC MS

(6 Week Classes -Starts 6/11/2007, Ends 7/21/2007)

CC MS = Community Charter Middle School

Note: Registration for these classes is held at the Maclay Annex

436 N Maclay Ave.

San Fernando, CA 91340

818.837.2239

COMPUTER APPLICATIONS & OFFICE TECHNOLOGIES

Business & Law

082 - MICROCOMPUTER SOFTWARE SURVEY

IN THE OFFICE - 3.00 UNITS

Advisory: CAOT 1.

Same as CSU Computer 100.

Become computer literate in MS Office using Word, Excel, Access, and PowerPoint.

7050 LEC 10:30-12:05 MTWTh Flood, P INST 2021

AND LAB 12:20- 2:40 MTWTh Flood, P INST 2021

(5 Week Class - Starts 6/11/2007, Ends 7/13/2007)

921 - COOPERATIVE EDUCATION - COMPUTER

APPLICATIONS OFFICE TECH - 2.00 UNITS Rpt 3

9057 3:50 hrs TBA Raskin, E Schedule

(10 Week Class - Starts 6/11/2007, Ends 8/17/2007)

931 - COOPERATIVE EDUCATION - COMPUTER

APPLICATIONS OFFICE TECH - 3.00 UNITS Rpt 3

9058 5:50 hrs TBA Raskin, E Schedule

(10 Week Class - Starts 6/11/2007, Ends 8/17/2007)

941 - COOPERATIVE EDUCATION - COMPUTER

APPLICATIONS OFFICE TECH - 4.00 UNITS Rpt 3

Supervised training is conducted in the form of on-the-job training in an employment area that will enhance the student's educational goals.

9059 7:50 hrs TBA Raskin, E Schedule

(10 Week Class - Starts 6/11/2007, Ends 8/17/2007)

COMPUTER SCIENCE
INFORMATION TECHNOLOGY
Engineering & Computer Science

Faculty Advisor: Mari Rettke - 818.609.4761

401 - INTRODUCTION TO COMPUTERS AND THEIR USES (UC:CSU) - 3.00 UNITS

Prerequisite: None.

Introduction to Computer Science terminology, concepts and programming.

This class satisfies the CAL STATE (CSUN) and the UC/ system Computer Literacy Requirement at ONE FOURTH of the price.

Evening Classes

3074 LAB 6:00-7:00 MTWTh Kubicki, P INST CLAB
AND LEC 7:00-10:15 MTWTh Kubicki, P INST 2004
(Email: online401@hotmail.com
5 Week Class - Starts 6/11/2007, Ends 7/13/2007)

408 - VISUAL BASIC (UC:CSU) - 3.00 UNITS

Prerequisite: None.

Introduction to programming: Using Visual Basic.

Evening Classes

3075 LAB 6:00-8:00 MTWTh Rettke, M INST CLAB
AND LEC 8:00-10:15 MTWTh Rettke, M INST 2005
(5 Week Class - Starts 6/11/2007, Ends 7/13/2007)

921 - COOPERATIVE EDUCATION - COMPUTER SCIENCE-INFORMATION TECHNOLOGY

2.00 UNITS Rpt 3

9088 3:50 hrs TBA Raskin, E Schedule
(10 Week Class - Starts 6/11/2007, Ends 8/17/2007)

931 - COOPERATIVE EDUCATION - COMPUTER SCIENCE-INFORMATION TECHNOLOGY

3.00 UNITS Rpt 3

9024 5:50 hrs TBA Raskin, E Schedule
(10 Week Class - Starts 6/11/2007, Ends 8/17/2007)

941 - COOPERATIVE EDUCATION - COMPUTER SCIENCE-INFORMATION TECHNOLOGY

4.00 UNITS Rpt 3

Supervised training is conducted in the form of on-the-job training in an employment area that will enhanced the student's educational goals.

9025 7:50 hrs TBA Raskin, E Schedule
(10 Week Class - Starts 6/11/2007, Ends 8/17/2007)

DEVELOPMENTAL COMMUNICATIONS
Developmental Communications

001 - GRAMMAR: APPLIED TO WRITING

3.00 UNITS Rpt 1

Prerequisite: None.

Class is graded credit/no-credit.

This course offers an introduction to basic grammar as it relates to writing and other communication skills. It covers parts of speech, sentence structure, types of phrases and clauses, verb tenses and agreement, pronoun usage, comparison, capitalization, and punctuation.

0108 7:45-10:10 MTWTh Staff LRC 215
(5 Week Class - Starts 6/11/2007, Ends 7/13/2007)

Evening Classes

3024 7:30- 9:55 MTWTh Staff LRC 215
(5 Week Class - Starts 6/11/2007, Ends 7/13/2007)

022C - COMMUNICATIONS LABORATORY C

1.00 UNITS Rpt 2

Prerequisite: None.

Class is graded credit/no-credit.

0180 2:05 hrs TBA Scuderi, R INST 1018
Class is geared for disabled students.
(5 Week Class - Starts 6/11/2007, Ends 7/13/2007)

022D - COMMUNICATIONS LABORATORY D

1.00 UNITS Rpt 2

Prerequisite: None.

Class is graded credit/no-credit.

0181 2:05 hrs TBA Scuderi, R INST 1018
Class is geared for disabled students.
(5 Week Class - Starts 6/11/2007, Ends 7/13/2007)

022E - COMMUNICATIONS LABORATORY E

1.00 UNITS Rpt 2

Prerequisite: None.

Class is graded credit/no-credit.

0182 2:05 hrs TBA Scuderi, R INST 1018
Class is geared for disabled students.
(5 Week Class - Starts 6/11/2007, Ends 7/13/2007)

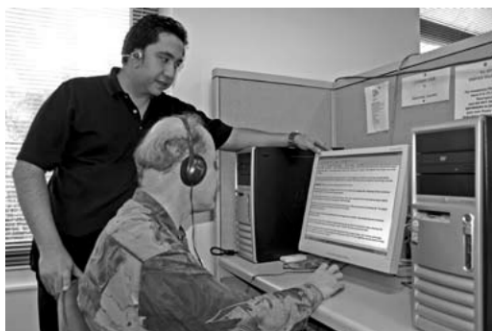

20 SUMMER 2007 Schedule OF CLASSES

036A - READING II: COMPREHENSION AND RELATED SKILLS A - 3.00 UNITS Rpt 1

Prerequisite: None.

Class is graded credit/no-credit

Intermediate course in reading; emphasizes finding main ideas, critical thinking, vocabulary skills, and study skills.

0112 10:30-12:55 MTWTh Staff LRC 215

(5 Week Class - Starts 6/11/2007, Ends 7/13/2007)

Evening Classes

3135 4:45-7:10 MTWTh Staff LRC 215

(5 Week Class - Starts 6/11/2007, Ends 7/13/2007)

Developmental Communication 36A also offered through PACE. See page 33.

ENGLISH ESL, English & Journalism

021 - ENGLISH FUNDAMENTALS - 3.00 UNITS

Prerequisite: Appropriate skill level demonstrated through the English assessment process or by permit.

Corequisite: Dev Com 36A.

Class graded credit/no credit.

Basic grammar, spelling, punctuation, topic sentences, and paragraph structure.

0171 7:45-10:10 MTWTh Grant, R CSB 208

(5 Week Class - Starts 6/11/2007, Ends 7/13/2007)

0172 10:30-12:55 MTWTh Grant, R CSB 205

(5 Week Class - Starts 6/11/2007, Ends 7/13/2007)

Evening Classes

3017 4:45-7:10 MTWTh Love, M CSB 206

(5 Week Class - Starts 6/11/2007, Ends 7/13/2007)

3029 7:30-9:55 MTWTh Staff CSB 206

(5 Week Class - Starts 6/11/2007, Ends 7/13/2007)

English 21 is also offered through PACE. See page 33.

028 - INTERMEDIATE READING AND COMPOSITION

3.00 UNITS

As a component of the student's final grade, a Common Department Final is required.

Prerequisite: English 21 with a grade of "C" or better, or appropriate skills level demonstrated through the English assessment process, or by permit.

English 28 is a course in reading and writing designed to strengthen the student's ability to use basic communication skills, including grammar, spelling, punctuation, and sentence construction. Instruction will include the assignment of full-length expository and argumentative essays.

0113 7:45-10:10 MTWTh Smith, N INST 1005

(5 Week Class - Starts 6/11/2007, Ends 7/13/2007)

Evening Classes

3009 7:30-9:55 MTWTh Staff INST 1004

(5 Week Class - Starts 6/11/2007, Ends 7/13/2007)

English 28 also offered through PACE. See page 33.

101 - COLLEGE READING AND COMPOSITION I

(UC:CSU) - 3.00 UNITS

Prerequisite: English 28 or ESL 8 with a grade of "C" or better, or appropriate skill level demonstrated through the English assessment process, or by permit.

This is the first freshman composition course that meets requirements for the BA at four-year colleges and universities, comprising intensive reading, writing of essays, term papers, the study of style, methods of discourse, logic, and documentation.

All sections may be taken for honors credit. See the Honors Counselor.

0114 7:45-10:10 MTWTh Staff CSB 201

(5 Week Class - Starts 6/11/2007, Ends 7/13/2007)

Evening Classes

3013 4:45-7:10 MTWTh Staff CSB 101

(5 Week Class - Starts 6/11/2007, Ends 7/13/2007)

3025 7:30-9:55 MTWTh Orozco, J CSB 201

(5 Week Class - Starts 6/11/2007, Ends 7/13/2007)

102 - COLLEGE READING AND COMPOSITION II

(UC:CSU) - 3.00 UNITS

Prerequisite: English 101 with a grade of "C" or better, or by permit.

Critical thinking and writing through the reading of poetry, drama, the short story, and the novel.

All sections may be taken for honors credit. See the Honors Counselor.

0151 10:30-12:55 MTWTh Campuzano, L CSB 101

(5 Week Class - Starts 6/11/2007, Ends 7/13/2007)

Evening Classes

3116 4:45-7:10 MTWTh Orozco, J CSB 201

(5 Week Class - Starts 6/11/2007, Ends 7/13/2007)

English 102 also offered through ITV. See page 34.

English 102 also offered through Pace. See page 33.

921 - COOPERATIVE EDUCATION - ENGLISH

2.00 UNITS Rpt 3

9091 3:50 hrs TBA Raskin, E Schedule

(10 Week Class - Starts 6/11/2007, Ends 8/17/2007)

931 - COOPERATIVE EDUCATION - ENGLISH

3.00 UNITS Rpt 3

9034 5:50 hrs TBA Raskin, E Schedule

(10 Week Class - Starts 6/11/2007, Ends 8/17/2007)

941 - COOPERATIVE EDUCATION - ENGLISH

4.00 UNITS Rpt 3

Supervised training is conducted in the form of on-the-job training in an employment area that will enhance the student's educational goals.

9035 7:50 hrs TBA Raskin, E Schedule

(10 Week Class - Starts 6/11/2007, Ends 8/17/2007)

ENGLISH AS A SECOND LANGUAGE

ESL, English & Journalism

052 - ESL READING AND CONVERSATION A

(NDA) - 3.00 UNITS

Prerequisite: Appropriate ESL placement results or by permit.

Class is graded credit/no-credit.

0117 7:45-10:10 MTWTh Prostack, G CSB 101
(5 Week Class - Starts 6/11/2007, Ends 7/13/2007)

Evening Classes

3117 7:30-9:55 MTWTh Lilburn, M CSB 101
(5 Week Class - Starts 6/11/2007, Ends 7/13/2007)

053 - ESL READING AND CONVERSATION B

(NDA) - 3.00 UNITS

Prerequisite: ESL 3, or appropriate ESL placement results, or by permit.

Class is graded credit/no-credit.

0118 7:45-10:10 MTWTh Staff CSB 205
(5 Week Class - Starts 6/11/2007, Ends 7/13/2007)

Evening Classes

3118 7:30-9:55 MTWTh Taylor, D CSB 205
(5 Week Class - Starts 6/11/2007, Ends 7/13/2007)

FAMILY AND CONSUMER STUDIES

Professional Studies

021 - NUTRITION (UC:CSU) - 3.00 UNITS

Prerequisite: None.

Required for ACF Certificate and Food Production Certificate, meets Natural Science requirement.

Comprehensive scientific nutrition information.

0102 10:30-12:55 MTWTh Epps, F CSB 201
(5 Week Class - Starts 6/11/2007, Ends 7/13/2007)

038 - IN-HOME CARE - 3.00 UNITS

Prerequisite: None.

Provides training for those interested in providing in-home care to older adults.

Continuing Education credit for RCFE.

0152 7:45-10:10 MTWTh EPPS, F CSB 105
(5 Week Class - Starts 6/11/2007, Ends 7/13/2007)

921 - COOPERATIVE EDUCATION - FAMILY AND CONSUMER STUDIES - 2.00 UNITS Rpt 3

9092 3:50 hrs TBA Raskin, E S Schedule
(9 Week Class - Starts 6/11/2007, Ends 8/11/2007)

931 - COOPERATIVE EDUCATION - FAMILY AND CONSUMER STUDIES - 3.00 UNITS Rpt 3

9038 5:50 hrs TBA Raskin, E S Schedule
(9 Week Class - Starts 6/11/2007, Ends 8/11/2007)

941 - COOPERATIVE EDUCATION - FAMILY AND CONSUMER STUDIES - 4.00 UNITS Rpt 3

Supervised training is conducted in the form of on-the-job training in an employment area that will enhance the student's educational goals.

9039 7:50 hrs TBA Raskin, E S Schedule
(9 Week Class - Starts 6/11/2007, Ends 8/11/2007)

FOOD SERVICE MANAGEMENT

Professional Studies

Faculty Advisor: Eloise F. Cantrell - 818.364.7625

050 - SANITATION AND SAFETY

(CSU) - 3.00 UNITS

Prerequisite: None.

0184	9:00 hrs	TBA	Struwe, K	Internet
Email: kurtstruwe@sbcglobal.net				
(5 Week Class - Starts 6/11/2007, Ends 7/13/2007)				

7107	8:30-11:05	TTh	Gilligan, M	PHOENIX
(11 Week Class - Starts 6/11/2007, Ends 8/24/2007)				

Note: The following series of classes FSM 100 through 108 and FCS 108, FCS 21, FCS 163 are required for AA, AS, ACF certification, and Food Management Certificate Program.

101 - FOOD PRODUCTION I (CSU) - 4.00 UNITS

Prerequisite: FCS 50, 100 and negative TB test.

Study and lab experience of quality food production. Introduction and application of culinary principles and procedures for basic food preparation.

Course is part of a one-year log series.

0100	LEC	8:00-8:55	MTWTh	Garcia, R	INST 1006
AND	LAB	9:10-11:40	MTWTh	Garcia, R	INST 1006
(Class taught bilingually (English/Spanish))					
(10 Week Class - Starts 6/11/2007, Ends 8/17/2007)					

7100	LEC	10:00-11:05	TWTh	Luna, A	CAMP HOLT
AND	LAB	11:05-2:20	TWTh	Luna, A	CAMP HOLT
(11 Week Class - Starts 6/12/2007, Ends 8/23/2007)					

7101	LEC	8:30-9:35	MWF	Zandalasini, L	PHOENIX
AND	LAB	9:45-1:05	MWF	Zandalasini, L	PHOENIX
(11 Week Class - Starts 6/11/2007, Ends 8/24/2007)					

7102	LEC	8:00-9:05	MWF	Higgins, A	CAMP GONZ
AND	LAB	8:00-9:05	TTh	Higgins, A	CAMP GONZ
AND	LAB	9:05-10:30	MTWThF	Higgins, A	CAMP GONZ
(11 Week Class - Starts 6/11/2007, Ends 8/25/2007)					

22 SUMMER 2007 Schedule OF CLASSES

102 - FOOD PRODUCTION II (CSU) - 4.00 UNITS

Prerequisite: FCS 101 and negative TB test.

Advanced study and laboratory experiences of food preparation and production that meet American Culinary Federation Certification/Competencies. Part of a one year certificate program.

0126 LEC	8:00-8:55	MTWTh	Garcia, R	INST 1006
AND LAB	9:10-11:45	MTWTh	Garcia, R	INST 1006

(Class taught bilingually English/Spanish).
(10 Week Class - Starts 6/11/2007, Ends 8/17/2007)

7003 LEC	10:00-11:05	TWTh	Luna, A	CAMP HOLT
AND LAB	11:05-2:20	TWTh	Luna, A	CAMP HOLT

(11 Week Class - Starts 6/12/2007, Ends 8/23/2007)

7004 LEC	8:30-9:35	MWF	Zandalasini, L	PHOENIX
AND LAB	9:45-1:05	MWF	Zandalasini, L	PHOENIX

(11 Week Class - Starts 6/11/2007, Ends 8/24/2007)

7005 LEC	8:00-9:05	MWF	Higgins, A	CAMP GONZ
AND LAB	8:00-9:05	TTh	Higgins, A	CAMP GONZ
AND LAB	9:05-10:30	MTWThF	Higgins, A	CAMP GONZ

(11 Week Class - Starts 6/11/2007, Ends 8/25/2007)

103 - MENU PLANNING - 2.00 UNITS

Prerequisite: FCS 21, FSM 100.

Course is part of a two-year certificate program. Examines basic principles of menu design. Includes all phases of menu planning for today's trends using computer software.

0311	12:00-2:50	MTWTh	Gilligan, M	INST 1002
------	------------	-------	-------------	-----------

(5 Week Class - Starts 6/11/2007, Ends 7/17/2007)

225 - FOODS LABORATORY - 2.00 UNITS Rpt 3

Prerequisite: FSM 101.

Class is graded credit/no-credit.

Supervised practice in college-operated food service operation, as well as food preparation in range, pantry, bakery, and short order.

0131 LAB	9:10-11:45	MTWTh	Garcia, R	INST 1006
----------	------------	-------	-----------	-----------

(10 Week Class - Starts 6/11/2007, Ends 8/17/2007)



GEOGRAPHY Natural Sciences

Faculty Advisor: Lorraine Manoogian - 818.364.7706

001 - PHYSICAL GEOGRAPHY

(UC:CSU) - 3.00 UNITS

Prerequisite: None.

This course covers the changing processes within the Earth's major Geosystems: the Atmosphere, Hydrosphere, Lithosphere and Biosphere. Units of study include weather, climate, landforms, plate tectonics, gradational processes of mass wasting, soil formation, vegetation communities and the human impact of the environment.

This course meets university transfer requirements for natural or physical science.

0177	10:30-12:55	MTWTh	Manoogian, L	INST 1013
------	-------------	-------	--------------	-----------

(5 Week Class - Starts 6/11/2007, Ends 7/13/2007)

015 - PHYSICAL GEOGRAPHY LABORATORY

(UC:CSU) - 2.00 UNITS

Prerequisite or Corequisite: Geog 1.

This earth environment laboratory emphasizes the scientific method by competing exercises and graphs solve equations, determine measurements, construct diagrams, and make field observations about Earth-Sun relations, weather systems, climate regions, soil classification, rock types and agents of landform modification.

This course meets university transfer requirements for the laboratory portion of the Physical Sciences.

0216 LEC	1:15-2:05	MTWTh	Rahman, A	INST 2014
AND LAB	2:05-3:40	MTWTh	Rahman, A	INST 2014

(5 Week Class - Starts 6/11/2007, Ends 7/13/2007)

HEALTH Arts, Health & Physical Education

011 - PRINCIPLES OF HEALTHFUL LIVING

(UC:CSU) - 3.00 UNITS

Prerequisite: None.

Implements the World Health Organization's definition of health that health is the state of physical, mental and social well-being, not merely the absence of disease.

0121	7:45-10:10	MTWTh	Cooper, C	CSB 110
------	------------	-------	-----------	---------

(5 Week Class - Starts 6/11/2007, Ends 7/13/2007)

0202	10:30-12:55	MTWTh	Cooper, C	CSB 110
------	-------------	-------	-----------	---------

(5 Week Class - Starts 6/11/2007, Ends 7/13/2007)

Evening Classes

3122	7:30-9:55	MTWTh	Staff	CSB 110
------	-----------	-------	-------	---------

(5 Week Class - Starts 6/11/2007, Ends 7/13/2007)

Health 11 also offered through ITV. See page 34.

HISTORY

Social Sciences

001 - INTRODUCTION TO WESTERN CIVILIZATION I

(UC:CSU) - 3.00 UNITS

Prerequisite: None.

A survey course emphasizing the main political, social, and economic currents that shaped the development of Western Civilization from antiquity through the emergence of nations in the 18th Century.

This section may be taken for honors credit. See the Honors Counselor.

Evening Classes

3121 4:45 - 7:10 MTWTh Staff INST 1010
(5 Week Class - Starts 6/11/2007, Ends 7/13/2007)
History 1 is also offered through ITV. See page 34.

011 - POLITICAL AND SOCIAL HISTORY OF THE UNITED STATES I

(UC:CSU) - 3.00 UNITS

Prerequisite: None.

A survey of major events, personages, and themes most significant to the political, economic, and social development of this nation from its New World beginnings through the Civil War. It meets the American History and Institutions requirements for the California State University system and the Social and Behavioral Sciences requirements for all universities.

All sections may be taken for honors credit. See the Honors Counselor.

0122 10:30-12:55 MTWTh Staff INST 1010
(5 Week Class - Starts 6/11/2007, Ends 7/13/2007)
History 11 also offered through ITV. See page 34.

012 - POLITICAL AND SOCIAL HISTORY OF THE UNITED STATES II

(UC:CSU) - 3.00 UNITS

Prerequisite: None.

Note: History 11 is not required for this course.

A survey of major events personages, and themes most significant to the political, economic, and social development of this nation from the Reconstruction Period (1865) to the present.

This section may be taken for honors credit. See the Honors Counselor.

0123 7:45-10:10 MTWTh Staff INST 1010
(5 Week Class - Starts 6/11/2007, Ends 7/13/2007)

HUMANITIES

Social Sciences

001 - CULTURAL PATTERNS OF WESTERN CIVILIZATION

(UC:CSU) - 3.00 UNITS

Prerequisite: None.

Survey of the arts in western civilization.

0125 10:30-12:55 MTWTh Goldberg, H INST 1017
(5 Week Class - Starts 6/11/2007, Ends 7/13/2007)

003 - THE ARTS OF CONTEMPORARY SOCIETY

(UC:CSU) - 3.00 UNITS

Prerequisite: None.

Humanities 3 offered through PACE. See page 33.

031 - PEOPLE IN CONTEMPORARY SOCIETY

(UC:CSU) - 3.00 UNITS

Prerequisite: None.

Traces the arts in their interrelations from the Baroque to the present as mirrors of western man's view of himself in a changing world.

0179 7:45-10:10 MTWTh Buchanan, L CSB 207
(6 Week Class - Starts 6/11/2007, Ends 7/16/2007)

921 - COOPERATIVE EDUCATION - HUMANITIES

2.00 UNITS Rpt 3

9040 3:50 hrs TBA Raskin, E Schedule
(10 Week Class - Starts 6/11/2007, Ends 8/17/2007)

931 - COOPERATIVE EDUCATION - HUMANITIES

3.00 UNITS Rpt 3

9042 5:50 hrs TBA Raskin, E Schedule
(10 Week Class - Starts 6/11/2007, Ends 8/17/2007)

941 - COOPERATIVE EDUCATION - HUMANITIES

4.00 UNITS Rpt 3

Supervised training is conducted in the form of on-the-job training in an employment area that will enhance the student's educational goals.

9043 7:50 hrs TBA Raskin, E Schedule
(10 Week Class - Starts 6/11/2007, Ends 8/17/2007)

INTERIOR DESIGN

Professional Studies

108B - SPACE PLANNING B - 2.00 UNITS

Prerequisite: None.

Advisory: ID 102, ID 106A and ID 106B, ID 108.

Design theory, applied to commercial interiors. Students do not need to have completed 108A to take this class.

7106 LEC 10:30-11:30 TTh Weilacher, D CAC 4
AND LAB 11:40-12:55 TTh Weilacher, D CAC 4
(5 Week Class - Starts 6/11/2007, Ends 7/13/2007)

24 SUMMER 2007 Schedule OF CLASSES

114 - MATERIALS AND COMPONENTS

2.00 UNITS

Prerequisite: None.

This course covers specifications for paints, finishes, coating products, their application methods and surface preparations, hard and soft flooring, wall and ceiling materials, construction and quality, moldings, door hardware and door materials.

Field trips may be required.

Evening Classes

6154 4:45 - 7:10 TWTh Anderson, S CAC 4
(5 Week Class - Starts 6/11/2007, Ends 7/13/2007)

115 - WINDOW TREATMENTS - 1.00 UNIT

Prerequisite: None.

This course covers window history, hard and soft window treatments and installations, specialty installations, residential and commercial specifications, sources for design concepts, calculating fabric requirements, measuring techniques used by installers, workrooms and interior designers and job costing.

7108 1:00-4:30 Th Weilacher, D CAC 4
(5 Week Class - Starts 6/11/2007, Ends 7/13/2007)

LAW Business & Law

001 - BUSINESS LAW I (UC:CSU) - 3.00 UNITS

Prerequisite: None.

Same as Business 5.

Introductory course in civil law open to all students.

0127 10:30 hrs TBA Kellogg, C Internet
Web page: www.lamission.edu/law
(5 Week Class - Starts 6/11/2007, Ends 7/13/2007)

002 - BUSINESS LAW II (UC:CSU) - 3.00 UNITS

Prerequisite: None.

Same as Business 6.

Second part of the civil law course, including bailment, principles of agency, third parties, partnerships, corporation, stockholders, and legal aspects of negotiable instruments.

This class may be taken for honors credit. See the Honors Counselor.

0167 10:30 hrs TBA Morinaka, B Internet
Web page: www.lamission.edu/law
(5 Week Class - Starts 6/11/2007, Ends 7/13/2007)

011 - INTRODUCTION TO LEGAL ASSISTANT II

(CSU) - 3.00 UNITS

Prerequisite: None.

A detailed examination of civil and criminal cases, and an introduction to drafting and writing.

0107 10:30 hrs TBA Jordan, D Internet
Web page: www.lamission.edu/law
(5 Week Class - Starts 6/11/2007, Ends 7/13/2007)

019 - PROPERTY AND CREDITOR RIGHTS

3.00 UNITS

Prerequisite: None.

Laws protecting landowners, tenants, and creditors.

Law 19 is a study of law of personal property and real property, and bankruptcy law and forms.

0170 10:30 hrs TBA Jordan, D Internet
Web page: www.lamission.edu/law
(5 Week Class - Starts 6/11/2007, Ends 7/13/2007)

020 - BASIC PROBATE PROCEDURES

3.00 UNITS

Prerequisite: None.

Study of the fundamental principles and methods of fact gathering, office of both testate and intestate decedents, as well as the administration of estates in California Probate Courts.

0128 10:30 hrs TBA Lampert, E Internet
Web page: www.lamission.edu/law
(5 Week Class - Starts 6/11/2007, Ends 7/13/2007)

921 - COOPERATIVE EDUCATION - LAW

2.00 UNITS Rpt 3

9045 3:50 hrs TBA Raskin, E S Schedule
(9 Week Class - Starts 6/11/2007, Ends 8/17/2007)

931 - COOPERATIVE EDUCATION - LAW

3.00 UNITS Rpt 3

9046 5:50 hrs TBA Raskin, E S Schedule
(9 Week Class - Starts 6/11/2007, Ends 8/17/2007)

941 - COOPERATIVE EDUCATION - LAW

4.00 UNITS Rpt 3

Supervised training is conducted in the form of on-the-job training in an employment area that will enhance the student's educational goals.

9047 7:50 hrs TBA Raskin, E S Schedule
(9 Week Class - Starts 6/11/2007, Ends 8/11/2007)



MATHEMATICS

Mathematics

100 - MATHEMATICS WORKSHOP

(NDA) - 1.00 UNITS Rpt 3

Corequisite: Math 113.

Students enroll in Math 100 section number 0227 must also enroll in Math 113 section number 0195. Students enrolled in Math section number 3131 must also enroll in Math 114 section number 3063.

0227 LAB 11:45-12:55 MTWTh Staff MATH CTR
(8 Week Class - Starts 6/11/2007, Ends 8/2/2007)

Evening Classes

3131 LAB 8:05 -9:15 MTWTh Staff MATH CTR
(8 Week Class - Starts 6/11/2007, Ends 8/2/2007)

105 - ARITHMETIC (NDA) - 3.00 UNITS

Prerequisite: Appropriate skill level demonstrated through the Mathematics assessment process, or by permit.

A review of elementary arithmetic.

0146 7:45-10:10 MTWTh Staff BUNG 1
(5 Week Class - Starts 6/11/2007, Ends 7/13/2007)
Mathematics 105 also offered through PACE. See page 33.

112 - PRE-ALGEBRA (NDA) - 3.00 UNITS

Prerequisite: Math 105 with grade of "C" or better, or appropriate skill level demonstrated through the Mathematics assessment process, or by permit.

0148 7:45-10:10 MTWTh Staff BUNG 3
(5 Week Class - Starts 6/11/2007, Ends 7/13/2007)
0149 1:15-3:40 MTWTh Staff BUNG 1
(5 Week Class - Starts 6/11/2007, Ends 7/13/2007)

Evening Classes

3015 7:30 -9:55 MTWTh Staff BUNG 2
(5 Week Class - Starts 6/11/2007, Ends 7/13/2007)
Mathematics 112 also offered through PACE. See page 33.

113 - ELEMENTARY ALGEBRA A - 3.00 UNITS

Prerequisite: Math 112 with a grade of "C" or better, or appropriate skill level demonstrated through the Mathematics assessment process, or by permit.

Corequisite: Math 100.

Students enrolled in Math 113 section number 0195 must also enroll in Math 100 section number 0227.

0195 9:40-11:30 MTWTh Staff MATH CTR
(8 Week Class - Starts 6/11/2007, Ends 8/2/2007)

114 - ELEMENTARY ALGEBRA B - 3.00 UNITS

Prerequisite: Math 113 with a grade of "C" or better, or appropriate skill level demonstrated through the Mathematics assessment process, or by permit.

Math 113 and 114 together are equivalent to Math 115.

Corequisite: Math 100.

Students enrolled in Math 114 section number 3063 must also enroll in Math 100 section number 3131.

Evening Classes

3063 6:00 -7:50 MTWTh Staff BUNG 5
(8 Week Class - Starts 6/11/2007, Ends 8/2/2007)

115 - ELEMENTARY ALGEBRA - 5.00 UNITS

Prerequisite: Math 112 with a grade of "C" or better, or appropriate skill level demonstrated through the Mathematics assessment process, or by permit.

Math 113 and 114 together are equivalent to Math 115.

All Mathematics 115 students are required to pass a comprehensive department final. Failure to take this examination at the Scheduled time and day will result in a score of zero. FINAL EXAMINATION WILL BE HELD ON THE LAST DAY OF CLASSES.

0147 10:00-12:55 MTWTh Staff BUNG 2
(8 Week Class - Starts 6/11/2007, Ends 8/2/2007)

Evening Classes

3014 7:00 -9:55 MTWTh Staff BUNG 3
(8 Week Class - Starts 6/11/2007, Ends 8/2/2007)
Math 115 also offered through PACE. See page 33.

125 - INTERMEDIATE ALGEBRA - 5.00 UNITS

Prerequisite: Math 115 or Math 114 with a grade of "C" or better, or appropriate skill level demonstrated through the Mathematics assessment process, or by permit.

0157 12:45-3:40 MTWTh Staff BUNG 3
(8 Week Class - Starts 6/11/2007, Ends 8/2/2007)

Evening Classes

3016 7:00 -9:55 MTWTh Staff BUNG 4
(8 Week Class - Starts 6/11/2007, Ends 8/2/2007)
Math 125 also offered through PACE. See page 33.
Math 125 also offered through ITV. See page 34.

215 - PRINCIPLES OF MATHEMATICS I

(UC:CSU) - 3.00 UNITS

Prerequisite: Math 125 and Math 120 or Math 125 and Math 121 with a grade of "C" or better, or appropriate skill level demonstrated through the Mathematics assessment process, or by permit.

Primarily for students who plan to teach arithmetic in elementary schools.

Evening Classes

3064 4:45 -7:10 M W F Staff BUNG 2
(5 Week Class - Starts 6/11/2007, Ends 7/13/2007)



26 SUMMER 2007 Schedule OF CLASSES

227 - STATISTICS (UC:CSU) - 4.00 UNITS

Prerequisite: Math 125 with a grade of "C" or better, or appropriate skill level demonstrated through the Mathematics assessment process, or by permit.

Equivalent to Math 225 with an additional hour of laboratory.

0229 9:10-12:45 MTWTh Staff BUNG 4

(5 Week Class - Starts 6/11/2007, Ends 7/13/2007)

Evening Classes

3065 3:25-7:10 MTWTh Staff MATH CTR

(5 Week Class - Starts 6/11/2007, Ends 7/13/2007)

Mathematics 227 also offered through PACE. See page 33.

240 - TRIGONOMETRY (CSU) - 3.00 UNITS

Prerequisite: Math 125 and Math 120 or Math 125 and Math 121 with a grade of "C" or better, or appropriate skill level demonstrated through the Mathematics assessment process, or by permit.

0163 7:45-10:10 MTWTh Staff BUNG 5

(5 Week Class - Starts 6/11/2007, Ends 7/13/2007)

245 - COLLEGE ALGEBRA (UC:CSU) - 3.00 UNITS

Prerequisite: Math 125 with a grade of "C" or better, or appropriate skill level demonstrated through the Mathematics assessment process, or by permit.

0194 10:30-12:55 MTWTh Staff BUNG 5

(5 Week Class - Starts 6/11/2007, Ends 7/13/2007)

265 - CALCULUS WITH ANALYTIC GEOMETRY I

(UC:CSU) - 5.00 UNITS

Prerequisite: Math 260, or Math 240 and 245 with a grade of "C" or better, or appropriate skill level demonstrated through the Mathematics assessment process, or by permit.

Graphic calculators recommended.

0231 10:00-12:55 MTWTh Staff BUNG 6

(8 Week Class - Starts 6/11/2007, Ends 8/2/2007)

MULTIMEDIA Arts, Health & Physical Education

100 - INTRODUCTION TO MULTIMEDIA

COMPUTER APPLICATIONS - 3.00 UNITS Rpt 3

(Photoshop and Illustrator)

Prerequisite: None.

Printing Fee \$10.00.

Evening Classes

3308 LEC 6:00-7:55 MTWTh Cole, D LRC 233

AND LAB 8:00-9:50 MTWTh Cole, D LRC 233

(5 Week Class - Starts 6/11/2007, Ends 7/13/2007)

320 - WEB DESIGN - 3.00 UNITS Rpt 3

(Dreamweaver and Flash)

Prerequisite: None.

0187 LEC 12:00-1:55 MTWTh Stage, C LRC 233

AND LAB 2:00-3:50 MTWTh Stage, C LRC 233

(5 Week Class - Starts 6/11/2007, Ends 7/13/2007)

500 - MULTIMEDIA LABORATORY

1.00 UNIT Rpt 3

Evening Classes

3309 LAB 4:00-5:50 MTWTh Stage, C LRC 233

(5 Week Class - Starts 6/11/2007, Ends 7/13/2007)

MUSIC Arts, Health & Physical Education

111 - MUSIC APPRECIATION I

(UC:CSU) - 3.00 UNITS

Prerequisite: None.

Introduction to musical works from a variety of styles and periods, how to listen to music effectively and with comprehension.

Evening Classes

6101 7:30-9:55 MTWTh Foster, D CAC 6

(5 Week Class - Starts 6/11/2007, Ends 7/13/2007)

921 - COOPERATIVE EDUCATION - MUSIC

2.00 UNITS Rpt 3

9053 3:50 hrs TBA Raskin, E S Schedule

(10 Week Class - Starts 6/11/2007, Ends 8/17/2007)

931 - COOPERATIVE EDUCATION - MUSIC

3.00 UNITS Rpt 3

9054 5:50 hrs TBA Raskin, E S Schedule

(10 Week Class - Starts 6/11/2007, Ends 8/17/2007)

941 - COOPERATIVE EDUCATION - MUSIC

4.00 UNITS Rpt 3

Supervised training is conducted in the form of on-the-job training in an employment area that will enhance the student's educational goals.

9055 7:50 hrs TBA Raskin, E S Schedule

(10 Week Class - Starts 6/11/2007, Ends 8/17/2007)



OCEANOGRAPHY

Natural Sciences

Faculty Advisor: Lorraine Manoogian - 818.364.7706

001 - INTRODUCTION TO OCEANOGRAPHY

(UC:CSU) - 3.00 UNITS

Prerequisite: None.

An introduction to Oceanography. Topics include the formation and the evolution of the sea floor, islands, coastlines, properties of seawater, motions of the sea (waves, tides and currents) and marine life. Specific reference is made to the Southern California coast.

Evening Classes

3056 4:45 -7:10 MTWTh Rogers, H INST 1013

(5 Week Class - Starts 6/11/2007, Ends 7/13/2007)

Oceanography 1 also offered through ITV. See page 34.

PHILOSOPHY

Social Sciences

Faculty Advisor: Mark Pursley - 818.364.7677

001 - INTRODUCTION TO PHILOSOPHY

(UC:CSU) - 3.00 UNITS

Prerequisite: None.

A survey of fundamental questions about self, society, and the universe. Primary focus on theories of reality, knowledge, and religion.

0153 10:30-12:55 MTWTh Pursley, M CSB 105

(5 Week Class - Starts 6/11/2007, Ends 7/13/2007)

Philosophy 1 also offered through ITV. See page 34.

006 - LOGIC IN PRACTICE (UC:CSU) - 3.00 UNITS

Prerequisite: None.

Introduces skills of argument identification and evaluation. Students will learn to classify arguments as inductive or deductive and acquire techniques for recognizing valid deductive and strong inductive reasoning. Stresses the application of critical thinking skills to social and political discourses.

All sections may be taken for honors credit. See the Honors counselor.

Web page: www.Internetlogic.org

Evening Classes

3072 4:45 -7:10 MTWTh O Connor, B CSB 105

(5 Week Class - Starts 6/11/2007, Ends 7/13/2007)

Philosophy 6 is also offered through PACE. See page 33.

033 - COMPARATIVE SURVEY OF

WORLD RELIGIONS (UC:CSU) - 3.00 UNITS

Prerequisite: None.

History, practices, and world views of the major religions originating in India, China, Japan, and the Near East.

This section may be taken for honors credit. See the Honors counselor.

Evening Classes

6510 LEC 6:00 -8:00 W Staff CMPC 5

AND LEC 10:00 -12:00 S Staff CMPC 5

AND LEC 2:00 hrs TBA Staff CMPC 5

(9 Week Class - Starts 6/11/2007, Ends 8/11/2007)

Philosophy 33 is offered through PACE. See page 33.

PHYSICAL EDUCATION

Arts, Health & Physical Education

295 - INDIVIDUAL AND DUAL ACTIVITIES -

ADAPTIVE ACTIVITIES (UC:CSU) - 1.00 UNITS Rpt 3

Prerequisite: None.

2026 LAB 10:30-11:50 MTWTh Edwards, K FOOT 103

Geared toward the disabled students.

(5 Week Class - Starts 6/11/2007, Ends 7/13/2007)

552 - ATHLETICS PRE-SEASON CONDITIONING

(UC:CSU) - 1.00 UNITS Rpt 3

Prerequisite: None.

This course is designed to improve and maintain the fitness condition of the athlete in preparation for the competitive season of play. It encompasses the mental aspects of sport performance, sport regulation and eligibility standards.

2027 LAB 6:00 hrs TBA Madha, E FOOT 103

SOCCER, MEN

(10 Week Class - Starts 6/11/2007, Ends 8/17/2007)

2028 LAB 6:00 hrs TBA Martins, E FOOT 103

SOCCER, WOMEN

(10 Week Class - Starts 6/11/2007, Ends 8/17/2007)

666 - BODY CONDITIONING

(UC:CSU) - 1.00 UNITS Rpt 3

Prerequisite: None.

The class will include various aerobic activities to enhance cardiovascular conditioning. Weight resistance exercises and stretching exercises will be include to develop muscle strength, endurance, and flexibility. Training principles and concepts along with nutritional information will be introduced.

2029 LAB 7:45-10:10 MTWTh Staff FOOT 103

EMPHASIS ON SELF DEFENSE SKILLS

(5 Week Class - Starts 6/11/2007, Ends 7/13/2007)

Evening Classes

2925 LAB 4:45 -7:10 MTWTh Staff ELCPARK

EMPHASIS ON POWER WALKING

(5 Week Class - Starts 6/11/2007, Ends 7/13/2007)

690 - WEIGHT TRAINING

(UC:CSU) - 1.00 UNIT Rpt 3

Prerequisite: None.

Weight Training and Conditioning includes progressive resistance exercises. There is an emphasis on the knowledge, understanding and values of building muscle strength and endurance. Students will develop their own physical fitness program based upon sound physiological principles.

Evening Classes

2926 LAB 7:30-9:55 MTWTh Staff FOOT 103
(5 Week Class - Starts 6/11/2007, Ends 7/13/2007)

PHYSICAL SCIENCE
Natural Sciences

Faculty Advisor: Said Pazirandeh - 818.364.7705

001 - PHYSICAL SCIENCE I (UC:CSU) - 3.00 UNITS

Prerequisite: None.

Advisory: Math 115.

Equivalent to CSUN Physical Science 170.

Note: Physical Science 1 fulfills IGETC requirements in the Physical Sciences.

Recommended for students enrolled in the PRECREDENTIAL OPTION of the Liberal Studies Program.

(SEE MATCHING LABORATORY: PHYSICAL SCIENCE 14, SECTION #0219 BELOW.)

0218 10:30-12:55 MTWTh Pazirandeh,S INST2003
(5 Week Class - Starts 6/11/2007, Ends 7/13/2007)
Physical Science 1 also offered through PACE. See page 33.

014 - PHYSICAL SCIENCE LABORATORY

(UC:CSU) - 1.00 UNIT

Prerequisite or Corequisite: Physical Science 1.

Equivalent to CSUN Physical Science 170L.

Recommended for students enrolled in the PRECREDENTIAL OPTION of the Liberal Studies Program.

(SEE MATCHING LECTURE: PHYSICAL SCIENCE 1 SECTION #0218 ABOVE.)

0219 LAB 1:15-3:20 MTWTh Pazirandeh,S INST2012
(5 Week Class - Starts 6/11/2007, Ends 7/13/2007)



PHYSIOLOGY
Natural Sciences

Faculty Advisor: Michael Reynolds - 818.364.7695

001 - INTRODUCTION TO HUMAN PHYSIOLOGY

(UC:CSU) - 4.00 UNITS

Equivalent to CSUN Biology 281 & 282, CSULA Biology 200A & 200B (if completed Anatomy 1).

Prerequisite: Anatomy 1 with a grade of "C" or better.

Advisory: Chemistry 51 or 65 or 101 and English 28 or ESL 8.

This course involves the study of the function of the following human systems: integumentary, skeletal, muscular, nervous, circulatory, respiratory, digestive, urinary, endocrine, lymphatic, and reproductive.

Labs include hands-on applications.

Evening Classes

3053 LAB 5:25 -6:50 MTWTh Covitt, G INST 2018
AND LEC 7:00 -8:25 MTWTh Covitt, G CSB 208
(8 Week Class - Starts 6/11/2007, Ends 8/2/2007)

POLITICAL SCIENCE
Social Sciences

Faculty Advisor: Chuck Dirks - 818.364.7675

001 - THE GOVERNMENT OF THE UNITED STATES

(UC:CSU) - 3.00 UNITS

Prerequisite: None.

0134 7:45-10:10 MTWTh Dirks, C INST 1001
(5 Week Class - Starts 6/11/2007, Ends 7/13/2007)

0155 10:30-12:55 MTWTh Hussain, S INST 1001
(5 Week Class - Starts 6/11/2007, Ends 7/13/2007)

Evening Classes

3082 4:45 -7:10 MTWTh Dirks, C INST 1001
(5 Week Class - Starts 6/11/2007, Ends 7/13/2007)

3083 7:30 -9:55 MTWTh Ostrow, I INST 1001
(5 Week Class - Starts 6/11/2007, Ends 7/13/2007)

Political Science 1 also offered through ITV. See page 34.

921 - COOPERATIVE EDUCATION -

POLITICAL SCIENCE - 2.00 UNITS Rpt 3

9065 3:50 hrs TBA Raskin, E Schedule
(10 Week Class - Starts 6/11/2007, Ends 8/17/2007)

931 - COOPERATIVE EDUCATION -

POLITICAL SCIENCE - 3.00 UNITS Rpt 3

9066 5:50 hrs TBA Raskin, E Schedule
(10 Week Class - Starts 6/11/2007, Ends 8/17/2007)

941 - COOPERATIVE EDUCATION -

POLITICAL SCIENCE - 4.00 UNITS Rpt 3

Supervised training is conducted in the form of on-the-job training in an employment area that will enhance the student's educational goals.

9067 7:50 hrs TBA Raskin, E Schedule
(10 Week Class - Starts 6/11/2007, Ends 8/17/2007)

PSYCHOLOGY
Social Sciences

001 - GENERAL PSYCHOLOGY I

(UC:CSU) - 3.00 UNITS

Advisory: English 21 or ESL 6.

This introductory psychology course covers biological foundations of behavior, various theoretical perspectives including learning, personality, and intelligence theories as well as experimental and research methodology.

0135 7:45-10:10 MTWTh Staff INST 1002
(5 Week Class - Starts 6/11/2007, Ends 7/13/2007)

Evening Classes

3010 4:45-7:10 MTWTh Staff INST 1002

(5 Week Class - Starts 6/11/2007, Ends 7/13/2007)

Psychology 1 also offered through ITV. See page 34.

002 - GENERAL PSYCHOLOGY II

(UC:CSU) - 3.00 UNITS

Prerequisite: Psychology I with a grade of "C" or better.

Discusses nervous system as it applies to abnormal behavior.

Evening Classes

6502 LEC 6:00-8:00 Th Staff CMPC 1

AND LEC 10:00-12:00 S Staff CMPC 1

AND LEC 2:00 hrs TBA Staff CMPC 1

(9 Week Class - Starts 6/11/2007, Ends 8/11/2007)

Psychology 2 offered through PACE. See page 33.

921 - COOPERATIVE EDUCATION - PSYCHOLOGY

2.00 UNITS Rpt 3

9069 3:50 hrs TBA Raskin, E Schedule

(10 Week Class - Starts 6/11/2007, Ends 8/17/2007)

931 - COOPERATIVE EDUCATION - PSYCHOLOGY

3.00 UNITS Rpt 3

9070 5:50 hrs TBA Raskin, E Schedule

(10 Week Class - Starts 6/11/2007, Ends 8/17/2007)

941 - COOPERATIVE EDUCATION - PSYCHOLOGY

4.00 UNITS Rpt 3

Supervised training is conducted in the form of on-the-job training in an employment area that will enhance the student's educational goals.

9071 7:50 hrs TBA Raskin, E Schedule

(10 Week Class - Starts 6/11/2007, Ends 8/17/2007)

SOCIOLOGY
Social Sciences

Faculty Advisor: Myriam Mekelburg - 818.833.3414

001 - INTRODUCTION TO SOCIOLOGY

(UC:CSU) - 3.00 UNITS

Prerequisite: None.

Develops the sociological perspective that behavior is largely determined by human interactions and by membership in groups.

All sections may be taken for honors credit. See the Honors Counselor.

0109	10:30 hrs	TBA	Biondo, J	Internet
Email: JillB9191@yahoo.com				
(5 Week Class - Starts 6/11/2007, Ends 7/13/2007)				

0132 10:30-12:55 MTWTh Layne, V INST 2004

(5 Week Class - Starts 6/11/2007, Ends 7/13/2007)

Sociology 1 also offered through ITV. See page 34.

Sociology 1 offered through PACE. See page 33.

002 - AMERICAN SOCIAL PROBLEMS

(UC:CSU) - 3.00 UNITS

Prerequisite: None.

Analysis of personal and social disorganization, crime and delinquency, race and ethnic relations, population and urban growth, and individual and societal rights.

0206	10:30 hrs	TBA	Biondo, J	Internet
Email: JillB9191@yahoo.com				
(5 Week Class - Starts 6/11/2007, Ends 7/13/2007)				

921 - COOPERATIVE EDUCATION - SOCIOLOGY

2.00 UNITS Rpt 3

9081 3:50 hrs TBA Raskin, E Schedule

(10 Week Class - Starts 6/11/2007, Ends 8/17/2007)

931 - COOPERATIVE EDUCATION - SOCIOLOGY

3.00 UNITS Rpt 3

9082 5:50 hrs TBA Raskin, E Schedule

(10 Week Class - Starts 6/11/2007, Ends 8/17/2007)

941 - COOPERATIVE EDUCATION - SOCIOLOGY

4.00 UNITS Rpt 3

Prerequisite: Employment in a field related to the student's major as verified by the signature of the Cooperative Education Advisor.

Supervised training is conducted in the form of on-the-job training in an employment area that will enhance the student's educational goals.

9083 7:50 hrs TBA Raskin, E Schedule

(10 Week Class - Starts 6/11/2007, Ends 8/17/2007)

Session A

S *PANISH*
*Foreign Languages***001 - ELEMENTARY SPANISH I**

(UC:CSU) - 5.00 UNITS

Prerequisite: None.0175 12:35-3:40 MTWTh Pardess, D INST 1005
(7 Week Class - Starts 6/11/2007, Ends 7/27/2007)**Evening Classes****3112 6:50-9:55 MTWTh RamiL, Y INST 1005**

(7 Week Class - Starts 6/11/2007, Ends 7/27/2007)

S *SPEECH COMMUNICATION*
Social Sciences

Faculty Advisor: Margie Long - 818.364.7682

101 - ORAL COMMUNICATION I

(UC:CSU) - 3.00 UNITS

Prerequisite: None.

This introductory speech course emphasizes the techniques of public speaking including the delivery of speeches to inform, persuade, and activate. In this course you will refine your critical thinking, research, organizational, and time management skills. You will learn how to organize and adapt your message to any audience.

0137 7:45-10:10 MTWTh Long, M INST 1012
(5 Week Class - Starts 6/11/2007, Ends 7/13/2007)0138 10:30-12:55 MTWTh Long, M INST 1012
(5 Week Class - Starts 6/11/2007, Ends 7/13/2007)

Speech 101 is also offered through PACE. See page 33.

921 - COOPERATIVE EDUCATION -**SPEECH COMMUNICATION** - 2.00 UNITS Rpt 39085 3:50 hrs TBA Raskin, E Schedule
(10 Week Class - Starts 6/11/2007, Ends 8/17/2007)**931 - COOPERATIVE EDUCATION -****SPEECH COMMUNICATION** - 3.00 UNITS Rpt 39086 5:50 hrs TBA Raskin, E Schedule
(10 Week Class - Starts 6/11/2007, Ends 8/17/2007)**941 - COOPERATIVE EDUCATION -****SPEECH COMMUNICATION** - 4.00 UNITS Rpt 3

Supervised training is conducted in the form on-the-job training in an employment area that will enhance the student's educational goals.

9087 7:50 hrs TBA Raskin, E S Schedule
(10 Week Class - Starts 6/11/2007, Ends 8/17/2007)**S** *SUPERVISED LEARNING ASSISTANCE*
*Learning Assistance***001T - SUPERVISED LEARNING ASSISTANCE**

(NDA) - 0.00 UNITS Rpt 9

Upon instructor referral, students will receive tutoring in the LAC. It is a non-credit, open-exit course which is non-graded and will not appear on student transcripts.

8950 20:00 hrs TBA Staff Schedule

(5 Week Class - Starts 6/11/2007, Ends 7/13/2007)

8951 20:00 hrs TBA Staff Schedule

(5 Week Class - Starts 6/11/2007, Ends 7/13/2007)



ONLINE CLASSES - Session A

Welcome to Online and Hybrid Classes!

1

Find your Class

To get to your online class, follow these steps:

1. Go first to the main College webpage -

<http://www.lamission.edu>

2. Click on "online classes"

http://www.lamission.edu/online_classes.html

3. If it is an etudes class - locate your class -

<http://missionclasses.pbwiki.com> and then contact your instructor -

http://www.lamission.edu/etudes_faculty.html

4. If it is a WebCT or other type of online class - locate your class -

and then contact your instructor at their faculty webpage -

http://www.lamission.edu/faculty_webpages.html

5. If you are having problems logging in - make certain you are registered for the class -

go to the Student Information System -

http://www.laccd.edu/student_information/sis_logon.asp

2

Log in to your class

edute classes are located at <http://lamc.etudes.fhda.edu>

A. Determine your Username:

The username is the first 2 letters of the first name + the first 2 letters of the last name + last 5 digits of the SIN (all lower case).

Example: Jose A. Garcia
SIN# 111-22-3333

Username: joga23333

B. Determine your Password:

The password is: Month+Day of birth (in school records).

Example: January 11
Password: 0111

3

See if you are ready for an online class

Take this sample online assessment to see if you are ready-

<http://www.alt.usg.edu/sort>

This information is located at -

<http://missiononline.pbwiki.com>

BUSINESS *Business & Law*

001 - INTRODUCTION TO BUSINESS

(UC:CSU) - 3.00 UNITS

Prerequisite: None.

The student will learn the various forms of business organizations. The student will study business management, organization, financing and marketing, and also become acquainted with the risks involved in business and with government's role in business.

Hybrid Class

3018 LEC 4:45-7:10 MW Bernal, V CSB 205

AND LEC 5:35 hrs TBA Bernal, V Internet

Web page: www.lamission.edu/business/bernal

(5 Week Class - Starts 6/11/2007, Ends 7/13/2007)

BUSINESS - MANAGEMENT *Business & Law*

013 - SMALL BUSINESS ENTREPRENEURSHIP

(CSU) - 3.00 UNITS

Prerequisite: None.

This course presents a systematic approach to successful small business operation.

Hybrid Class. Meeting dates: 6/11-7/12/2007.

Evening Classes

3101 LEC 7:30 -9:55 M W Bernal, V CSB 207

AND LEC 4:15 hrs TBA Bernal, V Internet

Web page: www.lamission.org

(6 Week Class - Starts 6/11/2007, Ends 7/17/2007)

CHICANO STUDIES *Foreign Languages & Chicano Studies*

007 - THE MEXICAN-AMERICAN IN THE HISTORY OF THE UNITED STATES I (UC:CSU) - 3.00 UNITS

Prerequisite: None.

Traces the historical evolution of the Mexican- American to 1850.

0168 10:30 hrs TBA Maldonado, J Internet

Email: maldonja@lamission.edu

(5 Week Class - Starts 6/11/2007, Ends 7/13/2007)

ONLINE CLASSES - Session A

037 - CHICANO LITERATURE

(UC:CSU) - 3.00 UNITS

Prerequisite: None.

0173 10:30 hrs TBA Maldonado, J Internet
 Email: maldonja@lission.edu
 (5 Week Class - Starts 6/11/2007, Ends 7/13/2007)

FOOD SERVICE MANAGEMENT *Professional Studies*

Faculty Advisor: Eloise F. Cantrell - 818.364.7625

050 - SANITATION AND SAFETY

(CSU) - 3.00 UNITS

Prerequisite: None.

0184 9:00 hrs TBA Struwe, K Internet
 Email: kurtstruwe@sbcglobal.net
 (6 Week Class - Starts 6/13/2007, Ends 7/24/2007)

LAW *Business & Law*

001 - BUSINESS LAW I (UC:CSU) - 3.00 UNITS

Prerequisite: None.

Same as Business 5.

Introductory course in civil law open to all students.

0127 10:30 hrs TBA Kellogg, C Internet
 Web page: www.lamission.edu/law
 (5 Week Class - Starts 6/11/2007, Ends 7/13/2007)

002 - BUSINESS LAW II (UC:CSU) - 3.00 UNITS

Prerequisite: None.

Same as Business 6.

Second part of the civil law course, including bailment, principles of agency, third parties, partnerships, corporation, stockholders, and legal aspects of negotiable instruments.

This class may be taken for honors credit. See the Honors Counselor.

0167 10:30 hrs TBA Morinaka, B Internet
 Web page: www.lamission.edu/law
 (5 Week Class - Starts 6/11/2007, Ends 7/13/2007)

011 - INTRODUCTION TO LEGAL ASSISTANT II

(CSU) - 3.00 UNITS

Prerequisite: None.

A detailed exination of civil and criminal cases, and an introduction to drafting and writing.

0107 10:30 hrs TBA Jordan, D Internet
 Web page: www.lamission.edu/law
 (5 Week Class - Starts 6/11/2007, Ends 7/13/2007)

019 - PROPERTY AND CREDITOR RIGHTS

3.00 UNITS

Prerequisite: None.

Laws protecting landowners, tenants, and creditors. Law 19 is a study of law of personal property and real property, and bankruptcy law and forms.

0170 IND 10:30 hrs TBA Jordan, D Internet
 Web page: www.lamission.edu/law
 (5 Week Class - Starts 6/11/2007, Ends 7/13/2007)

020 - BASIC PROBATE PROCEDURES

3.00 UNITS

Prerequisite: None.

Study of the fundamental principles and methods of fact gathering, office of both testate and intestate decedents, as well as the administration of estates in California Probate Courts.

0128 10:30 hrs TBA Lampert, E Internet
 Web page: www.lamission.edu/law
 (5 Week Class - Starts 6/11/2007, Ends 7/13/2007)

SOCIOLOGY *Social Sciences*

Faculty Advisor: Myriam Mekelburg - 818.833.3414

001 - INTRODUCTION TO SOCIOLOGY

(UC:CSU) - 3.00 UNITS

Prerequisite: None.

Develops the sociological perspective that behavior is largely determined by human interactions and by membership in groups.

All sections may be taken for honors credit. See the Honors Counselor.

0109 10:30 hrs TBA Biondo, J Internet
 Email: JillB9191@yahoo.com
 (5 Week Class - Starts 6/11/2007, Ends 7/13/2007)

002 - AMERICAN SOCIAL PROBLEMS

(UC:CSU) - 3.00 UNITS

Prerequisite: None.

Advisory: Soc 1.

Analysis of personal and social disorganization, crime and delinquency, race and ethnic relations, population and urban growth, and individual and societal rights.

0206 10:30 hrs TBA Biondo, J Internet
 Email: JillB9191@yahoo.com
 (5 Week Class - Starts 6/11/2007, Ends 7/13/2007)

Session A

LA Mission PACE Summer 2007

6/11- 8/11

Summer Orientation: Saturday, June 16, 8-9 AM CMPC 5 & 6

Regular PACE Saturdays: 6/23; 7/14; 7/28; 8/11 (Final exams)

Bridge Saturdays: 6/16; 7/7; 7/21; 8/4

Math 105,112,115, 125, and Biology 3 meet every Saturday.

6590	English 21	Monday 6-8 PM + Bridge Saturdays, 8-12	CMPC 5
6597	Dev Com 36A	Monday 8-10 PM + Bridge Saturdays 12:30-4:30	CMPC 5
6591	English 28	No Monday sessions, internet + Bridge Saturdays, 8-12	CMPC 2
6592	English 101	Monday 6-8 PM + Bridge Saturdays, 8-12	CMPC 1
6593	Math 105	Monday 8-10 PM Saturdays 12:30-4:30	CMPC 1
6594	Math 112	Monday 8-10 PM Saturdays 12:30-4:30	CMPC 2
6595	Math 115	Monday 8-10 PM, Wed. 6-10 PM, Saturday 12:30-4:30	CMPC 6
6596	Math 125	Monday 8-10 PM, Wed. 6-10 PM, Saturday 12:30-4:30	INST 1010
6598	Math 227	Monday and Wednesday 6-10 PM	INST 2020

Regular PACE Saturdays: 6/23; 7/14; 7/28; 8/11 (Final exams)

Tuesday Business

6500	Economics 2	6-8 PM Tues., 8-12 Regular PACE Saturdays	CMPC 2
6501	Business 32	No Tuesday meetings, internet + 12:30-4:30 PACE Saturdays	CMPC 1

Tuesday/Thursday Elementary Teaching

6506	Biology 3	Tues. 5:25-10:10 PM, Th. 5:25-7:15 PM Saturdays 7:45 AM- 12:30 PM	INST 2018, 2019
6507	Biology 3	Tues. 5:25-7:15 PM Thurs. 5:25-10:10 PM, Saturdays 10:40 AM- 3:35 PM	INST 2018, 2019

Wednesday Health Science

6504	Speech 101	Wed 6-8 PM, 8-12 Regular PACE Saturdays	CMPC 2
6505	Humanities 3	Wed 8-10 PM, 12:30-4:30 Regular PACE Saturdays	CMPC 2

Wednesday General Studies

6510	Philosophy 33	Wed 6-8 PM, 8-12 Regular PACE Saturdays	CMPC 5
6511	Art 103	Wed 8-10 PM, 12:30-4:30 Regular PACE Saturdays	CMPC 5

Thursday Social Science

6502	Psychology 2	6-8 PM, 8-12 Regular PACE Saturdays	CMPC 5
6503	Sociology 1	8-10 PM, 12:30-4:30 Regular PACE Saturdays	CMPC 5
6599	Philosophy 6	5 day format: Friday June 8, 6-10 PM; M Pursley Sat. June 9, 8 AM – 5 PM; Sunday June 10, 8 AM- 5 PM; Friday June 15, 6-10 PM; Sunday June 24, 8 AM- 5 PM.	CMPC 5 & 6

All LAMC students may enroll in PACE! PACE PICNIC 7/28, 11-1!

PACE was designed to offer convenient course scheduling for busy people.

PACE students may take two classes at a time for an eight week session.

PACE is fully accredited and all courses are transferable to CSU and UC.

All Los Angeles Mission College students may enroll in PACE courses.



The Weekend College

SUMMER 2007

ITV/The Instructional Television classes allow students to complete general education classes in a focused eight-week format. Classes are taught on four campuses: **City [C]** and **Southwest [SW]** Colleges on Saturdays and **Valley [V]** and **Pierce [P]** Colleges on Sundays. First college listed is **AM only 9:00 - 12:00 Noon**. Second college listed is **PM only 1:30 - 4:30 PM**. Students may attend at any location or change locations, if necessary, throughout the semester.

The classes are taught by the same qualified LACCD instructor at each campus. Instruction is combined with award-winning video lessons available on cable television, in broadband, in DVD, and in the College Learning Resource Centers. Each class also has an online component creating a positive, engaging learning environment.

For classroom locations go to: www.lamission.edu/itv View Schedule. Financial Aid is available for qualified students; fee waivers apply to these classes. Transcripts are issued by LA Mission College.

June 18 - August 12, 2007 **8 Weeks**
Class Meetings: Saturdays: June 23 - Aug.11
 Sunday: June 24 - Aug.12

Classes	Section	Campus	Campus
Economics 1	7877	C/SW	P/V
English 101	7878	C/SW	P/V
Health 11	7879	C/SW	P/V
History 1	7880	C/SW	P/V
History 11	7881	C/SW	P/V
Mathematics 125	7882	C/SW	P/V
Oceanography 1	7883	SW/C	V/P
Philosophy 1	7884	SW/C	V/P
Political Science 1	7885	SW/C	V/P
Psychology 1	7886	SW/C	V/P
Psychology 41	7887	SW/C	V/P
Sociology 1	7888	SW/C	V/P

Last Day To: ADD by STEP or on-line: **June 17, 2007**
Last Day To: ADD by FAX (818) 833-3598
 or in-person: **June 29, 2007**
Last Day To: DROP without incurring fees: **June 25, 2007**

Website: www.lamission.edu/itv • **Telephone:** 818/833-3594 or 800/917-9277



ADMINISTRATION OF JUSTICE

Business & Law

001 - INTRODUCTION TO ADMINISTRATION OF JUSTICE (UC:CSU) - 3.00 UNITS

Prerequisite: None.

The history and philosophy of administration of justice including the various subsystems---police, courts, corrections, etc.

Evening Classes

3046 4:45 -7:10 MTWTh Staff INST 1001
(5 Week Class - Starts 7/16/2007, Ends 8/17/2007)

004 - PRINCIPLES AND PROCEDURES OF THE JUSTICE SYSTEM (UC:CSU) - 3.00 UNITS

Prerequisite: None.

A study of the various agencies in the criminal justice arena.

Evening Classes

3049 7:30 -9:55 MTWTh Staff INST 1012
(5 Week Class - Starts 7/16/2007, Ends 8/17/2007)

006 - PATROL PROCEDURES - 3.00 UNITS

Prerequisite: None.

Principles and procedures of patrol activities.

Evening Classes

3047 7:30 -9:55 MTWTh Staff INST 1017
(5 Week Class - Starts 7/16/2007, Ends 8/17/2007)

014 - REPORT WRITING FOR PEACE OFFICERS (CSU) - 3.00 UNITS

Prerequisite: None.

The study of effective report writing in police work including crime scene investigative reports and arrest reports.

Evening Classes

3048 4:45 -7:10 MTWTh Staff INST 2004
(5 Week Class - Starts 7/16/2007, Ends 8/17/2007)

075 - INTRODUCTION TO CORRECTIONS 3.00 UNITS

Prerequisite: None.

Basic course dealing with the nature of correctional systems and corrections work.

Evening Classes

3050 7:30 -9:55 MTWTh Staff INST 2006
(5 Week Class - Starts 7/16/2007, Ends 8/17/2007)

ANTHROPOLOGY

Natural Sciences

Faculty Advisor: Arthur Gribben - 818.364.7600 x4235

101 - HUMAN BIOLOGICAL EVOLUTION (UC:CSU) - 3.00 UNITS

Advisory: English 28 or ESL 8.

0220 10:30 -12:55 MTWTh Gribben, A INST 1015
(5 Week Class - Starts 7/16/2007, Ends 8/17/2007)

Evening Classes

3059 4:45 -7:10 MTWTh Staff INST 1015
(5 Week Class - Starts 7/16/2007, Ends 8/17/2007)

121 - ANTHROPOLOGY OF RELIGION, MAGIC AND WITCHCRAFT (UC:CSU) - 3.00 UNITS

Prerequisite: None.

0221 7:45 -10:10 MTWTh Gribben, A INST 1015
(5 Week Class - Starts 7/16/2007, Ends 8/17/2007)

Evening Classes

3060 7:30 -9:55 MTWTh Staff INST 1015
(5 Week Class - Starts 7/16/2007, Ends 8/17/2007)

ART

Arts, Health & Physical Education

103 - ART APPRECIATION I (UC:CSU) - 3.00 UNITS

Prerequisite: None.

Advisory: English 21.

This class is an introductory course that involves the students in an exploration into the nature and appreciation of the visual arts.

All sections may be taken for honors credit. See the Honors Counselor.

Evening Classes

3006 4:45-7:10 MTWTh Ruppel, B CSB 207
(5 Week Class - Starts 7/16/2007, Ends 8/17/2007)
Art 103 also offered through PACE. See page 33.

300 - INTRODUCTION TO PAINTING (UC:CSU) - 3.00 UNITS

Prerequisite: None.

This is an introductory course in painting, utilizing historical and contemporary styles of painting. Emphasis is placed on color theory, composition and the application of fundamental painting techniques.

Part of Multimedia Studies Foundation I Block.
Required of Art Majors.

7113 LEC 1:15-2:50 MTWTh Kerwin, B CAC 2&3
AND LAB 2:55-4:30 MTWTh Kerwin, B CAC 2&3
(5 Week Class - Starts 7/16/2007, Ends 8/17/2007)

36 SUMMER 2007 Schedule OF CLASSES

304 - ACRYLIC PAINTING I (UC:CSU) - 3.00 UNITS

Prerequisite: Art 300 with a grade of "C" or better.

A course further exploring techniques learned in Art 300 and introducing personal style through a series of exploration.

7152 LEC 1:15-2:50 MTWTh Kerwin, B CAC 2&3

AND LAB 2:55-4:30 MTWTh Kerwin, B CAC 2&3

5 Week Class - Starts 7/16/2007, Ends 8/17/2007)

BIOLOGY *Natural Sciences*

Faculty Advisor: Mike Reynolds - 818.364.7695

033 - MEDICAL TERMINOLOGY - 3.00 UNITS

Prerequisite: None.

Medical terms related to the structure and function of the human body in health and disease.

Evening Classes

3061 7:30-9:55 MTWTh Ebnesahidi, A INST 2003

(5 Week Class - Starts 7/16/2007, Ends 8/17/2007)

BUSINESS *Business & Law*

001 - INTRODUCTION TO BUSINESS

(UC:CSU) - 3.00 UNITS

Prerequisite: None.

The student will learn the various forms of business organizations. The student will study business management, organization, financing and marketing, and also become acquainted with the risks involved in business and with government's role in business.

0215 10:30 hrs TBA Bernal, V Internet

Web page: www.lamission.edu/business/bernal

(5 Week Class - Starts 7/16/2007, Ends 8/17/2007)

Evening Classes

3052 4:45-7:10 MTWTh Rush, C INST 2006

(5 Week Class - Starts 7/16/2007, Ends 8/17/2007)

005 - BUSINESS LAW I (UC:CSU) - 3.00 UNITS

Prerequisite: None.

Same as Law 1.

0214 10:30-12:55 MTWTh Rush, C INST 2006

(5 Week Class - Starts 7/16/2007, Ends 8/17/2007)

BUSINESS - ECONOMICS *Business & Law*

001 - PRINCIPLES OF ECONOMICS I

(UC:CSU) - 3.00 UNITS

Prerequisite: None.

This class may be taken for honors credit. See the Honors Counselor.

0209 10:30-12:55 MTWTh Staff CSB 111

(5 Week Class - Starts 7/16/2007, Ends 8/17/2007)

Economics 1 also offered through ITV. See page 34.

002 - PRINCIPLES OF ECONOMICS II

(UC:CSU) - 3.00 UNITS

Prerequisite: None.

This class may be taken for honors credit. See the Honors Counselor.

0211 1:15-3:40 MTWTh Staff INST 2006

(5 Week Class - Starts 7/16/2007, Ends 8/17/2007)

Economics 2 also offered through PACE. See page 33.

BUSINESS - MARKETING *Business & Law*

021 - PRINCIPLES OF MARKETING - 3.00 UNITS

Prerequisite: None.

Emphasized how concepts and principles of marketing are applied from a marketing manager perspective in selecting an attractive target market.

0242 10:30 hrs TBA Bernal, V Internet

Web page: www.lamission.edu/business/bernal

(5 Week Class - Starts 7/16/2007, Ends 8/17/2007)

CHEMISTRY *Natural Sciences*

Faculty Advisor: Said Pazirandeh - 818.364.7705

051 - FUNDAMENTALS OF CHEMISTRY I

(UC:CSU) - 5.00 UNITS

Prerequisite: Math 115 with a grade of "C" or better, or appropriate Math placement results.

Equivalent to CSUN Chem 103 or 105.

This course is intended for nursing, nutrition, dietetics, food science, and environmental and occupational health majors. It provides an introduction to chemistry for the student with no previous background in chemistry.

Note: Not open for credit to students who have credit in Chem 101.

0222 LEC 8:00-10:35 MTWThF Pazirandeh, S INST 2003

AND LAB 10:40-1:05 MTWThF Pazirandeh, S INST 2012

(5 Week Class - Starts 7/16/2007, Ends 8/17/2007)

CHICANO STUDIES

Foreign Languages & Chicano Studies

007 - THE MEXICAN-AMERICAN IN THE HISTORY OF THE UNITED STATES I (UC:CSU) - 3.00 UNITS

Prerequisite: None.

Traces the historical evolution of the Mexican- American to 1850.

0200	10:30 hrs	TBA	Morales, J	Internet
Email: moralej@lamission.edu				
(6 Week Class - Starts 7/16/2007, Ends 8/17/2007)				

Evening Classes

6158 3:30-7:00 MTWTh Camacho, J SFDO HS
(5 Week Class - Starts 7/16/2007, Ends 8/17/2007)

008 - THE MEXICAN-AMERICAN IN THE HISTORY OF THE UNITED STATES II (UC:CSU) - 3.00 UNITS

Prerequisite: None.

This class may be taken for honors credit. See the Honors Counselor.

Evening Classes

3008 7:30-9:55 MTWTh Maldonado, J CSB 203
(5 Week Class - Starts 7/16/2007, Ends 8/17/2007)

037 - CHICANO LITERATURE

(UC:CSU) - 3.00 UNITS

Prerequisite: None.

0176	10:30 hrs	TBA	Gutierrez, E	Internet
Email: gutiereo@lmission.edu				
(5 Week Class - Starts 7/16/2007, Ends 8/17/2007)				

CHILD DEVELOPMENT

Professional Studies

001 - CHILD GROWTH AND DEVELOPMENT

(UC:CSU) - 3.00 UNITS

Prerequisite: None.

Covers the development of a child from the prenatal stage through adolescence.

0119	1:15-3:40	MTWTh	Ruelas, J	CSB 102A
Taught bilingually (English/ Spanish).				
(5 Week Class - Starts 7/16/2007, Ends 8/17/2007)				

004 - CREATIVE EXPERIENCES FOR CHILDREN II

3.00 UNITS

Advisory: Child Dev 1 and 2.

Language Arts, Math, Social Studies, Science, perceptual motor development and cooking.

Evening Classes

3003 4:45-7:10 MTWTh Ruelas, J CSB 102A
Taught bilingually (English/Spanish).
(5 Week Class - Starts 7/16/2007, Ends 8/17/2007)

011 - HOME, SCHOOL, AND COMMUNITY

RELATIONS (CSU) - 3.00 UNITS

Prerequisite: None.

Changes in families and schools, parent conferencing and community resources.

0129	10:30-12:55	MTWTh	Silver, J	CSB 102B
(5 Week Class - Starts 7/16/2007, Ends 8/17/2007)				

030 - INFANT AND TODDLER STUDIES I

3.00 UNITS

Prerequisite: None.

Required by the state for those who work with infants.

Evening Classes

3004 7:30-9:55 MTWTh Staff CSB 102A
(5 Week Class - Starts 7/16/2007, Ends 8/17/2007)

044 - PROGRAMS FOR CHILDREN WITH

SPECIAL NEEDS I - 3.00 UNITS

Prerequisite: None.

Evening Classes

3005 4:45-7:10 MTWTh Wada, J CSB 102B
(5 Week Class - Starts 7/16/2007, Ends 8/17/2007)

CINEMA

Arts, Health & Physical Education

003 - HISTORY OF MOTION PICTURES

(UC:CSU) - 3.00 UNITS

Prerequisite: None.

This course includes history of the development of motion pictures, with examples screened from the silent film to the present day. Emphasis is placed on American feature films.

All sections may be taken for honors credit. See the Honors Counselor.

0106 LEC	1:15-2:50	MTWTh	Staff	LRC TCR
AND LAB	2:50-4:25	MTWTh	Staff	LRC TCR
(5 Week Class - Starts 7/16/2007, Ends 8/17/2007)				

COMPUTER APPLICATIONS

Office Technology
Business & Law

001 - COMPUTER KEYBOARDING I - 3.00 UNITS

Students will develop basic keyboarding skills on the computer using Microsoft Word.

7051 LEC	10:30-12:55	MTWTh	Woodmansee, J	INST201
AND LAB	1:15-2:20	MTWTh	Woodmansee, J	INST201
(5 Week Class - Starts 7/16/2007, Ends 8/17/2007)				

076 - KEYBOARDING FOR DATA PROCESSING

1.00 UNIT

Keyboarding to improve input speed.

7053 LAB 2:25-3:45 MTWTh Woodmansee, J INST2021

(5 Week Class - Starts 7/16/2007, Ends 8/17/2007)

COMPUTER SCIENCE
INFORMATION TECHNOLOGY
Engineering & Computer Science

Faculty Advisor: Mari Rettke - 818.609.4761

401 - INTRODUCTION TO COMPUTERS AND THEIR USES (UC:CSU) - 3.00 UNITS

Prerequisite: None.

Introduction to Computer Science terminology, concepts and programming.

This class satisfies the CAL STATE (CSUN) and the UC/ system Computer Literacy Requirement at ONE FOURTH of the price.

0156 LAB 8:00-9:00 MTWTh Kubicki, P INST CLAB

AND LEC 9:00-12:00 MTWTh Kubicki, P INST 2005

(5 Week Class - Starts 7/16/2007, Ends 8/17/2007)

430 - MICROCOMPUTER APPLICATION SOFTWARE (CSU) - 3.00 UNITS

Prerequisite: None.

Introduction to Microsoft Excel and Microsoft Access.

This class prepares you to take the Microsoft Office Users Certification Exam.

Evening Classes

3073 LEC 6:00-8:00 MTWTh Staff INST 2005

AND LAB 8:00-10:15 MTWTh Staff INST CLAB

(5 Week Class - Starts 7/16/2007, Ends 8/17/2007)

DEVELOPMENTAL COMMUNICATIONS
Developmental Communications

001 - GRAMMAR: APPLIED TO WRITING

3.00 UNITS Rpt 1

Prerequisite: None.

Class is graded credit/no-credit.

Introduction to basic grammar as it relates to writing.

0190 7:45-10:10 MTWTh Staff LRC 215

(5 Week Class - Starts 7/16/2007, Ends 8/17/2007)

Evening Classes

3044 7:30-9:55 MTWTh Staff LRC 215

(5 Week Class - Starts 7/16/2007, Ends 8/17/2007)

036A - READING II: COMPREHENSION AND RELATED SKILLS A - 3.00 UNITS Rpt 1

Prerequisite: None.

Class is graded credit/no-credit.

Intermediate course in reading; emphasizes finding main ideas, critical thinking, vocabulary skills, and study skills.

0189 10:30-12:55 MTWTh Staff LRC 215

(5 Week Class - Starts 7/16/2007, Ends 8/17/2007)

Evening Classes

3045 4:45-7:10 MTWTh Staff LRC 215

(5 Week Class - Starts 7/16/2007, Ends 8/17/2007)

Developmental Communication 36A also offered through PACE. See page 33.

Session B

The New LRC Computer Commons
sleeker...
faster...
ultra-modern!



First Floor, Learning Resource Center, The Quad

More than 70 new ultra-modern computers available for student use

- INSTANT INTERNET
- FLAT PANEL MONITORS
- DVD ROM
- CD REWRITEABLE & FLOPPY DISK DRIVES
- SPECIALIZED INSTRUCTIONAL PROGRAMS

An ideal place to do your homework and class research!

Hours of Operation (subject to change)

Monday - Thursday: 9 AM to 7 PM

Saturdays: 10 AM to 2 PM

ENGLISH

ESL, English & Journalism

021 - ENGLISH FUNDAMENTALS - 3.00 UNITS

Prerequisite: Appropriate skill level demonstrated through the English assessment process or by permit.

Corequisite: Dev Com 36A.

Class graded credit/no credit.

Basic grammar, spelling, punctuation, topic sentences, and paragraph structure.

0178 7:45-10:10 MTWTh McKee, M CSB 111

(5 Week Class - Starts 7/16/2007, Ends 8/17/2007)

0183 10:30-12:55 MTWTh McKee, M CSB 205

(5 Week Class - Starts 7/16/2007, Ends 8/17/2007)

Evening Classes

3038 4:45-7:10 MTWTh Love, M CSB 206

(5 Week Class - Starts 7/16/2007, Ends 8/17/2007)

3039 7:30-9:55 MTWTh Stevenson, W CSB 205

(5 Week Class - Starts 7/16/2007, Ends 8/17/2007)

English 21 also offered through PACE. See page 33.

028 - INTERMEDIATE READING AND COMPOSITION

3.00 UNITS

As a component of the student's final grade, a Common Department Final is required.

Prerequisite: English 21 with a grade of "C" or better, or appropriate skills level demonstrated through the English assessment process, or by permit.

English 28 is a course in reading and writing designed to strengthen the student's ability to use basic communication skills, including grammar, spelling, punctuation, and sentence construction. Instruction will include the assignment of full-length expository and argumentative essays.

0186 7:45-10:10 MTWTh Grant, R INST CSB 208

(5 Week Class - Starts 7/16/2007, Ends 8/17/2007)

Evening Classes

3040 7:30-9:55 MTWTh Staff CSB 105

(5 Week Class - Starts 7/16/2007, Ends 8/17/2007)

English 28 also offered through PACE. See page 33.

101 - COLLEGE READING AND COMPOSITION I

(UC:CSU) - 3.00 UNITS

Prerequisite: English 28 or ESL 8 with a grade of "C" or better, or appropriate skill level demonstrated through the English assessment process, or by permit.

This is the first freshman composition course that meets requirements for the BA at four-year colleges and universities, comprising intensive reading, writing of essays, term papers, the study of style, methods of discourse, logic, and documentation.

All sections may be taken for honors credit. See the Honors Counselor.

0188 7:45-10:10 MTWTh Staff CSB 205

(5 Week Class - Starts 7/16/2007, Ends 8/17/2007)

Evening Classes

3041 7:30-9:55 MTWTh Staff CSB 111

(5 Week Class - Starts 7/16/2007, Ends 8/17/2007)

3043 4:45-7:10 MTWTh Stevenson, W CSB 111

(5 Week Class - Starts 7/16/2007, Ends 8/17/2007)

English 101 also offered through PACE. See page 33.

English 101 also offered through ITV. See page 34.

102 - COLLEGE READING AND COMPOSITION II

(UC:CSU) - 3.00 UNITS

Prerequisite: English 101 with a grade of "C" or better, or by permit.

Critical thinking and writing through the reading of poetry, drama, the short story, and the novel.

All sections may be taken for honors credit. See the Honors Counselor.

0116 10:30-12:55 MTWTh Keawe, G CSB 201

(5 Week Class - Starts 7/16/2007, Ends 8/17/2007)

Evening Classes

3042 4:45-7:10 MTWTh Kellenberger, A CSB 205

(5 Week Class - Starts 7/16/2007, Ends 8/17/2007)

ENGLISH AS A SECOND LANGUAGE

ESL, English & Journalism

052 - ESL READING AND CONVERSATION A

(NDA) - 3.00 UNITS

Prerequisite: Appropriate ESL placement results or by permit.

Class is graded credit/no-credit.

0142 7:45-10:10 MTWTh Cortes, T CSB 201

(5 Week Class - Starts 7/16/2007, Ends 8/17/2007)

Evening Classes

3142 7:30-9:55 MTWTh Staff CSB 201

(5 Week Class - Starts 7/16/2007, Ends 8/17/2007)

053 - ESL READING AND CONVERSATION B

(NDA) - 3.00 UNITS

Prerequisite: ESL 3, or appropriate ESL placement results, or by permit.

Class is graded credit/no-credit.

0159 7:45-10:10 MTWTh Barbato, L CSB 206

(5 Week Class - Starts 7/16/2007, Ends 8/17/2007)

Evening Classes

3159 7:30-9:55 MTWTh Berend, E CSB 206

(5 Week Class - Starts 7/16/2007, Ends 8/17/2007)

ENVIRONMENTAL SCIENCE
Natural Sciences

Faculty Advisor: Michael Reynolds - 818.364.7695

002 - THE HUMAN ENVIRONMENT: BIOLOGICAL PROCESSES (UC:CSU) - 3.00 UNITS

Prerequisite: None.

Advisory: English 28 or ESL 8.

Students examines the planet's major ecosystems, especially the impact of man on the environment. It satisfies the UC/CSU GE requirement of a natural science without lab.

Evening Classes

3055 7:30 -9:55 MTWTh Fennoy, S INST 1013
(5 Week Class - Starts 7/16/2007, Ends 8/17/2007)

FAMILY AND CONSUMER STUDIES
Professional Studies

021 - NUTRITION (UC:CSU) - 3.00 UNITS

Prerequisite: None.

Required for ACF Certificate and Food Production Certificate, meets Natural Science requirement. Comprehensive scientific nutrition information.

Evening Classes

3027 7:30 -9:55 MTWTh Cantrell, E INST 1008
Taught bilingually (English/Spanish).
(5 Week Class - Starts 7/16/2007, Ends 8/17/2007)

031 - MARRIAGE AND FAMILY LIFE

(UC:CSU) - 3.00 UNITS

Prerequisite: None.

Required for Gerontology, Administration of Justice Certificate, and Family and Consumer Studies AA Degree. Learn about relationships, communication techniques, sexual attitudes and how to be a complete you.

Evening Classes

3119 4:45 -7:10 MTWTh Cantrell, E. INST 1008
(5 Week Class - Starts 7/16/2007, Ends 8/17/2007)

FOOD SERVICE MANAGEMENT
Professional Studies

Faculty Advisor: Eloise F. Cantrell - 818.364.7625

Note: The following series of classes FSM 100 through 108 and FCS 108, FCS 21, FCS 163 are required for AA, AS, ACF certification, and Food Management Certificate Program.

100 - INTRODUCTION TO HOSPITALITY INDUSTRIES
3.00 UNITS

Advisory: FCS 20, 21, 50.

Overview of food services and management in the hospitality industry. Careers are explored.

7006	12:30-4:00 TWTh	Staff	KIRK HS3
------	-----------------	-------	----------

(5 Week Class - Starts 7/16/2007, Ends 8/17/2007)
Class meets at 10500 Lindley St., Northridge 91386

GEOGRAPHY
Natural Sciences

Faculty Advisor: Lorraine Manoogian - 818.364.7706

001 - PHYSICAL GEOGRAPHY

(UC:CSU) - 3.00 UNITS

Prerequisite: None.

This course covers the changing processes within the Earth's major Geosystems: the Atmosphere, Hydrosphere, Lithosphere and Biosphere. Units of study include weather, climate, landforms, plate tectonics, gradational processes of mass wasting, soil formation, vegetation communities and the human impact of the environment. This course meets university transfer requirements for natural or physical science.

Evening Classes

3057 4:45 -7:10 MTWTh Manoogian, L INST 1013
(5 Week Class - Starts 7/16/2007, Ends 8/17/2007)

014 - GEOGRAPHY OF CALIFORNIA

(UC:CSU) - 3.00 UNITS

Prerequisite: None.

This course of study elaborates on California's physical geography regions and natural resources in relation to patterns of population and economic activities, transportation routes and trade. Emphasis is placed on the state's history, demographics, ethnicity, land use and economy.

0224	10:30-12:55 MTWTh	Staff	INST 1013
------	-------------------	-------	-----------

(5 Week Class - Starts 7/16/2007, Ends 8/17/2007)

Session B



015 - PHYSICAL GEOGRAPHY LABORATORY

(UC:CSU) - 2.00 UNITS

Prerequisite or Corequisite: Geog 1.

This earth environment laboratory emphasizes the scientific method by competing exercises and graphs solve equations, determine measurements, construct diagrams, and make field observations about Earth-Sun relations, weather systems, climate regions, soil classification, rock types and agents of landform modification. This course meets university transfer requirements for the laboratory portion of the Physical Sciences.

Evening Classes**3058 LEC 7:30 - 8:20 MTWTh Rahman, A INST 2014****AND LAB 8:20 - 9:55 MTWTh Rahman, A INST 2014**

(5 Week Class - Starts 7/16/2007, Ends 8/17/2007)

H **HEALTH***Arts, Health & Physical Education***011 - PRINCIPLES OF HEALTHFUL LIVING**

(UC:CSU) - 3.00 UNITS

Prerequisite: None.

Implements the World Health Organization's definition of health that health is the state of physical, mental and social well-being, not merely the absence of disease.

0120 7:45-10:10 MTWTh Milke, L CSB 110
(5 Week Class - Starts 7/16/2007, Ends 8/17/2007)

Evening Classes**3007 4:45 - 7:10 MTWTh Staff CSB 110**

(5 Week Class - Starts 7/16/2007, Ends 8/17/2007)

Health 11 also offered through ITV. See page 34.

H **HISTORY***Social Sciences***002 - INTRODUCTION TO WESTERN CIVILIZATION II**

(UC:CSU) - 3.00 UNITS

Prerequisite: None.

A survey of western civilization from the beginning of the 17th century to the present with emphasis upon political, economic, and social forces.

0201 7:45-10:10 MTWTh Jimenez, G INST 1010
(5 Week Class - Starts 7/16/2007, Ends 8/17/2007)

0232 7:45-10:10 MTWTh Evans, R INST 1008
(5 Week Class - Starts 7/16/2007, Ends 8/17/2007)

012 - POLITICAL AND SOCIAL HISTORY OF THE**UNITED STATES II (UC:CSU) - 3.00 UNITS****Prerequisite:** None.

Note: History 11 is not required for this course.

A survey of major events personages, and themes most significant to the political, economic, and social development of this nation from the Reconstruction Period (1865) to the present.

This section may be taken for honors credit. See the Honors Counselor.

0233	10:30 hrs	TBA	Behling, R	Internet
Web page: www.lamission.edu/h12				
(5 Week Class - Starts 7/16/2007, Ends 8/17/2007)				

H **HUMANITIES***Social Sciences***001 - CULTURAL PATTERNS OF****WESTERN CIVILIZATION (UC:CSU) - 3.00 UNITS****Prerequisite:** None.

Survey of the arts in western civilization.

Evening Classes**3023 4:45 - 7:10 MTWTh Kiani, A INST 1017**

(5 Week Class - Starts 7/16/2007, Ends 8/17/2007)

031 - PEOPLE IN CONTEMPORARY SOCIETY

(UC:CSU) - 3.00 UNITS

Prerequisite: None.

Traces the arts in their interrelations from the Baroque to the present as mirrors of western man's view of himself in a changing world.

Evening Classes**3070 7:30 - 9:55 MTWTh Staff CSB 110**

(5 Week Class - Starts 7/16/2007, Ends 8/17/2007)

I **INTERIOR DESIGN***Professional Studies***102 - INTRODUCTION TO INTERIOR DESIGN**

3.00 UNITS

Prerequisite: None.

Basic elements and principles of design theory applied to furniture selection and interiors. Includes color schemes, floor coverings, window and wall treatments, lighting and accessories.

Possible field trips.

Evening Classes**6168 7:30 - 9:55 MTWTh Withers, K CAC 4**

(5 Week Class - Starts 7/16/2007, Ends 8/17/2007)

LAW
Business & Law

001 - BUSINESS LAW I (UC:CSU) - 3.00 UNITS

Prerequisite: None.

Same as Business 5.

Introductory course in civil law open to all students.

0191	10:30 hrs	TBA	Jordan, D	Internet
Web page: www.lamission.edu/law				
(5 Week Class - Starts 7/16/2007, Ends 8/17/2007)				

0240	8:00-10:25	MTWTh	Jordan, D	LRC 205
(5 Week Class - Starts 7/23/2007, Ends 8/23/2007)				

010 - INTRODUCTION TO LEGAL ASSISTANT I

3.00 UNITS

Prerequisite: None.

Formalizes the career of the legal assistant, and introduces legal terminology bibliography, including research problems.

0165	10:30 hrs	TBA	Staff	Internet
Web page: www.lamission.edu/law				
(5 Week Class - Starts 7/16/2007, Ends 8/17/2007)				

012 - TORT LAW AND CLAIMS INVESTIGATION

3.00 UNITS

Prerequisite: None.

Principles of California tort and insurance law, and the investigation techniques necessary in tort and insurance claims.

0169	10:30 hrs	TBA	Telanoff, A	Internet
Web page: www.lamission.edu/law				
(5 Week Class - Starts 7/16/2007, Ends 8/17/2007)				

016 - CIVIL AND CRIMINAL EVIDENCE

3.00 UNITS

Prerequisite: None.

Study of the rules of civil and criminal evidence, the admissibility of such evidence in court, deposition comprehension and use in court, and interrogatory summarizing and use in court.

0174	10:30 hrs	TBA	Rose, E	Internet
Web page: www.lamission.edu/law				
(5 Week Class - Starts 7/16/2007, Ends 8/17/2007)				

017 - LEGAL WRITING - 3.00 UNITS

Prerequisite: None.

This course consists of advanced legal drafting and writing, including research and special projects.

0199	10:30 hrs	TBA	Jordan, D	Internet
Web page: www.lamission.edu/law				
(5 Week Class - Starts 7/16/2007, Ends 8/17/2007)				

034 - LEGAL RESEARCH LABORATORY

3.00 UNITS

Prerequisite: None.

This course is the study of Legal Research. The student learns how to do legal research in a Law Library and Online, along with how to report the results of legal research.

0161	10:30 hrs	TBA	Jordan, D	Internet
Web page: www.lamission.edu/law				
(5 Week Class - Starts 7/16/2007, Ends 8/17/2007)				

M **MATHEMATICS**
Mathematics

105 - ARITHMETIC (NDA) - 3.00 UNITS

Prerequisite: Appropriate skill level demonstrated through the Mathematics assessment process, or by permit.

A review of elementary arithmetic.

0192	7:45-10:10	MTWTh	Staff	CSB 101
(5 Week Class - Starts 7/16/2007, Ends 8/17/2007)				

Evening Classes

3069	4:45 -7:10	MTWTh	Staff	BUNG 1
(5 Week Class - Starts 7/16/2007, Ends 8/17/2007)				

Mathematics 105 also offered through PACE. See page 33.

112 - PRE-ALGEBRA (NDA) - 3.00 UNITS

Prerequisite: Math 105 with grade of "C" or better, or appropriate skill level demonstrated through the Mathematics assessment process, or by permit.

0193	7:45-10:10	MTWTh	Staff	BUNG 1
(5 Week Class - Starts 7/16/2007, Ends 8/17/2007)				

0226	10:30-12:55	MTWTh	Staff	CSB 101
(5 Week Class - Starts 7/16/2007, Ends 8/17/2007)				

0228	1:15-3:40	MTWTh	Staff	BUNG 1
(5 Week Class - Starts 7/16/2007, Ends 8/17/2007)				

Evening Classes

3062	7:30 -9:55	MTWTh	Staff	BUNG 1
(5 Week Class - Starts 7/16/2007, Ends 8/17/2007)				

Mathematics 112 also offered through PACE. See page 33.

227 - STATISTICS (UC:CSU) - 4.00 UNITS

Prerequisite: Math 125 with a grade of "C" or better, or appropriate skill level demonstrated through the Mathematics assessment process, or by permit.

Equivalent to Math 225 with an additional hour of laboratory.

Evening Classes

3066	6:20 -9:55	MTWTh	Staff	CSB 101
(5 Week Class - Starts 7/16/2007, Ends 8/17/2007)				

Mathematics 227 also offered through PACE. See page 33.

245 - COLLEGE ALGEBRA (UC:CSU) - 3.00 UNITS
Prerequisite: Math 125 with a grade of "C" or better, or appropriate skill level demonstrated through the Mathematics assessment process, or by permit.
 0230 1:15-3:40 MTWTh Staff CSB 101
 (5 Week Class - Starts 7/16/2007, Ends 8/17/2007)

MUSIC

Arts, Health & Physical Education

101 - FUNDAMENTALS OF MUSIC
 (UC:CSU) - 3.00 UNITS

Prerequisite: None.

Study of basic elements of music: notation of pitch and rhythm, scales, intervals, key signatures, and triads.

Evening Classes

6129 4:45 - 7:10 MTWTh Staff CAC 6
 (5 Week Class - Starts 7/16/2007, Ends 8/17/2007)

OCEANOGRAPHY

Natural Sciences

Faculty Advisor: Lorraine Manoogian - 818.364.7706

001 - INTRODUCTION TO OCEANOGRAPHY
 (UC:CSU) - 3.00 UNITS

Prerequisite: None.

An introduction to Oceanography. Topics include the formation and the evolution of the sea floor, islands, coastlines, properties of seawater, motions of the sea (waves, tides and currents) and marine life. Specific reference is made to the Southern California coast.

0225 1:15-3:40 MTWTh Rogers, H INST 1013
 (5 Week Class - Starts 7/16/2007, Ends 8/17/2007)
 Oceanography 1 also offered through ITV. See page 34.

PHILOSOPHY

Social Sciences

Faculty Advisor: Mark Pursley - 818.364.7677

001 - INTRODUCTION TO PHILOSOPHY
 (UC:CSU) - 3.00 UNITS

Prerequisite: None.

A survey of fundamental questions about self, society, and the universe. Primary focus on theories of reality, knowledge, and religion.

Evening Classes

3071 4:45 - 7:10 MTWTh Staff CSB 105
 (5 Week Class - Starts 7/16/2007, Ends 8/17/2007)
 Philosophy 1 also offered through ITV. See page 34.

006 - LOGIC IN PRACTICE (UC:CSU) - 3.00 UNITS
Prerequisite: None.

Introduces skills of argument identification and evaluation. Students will learn to classify arguments as inductive or deductive and acquire techniques for recognizing valid deductive and strong inductive reasoning. Stresses the application of critical thinking skills to social and political discourses.

All sections may be taken for honors credit. See the Honors counselor.

0234 7:45-10:10 MTWTh Dyas, D CSB 105
 (5 Week Class - Starts 7/16/2007, Ends 8/17/2007)
 Philosophy 6 is also offered through PACE. See page 33.

PHYSICAL EDUCATION

Arts, Health & Physical Education

666 - BODY CONDITIONING

(UC:CSU) - 1.00 UNITS Rpt 3

Prerequisite: None.

The class will include various aerobic activities to enhance cardiovascular conditioning. Weight resistance exercises and stretching exercises will be included to develop muscle strength, endurance, and flexibility. Training principles and concepts along with nutritional information will be introduced.

2025 LAB 7:45-10:10 MTWTh Staff	ELCRPARK
EMPHASIS ON POWER WALKING	
(5 Week Class - Starts 7/16/2007, Ends 8/17/2007)	

690 - WEIGHT TRAINING

(UC:CSU) - 1.00 UNIT Rpt 3

Prerequisite: None.

Weight Training and Conditioning includes progressive resistance exercises. There is an emphasis on the knowledge, understanding and values of building muscle strength and endurance. Students will develop their own physical fitness program based upon sound physiological principles.

Evening Classes

2928 LAB 7:30 - 9:55 MTWTh Staff FOOT 103
 (5 Week Class - Starts 7/16/2007, Ends 8/17/2007)



POLITICAL SCIENCE
Social Sciences

Faculty Advisor: Chuck Dirks - 818.364.7675

001 - THE GOVERNMENT OF THE UNITED STATES

(UC:CSU) - 3.00 UNITS

Prerequisite: None.

0241	10:30 hrs	TBA	Chounlamounry, S	Internet
Web page: www.lamission.edu				
(5 Week Class - Starts 7/16/2007, Ends 8/17/2007)				

0150 7:45-10:10 MTWTh Hussain, S INST 1001
(5 Week Class - Starts 7/16/2007, Ends 8/17/2007)

0154 10:30-12:55 MTWTh Ostrow, I INST 1001
(5 Week Class - Starts 7/16/2007, Ends 8/17/2007)

Evening Classes

3125 7:30 -9:55 MTWTh Lopez, A INST 1001

(5 Week Class - Starts 7/16/2007, Ends 8/17/2007)
Political Science 1 also offered through ITV. See page 34.

Evening Classes

3084 7:30 -9:55 MTWTh Raskin, E INST 2004

(5 Week Class - Starts 7/16/2007, Ends 8/17/2007)
Sociology 1 also offered through ITV. See page 34.
Sociology 1 also offered through PACE. See page 34.

004 - SOCIOLOGICAL ANALYSIS

(UC:CSU) - 3.00 UNITS

Prerequisite: None.

This section may be taken for honors credit. See the Honors Counselor.

0208	10:30 hrs	TBA	Mekelburg, M	Internet
Email: profmek@hotmail.com				
(5 Week Class - Starts 7/16/2007, Ends 8/17/2007)				

SPEECH COMMUNICATION
Social Sciences

Faculty Advisor: Margie Long - 818.364.7682

101 - ORAL COMMUNICATION I

(UC:CSU) - 3.00 UNITS

Prerequisite: None.

This introductory speech course emphasizes the techniques of public speaking including the delivery of speeches to inform, persuade, and activate. In this course you will refine your critical thinking, research, organizational, and time management skills. You will learn how to organize and adapt your message to any audience.

0237 7:45-10:10 MTWTh Staff INST 1004
(5 Week Class - Starts 7/16/2007, Ends 8/17/2007)

0238 7:45-10:10 MTWTh Staff INST 1012
(5 Week Class - Starts 7/16/2007, Ends 8/17/2007)

0239 10:30-12:55 MTWTh Staff INST 1012
(5 Week Class - Starts 7/16/2007, Ends 8/17/2007)

Evening Classes

3019 4:45 -7:10 MTWTh Staff INST 1012

(5 Week Class - Starts 7/16/2007, Ends 8/17/2007)
Speech 101 also offered through PACE. See page 33.

Session B

PSYCHOLOGY
Social Sciences

001 - GENERAL PSYCHOLOGY I

(UC:CSU) - 3.00 UNITS

Advisory: English 21 or ESL 6.

This introductory psychology course covers biological foundations of behavior, various theoretical perspectives including learning, personality, and intelligence theories as well as experimental and research methodology.

0236	10:30 hrs	TBA	Rogers, C	Internet
Email: chante427@yahoo.com				
(5 Week Class - Starts 7/16/2007, Ends 8/17/2007)				

0235 7:45-10:10 MTWTh Staff INST 1002
(5 Week Class - Starts 7/16/2007, Ends 8/17/2007)

Psychology 1 also offered through ITV. See page 34.

SOCIOLOGY
Social Sciences

Faculty Advisor: Myriam Mekelburg - 818.833.3414

001 - INTRODUCTION TO SOCIOLOGY

(UC:CSU) - 3.00 UNITS

Prerequisite: None.

Develops the sociological perspective that behavior is largely determined by human interactions and by membership in groups.

All sections may be taken for honors credit. See the Honors Counselor.

0207	10:30 hrs	TBA	Mekelburg, M	Internet
Email: profmek@hotmail.com				
(5 Week Class - Starts 7/16/2007, Ends 8/17/2007)				

SUPERVISED LEARNING ASSISTANCE
Learning Assistance

001T - SUPERVISED LEARNING ASSISTANCE

(NDA) - 0.00 UNITS Rpt 9

Upon instructor referral, students will receive tutoring in the LAC. It is a non-credit, open-exit course which is non-graded and will not appear on student transcripts.

8952 19:50 hrs TBA Staff Schedule
(5 Week Class - Starts 7/16/2007, Ends 8/17/2007)

ONLINE CLASSES - Session B

BUSINESS *Business & Law*

001 - INTRODUCTION TO BUSINESS

(UC:CSU) - 3.00 UNITS

Prerequisite: None.

The student will learn the various forms of business organizations. The student will study business management, organization, financing and marketing, and also become acquainted with the risks involved in business and with government's role in business.

0215	10:30 hrs	TBA	Bernal, V	Internet
Web page: www.lamission.edu/business/bernal				
(5 Week Class - Starts 7/16/2007, Ends 8/17/2007)				

BUSINESS - MARKETING *Business & Law*

021 - PRINCIPLES OF MARKETING - 3.00 UNITS

Prerequisite: None.

Emphasized how concepts and principles of marketing are applied from a marketing manager perspective in selecting an attractive target market.

0242 LEC	10:30 hrs	TBA	Bernal, V	Internet
Web page: www.lamission.edu/business/bernal				
(5 Week Class - Starts 7/16/2007, Ends 8/17/2007)				

CHICANO STUDIES *Foreign Languages*

007 - THE MEXICAN-AMERICAN IN THE HISTORY OF THE UNITED STATES I (UC:CSU) - 3.00 UNITS

Prerequisite: None.

Traces the historical evolution of the Mexican- American to 1850.

0200	7:45-10:10 M		Morales, J	CSB 203
AND	6:05 hrs	TBA	Morales, J	Internet
Email: moralejj@lamission.edu				
(6 Week Class - Starts 7/16/2007, Ends 8/17/2007)				

037 - CHICANO LITERATURE

(UC:CSU) - 3.00 UNITS

Prerequisite: None.

0176	10:30 hrs	TBA	Gutierrez, E	Internet
Email: wgutiereo@lamission.edu				
(5 Week Class - Starts 7/16/2007, Ends 8/17/2007)				

HISTORY *Social Sciences*

012 - POLITICAL AND SOCIAL HISTORY OF THE UNITED STATES II (UC:CSU) - 3.00 UNITS

Prerequisite: None.

Note: History 11 is not required for this course.

A survey of major events personages, and themes most significant to the political, economic, and social development of this nation from the Reconstruction Period (1865) to the present.

This section may be taken for honors credit. See the Honors Counselor.

0233	10:30 hrs	TBA	Behling, R	Internet
Web page: www.lamission.edu/h12				
(5 Week Class - Starts 7/16/2007, Ends 8/17/2007)				

LAW *Business & Law*

001 - BUSINESS LAW I (UC:CSU) - 3.00 UNITS

Prerequisite: None.

Same as Business 5.

Introductory course in civil law open to all students.

0191	10:30 hrs	TBA	Jordan, D	Internet
Web page: www.lamission.edu/law				
(5 Week Class - Starts 7/16/2007, Ends 8/17/2007)				

010 - INTRODUCTION TO LEGAL ASSISTANT I 3.00 UNITS

Prerequisite: None.

Formalizes the career of the legal assistant, and introduces legal terminology bibliography, including research problems.

0165	10:30 hrs	TBA	Staff	Internet
Web page: www.lamission.edu/law				
(5 Week Class - Starts 7/16/2007, Ends 8/17/2007)				

012 - TORT LAW AND CLAIMS INVESTIGATION 3.00 UNITS

Prerequisite: None.

Principles of California tort and insurance law, and the investigation techniques necessary in tort and insurance claims.

0169	10:30 hrs	TBA	Telanoff, A	Internet
Web page: www.lamission.edu/law				
(5 Week Class - Starts 7/16/2007, Ends 8/17/2007)				

ONLINE CLASSES - Session B

Session B

016 - CIVIL AND CRIMINAL EVIDENCE

3.00 UNITS

Prerequisite: None.

Study of the rules of civil and criminal evidence, the admissibility of such evidence in court, deposition comprehension and use in court, and interrogatory summarizing and use in court.

0174	10:30 hrs	TBA	Rose, E	Internet
Web page: www.lamission.edu/law				
(5 Week Class - Starts 7/16/2007, Ends 8/17/2007)				

017 - LEGAL WRITING - 3.00 UNITS

Prerequisite: None.

This course consists of advanced legal drafting and writing, including research and special projects.

0199	10:30 hrs	TBA	Jordan, D	Internet
Web page: www.lamission.edu/law				
(5 Week Class - Starts 7/16/2007, Ends 8/17/2007)				

034 - LEGAL RESEARCH LABORATORY

3.00 UNITS

Prerequisite: None.

This course is the study of Legal Research. The student learns how to do legal research in a Law Library and Online, along with how to report the results of legal research.

0161	10:30 hrs	TBA	Jordan, D	Internet
Web page: www.lamission.edu/law				
(5 Week Class - Starts 7/16/2007, Ends 8/17/2007)				

POLITICAL SCIENCE *Social Sciences*

Faculty Advisor: Chuck Dirks - 818.364.7675

001 - THE GOVERNMENT OF THE UNITED STATES

(UC:CSU) - 3.00 UNITS

Prerequisite: None.

0241	10:30 hrs	TBA	Chounlamountry, S	Internet
Web page: www.lamission.edu/law				
(5 Week Class - Starts 7/16/2007, Ends 8/17/2007)				

PSYCHOLOGY *Social Sciences*

001 - GENERAL PSYCHOLOGY I

(UC:CSU) - 3.00 UNITS

Advisory: English 21 or ESL 6.

This introductory psychology course covers biological foundations of behavior, various theoretical perspectives including learning, personality, and intelligence theories as well as experimental and research methodology.

0236	10:30 hrs	TBA	Rogers, C	Internet
Email: chante427@yahoo.com				
(5 Week Class - Starts 7/16/2007, Ends 8/17/2007)				

Psychology 1 also offered through ITV. See page 34.

SOCIOLOGY *Social Sciences*

Faculty Advisor: Myriam Mekelburg - 818.833.3414

001 - INTRODUCTION TO SOCIOLOGY

(UC:CSU) - 3.00 UNITS

Prerequisite: None.

Develops the sociological perspective that behavior is largely determined by human interactions and by membership in groups.

All sections may be taken for honors credit. See the Honors Counselor.

0207	10:30 hrs	TBA	Mekelburg, M	Internet
Email: profmek@hotmail.com				
(5 Week Class - Starts 7/16/2007, Ends 8/17/2007)				

004 - SOCIOLOGICAL ANALYSIS

(UC:CSU) - 3.00 UNITS

Prerequisite: None.

This section may be taken for honors credit. See the Honors Counselor.

0208	10:30 hrs	TBA	Mekelburg, M	Internet
Email: profmek@hotmail.com				
(5 Week Class - Starts 7/16/2007, Ends 8/17/2007)				



GENERAL POLICIES

This schedule is an official publication of Los Angeles Mission College. It sets forth rules and regulations and, in case of conflict with information previously published, supersedes those publications of earlier date.

Mission of the Los Angeles Community Colleges

The mission of the Los Angeles Community Colleges is to provide comprehensive lower-division general education, occupational education, transfer education, transitional education, counseling and guidance, community services, and continuing education programs which are appropriate to the communities served and which meet the changing needs of students for academic and occupational preparation, citizenship, and cultural understanding.

IN PURSUIT OF THIS MISSION, WE ENDEAVOR TO:

- Promote equal opportunity for participation;
- Maintain appropriate standards for academic achievement;
- Provide an educational environment which meets the needs of students with varied learning skills;
- Provide support services which contribute to instructional effectiveness and student success;
- Affirm the importance of multi-cultural, international, and intercultural collegiate experiences that foster individual and group understanding; and
- Manage effectively educational and financial resources.

Students' Statements

Falsification of any record or signed statement, or the withholding of information, subjects the student to immediate suspension or expulsion.

Instructional Materials

Students may be required to provide instructional and other materials required for a credit or noncredit course. Such materials shall be of continuing value to a student outside of the classroom setting and shall not be solely or exclusively available from the District.

Withdrawal

Students wishing to drop a class or withdraw from the college during the semester must do so through the Admissions Office or use the telephone system. Failure to withdraw officially may result in an "F" grade. Students must withdraw on or before the 11th week (75%) in order to receive a W. Students in short-term classes must withdraw before 75% of the course is completed. After the 11th week or 75% completion of the

course, a student is assigned a letter grade (A through F). Instructors are not obligated to exclude a student for non-attendance. IT IS THE STUDENT'S RESPONSIBILITY TO WITHDRAW OFFICIALLY.

HOW TO DROP CLASSES OR WITHDRAW FROM COLLEGE

1. Dropping classes or withdrawing from the college must be done by the drop date deadline.
2. To drop classes, use the STEP telephone system, or fill out a "Drop Card" and present it, with your registration Fee Receipt, at the Admissions Office. To drop ALL classes (withdrawal), use the STEP System or check item number one on the drop card.
3. The clerk processes the forms and gives you a receipt. Keep your receipt for your records.
4. Fees are not automatically refunded. Fee refunds must be requested from the Business Office if you drop classes or withdraw by the end of the second week.
5. In order to do a complete withdrawal by mail, your request must be sent by Certified Mail with a receipt.
6. You may also withdraw by using the telephone system on or before the 11th week or before 75% of the course is completed.

Students in PACE or other special programs must check withdrawal deadlines with the appropriate program director.

Withdrawal from Classes

THROUGH THE 3rd WEEK: No notation ("W" or other) will appear on the student's record if the class is dropped during the first three weeks of the semester (or 30% of the class for short-term classes).

THROUGH THE 11TH WEEK: A notation of "W" (withdrawal) is recorded on the student's record for classes dropped during the 4th through the 11th week of the semester.

AFTER THE 11TH WEEK: Students who remain in class beyond the 11th week (or 75% of the class for short term classes) are given a grade by the instructor. THAT GRADE CANNOT BE A "W" (withdrawal).

Access to Records

The California Legislature passed S.B. 182 (Stull), which codifies provisions of the Education Code and the Federal statutes implementing the Family Education Rights and Privacy Act of 1974 (Buckley Amendment). This permits students to inspect their personally identifiable records maintained by the college, and permits access to these records only upon the student's request (other than to certain specified categories). Information

on these laws and college procedures in implementing them may be obtained from the Associate Dean of Admissions, who serves as the College Records Officer. Copies of pertinent State and Federal legislation are available for inspection.

Los Angeles Mission College considers the following information relating to a student to be directory information: student's name, city of residence, date of birth, major field of study, participation in officially recognized activities and sports, weight and height of members of athletic teams, dates of attendance, degrees and awards received, and the most recent previous educational agency or institution attended by the student. Students who do not wish any or all of the above categories of information to be given out should so indicate on their application at time of enrolling. Students are asked to voluntarily provide their student identification number for this purpose.

Family Educational Rights and Privacy

Act (FERPA) Notification The Family Educational Rights and Privacy Act (FERPA) affords students the following rights with respect to their educational records:

1. The right to inspect and review the student's education records which includes discipline records, within 45 days from the date the College receives a request for access.

- Students may submit to the College Admissions Office written requests that identify the specific record(s) they wish to inspect. Within 45 days, the College Admissions Office will make arrangements for access and will notify the student of the time and place where the records may be inspected.

- Education records are those records that are directly related to students and are maintained by the College. Students may not inspect education records pertaining to parents' financial records and certain confidential letters or recommendations.

2. The right to request an amendment of the student's educational records which the student believes to be inaccurate, misleading or otherwise in violation of the student's privacy rights.

- With the exception of grade grievances which are handled through Administrative Regulation E-55, students may ask the College President, or his/her designee to amend a record that they believe is inaccurate, misleading, or in violation of their privacy rights. A student seeking to amend an educational record should write to the College President and clearly identify the part of the record he/she wants changed and specify why it is inaccurate, misleading, or in violation of his/her privacy rights.

- If the College President, or his designee, decides not to amend the record as requested by the student, the College, in accordance with section 99.21 of the Code of Federal Regulations and section 76232 of the Education Code, will notify the student of the decision and of his/her right to a hearing.

3. The right to consent to disclosures of personally identifiable information contained in the student's educational records, except to the extent that FERPA and California law authorize disclosures without consent.

- If a student authorizes the release of his/her education record to a third party, he/she shall provide a dated written consent to the College Admissions Office authorizing said release with a specific list of the information to be released.

- Federal and California law authorize certain disclosures of personally identifiable information without a student's written consent. One such exception is the disclosure of personally identifiable information to school officials with legitimate educational interests. School officials with legitimate educational interests are employees or agents of the Los Angeles Community College District who need to review educational records in order to fulfill their professional responsibilities.

4. The right to restrict disclosure of personally identifiable information that the College has designated as directory information which may be released without the written consent of the student.

- Directory information may be disclosed without a student's consent unless the student has notified the college that he/she does not want all or portions of the directory information released. To do so, the student must submit the appropriate District form to the College Admissions Office requesting that some or all of the categories of directory information not be released without his/her consent. This form must be submitted in accordance with College policy.

- Pursuant to Board Rule 5201.10, the Los Angeles Community College District has designated the following student information as directory information:

(a) the student's name, city of residence, participation in officially recognized activities and sports, weight and height of members of athletic teams, dates of attendance, degrees and awards received, and the most previous educational agency or institution attended by the student;

(b) student employee records may be released in order to comply with collective bargaining agreements;

(c) the names, addresses and telephone numbers of students or former students may be released to the foundation for each college for college-related activities at the discretion of the College President, unless the student or former student has informed the College that such information should not be released. The release of this information is conditioned upon the foundation's agreement that such information will be released in accordance with District policy and that information will not be released to third parties;

(d) at the discretion of the College President, the names, addresses and telephone numbers of students from the College may be released to heads of private and/or public institutions of higher education, or their designees, for the purpose of providing information to student regarding transfer opportu-

nities to those institutions, unless the student has indicated that such information should not be released. The release of this information will be conditioned upon the institution's agreement that student privacy rights under federal and state law will be protected and that information will not be released to third parties.

5. The right to file a complaint with the U.S. Department of Education concerning alleged failures by the College to comply with the requirements of FERPA. The name and address of the office that administers FERPA is:

Family Policy Compliance Office
U.S. Department of Education
400 Maryland Avenue S.W.
Washington, DC 20202-4605

Student Right-to-Know Disclosure

In compliance with the Student Right-to-Know and Campus Security Act of 1990 (Public Law 101-542), it is the policy of the Los Angeles Community College District and Los Angeles Mission College to make available its completion and transfer rates to all current and prospective students. Beginning in Fall, 1996, a cohort of all certificates, degree, and transfer-seeking first-time, full-time students were tracked over a three-year period. Their completion and transfer rates are listed below. These rates do not represent the success rates of the entire student population at all California Community Colleges, nor do they account for student outcomes occurring after this three-year tracking period.

Based upon the cohort defined above, 28.2 percent attained a certificate, degree, or became "transfer-prepared" during a three-year period from Fall 1997 to Spring 2000. Students who are transfer-prepared have completed 56 transferable units with a GPA of 2.0 or better.

Based upon the cohort defined above, 29.8 percent transferred to another post secondary institution (CSU, UC, or another California Community College) prior to attaining a degree, certificate, or becoming transfer-prepared during a five semester period from Spring 1998 to Spring 2000.

Further information about Student Right-To-Know Rates and how they should be interpreted can be found at the California Community Colleges Chancellor's Office Student Right-To-Know Disclosure Website located at <http://srtk.cccco.edu/index.asp>

Student Grievance Procedure

The purpose of the Student Grievance Procedure is to provide a prompt and equitable means for resolving student grievances. The grievance procedure may be initiated by a student or group of students who reasonably believe he/she/they have been subject to unjust action or denied rights that adversely affect his/her/their status, rights, or privileges as a student. It is the responsibility of the student(s) to submit proof of alleged unfair or improper action.

Grievances pertaining to grades are subject to California Education Code Section 76224(a) which states:

"When grades are given for any course of instruction taught in a community college district, the grade given to each student shall be the grade determined by the instructor of the course and the determination of the student's grade by the instructor, in the absence of mistake, fraud, bad faith, or incompetence, shall be final."

This grievance procedure does not apply to the challenge process for prerequisites, corequisites, advisories, and limitations on enrollment; alleged violations of sexual harassment; actions dealing with student discipline; alleged discrimination on the basis of ethnic group identification, religion, age, sex, color, sexual orientation, physical or mental disability; or an appeal for residency decision; or to eligibility, disqualification, or reinstatement of Financial Aid. Informal resolution is encouraged.

A written Statement of Grievance must be submitted to the Compliance Officer within thirty (30) instructional days of the incident or after the student(s) learns of the basis for the grievance.

Recording Devices in the Classroom

Section 78907 of the California Education Code prohibits the use of any electronic listening or recording device without prior consent of the instructor. Any student violating this section is subject to disciplinary action. Any non-student who willfully violates this section is guilty of a misdemeanor.

Standards of Student Conduct and Disciplinary Action

The Standards of Student Conduct and Disciplinary Action for violation of rules were established by the Board of Trustees of the Los Angeles Community College District on September 2, 1969. A student enrolling in one of the Los Angeles Community Colleges may rightfully expect that the faculty and administrators will maintain an environment in which there is freedom to learn. This requires that there be appropriate conditions and opportunities in the classroom and on the campus. As members of the college community, students should be encouraged to develop the capacity for critical judgment, to engage in a sustained and independent search for truth, and to exercise their rights to free inquiry and speech in a responsible, non-violent manner. Students shall respect and obey civil and criminal law and they shall be subject to legal penalties for violation of laws of the city, county, state, and nation. Student conduct in all of the Los Angeles Community Colleges must conform to District and college rules and regulations.

Violations of such rules are subject to the following types of disciplinary actions, which are to be administered by appropriate college authorities against students who stand in violation. Each of the Los Angeles Community Colleges shall

establish due process of law for administration of the penalties enumerated here. Penalties are listed in degree of severity but not as chronological administration. College authorities will determine which type of penalty is appropriate.

1. **WARNING** – Notice to the student that continuation or repetition of specified conduct may be cause for other disciplinary action.
2. **REPRIMAND** – Written reprimand for violation of specified rules. A reprimand serves to place on record that a student's conduct in a specific instance does not meet the standards expected at the college. A person receiving a reprimand is notified that this is a warning that continued conduct of the type described in the reprimand may result in formal action against the student.
3. **DISCIPLINARY PROBATION** – Exclusion from participation in privileges or extra-curricular college activities set forth in the notice of disciplinary probation for a specified period of time. The imposition of disciplinary probation involves notification in writing of the reason for disciplinary probation to the student(s) or president of the student organization involved.
4. **RESTITUTION** – Reimbursement for damage or for misappropriation of property. Reimbursement may take the form of appropriate service to repair or otherwise compensate for damage.
5. **SUMMARY SUSPENSION** – A Summary Suspension is for purposes of investigation. It is a means of relieving the tension of the student body or individual class due to a serious infraction of student behavior standards, removing a threat to the well-being of the students, or removing for the good order of the college a student or students whose presence would prevent the continued normal conduct of the academic community. Summary Suspension is limited to that period of time necessary to insure that the purposes of the Summary Suspension are accomplished, and in any case, no more than a maximum of 10 school days. Summary Suspension is a type of suspension other than that ordinarily invoked by the instructor in the classroom. The College President, appropriate administrator, or other staff member designated by the President may summarily suspend a student when he deems it necessary for the safety and welfare of the college.
6. **DISCIPLINARY SUSPENSION** – Disciplinary Suspension follows a hearing based on due process of law. It shall be invoked by the College President, appropriate administrator, or other staff member designated by the President, upon students for misconduct when other corrective measures have failed or when the seriousness of the situation warrants such action.
7. **EXPULSION** – An expulsion is a long-term or permanent denial of all campus privileges including class attendance. The President of the college and/or the Board of Trustees may expel a student who has been convicted of a crime arising out of a campus disturbance or, after a hearing by a campus

body, has been found to have willfully disrupted the orderly operation of the campus. The President shall submit periodic reports on all expulsion cases to the Superintendent and the Board of Trustees.

Violations of the Standards of Student Conduct are as follows:

- 9803.10 **Willful Disobedience:** Willful disobedience to directions of college officials acting in the performance of their duties.
- 9803.11 **Violation of College Rules and Regulations:** Violation of college rules and regulations, including those concerning student organizations, the use of college facilities, or the time, place, and manner of public expression or distribution of materials.
- 9803.12 **Dishonesty:** Dishonesty, such as cheating, or knowingly furnishing false information to colleges.
- 9803.13 **Unauthorized Entry:** Unauthorized entry to or use of the college facilities.
- 9803.14 **College Documents:** Forgery, alteration, or misuse of college documents, records, or identification.
- 9803.15 **Disruption of Classes or College Activities:** Obstruction or disruption of classes, administration, disciplinary procedures, or authorized college activities.
- 9803.16 **Theft of or Damage to Property:** Theft of or damage to property belonging to the college, a member of the college community or a campus visitor.
- 9803.17 **Interference with Peace of College:** The malicious or willful disturbance of the peace or quiet of any of the Los Angeles Community Colleges by loud or unusual noise, or any threat, challenge to fight, fight, or violation of any rules of conduct as set forth in this Article.
- 9803.18 **Assault or Battery:** Assault or battery, abuse, or any threat of force or violence directed toward any member of the college community or campus visitor engaged in authorized activities.
- 9803.19 **Alcohol and Drugs:** Any possession of controlled substances which would constitute a violation of Health and Safety Code section 11350 or Business and Professions Code section 4230; any use of controlled substances the possession of which are prohibited by same, or any possession or use of alcoholic beverages while on any property owned or used by the District or colleges of the District. "Controlled substance," as used in this section includes, but is not limited to, the following drugs and narcotics:
 - (a) opiates, opium, and opium derivatives, (b) mescaline,
 - (c) hallucinogenic substances, (d) peyote, (e) marijuana,
 - (f) stimulants and depressants, (g) cocaine.
- 9803.20 **Lethal Weapons:** Possession, while on a college campus or at a college-sponsored function, of any object that might be used as a lethal weapon is forbidden by all persons

except sworn peace officers, police officers, and other government employees charged with policing responsibilities.

9803.21 **Discriminatory Behavior:** Behavior while on a college campus or at a college-sponsored function, inconsistent with the District's non-discrimination policy, which requires that all programs and activities of the Los Angeles Community College District be operated in a manner which is free of discrimination on the basis of race, color, natural origin, ancestry, religion, creed, sex, pregnancy, marital status, sexual orientation, age, handicap or veteran status.

9803.22 **Unlawful Assembly:** Any assemblage of two or more persons to (1) do an unlawful act, or (2) do a lawful act in a violent, boisterous or tumultuous manner.

9803.23 **Conspiring to Perform Illegal Acts:** Any agreement between two or more persons to perform an illegal act.

9803.24 **Threatening Behavior:** A direct or implied expression of intent to inflict physical or mental/emotional harm and/or actions (such as stalking) which a reasonable person would perceive as a threat to personal safety or property. Threats may include verbal statement, written statements, telephone threats or physical threats.

9803.25 **Disorderly Conduct:** Conduct that may be considered disorderly includes lewd or indecent attire, behavior that disrupts classes or college activities, breach of the peace of the college, aiding or inciting other persons to breach the peace of college premises or functions.

9803.26 **Theft or Abuse of Computer Resources:** Theft or Abuse of Computer Resources including but not limited to the following:

- a. Unauthorized entry into a file to use, read, or change the contents, or for any other purpose.
- b. Unauthorized transfer of a file.
- c. Unauthorized use of another individual's identification or password.
- d. Use of computing facilities to interfere with the work of a student, faculty member or college official, or to alter college or district records.
- e. Use of unlicensed software
- f. Unauthorized copying of software
- g. Use of computing facilities to access, send or engage in messages which are obscene, threatening, defamatory, present a clear and present danger, violate a lawful regulation and /or substantially disrupt the orderly operation of a college campus.
- h. Use of computing facilities to interfere with the regular operation of the college or District computing system.

9804 **Interference with Classes:** Every person who, by physical force, willfully obstructs, or attempts to obstruct, any

student or teacher seeking to attend or instruct classes at any of the campuses or facilities owned, controlled or administered by the Board of Trustees of the Los Angeles Community College District, is punishable by a fine not exceeding five hundred dollars (\$500) or imprisonment in a county jail not exceeding one year, or by both such fine and imprisonment.

9805 **Interference with Performance of Duties of Employees:** Action to cause, or attempt to cause, any employee of the District to do, or refrain from doing, any act in the performance of his or her duties by means of a threat to inflict any injury upon any person or property.

9805.10 **Assault or Abuse of an Instructor:** Assault or abuse of any instructor employed by the District in the presence or hearing of a community college student, or in the presence of other community college personnel or students, and at a place which is on District premises or public sidewalks, streets, or other public ways adjacent to school premises, or at some other place where the instructor is required to be in connection with assigned college activities.

9806 **Unsafe Conduct:** Conduct which poses a threat of harm to the individual and/or to others. This includes, but is not limited to, the following types of conduct: Unsafe conduct in connection with a Health Services Program (e.g., Nursing, Dental Hygiene, etc.); failure to follow safety direction of District and/or college staff; willful disregard of safety rules as adopted by the District and/or college; negligent behavior which creates an unsafe environment.

Non-Discrimination Policy

All programs and activities of the Los Angeles Community College District shall be operated in a manner which is free of discrimination on the basis of ethnic groups identification, race, color, national origin, ancestry, religion, creed, sex, pregnancy, marital status, medical condition (cancer related), sexual orientation, age, physical or mental disability (including AIDS) or veteran status (Reference: Board Rule 1202).

Politica No Discriminatoria

Todos los programas y actividades de los colegios de la comunidad de Los Angeles se administrarán de una manera que no discrimine respecto a la identidad de grupos étnicos, raza, color, nacionalidad, origen, ascendencia, religión, credo, sexo, embarazo, estado civil, condición médica (relacionada con cáncer), preferencia sexual, edad, incapacidad mental o física (incluyendo SIDA) o el ser veterano.

Compliance Procedure

In order to insure nondiscrimination policy compliance at Los Angeles Mission College, please direct inquiries to the Compliance Officer – Title IX/Gender-Equity, and Sexual Harassment 818.364.7701. Matters involving Section 504 may be directed to the Coordinator of Disabled Student's Program at 818.364.7734. In addition, inquiries may be directed to the

District Office of Diversity Programs at 213.891.2315.

Política De Acuerdo Con Los Procedimientos De Igualdad De Oportunidades Para asegurar que se cumpla una política no discriminatoria en Los Angeles Mission College, favor de dirigirse a la oficina de un mediador si se refiere al acoso sexual o a la discriminación – Compliance Officer Title IX/Gender Equity 818.364.7701. Para la Sección 504, dirijase al Coordinador del Programa de Personas Incapacitadas, al 818.364.7734. Además, puede también dirigir sus preguntas a la oficina de Diversity Programs del Distrito, teléfono 213.891.2315.

Compliance Officer

If students feel they have grounds for a grievance, they may contact the college Compliance Officer, who will help explain college rules and regulations, and, if a problem is resolvable, suggest the best method for resolving the problem. For additional information and a copy of Administrative Regulation E-55 (Student Grievance Procedures) see the Compliance Officer located in the Campus Center, 818.364.7701.

Sexual Assault Policy

The Los Angeles Community College District is committed to providing a safe environment for students, visitors, and staff. Any incident of sexual assault should be immediately reported to campus police at 818.364.7843. The term “sexual assault” under the California Education Code, Section 67385(d), includes threats of sexual violence.

Anyone charged with campus-related sexual assault may be subject to prosecution under appropriate California criminal statutes; students may also be subject to discipline under the Student Disciplinary Procedures. The Sexual Harassment Policy may also apply, and the Compliance Officer may be contacted at 818.364.7701. Confidentiality shall be maintained. (Reference: Board Rule 16400.11.)

Sexual Harassment Policy

The policy of the Los Angeles Community College District is to provide an educational, employment and business environment free from unwelcome sexual advances, requests for sexual favors, and other verbal or physical conduct or communications constituting sexual harassment. Employees, students, or other persons acting on behalf of the District who engage in sexual harassment as defined in the policy or by state or federal law shall be subject to discipline, up to and including discharge, expulsion or termination of contract. The specific rules and procedures for reporting charges of sexual harassment and for pursuing available remedies are incorporated in the Board Rules in Chapter 15.

The Los Angeles Community College District has a policy which provides informal and formal procedures for resolving complaints.

Copies of the policy and procedures may be obtained from the Compliance Officer located in the Administration Building, Room 123, 818/364-7701, or by calling the Senior Director of Educational and Student Support Services at 213/891-2279, or the Office of Diversity Programs at 213/891-2315. Any member of the College Community, which includes students, faculty, and staff, who believes, perceives, or actually experienced conduct that may constitute sexual harassment, has the right to seek the help of the College. Every employee has the responsibility to report such conduct when it is directed towards students to the Sexual Harassment Compliance Officer. Potential complainants are advised that administrative and civil law remedies, including but not limited to injunctions, restraining orders or other orders may be made available.

Diversity Program

The policy of the Los Angeles Community College District is to implement equal opportunity to all qualified employees and applicants for employment without regard to race, color, national origin, ancestry, religion, creed, sex, pregnancy, age, disability, marital status, medical condition (cancer related), sexual orientation, or veteran status. Positive action will be taken to ensure that this policy is followed in all personnel practices, including recruitment, hiring, placement, upgrading, transfer, demotion, treatment during employment, rate of pay or other forms of compensation, selection for training, layoff, or termination. Inquiries regarding equal opportunity practices at Los Angeles Mission College should be directed to the college Compliance Officer located in the Campus Center, 818.364.7701.

Drug-Free Environment

Los Angeles Mission College adheres to, supports, and is in full compliance with requirements that maintain our college as a drug-free institution of higher education.

On September 5, 1990, the Board of Trustees adopted the following standards of conduct:

- Students and employees are prohibited from unlawfully possessing, using or distributing illicit drugs and alcohol on District premises, in District vehicles, or as part of any activity of the Los Angeles Community College District.

On April 20, 1989, the Los Angeles Community College District Board of Trustees adopted Rule 9803.19, which prohibits:

- Alcohol and Drugs. Any possession of controlled substances which would constitute a violation of Health and Safety Code section 11350 or Business and Professions Code section 4230, any use of controlled substances, the possession of which are prohibited by the same, or any possession or use of alcoholic beverages while on any property owned or used by the District or colleges of the District. “Controlled substances,” as used in this section, include, but are not limited to, the following drugs and narcotics:

- a. opiates, opium and opium derivatives
- b. mescaline
- c. hallucinogenic substances
- d. peyote
- e. marijuana stimulants
- f. depressants and
- g. cocaine.

The Board's policy on the Drug Free Workplace, adopted March 22, 1989, restates these prohibitions.

- **Legal Sanctions.** Federal laws regarding alcohol and illicit drugs allow for fines and/or imprisonment. Other legal problems include the loss of driver's license and limitations of career choices.
- **Health Risks.** Health risks associated with the abuse of controlled substances include malnutrition, damage to various organs, hangovers, blackouts, general fatigue, impaired learning, dependency, disability, and death. Both drugs and alcohol may be damaging to the development of an unborn fetus.
- **Other Risks.** Personal problems include diminished self-esteem, depression, alienation from reality, and suicide. Social problems include loss of friends, academic standing, co- and extra-curricular opportunities, alienation from and abuse of family members, and chronic conflict with authority. Economic problems include loss of job, financial aid eligibility, homes, savings, and other assets.

Additionally, on June 28, 2000, the Board of Trustees adopted Rules 9803.24 Threatening Behavior, 9803.25 Disorderly Conduct, 9803.26 Theft or Abuse of Computer, and 9806 Unsafe Conduct. Each are fully described in Standards of Student Conduct.

Campus Security

The campus Sheriff's office personnel are responsible for the safety and well being of staff, faculty and students, and of the security of college property and facilities, 818/364-7843.

Campus Crime Report

Los Angeles Mission College's general statistics and crime can be viewed at the following URLs:

- General Information

<http://nces.ed.gov/ipeds/cool/InstDetail.asp?UNTID=117867>

- Crime

<http://ope.ed.gov/SECURITY/instDetail.asp?UNTID=117867>
then click on Criminal Offenses, Hate Offenses, or Arrests.

Counseling, Treatment and Rehabilitation

The following resources are available for the treatment of alcohol and drug dependence and abuse:

- Los Angeles Community College District Employee Assistance Program
818.907.7701 or 800.521.9944
- National Council on Alcoholism and Drug Dependence
213.384.0403 or 818.997.0414
- Los Angeles County Drug Abuse Program
213.624.DRUG
- Alcoholics Anonymous
213.387.8316 or 818.988.3001
- Cocaine Anonymous
213.839.1141 or 818.988.1777
- Narcotics Anonymous
213.283.1745 or 818.997.3822
- Families Anonymous
800.736.9805

Smoking Policy

In accordance with Board Rule 9804, smoking is permitted in designated areas only. A student who violates the rules is subject to the student disciplinary regulations.



Student Health Fee Information

The Los Angeles Community College Board of Trustees at its April 29, 1992 meeting modified Board rule 8502, thus making the \$11 Health Services fee a mandatory fee for all students enrolled in credit classes.

The Los Angeles Community College District policy exempts the following students from paying the student health fee:

(a) low-income students, including students on financial aid and/or recipients of a Board of Governors' grant, (b) students who depend exclusively on prayer for healing in accordance with the teaching of a bona fide religious sect, (c) students who are attending classes under an approved apprenticeship training program, (d) non-credit education students, (e) students enrolled in District colleges exclusively at sites where student health services are not provided, (f) students who are enrolled in District colleges exclusively through Instructional Television or distance education classes, (g) students who are enrolled in District colleges exclusively through contract education. Students exempted under the provisions of (a), (c) and (d) above are eligible to receive the services of the college health program; all other exempted students are not eligible to receive the services of the college health program.

Your registration fee receipt, or your current student I.D. must be presented to receive services.

Student ID

To comply with federal privacy requirements, Los Angeles Mission College and the Los Angeles Community College District has discontinued use of the Social Security Number as the student's identification number. Instead, a new Student Identification Number will be issued for each student. The new nine-digit number is randomly generated, but each will begin with the digits "88."

Where to use your new student ID card:

A valid student ID card is required to access student services in the following areas:

- Library • Bookstore • Financial Aid
- Health Center • Computer Labs

Your first Student ID Card is free. Go to either admissions or the business office to obtain yours. You will need to present your current student registration/receipt and a second form of ID such as a California ID or a high school picture ID. For additional information, see the F.A.Q. at www.lamission.edu



STUDENT SERVICES

In this section you will find information and contact telephone numbers for the wide variety of services available to students.

Los Angeles Mission College offers these special services to students:

Campus Child Development Center

818.364.7863

The Child Development Center provides a developmentally based curriculum for pre-school children aged 3 years through 5 years.*

HOURS OF OPERATION:

Monday through Thursday: 7:30 a.m. to 6 pm

Friday: 7:30 a.m. to 2 pm

*Qualified students may receive childcare services with low to no fees.

College Ombudsperson

818.364.7690

The college ombudsperson is a faculty member selected by the president to assist students in resolving issues or problems they may have with faculty or the college.

Disabled Student Programs and Services

818.364.7732

For students with disabilities the DSP&S office provides special assistance in areas like: registering for courses, specialized tutoring, note-taking, mobility assistance, special instruction, testing assistance, special equipment, special materials, instructor liaisons, community referrals, and job placement.

Student Activities

818.364.7820

Student government, student orientations, honors, commencement, student clubs, sports tournaments, dances, special events, video games, and more which enhance the student experience at Los Angeles Mission College.

Bookstore

818.364.7798

The Bookstore sells textbooks you need for your courses and supplies like paper, pens, blue books, scantrons, etc. Additionally the bookstore sells backpacks, T-shirts, sweatshirts, hats and more.

Bookstore Hours*

Monday - Thursday 9 am - 7 pm

Friday 9 am - 4 pm

* Hours subject to change

Business Office

818.364.7783

Payment of enrollment fees, refund requests, and other financial transactions are handled in the Business Office.

Business Office Hours*

Monday, Thursday 9 am - 7 pm

Tuesday, Wednesday, Friday 9 am - 4 pm

Extended Opportunity Programs & Services/CARE

818.364.7645

EOP&S provides qualifying students with

academic counseling, peer advisement, peer tutoring, free workshops, free university/cultural tours, transfer assistance, and assistance with books. Single parents on CalWORKs may receive additional assistance through the CARE program.

Offices which provide services to students include:

Admissions & Records

818.364.7658

The Admissions & Records Office keeps all student records. This office is where you apply for admission to the college, register for courses, add or drop courses, request transcripts, and request verification of enrollment.

Admission Office Hours*

Monday - Thursday 9 am - 7 pm

Friday 9 am - 4 pm

Family Child Care Homes Network

818.364.7881

The Family Child Care Homes Network consists of at least 25 licensed family child-care providers, who are located in the community around Los Angeles Mission College. Qualified students may receive child-care services for infants and toddlers, pre-schoolers, school age children, with low or no fees.

Library

818.364.7600 Ext. 7106

Online data bases, books, reference materials, periodicals, and information from the Internet – the tools you need to succeed are all available in the Library. One of the reference librarians will help you find information you need. You can study in our

quiet individual study areas and small groups can use our study rooms.

Library Hours*

Monday - Thursday	9 am - 7 pm
Saturday	10 am - 2 pm

Counseling

818.364.7655 or 818.364.7656

Students are strongly urged to make an appointment with a counselor to develop an Educational Plan. The Educational Plan is tailored to your needs and goals, and enables you to get the most from your studies.

Career planning is an important part of planning for your future. The Counseling Office makes the Eureka computer program available to students. Eureka helps students assess their skills, career interests, and educational decisions, and explore career options. For students interested in completing an Associate degree and transferring to a four-year college, the Transfer Center has the latest information on majors, transfer requirements, and application procedures at many public and private four-year colleges and universities.

All new students must take the college's assessment of English and Mathematics knowledge. College courses require reading and writing skills at the college level. Some courses require specific math skills. The assessment process is designed to inform students of areas in which they need improvement to be best prepared for success in college. The College Orientation Program is designed for new students to learn about the college, educational programs, services, degree requirements, and the secrets of being a successful college student.

International students have their own counselor at LAMC. The international students counselor assists the students to plan a program of studies that meets the requirements of the student and the federal requirements of the F-1 Visa. Veterans must make an appointment with the Veterans Affairs counselor to apply for VA benefits.

Learning Center

818.364.7756

Walk-in tutoring in English and math are offered most days and evenings; schedules are available at the learning center. One-on-one and small group tutoring is also available by appointment only on a limited basis in many subject areas. In addition, students can enroll in credit courses to build basic skills in reading, spelling, writing, vocabulary, math and study skills.

Honors/Transfer Alliance Program

818.364.7683

The Honors Program was created to promote academic excellence, to stimulate discussion of academic issues among students and faculty, to increase awareness of current social issues, to encourage community service, to celebrate cultural

diversity, and to prepare students for successful university transfer.

Completing an Honors Contract

Students receive Honors credit by competing an Honors Contract in any UC transferable course. In consultation with the instructor, the student develops a proposal for an Honors research project. When the final project is completed, the student must submit one copy to the instructor and a second copy to the Honors Coordinator. If the advisory committee approves the project, the student will receive an Honors notation on her transcript indicating that the course was completed for Honors credit.

Honors Certification

Students receive Honors Certification by completing a total of six Honors Contracts. Certified students receive access to a variety of scholarship opportunities and priority consideration for admission to UCLA, UCI, UCR, UCSC, Occidental College, Chapman University, Claremont College, Pomona Pitzer, La Sierra University, Whitman College, Pacific University, CSU Fullerton, CSU Stanislaus, and CSU San Diego.

Applying to the Honors Program

Applications for the Honors Program are available at the Honors/TAP office, which is located on the lower level of the Campus Center. Current LAMC students must be eligible for English 101 and have completed 12 transferable units with a GPA of 3.25 or higher. Entering students must have a high school GPA of 3.5 or higher or an SAT score above 1,000.

Honors Coordinator: Mark Pursley, 818.364.7677

Honors Counselor: Joanne Kalter-Flink, 818.364.7652

Health Center

818.362.6182

The Student Health Center at LAMC offers a variety of medical and health education services available for all registered Los Angeles Community College District students. The Student Health Center is located in front of the Child Development Center and next to the Campus Police Station. It is open varied hours which are posted on the trailer door. Students may call for an appointment or walk-in during scheduled clinic hours. Appointments can be made by calling 818.362.6182 or 818.837.7881.

This center will be staffed by medical and mental health professionals. Stop by the health center and check on available health services. Services not available at the on-campus center may be accessible through our San Fernando Health center located at 1600 San Fernando Road, and can be reached at 818.365.8086.

We welcome all students to visit and utilize their Student Health Center.

Campus Map

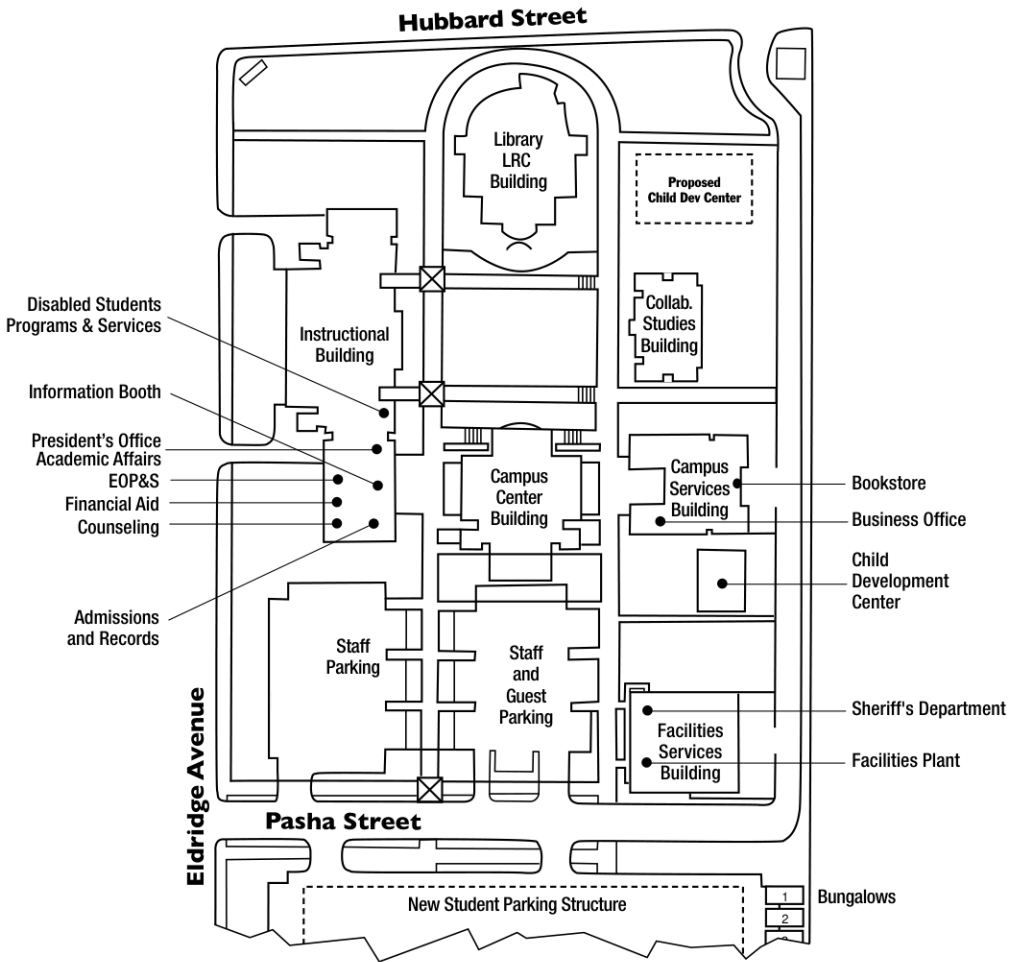

INSTRUCTIONAL BUILDING

- 1st Floor**
- Classrooms 1001-1018
 - Child Development Lab
 - Disabled Student Services
 - Engineering Lab
 - Faculty Offices
 - Foods Lab
 - Physics/Astronomy Lab

ADMINISTRATION WING

- Office of the President
- Vice President of Academic Affairs
- Academic Affairs
- Information Booth
- Admissions & Records
- Counseling
- Financial Aid
- EOP&S

2nd Floor

- Classrooms 2001-2003
- Accounting Lab
- Chemistry Lab
- Computer Science Lab
- Life Sciences Lab
- Computer & Office Applications Center

LIBRARY/LRC BUILDING

3rd Floor (Top level)

- Library

2nd Floor (Ground level)

- Computer-Aided Instruction
- Electronic Training Rooms
- Learning Center

1st Floor (Lower level)

- Educational Development Services
- Media Production Lab/ Multimedia Labs
- Teleconference Room

COLLABORATIVE STUDIES BUILDING

1st Floor

- Classrooms 101-111
- Faculty Offices

2nd Floor

- Classrooms 201-208

CAMPUS CENTER BUILDING

1st Floor (Lower level)

- Assessment
- ASO Office
- Center for Student Success
- ITV
- PACE
- Transfer Center
- FCCHN Office
- Classrooms

2nd Floor (Ground level)

- Assembly Area
- Audio-Visual

- Meeting Rooms 1-6
- Staff Lounge
- Student Community Center

CAMPUS SERVICES BUILDING

- Administrative Services
- Bookstore
- Central Supply
- Fiscal Services
- International Students Office
- Reprographics & Mailroom
- Student Activities
- Veterans Office
- Vice President of Student Services

FACILITIES SERVICES BUILDING

- Sheriff's Department
- Plant Facilities

BUNGALOWS

- Bungalows 1-8

Buildings and Classrooms

INSTRUCTIONAL BUILDING – 1ST FLOOR

Engineering and Computer Science Department
 English and Foreign Languages Department
 Natural Sciences Department

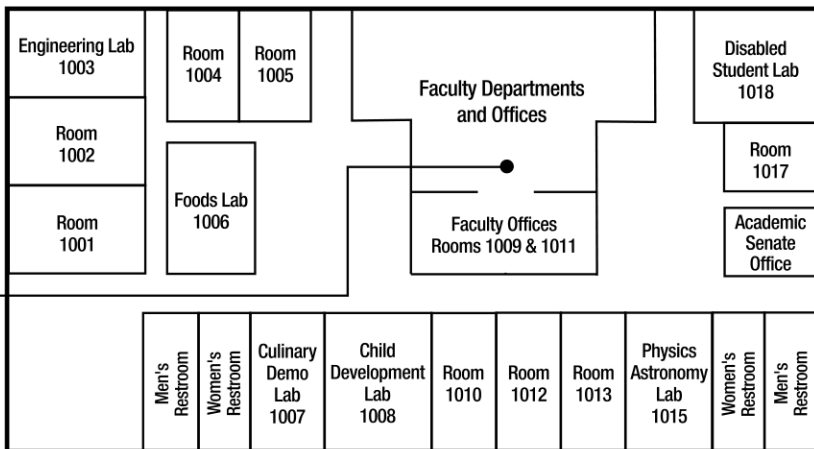

INSTRUCTIONAL BUILDING – 2ND FLOOR

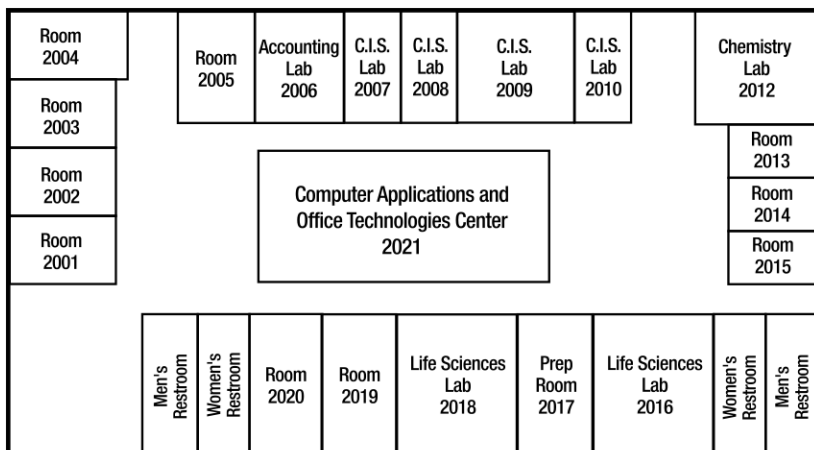

CAMPUS CENTER BUILDING 2ND FLOOR (Ground Level)

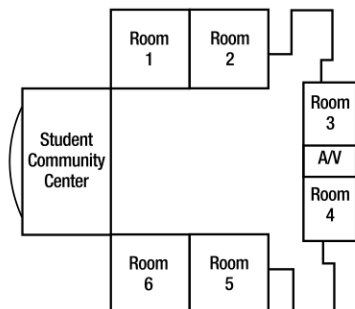

CAMPUS CENTER BUILDING 1ST FLOOR (Lower Level)

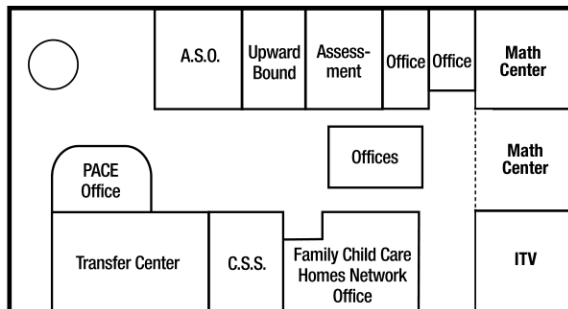

Buildings and Classrooms

GUADALUPE S. RAMIREZ COLLABORATIVE STUDIES BUILDING – 1ST FLOOR

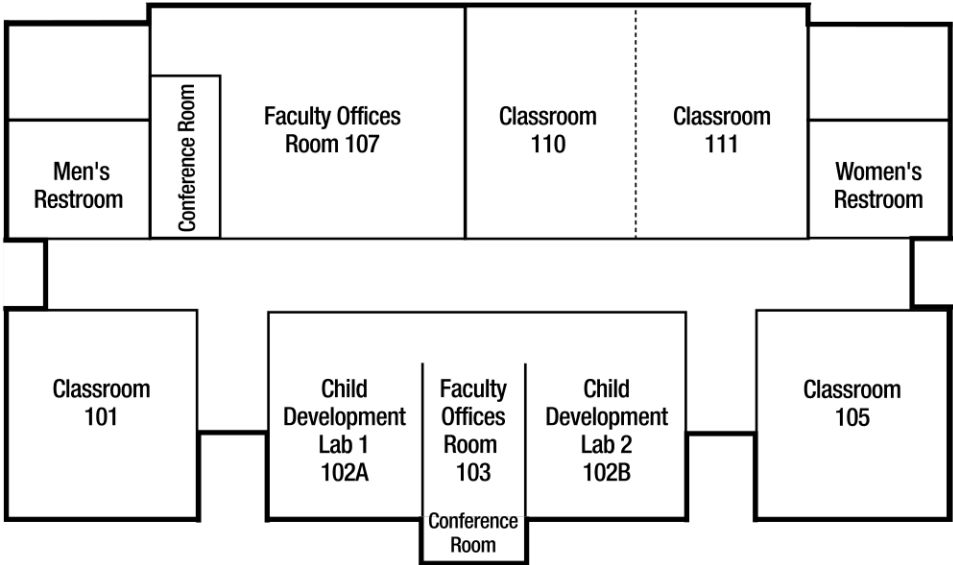

GUADALUPE S. RAMIREZ COLLABORATIVE STUDIES BUILDING – 2ND FLOOR

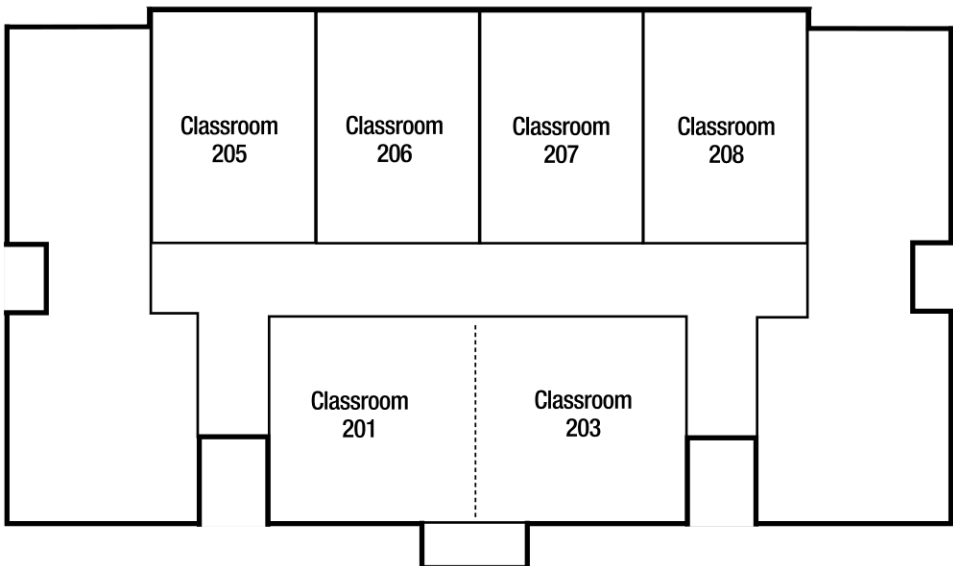

Directions to Mission College and Outreach Locations

Cultural Arts Center (CAC)
13000 Sayre Street

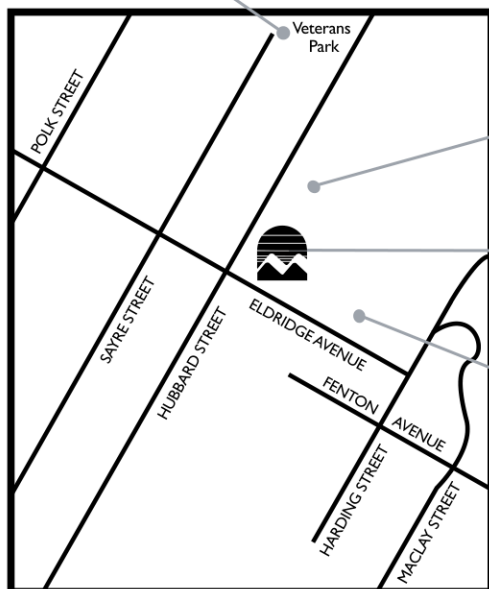

El Cariso Community Regional Park (ELCR-PARK)

LOS ANGELES MISSION COLLEGE
13356 Eldridge Avenue

El Cariso Golf Course (ELCR-GOLF)

Freeway Map and Legend

A / CCRC

Child Care Resource Center
8510 Balboa Boulevard, Northridge

B / CHAT-HS

Chatsworth High School
10027 Lurline Avenue, Chatsworth

C / FOOT

Physical Education Building
12843 Foothill Boulevard, Suite B, Sylmar

D / GRAN-HS

Granada High School
10535 Zelzah Avenue, Granada Hills

E / MONT-PREP

Montclair College Prep
8071 Sepulveda Boulevard, Van Nuys

F / MSSH-BOWL

Mission Hills Bowl
10430 Sepulveda Boulevard, Mission Hills

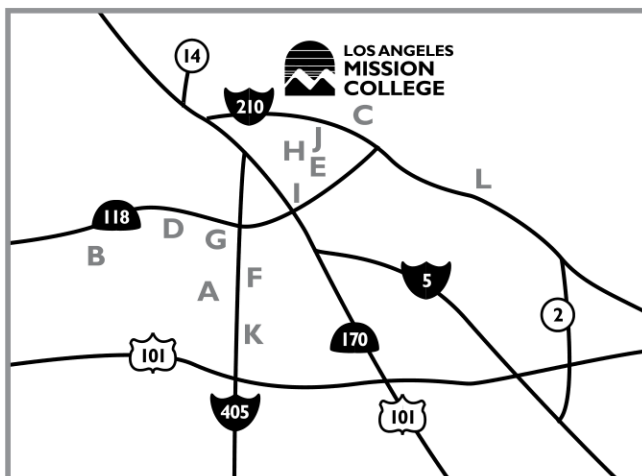

G / One Stop Career Center

11623 Glenoaks Boulevard, Pacoima

H / SFDO-HS

San Fernando High School
11133 O'Melveny Avenue, San Fernando

I / SFVJACC

San Fernando Valley Japanese American Community Center
12953 Branford Street, Pacoima

J / SYLM

Sylmar High School
13050 Borden Avenue, Sylmar

K / VANN-HS

Van Nuys High School
6535 Cedros Avenue, Van Nuys

L / VERD

Verdugo Hills High School
10625 Plainview Avenue, Tujunga

Emergency Information

Fire

1. If you smell smoke or see fire, activate the nearest fire alarm pull box. Call the campus sheriff, extension 7845 or 7843 (outside telephone 818.833.3504). If you are unable to contact the sheriff, call 911.
2. When you hear the fire alarm, proceed in an orderly fashion to the designated building evacuation assembly area. The last person to leave the room should close the door.
3. At the assembly area, wait for further instructions from a faculty member or administrator.

Earthquake

1. At first sign of shaking, get away from any potential falling objects. Try to get under a table or desk.
2. Do not run outside. If you are in a multistory building do not use the elevator.
3. If you are aware of any gas lines or heaters in the area, attempt to shut off the gas line or heater.
4. Wait for a faculty member or administrator to give further instructions.

Power Outage

1. Try to stay where you are and do not attempt to restore power.
2. Notify plant facilities, extension 7801 (outside telephone 818.364.7801).
3. Wait for the power to come back on or for information/ instruction from plant facilities or an administrator to ascertain the probably length of the outage and to be advised of what to do next.

Evacuation

1. If you hear the alarm, proceed in an orderly fashion to the nearest exit and assemble at the designated building evacuation assembly area.
2. If you are in a multistory building, do not use the elevator.
3. At the assembly area, wait for further instructions from a faculty member or administrator.

Other Emergencies

1. In the case of other emergencies, you will be given instructions from a faculty member or administrator on what to do.
2. Please remain calm and follow instructions.

EMERGENCY PHONE NUMBERS

	CAMPUS PHONES	OUTSIDE PHONES
Sheriffs Station	7843	818.364.7843
President	7795	818.364.7795
Academic Affairs Vice President	7635	818.364.7635
Administrative Services Vice President	7780	818.364.7780
Student Services Vice President	7766	818.364.7766
Plant Facilities	7801	818.364.7801
Los Angeles County:		
Police Department	9 - 911	911
Fire Department	9 - 911	911

Pay Telephones: For any emergency - Press *11 to reach L.A County Sheriffs Office



LOS ANGELES COMMUNITY COLLEGE DISTRICT

770 WEST WILSHIRE BOULEVARD | LOS ANGELES, CALIFORNIA 90017 | 213/891-2000

BOARD OF TRUSTEES

Vacant
President

Sylvia Scott-Hayes
Vice President

Kelly G. Candaele

Mona Field

Warren T. Furutani

Georgia L. Mercer

Nancy Pearlman

Luis Gomez
Student Trustee

DISTRICT ADMINISTRATION

Darroch F. Young
Chancellor

Adriana D. Barrera
Senior Vice Chancellor

Larry H. Eisenberg
*Executive Director,
Facilities Planning and Development*

Camille A. Goulet
General Counsel

COLLEGE ADMINISTRATION

Ernest Moreno
President

Dr. Kathleen Burke-Kelly
Vice President, Academic Affairs

Dr. Karen A. Hoefel
Vice President, Administrative Services

Joe S. Ramirez
Vice President, Student Services

Alma Johnson-Hawkins
Dean, Academic Affairs

David Green
Dean, Student Services

Maury Pearl
*Dean, Institutional Research,
Planning and Information Technology*

Edgardo E. Zayas
Dean, Academic Affairs

Belinda Acuña
*Assistant Dean,
Specially Funded Programs, Title V*

OUR MISSION IS... YOUR SUCCESS



13356
Eldridge Ave.
Sylmar, CA 91342
818/364-7600
TDD 818/364-7861
www.lamission.edu