



Newly installed energy-generating solar panels atop parking structure

# 2008 SUMMER Schedule of Classes

SESSION  
JUNE 9 I

SESSION  
JULY 14 II



*Our Mission Is Your Success*



## *Dear Mission College Student:*

*Welcome to your NEW Mission College! There are many new and exciting things happening on campus in which you can be involved. First, we are now really a campus that never sleeps. Our programs have been expanded to serve you beyond our traditional fall and spring semesters. We now have instituted week-end classes, a larger winter inter-session and have expanded our summer offerings. All of these changes have been to better serve you and allow you maximum flexibility in completing your educational goals.*

*If you are a returning student, you will see some of the many physical changes to our campus that will make Mission College a model of a twenty-first century institution of higher learning. Our new Child Care Facility will open it's doors in the fall; construction has begun on the Fitness Center building and you can now park with ease in the multi-level parking structure on the edge of campus. And, if you haven't noticed, the top floor of the parking structure is devoted to a solar energy producing facility that will bring electricity directly to the classrooms of Mission College. We "flipped the switch" for this innovative electricity producing facility last April and Mission can now boast of having it's very own power plant! In addition to being environmentally friendly, this facility will help Mission to keep the costs of your college education low.*

*Mission College has also changed in many ways right before your eyes in the last year. Enrollment has increased significantly and we are expanding our commitment to those in our service area that OUR MISSION IS YOUR SUCCESS. We have developed programs both on and off campus to answer your educational needs. So, whatever your individual goal may be, ask us how we can assist you in achieving that goal.*

*One area of the college, however, that has not changed and will remain a constant for Mission, is our commitment to provide you with the best facilities, best educational experience and best college environment that is possible. Mission College has remained dedicated to student service. For more than three decades our graduates have used Mission as a gateway to higher education, success in business, film, politics, culinary arts, and vocational training. So I personally invite you to take advantage of what we have to offer and allow Mission College to be your Gateway To The Future!*



*Sincerely,*

*Judith Valles,  
President*



## *Table of Contents*

---

Calendar Summer 2008 .....	2
Admissions & Enrollment Information.....	3
Health Fee Information .....	3
Student I.D. ....	3
Student Telephone Enrollment Program (STEP).....	4
California Non-Resident Tuition Exemption Request.....	9
How to Read the Schedule of Classes .....	10
Prerequisites, Corequisites & Advisories .....	11
ESL Program at Mission College .....	12
(Programa de Ingles Como Segundo Idioma).....	12
Community Extension Programs.....	12
Financial Aid.....	13
SESSION I.....	14
Online Classes - Session I .....	27
PACE .....	30
ITV - The Weekend College.....	31
SESSION II .....	32
Online Classes - Session II .....	39
General Policies.....	41
Student Services .....	47
Campus Map .....	49
Buildings & Classrooms .....	50
Directions to Mission College & Outreach Locations.....	52
Emergency Information .....	53

# Calendar

## Registration Dates

The following registration dates apply to all three Summer 2008 Sessions

<b>EOPS &amp; DSPS</b> telephone registration appointments.....	April 14 to 16
<b>Continuing</b> students telephone registration appointments.....	April 17 to May 10
<b>New and re-entering</b> students telephone registration start.....	May 12 to June 9
Walk-in registration.....	May 19

### Session I (5 weeks)

K to 8 student deadline .....	May 23
Memorial Day Holiday .....	May 26
Classes begin .....	June 9
Last day for refund .....	June 12
Last day to add .....	June 12
Last day to petition for CR/NCR.....	June 18
Last day to drop <b>without</b> a "W" .....	June 18
Last day to drop <b>with</b> a "W" .....	July 3
Independence Day Holiday.....	July 4
Final Exam .....	Last day of class
Session Ends.....	July 11

### Session II (5 weeks)

K to 8 student deadline .....	July 3
Classes begin .....	July 14
Last day for refund .....	July 17
Last day to add .....	July 17
Last day to petition for CR/NCR.....	July 23
Last day to drop <b>without</b> a "W" .....	July 23
Last day to drop <b>with</b> a "W" .....	August 7
Final Exam .....	Last day of class
Session Ends.....	August 15

### PACE 9-Week Summer Session

K to 8 student deadline .....	May 23
Memorial Day Holiday .....	May 26
Classes begin .....	June 9
Last day for a refund .....	June 15
Last day to add .....	June 20
Last day to petition for CR/NCR.....	June 27
Last day to drop <b>without</b> a "W" .....	June 27
Last day to drop <b>with</b> a "W" .....	July 25
Final Exam .....	Last day of class
Session Ends.....	August 9

On-Line Registration ..... [www.laccd.edu/student\\_information](http://www.laccd.edu/student_information)

Telephone Registration ..... 818.988.2222  
213.689.8888  
310.605.0505  
323.226.1999

Applications for Admission..... Year Round  
Assessment & Orientation..... Year Round

*Enrollment fees are now only \$20 per unit for ALL California residents\**



Now you can pay registration with your credit card.

\*Fees subject to change by the California Legislature.

## Who Can Attend Los Angeles Mission College?

### LAMC has an open door admissions policy for students who:

- are 18 years of age or over, or
- have completed high school, or
- are under 18 years of age and have their parents' and high school principal's permission to attend.

### Apply at the Admission & Records Office if you...

- are a new student. Complete an application form. Bring proof of your social security number. If you do not have a social security number, we will issue a student ID number.
- did not attend LAMC last semester. Complete an application form. Bring proof of your social security number.

### Enroll in Classes

After you complete the college application process, you can conveniently enroll by phone by following the STEP program on the next pages. You can also enroll in person at the Admissions & Records office on campus.

### Assessment & Orientation

Upon submitting an application to the college, all new non-exempt (see Matriculation Steps to Success for matriculation exemptions) students are required to go through the assessment process. The results from the assessment process will help place students into the appropriate level of English or ESL & Math courses for their first semester.

All new students are encouraged to participate in orientation. Students will learn about the college, educational programs, services, degree requirements and more.

For more detailed information please consult the current college catalog which is available in the College Bookstore and on the college's official website, [www.lamission.edu](http://www.lamission.edu)

### Student Health Fee Information

The Los Angeles Community College Board of Trustees at its April 29, 1992 meeting modified Board rule 8502, thus making the \$11 Health Services fee a mandatory fee for all students enrolled in credit classes.

The Los Angeles Community College District policy exempts the following students from paying the student health fee: (a) low-income students, including students on financial aid and/or recipients of a Board of Governors' grant, (b) students who depend exclusively on prayer for healing in accordance with the teaching of a bona fide religious sect, (c) students who are attending classes under an approved apprenticeship training program, (d) non-credit education students, (e) students enrolled in District colleges exclusively at sites where student health services are not provided, (f) students who are enrolled in District colleges exclusively through Instructional Television or distance education classes, (g) students who are enrolled in District colleges exclusively through contract education. Students exempted under the provisions of (a), (c) and (d) above are eligible to receive the services of the college health program; all other exempted students are not eligible to receive the services of the college health program.

Your registration fee receipt, or your current student I.D. must be presented to receive services.

### Student ID

To comply with federal privacy requirements, Los Angeles Mission College and the Los Angeles Community College District has discontinued use of the Social Security Number as the student's identification number. Instead, a new Student Identification Number will be issued for each student. The new nine-digit number is randomly generated, but each will begin with the digits "88."

Where to use your new student ID card:

A valid student ID card is required to access student services in the following areas:

- Library • Bookstore • Financial Aid
- Health Center • Computer Labs

Your first Student ID Card is free. Go to either admissions or the business office to obtain yours. You will need to present your current student registration/receipt and a second form of ID such as a California ID or a high school picture ID. For additional information, see the F.A.Q. at [www.lamission.edu](http://www.lamission.edu)

## *Student Telephone Enrollment Program (STEP)*

All Los Angeles Mission College students can now enroll by telephone.

Continuing students' appointments to enroll were mailed to their home of record in mid-April. This is a priority registration date based on the number of units you have completed at Mission College. You may enroll by telephone anytime after your appointment until one day prior to the start of classes.

New students will receive their priority telephone enrollment appointments when they complete Assessment testing and Advisement counseling.

### **Before Registering by Phone:**

- clear any holds or find out what type of holds, or financial obligations in the LA Community Colleges. Contact the Business Office (818.364.7783).
- contact the Counseling Office (818.364.7655) for help in planning your program.
- contact the Financial Aid Office (818.364.7648) if you need fee assistance.

The registration system will enforce all English, Math, and ESL prerequisites. Students will only be permitted to enroll in courses for which they are eligible. If, after registering, you feel the system has made an error, please bring your permit of proof of eligibility to a counselor.

### **To Enroll by Phone:**

- Carefully read these instructions.
- Complete the attached worksheet with both your first and second choices of classes.
- Call the STEP system using a touch-tone telephone at the date and time of your enrollment appointment or anytime after your appointment until one day prior to start of classes.

### **STEP System Hours:**

Monday through Saturday from 8:00 am to 11:00 pm

### **STEP Telephone Numbers:**

818.988.2222

213.689.8888

310.605.0505

323.226.1999

### **STEP Ahora también en Español!**

### **STEP is now in Spanish.**

El sistema para inscribirse por teléfono ahora también es en español.

## **TRANSFER CENTER**

**818/364-7827 • [www.lamission.edu/counseling/transfercenter](http://www.lamission.edu/counseling/transfercenter)**

Lower-Level Campus Center #1518



**GET ON TRACK  
TO TRANSFER!**

***GO to the four-year, college/university of your choice!***

### **TRANSFER STRATEGY:**

- Complete Transferable Math and English requirements in the beginning of your academic career.
- Prepare early with transferable general education courses for California State University and/or University of California, Private or Independent.
- Meet with a Counselor to establish and maintain an educational plan.
- Visit the Transfer Center for transfer advisement/counseling and resources.

Fill in all of this information **BEFORE** calling to make the best use of your telephone enrollment call. *(Form continues on next 3 pages.)*

STEP	ITEM	DIRECTIONS
1.	<b>College selection:</b>	Press <b>4</b> for Mission.
2.	<b>Semester:</b>	Press <b>1</b> for Spring.
3.	<b>Student ID Number:</b>	Enter your Student ID number. <input type="text" value="8"/> <input type="text" value="8"/> - <input type="text"/> <input type="text"/> <input type="text"/> <input type="text"/> <input type="text"/> <input type="text"/> <input type="text"/> <input type="text"/>
4.	<b>PIN</b> (Personal Identification Number)	This is the month and date of your birth. (Example: If your birthday is March 5, press 0 3 0 5; if your birthday is October 25, press 1 0 2 5)  <input type="text"/> <input type="text"/> <input type="text"/> <input type="text"/>
5.	<b>Enroll for classes:</b>	Press <b>1</b>
6.	<b>Major code:</b>	Enter your 6-digit major code without the decimal point. <input type="text"/> <input type="text"/> <input type="text"/> <input type="text"/> <input type="text"/> <input type="text"/>
0502.00	Accounting	0901.00 Engineering/Transfer
2104.40	Addiction Studies	0924.00 Engineering
2105.00	Administration of Justice	0924.01 Engineering Assistant
9922.02	Anthropology (Transfer)	0953.00 Engineering CADD and CAM (Manufacturing)
1002.00	Art	1501.00 English
1306.10	Bilingual Food Service Technology	1305.14 Family Child Care Provider
1305.15	Bilingual/Bicultural Pre School	1303.10 Fashion Design
9904.00	Biological Sciences (Transfer)	0504.00 Finance
0501.00	Business Administration	1306.12 Food Management Production Services and Related Techniques
0506.00	Business Management	1306.00 Foods and Nutrition
1305.13	Child Care - School-Age	9922.06 Geography (Transfer)
1305.10	Child Development	1305.30 Gerontology
1305.11	Child Development - Infant/Toddler	1260.00 Health Sciences
1305.12	Child Development - Pre-School	9922.05 History (Transfer)
0701.00	Computer Science	4903.00 Humanities
0701.01	Computer Science - Business Emphasis	4901.00 Interdisciplinary Studies
0514.00	Computer and Office Applications	1302.00 Interior Design
1304.00	Consumer Education and Management	1009.10 Jewelry
1306.11	Culinary Arts/Food Services Management	9914.00 Law (Transfer)
9922.04	Economics (Transfer)	2105.50 Law Enforcement Academy
9908.00	Education (Liberal Studies Transfer)	2105.51 Law Enforcement Officer Candidate
		1402.00 Legal Assisting (Paralegal)
		9949.01 Liberal Arts (Transfer)
		0509.50 Marketing
		1305.00 Marriage and Family Life Studies
		1701.00 Mathematics
		0701.02 Microcomputer Applications Management
		0701.03 Microcomputer Programming
		1099.00 Multimedia
		9910.04 Music (Transfer)
		0514.01 Office Assistant
		1002.10 Painting and Drawing
		1509.00 Philosophy
		1011.00 Photography
		1901.00 Physical Science
		9922.07 Political Science (Transfer)
		2105.20 Probation Officer Candidate
		1303.11 Professional Custom Clothier
		2001.00 Psychology
		2105.30 Security Systems Specialist
		0506.01 Small Business Management
		1105.00 Spanish
		9928.08 Sociology (Transfer)
		2107.50 Teacher's Assistant
		2107.51 Teacher's Assistant - Bilingual/Bicultural
		0809.00 Teacher's Assistant - Exceptional Children
		0003.00 Undecided
7.	<b>Hours worked:</b>	Enter the number of paid hours per week you will be working this semester followed by the pound # sign. If you are working 4 hours each week press <b>0 4</b> ; if you are working 40 hours each week, press <b>4 0</b> . The # sign is located on the lower right hand key of your telephone pad.
	<input type="text"/> <input type="text"/>	

## *Student Enrollment Schedule Worksheet*

Schedule				Alternate			
Sec. No.	Course Name	Time/Days	Units	Sec. No.	Course Name	Time/Days	Units

STEP	ITEM	DIRECTIONS
------	------	------------

**8. Add classes:** Press **1** to add classes.

If a class you select is full and you choose to be placed on standby, you will not be enrolled in the class and you will not be charged for the class. Your standby status will be printed on your Registration/Fee receipt. The class instructor will receive a printout of the standby list prior to the first class meeting. Names are placed on that list in the order of registration. Attend the first class meeting. Instructors will issue Add Permits to students on the standby list as space in the class permits.

Before adding classes, fill out the Student Enrollment Schedule Worksheet (above) with your first choice and second choice of classes. This will help you through the enrollment procedure. Follow the directions for enrolling in classes. Choose your classes from the Schedule of Classes and enter the correct 4-digit section number. Listen carefully to the messages after each selection. If you enroll for any of the English or mathematics courses that require prerequisites, your enrollment will be blocked if you have not completed the prerequisites.

If you have questions concerning prerequisites call 818.364.7868.

---

**9.** Press **#** when you are finished adding classes.

---

**10.** Press **3** to review your program.

---

**11.** Press **9** to review fees. Do not hang up.



### *Determining Your Residency Status*

For enrollment fee purposes you are considered a **RESIDENT** of the state of California if you are:

1. a citizen of the United States **OR** have permanent resident status, are a holder of an asylum or refugee visa, **AND**
2. have lived in the state of California for at least one year and one day.

For enrollment fee purposes you are considered a **NON-RESIDENT** of the state of California if you are:

1. a citizen of the United States **OR** have permanent resident status, are a holder of an asylum or refugee visa, **AND**
2. have **NOT** lived in the state of California for at least one year and one day.

For enrollment fee purposes you are considered an international student if you hold an F-1 Visa or other non-resident visa.

**Auditing a course...** enables you to attend class but not receive a grade or credit. The enrollment fee for auditing a class is \$15 per unit. Be sure to see a counselor because there are certain restrictions on auditing.

12.

**FEE CARD**

Name \_\_\_\_\_

Student ID No:

-

**Enrollment Fee:** \$20 per unit per semester\*  
(all students pay this fee)

units x \$20\* =

**Non-resident Tuition\*\*** (see definition on page 6)

units x \$173\* =

**International student tuition\*** (see definition on page 6)

Additional \$25 Report Fee due once per semester.

units x \$183\* =

**Health Fee** (see information on page 77)

\$8.00 per semester =

**Student Representation Fee:**

\$1.00 per semester =

Optional Fees:

**Associated Student Organization Membership\*\***

\$3.00 per semester =

**Parking Fee\*\*\***

\$10.00 per semester =

**TOTAL** (Pay this amount) =

**Attention Board of Governors Fee Waiver Students:**

Beginning Fall 2006, all students will be charged the health fee (\$11 for Fall and Spring and \$8 for Summer and Winter). This fee will no longer be waived for students who are eligible for a waiver. Please feel free to contact the Financial Aid Office on extension 2412 if you have any questions.

Students are required to pay for classes enrolled in beyond the refund deadline.

\*ALL FEES ARE SUBJECT TO CHANGE BY THE CALIFORNIA LEGISLATURE.

\*\*The Associated Student Organization represents students and supports college programs including extended library hours, tutoring, and college activities such as cultural events and commencement.

A parking permit is required to park in campus, including Saturdays. All parking is on a space available basis.

\*\*\*There are no student parking fee in Summer '08 but you must still obtain a parking permit from the Business Office.

† Non-resident tuition is due upon registration. Students who have not paid all non-resident tuition will be dropped from all classes on the Friday of the fourth week of the semester.

STEP	ITEM	DIRECTIONS
------	------	------------

13.	<b>Payment:</b>	Press <b>1</b> if you <b>WILL pay by credit card</b> . Pay your fees by credit card over the phone and avoid lines at the Business Office. If you choose to pay now by credit card, your semester Registration/Fee Receipt, ID verification sticker, and parking permit (if purchased) will be mailed to you.
-----	-----------------	---

14.	<b>Credit Card Payment:</b>	If you are paying by credit card, enter the card type and number.
	American Express <input type="checkbox"/>	VISA <input type="checkbox"/> Discover <input type="checkbox"/> Mastercard <input type="checkbox"/>
	Card No:	<input type="text"/> <input type="text"/> <input type="text"/> <input type="text"/> <input type="text"/> <input type="text"/> <input type="text"/> <input type="text"/> <input type="text"/> <input type="text"/> <input type="text"/> <input type="text"/> <input type="text"/> <input type="text"/> <input type="text"/> <input type="text"/>
	Expiration Date:	<input type="text"/> <input type="text"/> <input type="text"/> <input type="text"/> <input type="text"/> <input type="text"/>

15.	<b>Other payment:</b>	Press <b>2</b> if you <b>WILL NOT pay by credit card</b> . If you are not paying by credit card, you may pay in person at the Business Office or by mail to: <b>LOS ANGELES MISSION COLLEGE BUSINESS OFFICE - 13356 ELDRIDGE AVENUE - SYLMAR, CA 91342</b> Send <b>FEE CARD</b> (#12) with a check or money order. <u>Do not send cash</u> . Print your Student ID number and semester on the face of your check. Your semester fee receipt, student ID validation, and parking permit (if purchased) will be mailed to you when payment is complete.
-----	-----------------------	--



STEP	ITEM	DIRECTIONS
16.	<b>Program Changes:</b>	You may change your program by telephone or through the STEP and Web system anytime after you enroll through one day prior to the start of classes. You may also change your program in-person in the Admissions & Records Office.
17.	<b>Dropping Classes:</b>	It is your responsibility to drop any classes you stop attending. Do not rely on the instructor to exclude you. You will be liable for all enrollment fees, health fees, and non-resident tuition for any class not dropped by the <u>third day of the session</u> . You can use the STEP and web system at <a href="https://eweb2.laccd.edu">https://eweb2.laccd.edu</a> to drop classes through the 4th week.
18.	<b>ATTENTION! It is the student's responsibility to meet the prerequisites for all courses. Students who fail to do so may be dropped from the class.</b>	

## *Dropping a Course & Enrollment Fee Refund*

If you want to drop a course in which you have enrolled you must complete an official drop card available in the Admissions & Records Office. **It is your responsibility to do this. FEES ARE DUE AT TIME OF ENROLLMENT.** (You may also drop a class by telephone – using the STEP system and through the web system at <https://eweb2.laccd.edu>.)

The date you drop a course determines whether you will receive a refund of your enrollment fee. Normally, the last day to request a refund of your enrollment fee for full-term classes is the Friday of the second week of the semester. **Exceptions are PACE classes and other short-term classes.** Please check the calendar for the official date(s).

### **TO OBTAIN A REFUND:**

- Drop the course by the deadline at the Admissions & Records Office, (may also be done by through the STEP system)
- **Request refund at Business Office (refunds are not automatically issued).**
- If you paid your fees by **CHECK**, a refund check will be issued.
- If you paid your fees by **CREDIT CARD**, the refund will be credited to your credit card.
- If you paid by **CASH**, refunds up to \$100 will be made in cash; if your refund is more than \$100, a refund check will be issued.

### *Board of Governors Fee Waiver Program – BOGFW-B*

Do you need assistance paying for enrollment fees?

The Board of Governors Fee Waiver Program (commonly referred to as BOGG) is a California state program that waives enrollment fees. This waiver does not have to be repaid.

**Eligibility:** Students must be residents of California, and they must receive state assistance or meet minimum income standards or demonstrate financial need as determined by the federal financial aid application (FAFSA).

**How to apply:** Fill out the Free Application for Federal Student Aid (FAFSA) form available in the Financial Aid Office or fill out the online application at [www.fafsa.ed.gov](http://www.fafsa.ed.gov)

**NEW!** Effective Fall 2006 semester, the Health Fee will not be waived for all Fee Waiver eligible students.

**Note:** Audited classes are not covered by the Board of Governor's Fee Waiver Program. Students are solely responsible for payment of enrollment fees for audited classes. No exception to this policy can be made.

# *California Non-Resident Tuition Exemption Request For Eligible California High School Graduates*

Complete and sign the form to request an exemption from Non-resident Tuition. You must submit any documentation required by the College or University (for example, proof of high school attendance in California). Contact the California Community College, University of California or California State University campus where you intend to enroll (or are enrolled) for instructions on documentation, additional procedures and applicable deadlines.

**ELIGIBILITY:**

I, the undersigned, am applying for a California Non-Resident Tuition Exemption for eligible California high school graduates at (specify college or university) \_\_\_\_\_ and I declare the following:

**Check YES or NO boxes:**

YES  NO I have graduated from a California high school or have attained the equivalent thereof, such as a High School Equivalency Certificate, issued by the California State GED Office or a Certificate of Proficiency, resulting from the California High School Proficiency Examination.

YES  NO I have attended high school in California for three or more years.

**Provide information on all school(s) you attended in grades 9-12:**

SCHOOL	CITY	STATE	DATES	
			FROM - Month/Year	TO - Month/Year

Documentation of high school attendance and graduation (or its equivalent) is required by the University of California, the California State University and some California Community Colleges. Follow campus directions.

**Check the box that applies to you (check only one box):**

I am a non-immigrant alien as defined by federal law (including, but not limited to, a foreign student [F visa] or exchange visitor [J visa]).

I am NOT a non-immigrant alien (including, but not limited to, a U.S. citizen, permanent resident, or an alien with out lawful immigration status).

**AFFIDAVIT:**

I, the undersigned, declare under penalty of perjury under the laws of the State of California that information I have provided on this form is true and accurate. I understand that this information will be used to determine my eligibility for the non-resident tuition exemption for eligible California high school graduates. I hereby declare that, if I am an alien without lawful immigration status, I have filed an application to legalize my immigration status or will file an application as soon as I am eligible to do so. I further understand that if any of the above information is untrue, I will be liable for payment of all non-resident charges from which I was exempted and may be subject to disciplinary action by the College or University.

Print Full Name (as it appears on your campus student records)	Campus/Student Identification Number
Print Full Mailing Address (number, street, city, state, zip code)	Email address (optional)
	Phone number (optional)
Signature	Date



# Prerequisites, Corequisites & Advisories

**Prerequisite:** A requirement that must be satisfied before enrolling in the target course.

**Corequisite:** A requirement that must be taken simultaneously with the target course. However, in some instances the corequisite may be satisfied before enrolling into the target course.

**Advisory:** A course or condition that a student is advised (but not required) to meet prior to enrolling in the target course.

## Registration Limitation

All students need to demonstrate meeting the prerequisite or corequisite requirement in order to enroll into the target course.

- If the student satisfies the requirement by completing a class with a grade of “C” or better at LAMC or through the assessment process, he/she will be cleared for registering into the target course.
- If the student has satisfied the prerequisite or corequisite and/or placement at another college or through another method, he/she must submit the appropriate documentation (i.e. an unofficial transcript and/or placement results) to the counseling office located in the Instructional and Student Services Building (818.364.7655).

Once a counselor reviews the documents and finds that the prerequisite or corequisite has been satisfied, the counselor will issue a course placement authorization form. This form, once signed by the counselor, needs to be turned into the Admissions office along with the necessary add slip by the student for processing.

## Prerequisite Challenge

Students without transcripts or other proof of meeting the specified prerequisite or corequisite but believe that they have other clear and reliable evidence that they are adequately prepared to take the target course may go through the prerequisite or corequisite challenge process.

Prerequisite or Corequisite may be challenged based on the following:

1. The student has the knowledge or ability to succeed in the target course despite not meeting the prerequisite or corequisite. (Criteria for challenging based on knowledge or ability to succeed will be determined by each Academic Department.);
2. The prerequisite or corequisite is not valid because it has not been established in accordance with the District’s policy;
3. The prerequisite or corequisite is being applied in an unlawfully discriminatory manner; and
4. The prerequisite or corequisite has not been made reasonably available causing the student undue delay in completing his/her educational goal.

## Prerequisite Challenge Process

1. Pick up the challenge form at the Counseling Office. It is recommended that a student seeking to go through the challenge process meet with a counselor to discuss the process in further detail.
2. All challenge forms must be processed prior to the add deadline as stated in the Schedule of Classes (please note: the challenge process takes five working days to complete). Challenges filed after this deadline will be considered for the following semester. If space is available in a course when a student files a challenge to the prerequisite or corequisite, the student will be allowed to enroll into the course during the challenge process. If the challenge is approved or the college fails to resolve the challenge within 5 working days, the student shall be allowed to remain in the course. If the challenge is denied, the student will be notified and dropped administratively. If no space is available in the course when a challenge is filed and approved, the student shall be permitted to enroll for the following semester.
3. Students need to complete the challenge form, attach appropriate documentation and take the form to the Chair and/or Vice Chair of the department through which the course in question is being offered.
4. The Department Chair and/or Vice Chair will approve or deny the challenge. If the Chair and/or Vice Chair is the instructor of the course that the student wishes to enter, then the Chair and/or Vice Chair will identify another faculty member in the discipline to review and approve the challenge form.
  - Once the challenge is approved/denied and signed, the Chair and/or Vice Chair of the department or designated faculty member will return the form to the Matriculation Coordinator.
  - The Matriculation Coordinator will contact the student of the results of the challenge.
  - If the challenge is approved, the student will be given a course placement authorization that the student will take to Admissions along with the necessary add form for processing.
5. If the challenge is denied, the student may appeal the decision to the Vice President of Academic Affairs. Notification of the appeal decision will be sent to the student within 5 working days after its receipt.



## *ESL Program at Mission College*

---

### Levels and Classes:

The ESL program at Mission College is very comprehensive. It has six levels, twelve units each. It is the philosophy of the department not to teach language skills in isolation, consequently some classes are combined. Students receive maximum benefit from taking all classes of each level concurrently.

Level 1: ESL 1 integrated (combined skills) -12 units

Level 2: ESL 2 integrated (combined skills) -12 units

Levels 3,4,5,6 have two segments:

1. A - Writing/Grammar - 6 units
2. B - Reading/Vocabulary - 3 units
- C - Listening/Speaking - 3 units

### Assessment - Which Level Should I Take?

Students must go through the assessment process which will show what level they should enroll in. All colleges use different systems, so students cannot rely on class levels from another college or adult school to choose the correct class. It will probably be different at Mission College.

After attending classes, students who believe they are in the wrong level should confer with their instructor. That is the person who can best judge the appropriateness of the level.

For information call: 818.364.7735

## *Programa de Ingles Como Segundo Idioma*

---

El programa de inglés como segundo idioma (ESL) en Los Angeles Mission College se compone de seis niveles, cada nivel es de doce unidades. La filosofía del programa es la de enseñar las destrezas del idioma combinadas de acuerdo al nivel, para que los estudiantes reciban el máximo beneficio.

Nivel 1: ESL 1 integrado (habilidades combinadas) - 12 unidades

Nivel 2: ESL 2 integrado (habilidades combinadas) - 12 unidades

Niveles 3,4,5,6 se componen de dos segmentos:

1. A - Escritura/Gramática - 6 unidades
2. B - Lectura/Vocabulario - 3 unidades
- C - Destrezas auditivas/Conversación - 3 unidades

Dias de clases: lunes, martes, miércoles y jueves

Horario: mañanas de 9:00 a 12:00

noches de 6:00 a 9:00, 7:00-10:10

Para información llamar al teléfono:

818.364.7735

Ayuda financiera a quienes califiquen

### **Community Extension**

The Community Extension Program at Los Angeles Mission College offers a wide variety of non-credit courses and one-time seminars for personal and skill development, cultural enrichment and recreational enjoyment for all ages in our community. Courses and workshops are offered year-round in such areas as fine and handcrafted art, floral design, performing arts and music, personal power, dance exercise, money and business, careers, digital media production, languages, kids college, computers and more! For further information please call our office at 818.364.7387 from 8:00 a.m. to 6:00 p.m. Mon.-Thu. and 8:00 a.m. to 5:00p.m. on Fri.

### **Traffic School**

For drivers who have received current traffic citations, the Community Extension Program provides Traffic Violators School on Saturdays only for eight hours. Pre-enrollment is necessary. Please call 818.364.7390 for registration information.

### **Escuela de Tráfico**

Para aquellas personas que han recibido una infracción de tráfico recientemente, el programa "Community Extension" de Mission College ofrece ocho horas de clase de tráfico en español solo los sábados. Es necesario inscribirse con anticipación. Por favor llame al 818.364.7390 para más información.



## Financial Aid

### Do you need assistance paying your enrollment fees?

The Board of Governors Fee Waiver Program (commonly referred to as BOGG) is a California state program that waives enrollment fees. This waiver does not have to be repaid.

**Eligibility:** Students must be residents of California, and they must receive state assistance or meet minimum income standards or demonstrate financial need as determined by the federal financial aid application (FAFSA).

**How to apply:** Fill out 2007-2008 Free Application for Federal Student Aid (FAFSA) form available in the Financial Aid Office or fill out the online application at [www.fafsa.ed.gov](http://www.fafsa.ed.gov).

**NEW!** Effective Fall 2006 semester, the Health Fee will not be waived for all Fee Waiver eligible students

**Note:** Audited classes are not covered by the Board of Governors Fee Waiver Program. Students are solely responsible for payment of enrollment fees for audited classes. No exception to this policy can be made.

### Financial Aid & Scholarships

818.364.7648

Email: [lamcfinaid@lamission.edu](mailto:lamcfinaid@lamission.edu)

Financial aid is made available by federal, state and private sources in the form of grants, scholarships, loans, and employment. Most financial aid resources are intended to supplement, not replace, the financial resources of the family to help pay for the cost of college education.

The Financial Aid Office offers many services to our students including financial aid awareness and FAFSA hands on workshops. Financial Aid counseling is available by appointment with the Financial Aid Director. Our Financial Aid Staff will answer your questions in person and over the phone with FERPA regulations for student privacy. We are here to help you fund your cost of education. Stop by the Financial Aid Office or visit our Financial Aid website at [www.lamission.edu/financialaid](http://www.lamission.edu/financialaid). Remember that you are in charge of your education; we are here to help you finance it.

### How To Apply for Financial Aid:

To apply for Summer 2008 financial aid, you must use the 2007-2008 Free Application for Federal Student Aid (FAFSA) and must submit it before June 30, 2008.

Applying for financial aid is in two easy steps:

**Step 1:** Apply for a Personal Identification Number (PIN) at [www.pin.ed.gov](http://www.pin.ed.gov). If you already have a PIN assigned to you by the United States Department of Education, go to Step 2.

**Step 2:** Apply for financial aid at [www.fafsa.ed.gov](http://www.fafsa.ed.gov). Remember, to apply for Summer 2008 financial aid, use the 2007-2008 FAFSA. Our Federal School Code is 012550.

### When Do I Apply?

We encourage our students to apply as early as January 1, 2007 and apply before March 2, 2007 for the 2007-2008 academic year.

Our priority deadline to submit all required documents is May 1, 2007. Students who have missed the priority date may still apply as funds may be available. If in doubt, please visit our Financial Aid Office. Staff members are available during regular office hours to answer your questions and assist you in completing any of the forms.

If you will be continuing your education for the Fall 2008, you must reapply for financial aid starting Jan 1, 2008 and you must submit your 2008-2009 Free Application for Federal Student Aid (FAFSA) before March 2, 2008 to apply for the Cal Grant Program.

### Office Hours:

Monday and Thursday	10:00 am – 2:00 pm and 5:00 pm – 7:00 pm
Tuesday and Wednesday	10:00 am - 2:00 pm
Friday	Closed

**Note:** Financial Aid does not pay for audited classes.

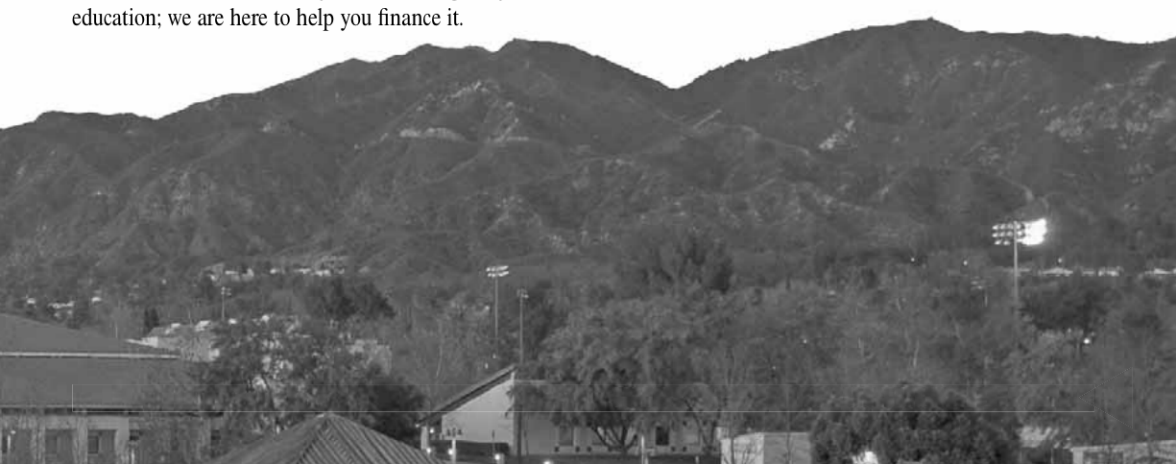

## ADMINISTRATION OF JUSTICE Business & Law

### 001 INTRO TO ADMINISTRATION OF JUSTICE

(UC:CSU) - 3.00 UNITS

Prerequisite: None

The history and philosophy of administration of justice including the various subsystems---police, courts, corrections, etc.

0160 LEC 10:35-1:05 MTWTh Sinclair, R CSB 208  
3046 LEC 7:30-10:00 MTWTh Smith, P INST 1012

### 003 LEGAL ASPECTS OF EVIDENCE - 3.00 UNITS

Prerequisite: None

Origin, development, philosophy and constitutional basis of evidence in criminal cases.

3134 LEC 7:30-9:55 MTWTh Mahanay, L CSB 111

### 004 PRINCIPLES & PROCEDURES

**OF THE JUSTICE SYSTEM** (UC:CSU) - 3.00 UNITS

Prerequisite: None

A study of the various agencies in the criminal justice arena.

0164 LEC 1:25-3:55 MTWTh Enos, K CSB 111

### 006 PATROL PROCEDURES - 3.00 UNITS

Prerequisite: None

Principles and procedures of patrol activities.

0179 LEC 10:35-1:05 MTWTh Laflamme, F CSB 101

### 039 PROBATION & PAROLE - 3.00 UNITS

Prerequisite: None

Examination of community treatment in the correctional process, contemporary usage of presentence investigation, selection, and of probationers and parolees.

3048 LEC 7:30-9:55 MTWTh Kovnator, G INST 1010

### 067 COMMUNITY RELATIONS I

(UC:CSU) - 3.00 UNITS

Prerequisite: None

A study of the various agencies of the justice system and their attempts to gain the confidence and support of the citizens they serve. Community-based policing is highlighted.

3067 LEC 6:00-9:20 F Staff INST CLAB  
AND LEC 9:00-12:20 S Staff INST 2005

### 160 POLICE ORGANIZATION & ADMINISTRATION

3.00 UNITS

3137 LEC 4:45-7:10 MTWTh Enos, K CSB 203

### 921 COOP ED - ADMINISTRATION OF JUSTICE

2.00 UNITS Rpt 3

9093 3:20 hrs TBA Raskin, E Schedule  
(10 Week Class - Starts 6/9/2008, Ends 8/15/2008 )

### 931 COOP ED - ADMINISTRATION OF JUSTICE

3.00 UNITS Rpt 3

9094 5:30 hrs TBA Raskin, E Schedule  
(10 Week Class - Starts 6/9/2008, Ends 8/15/2008 )

### 941 COOP ED - ADMINISTRATION OF JUSTICE 4.00 UNITS Rpt 3

Supervised training is conducted in the form of on-the-job training in an employment area that will enhance the student's educational goals.

9095 7:50 hrs TBA Raskin, E Schedule  
(10 Week Class - Starts 6/9/2008, Ends 8/15/2008 )

## ANATOMY Life Science

Faculty Advisor: Mike Reynolds - 818.364.7695

### 001 INTRO TO HUMAN ANATOMY

(UC:CSU) - 4.00 UNITS

Prerequisite: Bio 3 with a grade of C or better.

Advisory: English 28 or ESL 8.

Equivalent to: CSUN Biology 211 and 212; CSULA Biology 200A + 200B with completion of Physiology 1.

3011 LEC 5:25-6:50 MTWTh Ebneshahidi, A INST 2001  
AND LAB 7:00-8:30 MTWTh Ebneshahidi, A INST 2018  
(8 Week Class - Starts 6/9/2008, Ends 8/1/2008 )

## ANTHROPOLOGY Life Science

Faculty Advisor: Arthur Gribben - 818.364.7600 x4235

### 101 HUMAN BIOLOGICAL EVOLUTION

(UC:CSU) - 3.00 UNITS

Advisory: English 28 or ESL 8.

0220 LEC 10:35-1:00 MTWTh Gribben, A INST 1015

0221 LEC 1:25-3:55 MTWTh Gribben, A INST 1015

## ART Arts, Health & Physical Education

### 101 SURVEY OF ART HISTORY I

(UC:CSU) - 3.00 UNITS

Advisory: English 21

Satisfies one of two Art History requirements for Art majors.

A study is made of the historical development of art from prehistoric through the gothic era, with attention given to the painting, sculpture and architecture of each period. Emphasis is put on the relationship of art to culture within our western artistic tradition; with a brief survey of eastern, pacific and pre-Columbian periods include.

0246 LEC 10:30-12:55 MTWTh Staff CSB 207

### 103 ART APPRECIATION I (UC:CSU) - 3.00 UNITS

Prerequisite: None

Advisory: English 21.

This class is an introductory course that involves the students in an exploration into the nature and appreciation of the visual arts.

All sections may be taken for honors credit. See the Honors Counselor.

3103 LEC 4:45-7:10 MTWTh Staff CSB 207

Starts 6/9/2008, Ends 7/1/2008 except as noted.

**109 THE ARTS OF AFRICA, OCEANIA, & ANCIENT AMERICA** (UC:CSU) - 3.00 UNITS

Prerequisite: None

This course is a survey of the painting, sculpture, architecture and craft of Africa, the Pacific Ocean areas and the Indians of North and South America in relation to their history, religion, and general culture.

0162 LEC 10:30-12:55 MTWTh Staff CSB 207

**201 DRAWING I** (UC:CSU) - 3.00 UNITS

Prerequisite: None

Introductory problems in two-dimensional representation of nature with various drawing media; utilizing the elements of design, introductory perspective, with emphasis on the organization of vision and thought in terms of drawing techniques, composition and structure. Required of Art Majors and Multimedia Block I.

7104 LEC 7:45-9:20 MTWTh Zarcone, J CAC 2&3

AND LAB 9:45-11:05 MTWTh Zarcone, J CAC 2&3

**501 BEGINNING TWO-DIMENSIONAL DESIGN**

(UC:CSU) - 3.00 UNITS

Prerequisite: None

A study of the elements and principles of design. A foundation course in design for application in all subsequent Art major courses. Emphasis is placed upon line, color, texture, shape and composition. Part of the Multimedia Studies Foundation Block I. Required for Art Majors.

6109 LEC 6:35-8:10 MTWTh Staff CAC 1

AND LAB 8:10-9:45 MTWTh Staff CAC 1

**520 DESIGN WORKSHOP** - 3.00 UNITS

Prerequisite: Art 501.

This is a course in the principles of design. Emphasis is placed on individual research, experimentation, and the development of style. Students work with a variety of art materials.

6110 LEC 6:35-8:10 MTWTh Staff CAC 1

AND LAB 8:10-9:45 MTWTh Staff CAC 1

**A**STRONOMY  
Physical Science

Faculty Advisor: Richard Rains - 818.364.7702

**001 ELEMENTARY ASTRONOMY**

(UC:CSU) - 3.00 UNITS

Advisory: English 21, or ESL 6.

All sections may be taken for honors credit. See the Honors Counselor.

3033 LEC 4:40-7:10 MTWTh Rains, R INST 1015

Astronomy 1 also offered through ITV. See page 31.

**005 FUNDAMENTALS OF ASTRONOMY**

**LABORATORY** (UC:CSU) - 1.00 UNIT

Prerequisite or Corequisite: Astronomy 1.

3124 LAB 7:30-10:00 MTWTh Rains, R INST 1015

**BIOLOGY**  
Life Science

Faculty Advisor: Michael Reynolds - 818.364.7695

**003 INTRO TO BIOLOGY** (UC:CSU) - 4.00 UNITS

Advisory: English 28 or ESL 8.

Equivalent to CSUN Biology 101/100L; CSULA Biology 155 or 156, or 180.

0223 LEC 2:00-3:35 MTWTh Reynolds, J INST 2001

AND LAB 3:40-6:50 MW Reynolds, J INST 2019

0243 LEC 2:00-3:35 MTWTh Reynolds, J INST 2001

AND LAB 3:40-6:50 TTh Reynolds, J INST 2019

(8 Week Class - Starts 6/9/2008, Ends 8/1/2008)

Biology 3 also offered through PACE. See page 30.

**033 MEDICAL TERMINOLOGY** - 3.00 UNITS

Prerequisite: None

Medical terms related to the structure and function of the human body in health and disease. Ideal for allied Math students.

0181 LEC 6:30 hrs TBA Saeki, W Internet

Email: [www.lamission.edu/lifesciences/saeki](http://www.lamission.edu/lifesciences/saeki)

(8 Week Class - Starts 6/9/2008, Ends 8/1/2008)

**040 THE SCIENCE OF BIOTECHNOLOGY**

(UC:CSU) - 3.00 UNITS

Prerequisite: Biology 6 and Chemistry 101 or equivalents with a grade of C or better.

Advisory: English 28 or ESL 8.

3152 LEC 5:30-7:30 MTW Jayachandran, S INST 2016

AND LAB 7:35-9:35 MTW Jayachandran, S INST 2016

(6 Week Class - Starts 6/9/2008, Ends 7/17/2008)

**921 COOP ED - BIOLOGY** - 2.00 UNITS Rpt 3

9009 LEC 3:20 hrs TBA Raskin, E SCHEDULE

(10 Week Class - Starts 6/9/2008, Ends 8/15/2008)

**931 COOP ED - BIOLOGY** - 3.00 UNITS Rpt 3

9010 LEC 5:50 hrs TBA Raskin, E SCHEDULE

(10 Week Class - Starts 6/9/2008, Ends 8/15/2008)



SESSION 1

Starts 6/9/2008, Ends 7/1/2008 except as noted.

**941 COOP ED - BIOLOGY** - 4.00 UNITS Rpt 3  
 Supervised training is conducted in the form of on-the-job training in an employment area that will enhance the student's educational goals.  
 9011 LEC 7:50 hrs TBA Raskin, E SCHEDULE  
 (10 Week Class - Starts 6/9/2008, Ends 8/15/2008 )

**B** *BUSINESS*  
 Business & Law

**001 INTRO TO BUSINESS** (UC:CSU) - 3.00 UNITS  
 Prerequisite: None

The student will learn the various forms of business organizations. The student will study business management, organization, financing and marketing, and also become acquainted with the risks involved in business and with government's role in business.

3018 LEC 4:45-7:10 MW Bernal, V CSB 205  
 AND IND 5:35 hrs TBA Bernal, V Internet  
 3051 LEC 5:30-7:55 MTWTh Fujitani, D INST 2006

**005 BUSINESS LAW I** (UC:CSU) - 3.00 UNITS  
 Prerequisite: None

Same as Law 1.  
 0213 LEC 10:30-12:55 MTWTh Rush, C INST 2006

**921 COOP ED - BUSINESS** 2.00 UNITS Rpt 3  
 9013 3:20 hrs TBA Raskin, E Schedule  
 (10 Week Class - Starts 6/9/2008, Ends 8/15/2008 )

**931 COOP ED - BUSINESS** 3.00 UNITS Rpt 3  
 9014 5:50 hrs TBA Raskin, E Schedule  
 (10 Week Class - Starts 6/9/2008, Ends 8/15/2008 )

**941 COOP ED - BUSINESS** 4.00 UNITS Rpt 3  
 Supervised training is conducted in the form of on-the-job training in an employment area that will enhance the student's educational goals.  
 9015 7:50 hrs TBA Raskin, E Schedule  
 (10 Week Class - Starts 6/9/2008, Ends 8/15/2008 )

**B** *BUSINESS - ECONOMICS*  
 Business & Law

**001 PRINCIPLES OF ECONOMICS I**  
 (UC:CSU) - 3.00 UNITS

Prerequisite: None  
 This class may be taken for honors credit. See the Honors Counselor.  
 0141 10:30-12:55 MTWTh Espinoza, A CSB 111  
 Economics 1 also offered through ITV. See page 31.

**002 PRINCIPLES OF ECONOMICS II**  
 (UC:CSU) - 3.00 UNITS

Prerequisite: None  
 This class may taken for honors credit. See the Honors Counselor.  
 0133 1:15-3:40 MTWTh Danai, M INST 2006  
 Economics 2 is also offered through PACE. See page 30.

**B** *BUSINESS - MANAGEMENT*  
 Business & Law

**013 SMALL BUSINESS ENTREPRENEURSHIP**  
 (CSU) - 3.00 UNITS

Prerequisite: None  
 This course presents a systematic approach to successful small business operation.  
**3101 LEC 7:30-9:55 MW Bernal, V CSB 207**  
 AND LEC 6:05 hrs TBA Bernal, V Internet  
 www.lamission.edu/business/bernal

Management 13 is also offered in ITV. See page

**921 COOP ED - MANAGEMENT** 2.00 UNITS Rpt 3  
 9049 3:20 hrs TBA Raskin, E Schedule  
 (10 Week Class - Starts 6/9/2008, Ends 8/15/2008 )

**931 COOP ED - MANAGEMENT** 3.00 UNITS Rpt 3  
 9050 5:50 hrs TBA Raskin, E Schedule  
 (10 Week Class - Starts 6/9/2008, Ends 8/15/2008 )

**941 COOP ED - MANAGEMENT** 4.00 UNITS Rpt 3  
 Supervised training is conducted in the form of on-the-job training in an employment area that will enhance the student's educational goals.  
 9051 7:50 hrs TBA Raskin, E Schedule  
 (10 Week Class - Starts 6/9/2008, Ends 8/15/2008 )

**C** *CHEMISTRY*  
 Physical Science

Faculty Advisor: Said Pazirandeh - 818.364.7705

**051 FUNDAMENTALS OF CHEMISTRY I**  
 (UC:CSU) - 5.00 UNITS

Prerequisite: Math 115 with a grade of "C" or better, or appropriate Math placement results.  
 Equivalent to CSUN Chem 103 or 105.  
 This course is intended for nursing, nutrition, dietetics, food science, and environmental and occupational health majors. It provides an introduction to chemistry for the student with no previous background in chemistry.  
 Note: Not open for credit to students who have credit in Chem 101.

0222 LAB 8:00-10:05 MTWThF Staff INST 2012  
 AND LEC 10:25-1:15 MTWThF Staff INST 2003

**101 GENERAL CHEMISTRY I** (UC:CSU) - 5.00 UNITS

Prerequisite: Chem 65 with a grade of "C" or better, or appropriate placement test results and Math 125 with a grade of "C" or better, or appropriate Math placement results (For Placement Test questions contact 818.364.7868).  
 Equivalent to CSUN Chemistry 101.

The course covers fundamental chemical principles and theories with special emphasis on stoichiometry, atomic structure, periodic table, chemical bonding, solutions, acids and bases, oxidation-reduction, and properties of gases.  
 0153 LEC 8:00-9:25 MTWTh Pazirandeh, S INST 2003  
 AND LAB 9:30-10:05 MTWTh Pazirandeh, S INST 2003  
 AND LAB 10:25-12:50 MTWTh Pazirandeh, S INST 2012  
 (9 Week Class - Starts 6/9/2008, Ends 8/4/2008 )

Starts 6/9/2008, Ends 7/11/2008 except as noted.

Faculty Advisor: Jose Maldonado- Phone: 818.364.3412.

**002 THE MEXICAN-AMERICAN IN CONTEMPORARY SOCIETY** (UC:CSU) - 3.00 UNITS

Prerequisite: None  
7103 LEC 2:20-4:50 MTWTh Morales, J JEFF HS

**007 THE MEXICAN-AMERICAN IN THE HISTORY OF THE UNITED STATES I** (UC:CSU) - 3.00 UNITS

Prerequisite: None  
Traces the historical evolution of the Mexican-American to 1850.  
0168 LEC 10:30 hrs TBA Maldonado, J Internet  
Email:maldonaja@lamission.edu

0200 LEC 7:45-10:10 MTWTh Staff CSB 203  
6158 LEC 3:30-5:55 MTWTh Camacho, J SFDO HS

**008 THE MEXICAN-AMERICAN IN THE HISTORY OF THE UNITED STATES II** (UC:CSU) - 3.00 UNITS

Prerequisite: None  
This class may be taken for honors credit. See the Honors Counselor.  
0101 LEC 10:30 hrs TBA Morales, J Internet  
Email:moralej@lamission.edu

**037 CHICANO LITERATURE** (UC:CSU) - 3.00 UNITS

Prerequisite: None  
0173 LEC 10:30 hrs TBA Maldonado, J Internet  
Email:maldonaja@lamission.edu  
3100 LEC 7:30-10:00 MTWTh Staff CSB 203

**001 CHILD GROWTH & DEVELOPMENT** (UC:CSU) - 3.00 UNITS

Prerequisite: None  
Covers the development of a child from the prenatal stage through adolescence.  
0119 LEC 7:45-10:15 MTWTh Singh, M CSB 102B  
3000 LEC 7:30-10:00 MTWTh Murphy, K CSB 102A

**002 EARLY CHILDHOOD: PRINCIPLES & PRACTICES** - 3.00 UNITS

Prerequisite: None  
Preschool principles, practices (including discipline and guidance) and philosophies.  
0102 LEC 1:25-3:50 MTWTh Ruelas, J CSB 102A

**004 CREATIVE EXPERIENCES FOR CHILDREN II** 3.00 UNITS

Advisory: Child Dev 1 and 2.  
Language Arts, Math, Social Studies, Science, perceptual motor development and cooking.  
Taught bilingually (English/Spanish).  
3003 LEC 4:40-7:05 MTWTh Ruelas, J CSB 102A

**010 CHILD HEALTH** (CSU) - 3.00 UNITS

Prerequisite: None  
Health and safety, communicable illness and management, safe environment, child nutrition. Pediatric First Aid and Cardio-Pulmonary-Respiration certificates will be issued.  
3055 LEC 4:40-7:10 MTWTh Staff INST 1008

**011 HOME, SCHOOL, & COMMUNITY RELATIONS** (CSU) - 3.00 UNITS

Prerequisite: None  
Changes in families and schools, parent conferencing and community resources.  
0129 LEC 10:35-1:05 MTWTh Silver, J CSB 102A

**045 PROGRAMS FOR CHILDREN WITH SPECIAL NEEDS II** - 3.00 UNITS

Prerequisite: None  
Study of programs for exceptional children (special education) and "mainstreaming."  
3002 LEC 4:40-7:05 MTWTh Doelitzsch, P CSB 102B

**921 COOP ED - CHILD DEVELOPMENT** 2.00 UNITS Rpt 3

9021 3:20 hrs TBA Raskin, E Schedule  
(10 Week Class - Starts 6/9/2008, Ends 8/15/2008)

**931 COOP ED - CHILD DEVELOPMENT** 3.00 UNITS Rpt 3

9022 5:50 hrs TBA Raskin, E Schedule  
(10 Week Class - Starts 6/9/2008, Ends 8/15/2008)

**941 COOP ED - CHILD DEVELOPMENT** 4.00 UNITS Rpt 3

Supervised training is conducted in the form of on-the-job training in an employment area that will enhance the student's educational goals.  
9023 7:50 hrs TBA Raskin, E Schedule  
(10 Week Class - Starts 6/9/2008, Ends 8/15/2008)

**003 HISTORY OF MOTION PICTURES** (UC:CSU) - 3.00 UNITS

Prerequisite: None  
This course includes history of the development of motion pictures, with examples screened from the silent film to the present day. Emphasis is placed on American feature films.  
All sections may be taken for honors credit. See the Honors Counselor.  
3026 LEC 4:40-6:15 MTWTh Levine, S LRC TCR  
AND LAB 6:15-7:50 MTWTh Levine, S LRC TCR

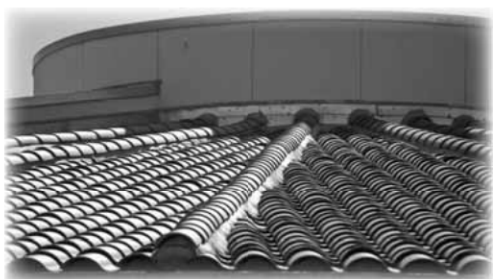

SESSION 7

Starts 6/9/2008, Ends 7/1/2008 except as noted.

**COMPUTER APPLICATIONS &  
OFFICE TECHNOLOGIES**  
Business & Law

**082 MICROCOMPUTER SOFTWARE SURVEY  
IN THE OFFICE - 3.00 UNITS**

Advisory: CAOT 1.  
Same as CSU Computer 100.  
Become computer literate in MS Office using Word,  
Excel, Access, and PowerPoint.  
7050 LEC 10:30-12:05 MTWTh Flood, P INST 2021  
AND LAB 12:20-2:40 MTWTh Flood, P INST 2021

**921 COOP ED - COMPUTER APPLICATIONS  
OFFICE TECHNOLOGY - 2.00 UNITS Rpt 3**  
9057 3:20 hrs TBA Raskin, E Schedule  
(10 Week Class - Starts 6/9/2008, Ends 8/15/2008)

**931 COOP ED - COMPUTER APPLICATIONS  
OFFICE TECHNOLOGY - 3.00 UNITS Rpt 3**  
9058 5:50 hrs TBA Raskin, E Schedule  
(10 Week Class - Starts 6/9/2008, Ends 8/15/2008)

**941 COOP ED - COMPUTER APPLICATIONS  
OFFICE TECHNOLOGY - 4.00 UNITS Rpt 3**  
Supervised training is conducted in the form of on-the-  
job training in an employment area that will enhance the  
student's educational goals.  
9059 7:50 hrs TBA Raskin, E Schedule  
(10 Week Class - Starts 6/9/2008, Ends 8/15/2008)

**COMPUTER SCIENCE  
INFORMATION TECHNOLOGY**  
Business & Law

Faculty Advisor: Mari Rettke - 818.609.4761

**401 INTRO TO COMPUTERS & THEIR USES**  
(UC:CSU) - 3.00 UNITS  
Prerequisite: None  
Introduction to Computer Science terminology, concepts  
and programming.  
This class satisfies the CAL STATE (CSUN) and the UC/  
system Computer Literacy Requirement at ONE FOURTH  
of the price.  
0142 LAB 8:00-8:55 MTWTh Kubicki, P INST CLAB  
AND LEC 9:00-12:00 MTWTh Kubicki, P INST 2005  
3074 LAB 6:00-7:00 MTWTh Rettke, E INST CLAB  
AND LEC 7:00-10:15 MTWTh Rettke, E INST 2004

**439 PROGRAMMING IN C (UC:CSU) - 3.00 UNITS**  
Prerequisite: CS 401 and 406.  
This is a structured systems programming class.  
Students will learn types, operator's expressions, control  
flow, functions, arrays and file constants. Unix system  
interface is also discussed. C is a highly portable struc-  
tured systems programming language with widespread  
applications. Upon completion of the course students  
will be able to write programs in C, determine the  
suitability of C for particular applications and design C  
routines to be modular and compact.  
3075 LAB 6:00-8:00 MTWTh Rettke, M INST CLAB  
AND LEC 8:00-10:00 MTWTh Rettke, M INST 2005

**921 COOP ED - COMPUTER SCIENCE-  
INFORMATION TECHNOLOGY 2.00 UNITS Rpt 3**  
9088 3:20 hrs TBA Raskin, E Schedule  
(10 Week Class - Starts 6/9/2008, Ends 8/15/2008)

**931 COOP ED - COMPUTER SCIENCE-  
INFORMATION TECHNOLOGY 3.00 UNITS Rpt 3**  
9024 5:50 hrs TBA Raskin, E Schedule  
(10 Week Class - Starts 6/9/2008, Ends 8/15/2008)

**941 COOP ED - COMPUTER SCIENCE-  
INFORMATION TECHNOLOGY 4.00 UNITS Rpt 3**  
Supervised training is conducted in the form of on-the-  
job training in an employment area that will enhanced  
the student's educational goals.  
9025 7:50 hrs TBA Raskin, E Schedule  
(10 Week Class - Starts 6/9/2008, Ends 8/15/2008)

**COOPERATIVE EDUCATION**  
Coop Ed

Faculty Advisor: Ed Raskin - Phone: 818.364.7700

**921, 931 OR 941 WORK EXPERIENCE II, III OR IV**  
(CSU) - 2, 3 or 4 UNITS  
A program providing a student with a linkage to their future  
career success and job placement. All students may sign up  
for this. Questions or further information? Call the Coop. Ed.  
Hot Line at 818.364.7700.  
This program is open to all students who wish to gain  
transferable college credit for working toward goals at  
their job. Students may enroll in this program for up to 4  
semesters, a maximum of 4 units per semester.

Requirements:  
Students must be enrolled in seven or more units at Mission  
or another school including cooperative education and be  
employed, or in a voluntary job. One mandatory orientation  
is required. See times below. Contact the Coop Ed  
office for dates. Students may register for this program  
anytime during the first 4 weeks of the semester, by calling  
818.364.7700.

Note: Addiction Studies sections 9017, 9018, and 9019; and  
Law sections 9045, 9046, and 9047; and Computer and  
Office Applications sections 9057, 9058, and 9059 WILL  
NOT TRANSFER to the California State University System.

Please ask the Coop Ed director about the LAMC Volunteer  
and Job Placement Program.

If you qualify for a BOGG fee waiver, you will not have to  
pay for taking this course. For information on the BOGG fee  
waiver, contact the Financial Aid Office.

Day Classes:  
10:30-1:30 M E. Raskin LRC-COOP ED OFF  
8:30-11:30 T E. Raskin LRC-COOP ED OFF  
10:30-1:30 W E. Raskin LRC-COOP ED OFF  
Evening Classes:  
4:00- 7:00 M Staff LRC-COOP ED OFF  
4:00- 7:00 W Staff LRC-COOP ED OFF

Starts 6/9/2008, Ends 7/1/2008 except as noted.

**STUDENTS EMPLOYED 10-14 HOURS PER WEEK:**  
Enroll in class 921 and appropriate section number from college major list below.

Example: Accounting 921, Section 9001.

**STUDENTS EMPLOYED 15 HOURS PER WEEK:**  
Enroll in class 931 and appropriate section number from college major list below.

Example: Accounting 931, Section 9002.

**STUDENTS EMPLOYED 20 HOURS OR MORE PER WEEK:**  
Enroll in class 941 and appropriate section number from college major list below.

Example: Accounting 941, Section 9003.

Students can repeat the same Coop-Ed class for a maximum of 4 semesters.

SECTION NUMBER	MAJOR
(921) (931) (941)	
9001, 9002, 9003	ACCOUNTING
9093, 9094, 9095	ADMINISTRATION OF JUSTICE
9009, 9010, 9011	BIOLOGY
9013, 9014, 9015	BUSINESS/ECONOMICS/ FINANCE/MARKETING
9021, 9022, 9023	CHILD DEVELOPMENT
9057, 9058, 9059	COMPUTER & OFFICE APPLICATIONS (Clerical does not transfer to CSU)
9088, 9024, 9025	COMPUTER SCIENCE
9089, 9026, 9027	EDUCATION (Education Aide & Bilingual Education)
9090, 9032, 9033	ENGINEERING, GENERAL
9091, 9034, 9035	ENGLISH
9092, 9038, 9039	FAMILY & CONSUMER STUDIES/ FOOD SERVICE MANAGEMENT
9040, 9042, 9043	HUMANITIES (Liberal Arts)
9045, 9046, 9047	LAW (including Legal Assistant does not transfer to CSU)
9049, 9050, 9051	MANAGEMENT
9053, 9054, 9055	MUSIC
9065, 9066, 9067	POLITICAL SCIENCE
9069, 9070, 9071	PSYCHOLOGY
9081, 9082, 9083	SOCIOLOGY
9085, 9086, 9087	SPEECH

## DEVELOPMENTAL COMMUNICATIONS

*Developmental Communications*

### 001 GRAMMAR: APPLIED TO WRITING

3.00 UNITS Rpt 1  
Prerequisite: None

Class is graded credit/no-credit.

This course offers an introduction to basic grammar as it relates to writing and other communication skills. It covers parts of speech, sentence structure, types of phrases and clauses, verb tenses and agreement, pronoun usage, comparison, capitalization, and punctuation.

0108	7:45-10:15	MTWTh	Staff	LRC 215
3024	7:30- 10:00	MTWTh	Staff	LRC 215

### 022C COMMUNICATIONS LABORATORY C

1.00 UNITS Rpt 2

Prerequisite: None

Class is graded credit/no-credit.

0180 LEC 3:20 hrs TBA Scuderi, R INST 1018

Class is geared for disabled students.

### 022D COMMUNICATIONS LABORATORY D

1.00 UNITS Rpt 2

Prerequisite: None

Class is graded credit/no-credit.

0115 LEC 3:20 hrs TBA Scuderi, R INST 1018

Class is geared for disabled students.

### 022E COMMUNICATIONS LABORATORY E

1.00 UNITS Rpt 2

Prerequisite: None

Class is graded credit/no-credit.

0182 LEC 3:20 hrs TBA Scuderi, R INST 1018

Class is geared for disabled students.

### 036A READING II: COMPREHENSION AND RELATED SKILLS A - 3.00 UNITS Rpt 1

Prerequisite: None

Class is graded credit/no-credit.

Intermediate course in reading; emphasizes finding main ideas, critical thinking, vocabulary skills, and study skills.

0112 LEC 10:35-12:00 MTWTh Staff INST 1003

3135 LEC 4:40-6:05 MTWTh Staff LRC 215

Developmental Communication 36A also offered through PACE. See page

## ENGLISH

*ESL, English & Journalism*

### 021 - ENGLISH FUNDAMENTALS - 3.00 UNITS

Prerequisite: Appropriate skill level demonstrated through the English assessment process or by permit.

**Corequisite:** Dev Com 36A.

Class graded credit/no credit.

Basic grammar, spelling, punctuation, topic sentences, and paragraph structure.

0171 7:45-10:15 MTWTh McKee, M CSB 201

0172 10:35-1:05 MTWTh Caggiano, S CSB 205

3017 4:40-6:05 MTWTh Stevenson, W CSB 105

(8 Week Class - Starts 6/9/2008, Ends 8/1/2008 )

3029 7:30-10:00 MTWTh Kemp, E CSB 206

English 21 is also offered through PACE. See page 30.



**028 INTERMEDIATE READING & COMPOSITION**

3.00 UNITS

As a component of the student's final grade, a Common Department Final is required.

Prerequisite: English 21 with a grade of "C" or better, or appropriate skills level demonstrated through the English assessment process, or by permit.

English 28 is a course in reading and writing designed to strengthen the student's ability to use basic communication skills, including grammar, spelling, punctuation, and sentence construction. Instruction will include the assignment of full-length expository and argumentative essays.

0113 7:45-10:15 MTWTh Grant, R INST 1005  
3009 7:30-10:00 MTWTh Stevenson, W INST 1004  
English 28 also offered through PACE. See page 30.

**101 COLLEGE READING & COMPOSITION I**

(UC:CSU) - 3.00 UNITS

Prerequisite: English 28 or ESL 8 with a grade of "C" or better, or appropriate skill level demonstrated through the English assessment process, or by permit.

This is the first freshman composition course that meets requirements for the BA at four-year colleges and universities, comprising intensive reading, writing of essays, term papers, the study of style, methods of discourse, logic, and documentation.

All sections may be taken for honors credit. See the Honors Counselor.

0114 LEC 10:35-1:05 MTWTh Grant, R CSB 201  
3013 LEC 4:40-7:10 MTWTh Romero, T CSB 101  
3025 LEC 7:30-10:00 MTWTh Campuzano, L CSB 205

**102 COLLEGE READING & COMPOSITION II**

(UC:CSU) - 3.00 UNITS

Prerequisite: English 101 with a grade of "C" or better, or by permit.

Critical thinking and writing through the reading of poetry, drama, the short story, and the novel.

All sections may be taken for honors credit. See the Honors Counselor.

0116 LEC 10:35-1:05 MTWTh Keawe, G BUNG 8  
3042 LEC 4:40-7:10 MTWTh Keawe, G CSB 206  
English 102 also offered through ITV. See page 31.  
English 102 also offered through PACE. See page 30.

**921 COOP ED - ENGLISH 2.00 UNITS Rpt 3**

9091 3:20 hrs TBA Raskin, E Schedule  
(10 Week Class - Starts 6/9/2008, Ends 8/15/2008 )

**941 COOP ED - ENGLISH 4.00 UNITS Rpt 3**

Supervised training is conducted in the form of on-the-job training in an employment area that will enhance the student's educational goals.

9035 7:50 hrs TBA Raskin, E Schedule  
(10 Week Class - Starts 6/9/2008, Ends 8/15/2008 )

## ENGLISH AS A SECOND LANGUAGE

ESL, English & Journalism

**052 ESL READING & CONVERSATION A**

(NDA) - 3.00 UNITS

Prerequisite: Appropriate ESL placement results or by permit.

Class is graded credit/no-credit.

0117 7:45-10:15 MTWTh Probst, G CSB 205

**053 ESL READING & CONVERSATION B**

(NDA) - 3.00 UNITS

Prerequisite: ESL 3, or appropriate ESL placement results, or by permit.

Class is graded credit/no-credit.

3118 7:30-10:00 MTWTh CLIMO, M CSB 101

## FAMILY AND CONSUMER STUDIES

Professional Studies

**021 NUTRITION (UC:CSU) - 3.00 UNITS**

Prerequisite: None

Required for ACF Certificate and Food Production Certificate, meets Natural Science requirement.

Comprehensive scientific nutrition information.

0185 LEC 10:30 hrs TBA Epps, F Internet

Email: professor\_epps@live.com

3036 LEC 7:30-10:00 MTWTh Epps, F CSB 201

**921 COOP ED - FAMILY & CONSUMER STUDIES**

2.00 UNITS Rpt 3

9092 3:20 hrs TBA Raskin, E Schedule  
(10 Week Class - Starts 6/9/2008, Ends 8/15/2008 )

**931 COOP ED - FAMILY & CONSUMER STUDIES**

3.00 UNITS Rpt 3

9038 5:50 hrs TBA Raskin, E Schedule  
(10 Week Class - Starts 6/9/2008, Ends 8/15/2008 )

**941 COOP ED - FAMILY & CONSUMER STUDIES**

4.00 UNITS Rpt 3

Supervised training is conducted in the form of on-the-job training in an employment area that will enhance the student's educational goals.

9039 7:50 hrs TBA Raskin, E Schedule  
(10 Week Class - Starts 6/9/2008, Ends 8/15/2008 )

## FOOD SERVICE MANAGEMENT

Professional Studies

Faculty Advisor: Eloise F. Cantrell - 818.364.7625

**050 SANITATION & SAFETY (CSU) - 3.00 UNITS**

Prerequisite: None

0184 IND 10:30 hrs TBA Struwe, K Internet

Email: kurtstruwe@sbcglobal.net (0184)

7107 LEC 7:45-10:15 MTWTh McKay, B INST 1008

**Note:** The following series of classes FSM 100 through 108 and FCS 108, FCS 21, FCS 163 are required for AA, AS, ACF certification, and Food Management Certificate Program.

**100 INTRO TO HOSPITALITY INDUSTRIES**

3.00 UNITS

Advisory: FCS 20, 21, 50.

Overview of food service and management in the hospitality industry. Careers are explored.

0154 LEC 10:30 hrs TBA Struwe, K Internet  
e-mail:kurtstruwe@sbcglobal.net

7006 LEC 8:30-12:00 TWTTh Griska, B PHOENIX

**101 FOOD PRODUCTION I (CSU) - 4.00 UNITS**

Prerequisite: FCS 50, 100 and negative TB test.

Study and lab experience of quality food production course, part of the American Culinary Federation Certification/Competencies.

0100 LEC 8:00-9:00 MTWTh Zandalasini, L INST 1006

AND LAB 9:10-11:40 MTWTh Zandalasini, L INST 1006

(10 Week Class - Starts 6/9/2008, Ends 8/14/2008)

7100 LEC 10:00-11:05 TWTTh Luna, A CAMP HOLT

AND LAB 11:05-2:20 TWTTh Luna, A CAMP HOLT

(11 Week Class - Starts 6/9/2008, Ends 8/21/2008)

7101 LEC 12:15-1:20 MTWTh Duprez, K GRAN HS

AND LAB 1:35-4:45 MTWTh Duprez, K GRAN HS

(8 Week Class - Starts 6/9/2008, Ends 7/31/2008)

7102 LEC 8:00-9:05 MWF Higgins, A CAMP GONZ

AND LAB 8:00-9:05 TTh Higgins, A CAMP GONZ

AND LAB 9:05-10:30 MTWThF Higgins, A CAMP GONZ

(11 Week Class - Starts 6/9/2008, Ends 8/21/2008)

**102 FOOD PRODUCTION II (CSU) - 4.00 UNITS**

Prerequisite: FCS 101 and negative TB test.

Advanced study and laboratory experiences of food preparation and production that meet American Culinary Federation Certification/Competencies. Part of a one year certificate program.

0126 LEC 8:00-9:00 MTWTh Zandalasini, L INST 1006

AND LAB 9:10-11:40 MTWTh Zandalasini, L INST 1006

(10 Week Class - Starts 6/9/2008, Ends 8/14/2008)

7003 LEC 10:00-11:05 TWTTh Luna, A CAMP HOLT

AND LAB 11:05-2:20 TWTTh LUNA, A CAMP HOLT

(11 Week Class - Starts 6/9/2008, Ends 8/21/2008)

7005 LEC 8:00-9:05 MWF Higgins, A CAMP GONZ

AND LAB 8:00-9:05 TTh Higgins, A CAMP GONZ

AND LAB 9:05-10:30 MTWThF Higgins, A CAMP GONZ

(11 Week Class - Starts 6/9/2008, Ends 8/21/2008)

**103 MENU PLANNING - 2.00 UNITS**

Prerequisite: FCS 21, FSM 100

Course is part of a two-year certificate program.

Examines basic principles of menu design. Includes all phases of menu planning for today's trends using computer software.

0311 LEC 12:00-1:30 MTWTh Gilligan, M INST 1002

**109 PROFESSIONAL BAKING**

(CSU) - 4.00 UNITS Rpt 3

Prerequisite: FSM 50, 101

Course covers study of baking functions, practical instruction and skill development in yeast-raised products, cakes, pies, cobblers, cookies, bars, brownies, and breakfast breads.

3035 LEC 4:40-5:40 TWTTh Garcia, R INST 1006

AND LAB 5:55-9:15 TWTTh Garcia, R INST 1006

(10 Week Class - Starts 6/9/2008, Ends 8/14/2008)

**125 FOODS LABORATORY - 1.00 UNIT Rpt 2**

Prerequisite: None

Class is graded credit/no credit.

7153 LAB 3:15-4:40 MTWTh Sanchez, J POLY TECH  
(8 Week Class - Starts 6/30/2008, Ends 8/21/2008)

**130 CAKE DECORATION I - 2.00 UNITS Rpt 2**

Prerequisite: FCS 101 or FSM 101.

Course emphasizes the fundamentals of the American Style of cake decoration. Exposure to basic equipment, procedures of cake production, coloring techniques, design transfer, cake construction, borders, and icings will be covered. Learn the art of cake decorating.

6000 LEC 5:30-6:30 MW Holtz, S WVOC RM4

AND LAB 6:30-9:00 MW Holtz, S WVOC RM4

(10 Week Class - Starts 6/9/2008, Ends 8/14/2008)

(6200 Winnetka ave. Woodland Hills)

**225 FOODS LABORATORY - 2.00 UNITS Rpt 3**

Prerequisite: FSM 101

Class is graded credit/no-credit.

Supervised practice in college-operated food service operation, as well as food preparation in range, pantry, bakery, and short order.

0131 LAB 9:10-11:40 MTWTh Zandalasini, L INST 1006

(10 Week Class - Starts 6/9/2008, Ends 8/14/2008)

## GEOLOGY

Physical Science

Geology 1 is offered through ITV. See page 31.

## GEOGRAPHY

Physical Science

Faculty Advisor: Lorraine Manoogian - 818.364.7706

**001 PHYSICAL GEOGRAPHY**

(UC:CSU) - 3.00 UNITS

Prerequisite: None

This course covers the changing processes within the Earth's major Geosystems: the Atmosphere, Hydrosphere, Lithosphere and Biosphere. Units of study include weather, climate, landforms, plate tectonics, gradational processes of mass wasting, soil formation, vegetation communities and the human impact of the environment. This course meets university transfer requirements for natural or physical science.

0177 10:30-1:05 MTWTh Manoogian, L INST 1013

**015 PHYSICAL GEOGRAPHY LABORATORY**

(UC:CSU) - 2.00 UNITS

**Prerequisite or Corequisite:** Geography 1

This earth environment laboratory emphasizes the scientific method by competing exercises and graphs solve equations, determine measurements, construct diagrams, and make field observations about Earth-Sun relations, weather systems, climate regions, soil classification, rock types and agents of landform modification. This course meets university transfer requirements for the laboratory portion of the Physical Sciences.

0216 LEC 1:25-2:15 MTWTh Rahman, A INST 2014

AND LAB 2:15-3:55 MTWTh Rahman, A INST 2014

# SESSION 7

Starts 6/9/2008, Ends 7/11/2008 except as noted.

## HEALTH

Arts, Health & Physical Education

### 011 PRINCIPLES OF HEALTHFUL LIVING

(UC:CSU) - 3.00 UNITS

Prerequisite: None

Implements the World Health Organization's definition of health that health is the state of physical, mental and social well-being, not merely the absence of disease.

0121 LEC 7:45-10:10 MTWTh Milke, L CSB 110

0202 LEC 10:30-12:55 MTWTh Cooper, C CSB 110

3122 LEC 7:30-9:55 MTWTh Staff CSB 110

Health 11 also offered through ITV. See page 31.

## HISTORY

Social Sciences

### 001 INTRO TO WESTERN CIVILIZATION I

(UC:CSU) - 3.00 UNITS

Prerequisite: None

A survey course emphasizing the main political, social, and economic currents that shaped the development of Western Civilization from antiquity through the emergence of nations in the 18th Century.

This section may be taken for honors credit. See the Honors Counselor.

0232 LEC 7:45-10:15 MTWTh Jimenez, G INST 1010

### 011 POLITICAL AND SOCIAL HISTORY OF THE UNITED STATES I

(UC:CSU) - 3.00 UNITS

Prerequisite: None

A survey of major events, personages, and themes most significant to the political, economic, and social development of this nation from its New World beginnings through the Civil War. It meets the American History and Institutions requirements for the California State University system and the Social and Behavioral Sciences requirements for all universities.

All sections may be taken for honors credit. See the Honors Counselor.

0103 IND 10:30 hrs TBA Cramer, A Internet  
www.lamission.edu/online

0104 IND 10:30 hrs TBA Sennet, R Internet  
www.lamission.edu/online

0122 LEC 10:30-12:55 MTWTh jimenez, G INST 1010  
History 11 also offered through ITV. See page 31.

## HUMANITIES

Social Sciences

### 001 CULTURAL PATTERNS OF WESTERN CIVILIZATION

(UC:CSU) - 3.00 UNITS

Prerequisite: None

Survey of the arts in western civilization.

0125 10:30-12:55 MTWTh Schuster, M INST 1017

### 003 THE ARTS OF CONTEMPORARY SOCIETY

(UC:CSU) - 3.00 UNITS

Prerequisite: None

6503 LEC 8:00-10:00 W Staff CMPC 1

AND LEC 2:00-4:00 S Staff CMPC 1

AND LEC 2:00 hrs TBA Staff CMPC 1

(9 Week Class - Starts 6/9/2008, Ends 8/8/2008)

921 COOP ED - HUMANITIES 2.00 UNITS Rpt 3  
9040 3:20 hrs TBA Raskin, E Schedule  
(10 Week Class - Starts 6/9/2008, Ends 8/15/2008)

931 COOP ED - HUMANITIES 3.00 UNITS Rpt 3  
9042 5:50 hrs TBA Raskin, E Schedule  
(10 Week Class - Starts 6/9/2008, Ends 8/15/2008)

941 COOP ED - HUMANITIES 4.00 UNITS Rpt 3  
Supervised training is conducted in the form of on-the-job training in an employment area that will enhance the student's educational goals.  
9043 7:50 hrs TBA Raskin, E Schedule  
(10 Week Class - Starts 6/9/2008, Ends 8/15/2008)

## INTERIOR DESIGN

Professional Studies

### 102 INTRO TO INTERIOR DESIGN 3.00 UNITS

Prerequisite: None

Basic elements and principles of design theory applied to furniture selection and interiors. Includes color schemes, floor coverings, window and wall treatments, lighting and accessories. Possible field trips.

7108 LEC 10:35-1:05 MTWTh Anderson, S CAC 4

### 108B SPACE PLANNING B - 2.00 UNITS

Prerequisite: None

Advisory: ID 102, ID 106A and ID 106B, ID 108.

Design theory, applied to commercial interiors.

Students do not need to have completed 108A to take this class.

7106 LEC 1:25-2:25 TWTh Weilacher, D CAC 4

AND LAB 2:40-4:50 TWTh Weilacher, D CAC 4

### 115 WINDOW TREATMENTS - 1.00 UNIT

Prerequisite: None

This course covers window history, hard and soft window treatments and installations, specialty installations, residential and commercial specifications, sources for design concepts, calculating fabric requirements, measuring techniques used by installers, workrooms and interior designers and job costing.

6168 LEC 6:30-9:50 T Withers, K CAC 4

## LAW

Business & Law

### 001 BUSINESS LAW I (UC:CSU) - 3.00 UNITS

Prerequisite: None

Same as Business 5.

Introductory course in civil law open to all students.

0127 IND 10:30 hrs TBA Kellogg, C Internet  
www.lamission.edu/law

3059 LEC 4:30-7:00 MW Morinaka, B INST 1017

(10 Week Class - Starts 6/9/2008, Ends 8/15/2008)

3061 LEC 4:30-7:00 TTh Staff INST 1017

(10 Week Class - Starts 6/9/2008, Ends 8/15/2008)

Starts 6/9/2008, Ends 7/11/2008 except as noted.

**002 BUSINESS LAW II** (UC:CSU) - 3.00 UNITS

Prerequisite: None

Same as Business 6.

Second part of the civil law course, including bailment, principles of agency, third parties, partnerships, corporation, stockholders, and legal aspects of negotiable instruments.

This class may be taken for honors credit. See the Honors Counselor.

0167 IND 10:30 hrs TBA Morinaka, B Internet  
www.lamission.edu/law

**011 INTRO TO LEGAL ASSISTANT II**

(CSU) - 3.00 UNITS

Prerequisite: None

A detailed examination of civil and criminal cases, and an introduction to drafting and writing.

0107 IND 10:30 hrs TBA Jordan, D Internet  
www.lamission.edu/law

**019 PROPERTY & CREDITOR RIGHTS** 3.00 UNITS

Prerequisite: None

Laws protecting landowners, tenants, and creditors.

Law 19 is a study of law of personal property and real property, and bankruptcy law and forms.

0170 IND 10:30 hrs TBA Jordan, D Internet  
www.lamission.edu/law

**020 BASIC PROBATE PROCEDURES** 3.00 UNITS

Prerequisite: None

Study of the fundamental principles and methods of fact gathering, office of both testate and intestate decedents, as well as the administration of estates in California Probate Courts.

0128 IND 10:30 hrs TBA Lampert, E Internet  
www.lamission.edu/law

# MATHEMATICS

## Mathematics

**100 MATHEMATICS WORKSHOP**

(NDA) - 1.00 UNIT Rpt 3

**Corequisite:** Math 113

Math 100 <----->Math 114  
3131 3063

Students enroll in Math 100 section number 0227 must also enroll in Math 113 section number 0195. Students enrolled in Math section number 3131 must also enroll in Math 114 section number 3063.

3131 LAB 8:00-9:10 MTWTh Burds, J MATH CTR  
(8 Week Class - Starts 6/9/2008, Ends 8/1/2008)

**112 PRE-ALGEBRA** (NDA) - 3.00 UNITS

Prerequisite: Math 105 with grade of "C" or better, or appropriate skill level demonstrated through the Mathematics assessment process, or by permit.

0149 LEC 1:25-3:55 MTWTh Sani, R BUNG 1  
0226 LEC 10:35-1:00 MTWTh Tadevosian, L BUNG 4  
3068 LEC 7:30-10:00 MTWTh Reyes, C BUNG 1  
Mathematics 112 also offered through PACE. See page 30.

**114 ELEMENTARY ALGEBRA B** - 3.00 UNITS

Prerequisite: Math 113 with a grade of "C" or better, or appropriate skill level demonstrated through the Mathematics assessment process, or by permit.

Math 113 and 114 together are equivalent to Math 115.

**Corequisite:** Math 100.

Students enrolled in Math 114 section number 3063 must also enroll in Math 100 section number 3131.

3063 6:00-7:50 MTWTh Burds, J BUNG 5  
(8 Week Class - Starts 6/9/2008, Ends 8/1/2008)

**115 ELEMENTARY ALGEBRA** - 5.00 UNITS

Prerequisite: Math 112 with a grade of "C" or better, or appropriate skill level demonstrated through the Mathematics assessment process, or by permit.

Math 113 and 114 together are equivalent to Math 115.

All Mathematics 115 students are required to pass a comprehensive department final. Failure to take this examination at the Scheduled time and day will result in a score of zero.

0147 10:20-12:50 MTWTh Evinyan, Z BUNG 2  
(8 Week Class - Starts 6/9/2008, Ends 8/1/2008)

3014 7:00-9:35 MTWTh Roshanaei, A BUNG 3  
(8 Week Class - Starts 6/9/2008, Ends 8/1/2008)

Math 115 also offered through PACE. See page 30.

**125 INTERMEDIATE ALGEBRA** - 5.00 UNITS

Prerequisite: Math 115 or Math 114 with a grade of "C" or better, or appropriate skill level demonstrated through the Mathematics assessment process, or by permit.

3016 7:00-9:35 MTWTh Butler, D INST 1003  
(8 Week Class - Starts 6/9/2008, Ends 8/1/2008)

Math 125 also offered through PACE. See page 30.

Math 125 also offered through ITV. See page 31.

**215 PRINCIPLES OF MATHEMATICS I**

(UC:CSU) - 3.00 UNITS

Prerequisite: Math 125 and Math 120 or Math 125 and Math 121 with a grade of "C" or better, or appropriate skill level demonstrated through the Mathematics assessment process, or by permit.

Primarily for students who plan to teach arithmetic in elementary schools.

3064 LEC 7:30-10:00 MTWTh Staff BUNG 2

**227 STATISTICS** (UC:CSU) - 4.00 UNITS

Prerequisite: Math 125 with a grade of "C" or better, or appropriate skill level demonstrated through the Mathematics assessment process, or by permit.

Equivalent to Math 225 with an additional hour of laboratory.

0187 LEC 9:45-1:05 MTWTh Gerhardt, S BUNG 1

0229 LEC 9:25-12:45 MTWTh Yun, Y CSB 206

3053 LEC 6:35-9:55 MTWTh Wong, K BUNG 5

3065 LEC 3:50-7:10 MTWTh Antoniou N INST 2005

Mathematics 227 also offered through PACE. See page 30.

**240 TRIGONOMETRY** (CSU) - 3.00 UNITS

Prerequisite: Math 125 and Math 120 or Math 125 and Math 121 with a grade of "C" or better, or appropriate skill level demonstrated through the Mathematics assessment process, or by permit.

3022 LEC 7:30-10:00 MTWTh Bakijanian, A INST 1017

**245 COLLEGE ALGEBRA** (UC:CSU) - 3.00 UNITS  
 Prerequisite: Math 125 with a grade of "C" or better, or appropriate skill level demonstrated through the Mathematics assessment process, or by permit.  
 0194 LEC 10:35-1:05 MTWTh Staff CSB 203  
 3028 LEC 7:30-10:00 MTWTh Ngo, H INST 1013

**265 CALCULUS WITH ANALYTIC GEOMETRY I**  
 (UC:CSU) - 5.00 UNITS  
 Prerequisite: Math 260, or Math 240 and 245 with a grade of "C" or better, or appropriate skill level demonstrated through the Mathematics assessment process, or by permit. Graphic calculators recommended.  
 3231 LEC 7:20-9:55 MTWTh Malki A BUNG 6  
 (8 Week Class - Starts 6/9/2008, Ends 8/1/2008)

**267 CALCULUS WITH ANALYTIC GEOMETRY III**  
 (UC:CSU) - 5.00 UNITS  
 Prerequisite: Math 266 with a grade of "C" or better, or appropriate skill level demonstrated through the Mathematics assessment process, or by permit.  
 3030 LEC 5:45-10:00 MTWTh Smazenka, R CSB 208

**MICROBIOLOGY**  
*Life Science*

Faculty Advisor: Dr. Angela Echeverri - 818.364.7704  
**020 GENERAL MICROBIOLOGY**  
 (UC:CSU) - 4.00 UNITS  
 Prerequisite: Bio 3 or 6 and Chem 51 or 65 or 101 with grade of "C" or better.  
 Advisory: English 28 or ESL 8.  
 Equivalent to CSUN Biology 215 and 215L; CSULA Microbiology 151.  
 0245 LEC 8:30-9:55 MTWTh Echeverri, A INST 2016  
 AND LAB 10:00-11:25 MTWTh Echeverri, A INST 2016  
 (8 Week Class - Starts 6/9/2008, Ends 8/1/2008)

**MULTIMEDIA**  
*Arts, Health & Physical Education*

**100 INTRO TO MULTIMEDIA COMPUTER APPLICATIONS** - 3.00 UNITS Rpt 3  
 Prerequisite: None  
 Printing Fee \$10.00.  
 3308 LEC 6:00-7:30 MTWTh Staff LRC 233  
 AND LAB 7:40-9:10 MTWTh Staff LRC 233

**320 WEB DESIGN** - 3.00 UNITS Rpt 3  
 Prerequisite: None  
 3012 LEC 6:00-7:30 MTWTh Stage, C LRC 106  
 AND LAB 7:40-9:10 MTWTh Stage, C LRC 106

**500 MULTIMEDIA LABORATORY** - 1.00 UNIT Rpt 3  
 3309 LAB 4:00-5:20 MTWTh Stage, C LRC 106

**MUSIC**  
*Arts, Health & Physical Education*

**101 FUNDAMENTALS OF MUSIC**  
 (UC:CSU) - 3.00 UNITS  
 Prerequisite: None  
 Study of basic elements of music: notation of pitch and rhythm, scales, intervals, key signatures, and triads.  
 6113 LEC 4:45-7:10 MTWTh Staff CAC 6

**111 MUSIC APPRECIATION I** (UC:CSU) - 3.00 UNITS  
 Prerequisite: None  
 Introduction to musical works from a variety of styles and periods, how to listen to music effectively and with comprehension.  
 6101 LEC 7:30-9:55 MTWTh Foster, D CAC 6

**921 COOP ED - MUSIC** 2.00 UNITS Rpt 3  
 9053 3:20 hrs TBA Raskin, E Schedule  
 (10 Week Class - Starts 6/9/2008, Ends 8/15/2008)

**931 COOP ED - MUSIC** 3.00 UNITS Rpt 3  
 9054 5:50 hrs TBA Raskin, E Schedule  
 (10 Week Class - Starts 6/9/2008, Ends 8/15/2008)

**941 COOP ED - MUSIC** 4.00 UNITS Rpt 3  
 Supervised training is conducted in the form of on-the-job training in an employment area that will enhance the student's educational goals.  
 9055 7:50 hrs TBA Raskin, E Schedule  
 (10 Week Class - Starts 6/9/2008, Ends 8/15/2008)

**PHILOSOPHY**  
*Social Sciences*

Faculty Advisor: Mark Pursley - 818.364.7677

**001 INTRO TO PHILOSOPHY** (UC:CSU) - 3.00 UNITS  
 Prerequisite: None  
 A survey of fundamental questions about self, society, and the universe. Primary focus on theories of reality, knowledge, and religion.  
 0130 LEC 10:35-1:05 MTWTh Pursley, M CSB 105  
 0146 IND 10:30 hrs TBA Dyas, D Internet  
 Email: david@daviddyas.com  
 Philosophy 1 also offered through ITV. See page 31.

**005 CRITICAL THINKING & COMPOSITION**  
 (UC:CSU) - 3.00 UNITS  
 Prerequisite: English 101 with a grade of "C" or better.  
 This course studies the critical thinking skills necessary for evaluating and formulating argumentative essays. Critical writing is the focus of this course.  
 This section may be taken for honors credit. See the Honors Counselor.  
 6585 LEC 6:00-8:00 F Pursley, M CMPC CTR  
 AND LEC 8:00-10:00 U Pursley, M CMPC CTR  
 AND LEC 2:00 hrs TBA Pursley, M CMPC CTR  
 (9 Week Class - Starts 6/9/2008, Ends 8/8/2008)

Starts 6/9/2008, Ends 7/1/2008 except as noted.

**006 LOGIC IN PRACTICE (UC:CSU) - 3.00 UNITS**

Prerequisite: None

Introduces skills of argument identification and evaluation. Students will learn to classify arguments as inductive or deductive and acquire techniques for recognizing valid deductive and strong inductive reasoning. Stresses the application of critical thinking skills to social and political discourses.

All sections may be taken for honors credit. See the Honors counselor.

0234 IND 8:50 hrs TBA Dyas, D Internet  
Email: david@daviddyas.com

Philosophy 6 is also offered through PACE. See page 30.

**003 COMPARATIVE SURVEY OF****WORLD RELIGIONS (UC:CSU) - 3.00 UNITS**

Prerequisite: None

History, practices, and world views of the major religions originating in India, China, Japan, and the Near East.

This section may be taken for honors credit. See the Honors counselor.

6504 LEC 6:00-8:00 W Pursley, M CMPC 5  
AND LEC 10:00-12:00 S Pursley, M CMPC 5  
AND LEC 2:00 hrs TBA Pursley, M CMPC 5  
(9 Week Class - Starts 6/9/2008, Ends 8/8/2008)

## PHYSICAL EDUCATION

Arts, Health & Physical Education

**295 INDIVIDUAL & DUAL ACTIVITIES -****ADAPTIVE ACTIVITIES (UC:CSU) - 1.00 UNIT Rpt 3**

Prerequisite: None

Geared toward the disabled students.

2026 LAB 10:30-11:50 MTWTh Staff FOOT 103

**552 ATHLETICS PRE-SEASON CONDITIONING**

(UC:CSU) - 1.00 UNIT Rpt 3

Prerequisite: None

This course is designed to improve and maintain the fitness condition of the athlete in preparation for the competitive season of play. It encompasses the mental aspects of sport performance, sport regulation and eligibility standards.

2024 LAB 5:10 hrs TBA Cascione, J ELCRPARK  
2027 LAB 10:30 hrs TBA Madha, E FOOT 103  
MEN SOCCER  
2028 LAB 6:00 hrs TBA Martins, E FOOT 103  
WOMEN SOCCER

**666 BODY CONDITIONING**

(UC:CSU) - 1.00 UNIT Rpt 3

Prerequisite: None

The class will include various aerobic activities to enhance cardiovascular conditioning. Weight resistance exercises and stretching exercises will be include to develop muscle strength, endurance, and flexibility. Training principles and concepts along with nutritional information will be introduced.

Emphasis on Power Walking.

2029 LAB 7:45-10:10 MTWTh Staff FOOT 103  
2925 LAB 4:45-7:10 MTWTh Staff ELCRPARK

**690 WEIGHT TRAINING (UC:CSU) - 1.00 UNIT Rpt 3**

Prerequisite: None

Weight Training and Conditioning includes progressive resistance exercises. There is an emphasis on the knowledge, understanding and values of building muscle strength and endurance. Students will develop their own physical fitness program based upon sound physiological principles.

2926 LAB 7:30-9:55 MTWTh Staff FOOT 103

## PHYSIOLOGY

Life Science

Faculty Advisor: Michael Reynolds - 818.364.7695

**001 INTRO TO HUMAN PHYSIOLOGY**

(UC:CSU) - 4.00 UNITS

Equivalent to CSUN Biology 281 & 282, CSULA Biology 200A & 200B (if completed Anatomy 1).

Prerequisite: Anatomy 1 with a grade of "C" or better.

Advisory: Chemistry 51 or 65 or 101 and English 28 or ESL 8.

This course involves the study of the function of the following human systems: integumentary, skeletal, muscular, nervous, circulatory, respiratory, digestive, urinary, endocrine, lymphatic, and reproductive.

Labs include hands-on applications.

0244 LEC 8:00-9:25 MTWTh Elkerdany, M INST 2001  
AND LAB 9:35-11:00 MTWTh Elkerdany, M INST 2018  
(8 Week Class - Starts 6/9/2008, Ends 8/1/2008)

## POLITICAL SCIENCE

Social Sciences

Faculty Advisor: Chuck Dirks - 818.364.7675

**001 THE GOVERNMENT OF THE UNITED STATES**

(UC:CSU) - 3.00 UNITS

Prerequisite: None

0134 LEC 7:45-10:10 MTWTh Dirks, C INST 1001  
0155 LEC 10:30-12:55 MTWTh Dirks, C INST 1001  
0241 IND 10:30 hrs TBA Chounlamountry Internet  
email: chounlam@usc.edu

3034 LEC 7:30-9:55 MTWTh Staff INST 1002  
3082 LEC 7:30-9:55 MTWTh Staff INST 1001  
Political Science 1 also offered through ITV. See page 31.

**921 COOP ED - POLITICAL SCIENCE**

2.00 UNITS Rpt 3

9065 3:20 hrs TBA Raskin, E Schedule  
(10 Week Class - Starts 6/9/2008, Ends 8/15/2008)

**931 COOP ED - POLITICAL SCIENCE**

3.00 UNITS Rpt 3

9066 5:50 hrs TBA Raskin, E Schedule  
(10 Week Class - Starts 6/9/2008, Ends 8/15/2008)

**941 COOP ED - POLITICAL SCIENCE**

4.00 UNITS Rpt 3

Supervised training is conducted in the form of on-the-job training in an employment area that will enhance the student's educational goals.

9067 7:50 hrs TBA Raskin, E Schedule  
(10 Week Class - Starts 6/9/2008, Ends 8/15/2008)

SESSION 1

Starts 6/9/2008, Ends 7/1/2008 except as noted.

## PSYCHOLOGY

Social Sciences

### 001 GENERAL PSYCHOLOGY I

(UC:CSU) - 3.00 UNITS

Advisory: English 21 or ESL 6.

This introductory psychology course covers biological foundations of behavior, various theoretical perspectives including learning, personality, and intelligence theories as well as experimental and research methodology.

0135 LEC 7:45-10:10 MTWTh Milani, N INST 1002

0144 IND 10:30 hrs TBA Rogers, C Internet  
Chante427@yahoo.com

3010 LEC 4:45-7:10 MTWTh Moyenda, A INST 1002  
Psychology 1 also offered through ITV. See page 31.

### 921 COOP ED - PSYCHOLOGY 2.00 UNITS Rpt 3

9069 3:20 hrs TBA Raskin, E Schedule  
(10 Week Class - Starts 6/9/2008, Ends 8/15/2008)

### 931 COOP ED - PSYCHOLOGY 3.00 UNITS Rpt 3

9070 5:50 hrs TBA Raskin, E Schedule  
(10 Week Class - Starts 6/9/2008, Ends 8/15/2008)

### 941 COOP ED - PSYCHOLOGY 4.00 UNITS Rpt 3

Supervised training is conducted in the form of on-the-job training in an employment area that will enhance the student's educational goals.

9071 7:50 hrs TBA Raskin, E Schedule  
(10 Week Class - Starts 6/9/2008, Ends 8/15/2008)

## SOCIOLOGY

Social Sciences

Faculty Advisor: Myriam Mekelburg - 818.833.3414

### 001 INTRO TO SOCIOLOGY (UC:CSU) - 3.00 UNITS

Prerequisite: None

Develops the sociological perspective that behavior is largely determined by human interactions and by membership in groups.

All sections may be taken for honors credit. See the Honors Counselor.

0109 IND 10:30 hrs TBA Layne, V Internet  
Email: proflayne@yahoo.com

0132 LEC 7:45-10:15 MTWTh Raskin, E INST 2004

0163 IND 10:30 hrs TBA Mekelburg, M Internet  
Email: profmek@hotmail.com

Sociology 1 also offered through ITV. See page 31.

### 921 COOP ED - SOCIOLOGY 2.00 UNITS Rpt 3

9081 3:20 hrs TBA Raskin, E Schedule  
(10 Week Class - Starts 6/9/2008, Ends 8/15/2008)

### 931 COOP ED - SOCIOLOGY 3.00 UNITS Rpt 3

9082 5:50 hrs TBA Raskin, E Schedule  
(10 Week Class - Starts 6/9/2008, Ends 8/15/2008)

### 941 COOP ED - SOCIOLOGY 4.00 UNITS Rpt 3

Prerequisite: Employment in a field related to the student's major as verified by the signature of the Cooperative Education Advisor.

Supervised training is conducted in the form of on-the-job training in an employment area that will enhance the student's educational goals.

9083 7:50 hrs TBA Raskin, E Schedule  
(10 Week Class - Starts 6/9/2008, Ends 8/15/2008)

## SPANISH

Foreign Languages

### 001 ELEMENTARY SPANISH I

(UC:CSU) - 5.00 UNITS

Prerequisite: None

0175 10:35-1:05 MTWTh Lopez, B INST 1005  
(8 Week Class - Starts 6/9/2008, Ends 7/31/2008)

3112 7:25-9:55 MTWTh Ramil, Y INST 1005  
(8 Week Class - Starts 6/9/2008, Ends 7/31/2008)

## SPEECH COMMUNICATION

Social Sciences

Faculty Advisor: Margie Long - 818.364.7682

### 101 ORAL COMMUNICATION I

(UC:CSU) - 3.00 UNITS

Prerequisite: None

This introductory speech course emphasizes the techniques of public speaking including the delivery of speeches to inform, persuade, and activate. In this course you will refine your critical thinking, research, organizational, and time management skills. You will learn how to organize and adapt your message to any audience.

0137 7:45-10:10 MTWTh Long, M INST 1012

0138 10:30-12:55 MTWTh Long, M INST 1012  
Speech 101 is also offered through PACE. See page 30.

### 921 COOP ED - SPEECH COMMUNICATION

2.00 UNITS Rpt 3

9085 3:20 hrs TBA Raskin, E Schedule  
(10 Week Class - Starts 6/9/2008, Ends 8/15/2008)

### 931 COOP ED - SPEECH COMMUNICATION

3.00 UNITS Rpt 3

9086 5:50 hrs TBA Raskin, E Schedule  
(10 Week Class - Starts 6/9/2008, Ends 8/15/2008)

### 941 COOP ED - SPEECH COMMUNICATION

4.00 UNITS Rpt 3

Supervised training is conducted in the form on-the-job training in an employment area that will enhance the student's educational goals.

9087 7:50 hrs TBA Raskin, E Schedule  
(10 Week Class - Starts 6/9/2008, Ends 8/15/2008)

## SUPERVISED LEARNING

Learning Assistance

### 001T SUPERVISED LEARNING ASSISTANCE

(NDA) - 0.00 UNITS Rpt 9

Upon instructor referral, students will receive tutoring in the LAC. It is a non-credit, open-exit course which is non-graded and will not appear on student transcripts.

8950 20:00 hrs TBA Rivera, P Schedule

8951 20:00 hrs TBA Rivera, P Schedule

# Non Credit Program

## BASIC SKILLS CONTINUING EDUCATION Adult Education

### 001 CE READING & MATHEMATICS BASIC SKILLS

(NDA) -0.00UNITS Rpt 9

8858	8:00-11:10	MTWTh	Gutierrez, J	MORNING
8859	8:00-11:10	MTWTh	Sarmiento, E	HADDON
5856	6:00-9:10	MTWTh	Staff	LRC 234
(7/14/08-8/15/08)				
5857	6:00-9:10	MTWTh	Gutierrez, J	MAC CTR
5858	6:00-9:10	MTWTh	Castrellon, O	GRIDLEY

### ENGLISH AS A SECOND LANGUAGE 10CE

(NDA) -0.00UNITS Rpt 9

5859	6:00-9:10	MTWTh	Staff	VALV PARK
------	-----------	-------	-------	-----------

### ESL CIVICS 1CE (NDA) -0.00UNITS Rpt 9

5860	6:00-9:00	MW	De La Cruz, L	CC MS
AND	6:00-9:00	TTh	De La Cruz, J	CC MS

### ESL CIVICS 11CE-ESL & CIVICS 2

(NDA) -0.00UNITS Rpt 9

8857	8:00-11:30	F	Krawchuck, M	MACLAY
5852	5:00-8:20	W	Aldaco, R	FDO GARD
5853	6:00-9:20	T	Yehia, S	VAUG HS
5854	6:00-9:20	W	Sarmiento, E	HADDON
5855	6:00-9:20	W	Galvez, L	GRIDLEY

(5 Week Classes -Starts 6/9/2008, Ends 7/11/2008)

MACLAY= Maclay Middle School  
SARA COUG= Sara Coughlin  
SFDO MS= San Fernando Middle School  
CC MS = Community Charter Middle School  
GRIDLEY= Gridley Elementary School  
MORNING=Morningside Elementary School  
MAC CTR= Maclay Annex  
ADDON= Haddon Elementary School  
AUG HS= Vaughn High School  
SFDO GARD= San Fernando Gardens

Note: Registration for these classes is held at the  
Maclay Annex 436 N Maclay Ave. San Fernando, CA 91340 818.837.2239

## ONLINE CLASSES - Session I

Welcome to Online & Hybrid Classes!

### 1 Find your Class

To get to your online class, follow these steps:

1. Go first to the main College webpage - <http://www.lamission.edu>
2. Click on "online classes" [http://www.lamission.edu/online\\_classes.html](http://www.lamission.edu/online_classes.html)
3. If it is an etudes class - locate your class - <http://missionclasses.pbwiki.com> and then contact your instructor - [http://www.lamission.edu/etudes\\_faculty.html](http://www.lamission.edu/etudes_faculty.html)
4. If it is a WebCT or other type of online class - locate your class - and then contact your instructor at their faculty webpage - [http://www.lamission.edu/faculty\\_webpages.html](http://www.lamission.edu/faculty_webpages.html)
5. If you are having problems logging in - make certain you are registered for the class - go the Student Information System - [http://www.laccd.edu/student\\_information/sis\\_logon.asp](http://www.laccd.edu/student_information/sis_logon.asp)

### 2 Log in to your class

etude classes are located at <http://lamc.etudes.fhda.edu>

A. Determine your Username:

The username is the first 2 letters of the first name + the first 2 letters of the last name + last 5 digits of the SIN (all lower case). Example: Jose A. Garcia  
SIN# 111-22-3333

Username: joga23333

B. Determine your Password:

The password is: Month+Day of birth (in school records).

Example: January 11

Password: 0111

### 3 See if you are ready for an online class

Take this sample online assessment to see if you are ready- <http://www.alt.usg.edu/sort>

This information is located at <http://missiononline.pbwiki.com>

## BIOLOGY Life Science

Faculty Advisor: Michael Reynolds - 818.364.7695

### 003 MEDICAL TERMINOLOGY - 3.00 UNITS

Prerequisite: None

Medical terms related to the structure and function of the human body in health and disease. Ideal for allied Math students.

0181 LEC 6:30 hrs TBA Saeki, W Internet

Email: [www.lamission.edu/lifesciences/saeki](http://www.lamission.edu/lifesciences/saeki)

(8 Week Class - Starts 6/9/2008, Ends 8/1/2008)

## BUSINESS Business & Law

### 001 INTRO TO BUSINESS (UC:CSU) - 3.00 UNITS

Prerequisite: None

The student will learn the various forms of business organizations. The student will study business management, organization, financing and marketing, and also become acquainted with the risks involved in business and with government's role in business.

3018 LEC 4:45-7:10 MW Bernal, V CSB 205

AND IND 5:35 hrs TBA Bernal, V Internet

SESSION I

Starts 6/9/2008, Ends 7/11/2008 except as noted.

## ONLINE CLASSES - Session I

### **B**USINESS - MANAGEMENT *Business & Law*

#### **013 SMALL BUSINESS ENTREPRENEURSHIP**

(CSU) - 3.00 UNITS

Prerequisite: None

This course presents a systematic approach to successful small business operation.

3101 LEC 7:30-9:55 MW Bernal, V CSB 207

AND LEC 6:05 hrs TBA Bernal, V Internet

[www.lamission.edu/business/bernal](http://www.lamission.edu/business/bernal)

Management 13 is also offered in ITV. See page

### **C**HICANO STUDIES *Foreign Languages & Chicano Studies*

#### **007 THE MEXICAN-AMERICAN IN THE HISTORY OF THE UNITED STATES I** (UC:CSU) - 3.00 UNITS

Prerequisite: None

Traces the historical evolution of the Mexican-American to 1850.

0168 LEC 10:30 hrs TBA Maldonado, J Internet

Email: [maldonaja@lamission.edu](mailto:maldonaja@lamission.edu)

#### **008 THE MEXICAN-AMERICAN IN THE HISTORY OF THE UNITED STATES II** (UC:CSU) - 3.00 UNITS

Prerequisite: None

This class may be taken for honors credit. See the Honors Counselor.

0101 LEC 10:30 hrs TBA Morales, J Internet

Email: [moralejj@lamission.edu](mailto:moralejj@lamission.edu)

#### **037 CHICANO LITERATURE**

(UC:CSU) - 3.00 UNITS

Prerequisite: None

0173 LEC 10:30 hrs TBA Maldonado, J Internet

Email: [maldonaja@lamission.edu](mailto:maldonaja@lamission.edu)

### **F**AMILY AND CONSUMER STUDIES *Professional Studies*

#### **021 - NUTRITION** (UC:CSU) - 3.00 UNITS

Prerequisite: None

Required for ACF Certificate and Food Production Certificate, meets Natural Science requirement.

Comprehensive scientific nutrition information.

0185 LEC 10:30 hrs TBA Epps, F Internet

Email: [professor\\_epps@live.com](mailto:professor_epps@live.com)

### **F**OOD SERVICE MANAGEMENT *Professional Studies*

Faculty Advisor: Eloise F. Cantrell - 818.364.7625

#### **050 SANITATION & SAFETY** (CSU) - 3.00 UNITS

Prerequisite: None

0184 IND 10:30 hrs TBA Struwe, K Internet

Email: [kurtstruwe@sbcglobal.net](mailto:kurtstruwe@sbcglobal.net) (0184)

#### **100 INTRO TO HOSPITALITY INDUSTRIES**

3.00 UNITS

Advisory: FCS 20, 21, 50.

Overview of food service and management in the hospitality industry. Careers are explored.

0154 LEC 10:30 hrs TBA Struwe, K Internet

e-mail: [kurtstruwe@sbcglobal.net](mailto:kurtstruwe@sbcglobal.net)

### **H**ISTORY *Social Sciences*

#### **011 POLITICAL & SOCIAL HISTORY OF THE UNITED STATES I** (UC:CSU) - 3.00 UNITS

Prerequisite: None

A survey of major events, personages, and themes most significant to the political, economic, and social development of this nation from its New World beginnings through the Civil War. It meets the American History and Institutions requirements for the California State University system and the Social and Behavioral Sciences requirements for all universities.

All sections may be taken for honors credit. See the Honors Counselor.

0103 IND 10:30 hrs TBA Cramer, A Internet

[www.lamission.edu/online](http://www.lamission.edu/online)

0104 IND 10:30 hrs TBA Sennet, R Internet

[www.lamission.edu/online](http://www.lamission.edu/online)

### **L**<sup>AW</sup> *Business & Law*

#### **001 BUSINESS LAW I** (UC:CSU) - 3.00 UNITS

Prerequisite: None

Same as Business 5.

Introductory course in civil law open to all students.

0127 IND 10:30 hrs TBA Kellogg, C Internet

[www.lamission.edu/law](http://www.lamission.edu/law)

#### **002 BUSINESS LAW II** (UC:CSU) - 3.00 UNITS

Prerequisite: None

Same as Business 6.

Second part of the civil law course, including bailment, principles of agency, third parties, partnerships, corporation, stockholders, and legal aspects of negotiable instruments.

This class may be taken for honors credit. See the Honors Counselor.

0167 IND 10:30 hrs TBA Morinaka, B Internet

[www.lamission.edu/law](http://www.lamission.edu/law)

#### **011 INTRO TO LEGAL ASSISTANT II**

(CSU) - 3.00 UNITS

Prerequisite: None

A detailed examination of civil and criminal cases, and an introduction to drafting and writing.

0107 IND 10:30 hrs TBA Jordan, D Internet

[www.lamission.edu/law](http://www.lamission.edu/law)

## ONLINE CLASSES - Session I

### 019 PROPERTY & CREDITOR RIGHTS - 3.00 UNITS

Prerequisite: None

Laws protecting landowners, tenants, and creditors.

Law 19 is a study of law of personal property and real property, and bankruptcy law and forms.

0170 IND 10:30 hrs TBA Jordan, D Internet  
www.lamission.edu/law

### 020 BASIC PROBATE PROCEDURES - 3.00 UNITS

Prerequisite: None

Study of the fundamental principles and methods of fact gathering, office of both testate and intestate decedents, as well as the administration of estates in California

Probate Courts.

0128 IND 10:30 hrs TBA Lampert, E Internet  
www.lamission.edu/law

## PHILOSOPHY Social Sciences

Faculty Advisor: Mark Pursley - 818.364.7677

### 001 INTRO TO PHILOSOPHY (UC:CSU) - 3.00 UNITS

Prerequisite: None

A survey of fundamental questions about self, society, and the universe. Primary focus on theories of reality, knowledge, and religion.

0146 IND 10:30 hrs TBA Dyas, D Internet  
Email: david@daviddyas.com

### 006 LOGIC IN PRACTICE (UC:CSU) - 3.00 UNITS

Prerequisite: None

Introduces skills of argument identification and evaluation. Students will learn to classify arguments as inductive or deductive and acquire techniques for recognizing valid deductive and strong inductive reasoning. Stresses the application of critical thinking skills to social and political discourses.

All sections may be taken for honors credit. See the Honors counselor.

0234 IND 8:50 hrs TBA Dyas, D Internet  
Email: david@daviddyas.com

## PSYCHOLOGY Social Sciences

### 001 GENERAL PSYCHOLOGY I

(UC:CSU) - 3.00 UNITS

Advisory: English 21 or ESL 6.

This introductory psychology course covers biological foundations of behavior, various theoretical perspectives including learning, personality, and intelligence theories as well as experimental and research methodology.

0144 IND 10:30 hrs TBA Rogers, C Internet  
Chante427@yahoo.com

## SOCIOLOGY Social Sciences

Faculty Advisor: Myriam Mekelburg - 818.833.3414

### 001 INTRO TO SOCIOLOGY (UC:CSU) - 3.00 UNITS

Prerequisite: None

Develops the sociological perspective that behavior is largely determined by human interactions and by membership in groups.

All sections may be taken for honors credit. See the Honors Counselor.

0109 IND 10:30 hrs TBA Layne, V Internet

Email: proflayne@yahoo.com

0163 IND 10:30 hrs TBA Mekelburg, M Internet

Email: profmek@hotmail.com

Sociology 1 also offered through ITV. See page 31.



SESSION I

Starts 6/9/2008, Ends 7/1/2008 except as noted.

# *PACE Summer Session Course Offerings for 2008*

**June 9th - August 9th**

**Summer Orientation: Saturday, June 7, 9-11 AM**

**CMPC 5 & 6**

**Regular PACE Saturdays: 6/21; 7/12; 7/26; 8/9 final exams.**

**Bridge Saturdays: 6/14; 6/28; 7/19; 8/2; 8/9 final exams**

**Note: Math 115, 125, and Biology 3, meet every Saturday.**

**PACE Bridge Courses Meet Mondays, and Bridge Saturdays (except Math 115 and 125).**

6590	English 21	3 units	Monday 6-8 PM & Bridge Saturday, 8 AM-12 PM	CMPC 6
6591	English 28	3 units	Internet & Bridge Saturday	CMPC 5
6592	English 101	3 units	Monday 6-8 PM & Bridge Saturday, 8 AM-12 PM	CMPC 1
6597	Dev Com 36A		Monday 8-10 & Bridge Saturdays 12:30-4:30 PM	CMPC 5
6593	Math 105	3 units	Monday 8-10 PM & Bridge Saturday 12:30-4:30 PM	INST 2004
6594	Math 112	3 units	Monday 8-10 PM & Bridge Saturday 12:30-4:30 PM	INST 1004
6595	Math 115	5 units	Monday 8-10 PM, Wed. 6-10 PM, Sat. 12:30-4:30 PM	CMPC 6
6596	Math 125	5 units	Monday 8-10 PM, Saturday 12:30-4:30 PM Wednesday 6-10 PM	INST 1010 CMPC 1
6598	Math 227		Monday & Wednesday 6-10 PM (no Saturdays)	CMPC 2

**Wednesday Courses (General Studies Track)**

6504	Philosophy 33	3 units	Wed 6-8 PM Regular PACE Sat. 8 AM-12 PM M Pursley	CMPC 5
6503	Humanities 3	3 units	Wed 8-10 PM, Saturday 12:30-4:30 PM	CMPC 5

**Monday/Wednesday Course (Health Sciences Track)**

6506	Biology 3	4 units	Monday & Wednesday 5:25- 8:35 PM & Saturday 7:45 AM- 12:40 PM Lec/Lab	INST 2019
6507	Biology 3	4 units	Tuesday 5:25-7:15 PM Thursday 5:25-10:10 PM, Saturday 10:40 AM- 3:35 PM Lec/Lab	INST 2019

**Tuesday Courses (Business, Elementary Teaching, Social Science)**

6502	Speech 101	3 units	Tuesday 6-8 PM & Regular PACE Sat. 8 AM-12 PM	CMPC 1 & 2
6501	Political Sci 1	3 units	Tuesday 8-10 PM & Regular PACE Saturday 12:30- 4:30 PM I Ostrow	CMPC 1 & 2

**Thursday Courses (Business, Elementary Teaching, Social Science)**

6505	Speech 101	3 units	Thursday 6-8 PM & Regular PACE Sat. 8-12	CMPC 1 & 2
6508	Political Sci 1	3 units	Thursday 8-10 PM & Regular PACE Saturday 12:30- 4:30 PM I Ostrow	CMPC 1 & 2

**Combined sections!**

Philosophy 5:	Five day course section # 6598	Mark Pursley, Instructor
Philosophy 6:	Five-Day Course Section # 6599	CMPC 5 & 6
	Friday June 6: 6-10 PM	Saturday June 7: 11 AM –3 PM & 4-8 PM
	Sunday June 8: 8-12 & 1-5 PM	Friday June 13: 6-10 PM
	Sunday June 15: 8 AM-12 PM & 1-5 PM	

**All LAMC students may enroll in PACE! PACE PICNIC: Saturday, July 26, Campus quad 11-1**

PACE was designed to offer convenient course scheduling for busy people.

PACE students may take two classes at a time for an eight week session.

PACE is fully accredited and all courses are transferable to CSU and UC.

All Los Angeles Mission College students may enroll in PACE courses.



# The Weekend College

ITV/The Weekend College classes allow students to complete general education classes in a focused eight-week format. Classes are taught on four campuses: **City [C]** and **Southwest [SW]** Colleges on Saturdays and **Valley [V]** and **Pierce [P]** Colleges on Sundays. First college listed is **AM only 9:00 - 12:00 Noon**. Second college listed is **PM only 1:30 - 4:30 PM**. Students may attend at any location or change locations, if necessary, throughout the semester.

The classes are taught by the same qualified LACCD instructor at each campus. Instruction is combined with award-winning video lessons available on cable television, in broadband, on DVD, and in the College Learning Resource Centers. Each class also has an online component creating a positive, engaging learning environment.

For classroom locations go to:

[www.lamission.edu/itv](http://www.lamission.edu/itv) and click View Schedule. Financial aid is available for qualified students; fee waivers apply to these classes. Transcripts are issued by LA Mission College.

## SUMMER 08

June 16 - August 10, 2008

Classes	Section	Saturday Campus	Sunday Campus
Economics 1	7936	C/SW	P/V
English 101	7937	C/SW	P/V
English 102	7938	C/SW	P/V
Geology 1	7939	C/SW	P/V
Health 11	7940	C/SW	P/V
History 11	7941	C/SW	P/V
Math 125	7942	SW/C	V/P
Philosophy 1	7943	SW/C	V/P
Political Science 1	7944	SW/C	V/P
Psychology 1	7945	SW/C	V/P
Psychology 41	7946	SW/C	V/P
Sociology 1	7947	SW/C	V/P

Saturday class meetings: **June 21 – Aug. 9, 2008**

Sunday class meetings: **June 22 – Aug. 10, 2008**

### Last Day To:

ADD by STEP or on-line: **June 15, 2008**

ADD by FAX: **(818)833-3598**

Or in-person: **June 27, 2008**

Drop without incurring fees: **June 21, 2008**

**Website:** [www.lamission.edu/itv](http://www.lamission.edu/itv) • **Telephone:** 818/833-3594 or 800/917-9277

Instructional Television (ITV) courses are transferable community college courses that combine instructional video with an interactive course website and weekend class meetings. The classes are specifically designed for working adults and busy students. Classes are convenient and provide the flexibility working adults require.

## ADMINISTRATION OF JUSTICE Business & Law

### 002 CONCEPTS OF CRIMINAL LAW

(UC:CSU) - 3.00 UNITS

Prerequisite: None

The structure, definitions and most used sections of the Penal Code and other criminal statutes.

3037 LEC 4:45-7:15 MTWTh Enos, K CSB 101

### 004 PRINCIPLES & PROCEDURES OF THE JUSTICE SYSTEM (UC:CSU) - 3.00 UNITS

Prerequisite: None

A study of the various agencies in the criminal justice arena.

0166 LEC 10:35-1:05 MTWTh Laflamme, F INST 1012

### 005 CRIMINAL INVESTIGATION - 3.00 UNITS

Prerequisite: None

Police procedures in criminal investigation. Legal aspects and procedures.

3047 LEC 7:30-9:55 MTWTh Enos, K CSB 101

### 014 REPORT WRITING FOR PEACE OFFICERS

(CSU) - 3.00 UNITS

Prerequisite: None

The study of effective report writing in police work including crime scene investigative reports and arrest reports.

0192 LEC 1:15-3:40 MTWTh Roche, J INST 2004

### 075 INTRO TO CORRECTIONS - 3.00 UNITS

Prerequisite: None

Basic course dealing with the nature of correctional systems and corrections work.

3050 LEC 7:30-9:55 MTWTh Woods, M INST 2006

## ANTHROPOLOGY Life Science

Faculty Advisor: Arthur Gribben - 818.364.7600 x4235

### 101 HUMAN BIOLOGICAL EVOLUTION

(UC:CSU) - 3.00 UNITS

Advisory: English 28 or ESL 8.

0331 LEC 10:35-1:00 MTWTh Gribben, A INST 1015

### 121 ANTHROPOLOGY OF RELIGION, MAGIC AND WITCHCRAFT (UC:CSU) - 3.00 UNITS

Prerequisite: None

3060 LEC 7:30-9:55 MTWTh Carter, M INST 1015

## ART Arts, Health & Physical Education

### 103 ART APPRECIATION I (UC:CSU) - 3.00 UNITS

Prerequisite: None

Advisory: English 21.

This class is an introductory course that involves the students in an exploration into the nature and appreciation of the visual arts.

All sections may be taken for honors credit. See the Honors Counselor.

3006 LEC 4:45-7:10 MTWTh Staff CSB 207

### 502 BEGINNING THREE-DIMENSIONAL DESIGN

(UC:CSU) - 3.00 UNITS

Prerequisite: None

Introduction to art making utilizing three dimensional materials, including additive and subtractive processes.

Required of Art Majors and Multimedia Block I

Lecture 2 hours, lab 2 hours.

0105 LEC 12:30-2:35 MTWTh Staff CAC 1

AND LAB 2:35-4:40 MTWTh Staff CAC 1

## BUSINESS Business & Law

### 001 INTRO TO BUSINESS (UC:CSU) - 3.00 UNITS

Prerequisite: None

The student will learn the various forms of business organizations. The student will study business management, organization, financing and marketing, and also become acquainted with the risks involved in business and with government's role in business.

0215 LEC 0:30 hrs TBA Bernal, V Internet

[www.lamission.edu/business/bernal](http://www.lamission.edu/business/bernal)

3052 LEC 4:45-7:10 MTWTh Valarao, M INST 2006

### 005 BUSINESS LAW I (UC:CSU) - 3.00 UNITS

Prerequisite: None

Same as Law 1.

0214 LEC 10:30-12:55 MTWTh Rush, C INST 2006

## BUSINESS - ECONOMICS Business & Law

### 001 PRINCIPLES OF ECONOMICS I

(UC:CSU) - 3.00 UNITS

Prerequisite: None

This class may be taken for honors credit. See the Honors Counselor.

0209 10:30-12:55 MTWTh Danai, M CSB 111

Economics 1 also offered through ITV. See page 31.

### 002 PRINCIPLES OF ECONOMICS II

(UC:CSU) - 3.00 UNITS

Prerequisite: None

This class may be taken for honors credit. See the Honors Counselor.

0211 1:15-3:40 MTWTh Staff INST 2006

Economics 2 also offered through PACE. See page 30.

## BUSINESS - MARKETING Business & Law

### 021 PRINCIPLES OF MARKETING - 3.00 UNITS

Prerequisite: None

Emphasized how concepts and principles of marketing are applied from a marketing manager perspective in selecting an attractive target market.

0242 LEC 10:30 hrs TBA Bernal, V Internet

[www.lamission.edu/business/bernal](http://www.lamission.edu/business/bernal)

**002 - THE MEXICAN-AMERICAN IN CONTEMPORARY SOCIETY** (UC:CSU) - 3.00 UNITS

Prerequisite: None  
0157 LEC 10:30 hrs TBA Maldonado, J Internet  
e-mail:maldonaja@lamission.edu  
0158 LEC 7:45-10:15 MTWTh Staff CSB 203  
7105 LEC 7:30-9:55 MTWTh Gutierrez, E JEFF HS

**007 - THE MEXICAN-AMERICAN IN THE HISTORY OF THE UNITED STATES I** (UC:CSU) - 3.00 UNITS

Prerequisite: None  
Traces the historical evolution of the Mexican- American to 1850.  
0159 LEC 10:30 hrs TBA Morales, J Internet  
email:moralejj@lamission.edu

**008 - THE MEXICAN-AMERICAN IN THE HISTORY OF THE UNITED STATES II** (UC:CSU) - 3.00 UNITS

Prerequisite: None  
This class may be taken for honors credit. See the Honors Counselor.  
3008 LEC 7:30-9:55 MTWTh Staff CSB 203  
6159 LEC 3:30-5:55 MTWTh Staff SFDO HS

**052 MEXICAN ART-MODERN** (UC:CSU) - 3.00 UNITS

Prerequisite: None  
A survey of the art of Mexico from the nineteenth century to the present, including the renaissance of indigenous Mexican art, the evolution of a Mexican-American art, and the cultural interplay between the United States and Mexico.  
6160 LEC 10:05-12:30 MTWTh Gutierrez, E JEFF HS

**001 CHILD GROWTH & DEVELOPMENT** (UC:CSU) - 3.00 UNITS

Prerequisite: None  
Covers the development of a child from the prenatal stage through adolescence.  
3005 LEC 4:40-6:45 Th Ruelas, J CSB 102B  
AND LEC 8:15 hrs TBA Ruelas, J Internet  
Taught bilingually (English/ Spanish)  
3054 LEC 7:30-10:00 MTWTh Staff CSB 102A

**002 EARLY CHILDHOOD: PRINCIPLES & PRACTICES** 3.00 UNITS

Prerequisite: None  
Preschool principles, practices (including discipline and guidance) and philosophies.  
3001 LEC 4:40-7:05 MTWTh De Silva, L CSB 102A

**003 CREATIVE EXPERIENCES FOR CHILDREN I** 3.00 UNITS

Advisory: Child Dev 1 and 2.  
Arts, crafts, puppetry, dramatic play.  
0110 LEC 1:25-3:50 MTWTh De Silva, L CSB 102A

**004 - CREATIVE EXPERIENCES FOR CHILDREN II**

3.00 UNITS  
Advisory: Child Dev 1 and 2.  
Language Arts, Math, Social Studies, Science, perceptual motor development and cooking.  
0139 LEC 10:35-1:05 MTWTh Berg, R INST 1008

**010 - CHILD HEALTH** (CSU) - 3.00 UNITS

Prerequisite: None  
Health and safety, communicable illness and management, safe environment, child nutrition. Pediatric First Aid and Cardio-Pulmonary-Respiration certificates will be issued.  
0111 LEC 10:35-1:05 MTWTh Staff CSB 102A

**030 - INFANT & TODDLER STUDIES I**

3.00 UNITS  
Prerequisite: None  
Required by the state for those who work with infants.  
3004 LEC 7:30-10:00 MTWTh Staff CSB 102B

**003 HISTORY OF MOTION PICTURES**

(UC:CSU) - 3.00 UNITS  
Prerequisite: None  
This course includes history of the development of motion pictures, with examples screened from the silent film to the present day. Emphasis is placed on American feature films.  
All sections may be taken for honors credit. See the Honors Counselor.  
0106 LEC 1:15-2:50 MTWTh Levine, S LRC TCR  
AND LAB 2:50-4:25 MTWTh Levine, S LRC TCR

**001 COMPUTER KEYBOARDING I** - 3.00 UNITS

Students will develop basic keyboarding skills on the computer using Microsoft Word.  
7051 LEC 10:30-12:00 MTWTh Woodmansee, J INST 2021  
AND LAB 12:00-2:25 MTWTh Woodmansee, J INST 2021

**076 KEYBOARDING FOR DATA PROCESSING**

1.00 UNIT  
Keyboarding to improve input speed.  
7053 LAB 2:25-3:55 MTWTh Staff INST 2021



Starts 7/14/2008, Ends 8/15/2008.

SESSION III

**COMPUTER SCIENCE  
INFORMATION TECHNOLOGY**  
Business & Law

Faculty Advisor: Mari Rettke - 818.609.4761

**401 INTRO TO COMPUTERS & THEIR USES**

(UC:CSU) - 3.00 UNITS

Prerequisite: None

Introduction to Computer Science terminology, concepts and programming.

This class satisfies the CAL STATE (CSUN) and the UC/ system Computer Literacy Requirement at ONE FOURTH of the price.

0156 LAB 8:00-9:00 MTWTh Kubicki, P INST CLAB  
AND LEC 9:00-12:00 MTWTh Kubicki, P INST 2005

**435 MICROCOMPUTER OPERATING SYSTEM**

3.00 UNITS

Prerequisite: CS 431

The student will master advanced operating system techniques using a mouse driven graphical interface.

Currently popular microcomputer operating systems programs commonly used utility programs will be discussed.

3073 LEC 6:00-7:50 MTWTh Rettke, E INST 2005  
AND LAB 8:00-10:00 MTWTh Rettke, E INST CLAB

**DEVELOPMENTAL  
COMMUNICATIONS**  
Developmental Communications

**001 GRAMMAR: APPLIED TO WRITING**

3.00 UNITS Rpt 1

Prerequisite: None

Class is graded credit/no-credit.

Introduction to basic grammar as it relates to writing.

0190 7:45-10:15 MTWTh Staff LRC 215  
3044 7:30-9:55 MTWTh Staff LRC 215

**036A READING II: COMPREHENSION &  
RELATED SKILLS A** - 3.00 UNITS Rpt 1

Prerequisite: None

Class is graded credit/no-credit.

Intermediate course in reading; emphasizes finding main ideas, critical thinking, vocabulary skills, and study skills.

0189 10:35-1:00 MTWTh Staff LRC 215  
3045 4:40-7:05 MTWTh Staff INST 1004

Developmental Communication 36A also offered through PACE. See page 30.

**ENGLISH**  
ESL, English & Journalism

**021 ENGLISH FUNDAMENTALS** - 3.00 UNITS

Prerequisite: Appropriate skill level demonstrated through the English assessment process or by permit.

**Corequisite:** Dev Com 36A.

Class graded credit/no credit.

Basic grammar, spelling, punctuation, topic sentences, and paragraph structure.

0178 7:45-10:10 MTWTh Stern, A CSB 111  
0183 10:30-1:00 MTWTh Stern, A CSB 205  
3038 4:4-7:05 MTWTh Caggiano, S CSB 206  
3039 7:30-9:55 MTWTh Darr, N CSB 208  
English 21 also offered through PACE. See page

**028 INTERMEDIATE READING & COMPOSITION**

3.00 UNITS

As a component of the student's final grade, a Common Department Final is required.

Prerequisite: English 21 with a grade of "C" or better, or appropriate skills level demonstrated through the English assessment process, or by permit.

English 28 is a course in reading and writing designed to strengthen the student's ability to use basic communication skills, including grammar, spelling, punctuation, and sentence construction. Instruction will include the assignment of full-length expository and argumentative essays.

0186 7:45-10:10 MTWTh Spitter, E CSB 208  
3040 7:30-9:55 MTWTh Campuzano, L CSB 105  
English 28 also offered through PACE. See page

**101 COLLEGE READING & COMPOSITION I**

(UC:CSU) - 3.00 UNITS

Prerequisite: English 28 or ESL 8 with a grade of "C" or better, or appropriate skill level demonstrated through the English assessment process, or by permit.

This is the first freshman composition course that meets requirements for the BA at four-year colleges and universities, comprising intensive reading, writing of essays, term papers, the study of style, methods of discourse, logic, and documentation.

All sections may be taken for honors credit. See the Honors Counselor.

0188 7:45-10:10 MTWTh Camhi, J CSB 205  
3041 7:30-9:55 MTWTh Kemp, E CSB 111  
3043 4:40-7:05 MTWTh Romero, T BUNG 8

English 101 also offered through PACE. See page 30.

English 101 also offered through ITV. See page 31.

**102 COLLEGE READING & COMPOSITION II**

(UC:CSU) - 3.00 UNITS

Prerequisite: English 101 with a grade of "C" or better, or by permit.

Critical thinking and writing through the reading of poetry, drama, the short story, and the novel.

All sections may be taken for honors credit. See the Honors Counselor.

0151 LEC 10:35-1:00 MTWTh McKee, M CSB 101  
3116 LEC 4:40-7:05 MTWTh Cohenour, H CSB 201  
English 102 also offered through ITV. See page

Starts 7/14/2008, Ends 8/15/2008.

SESSION II



## ENGLISH AS A SECOND LANGUAGE ESL, English & Journalism

### 052 ESL READING & CONVERSATION A

(NDA) - 3.00 UNITS

Prerequisite: Appropriate ESL placement results or by permit.

Class is graded credit/no-credit.

3142 7:30-9:55 MTWTh Keesee, D CSB 201

### 053 ESL READING & CONVERSATION B

(NDA) - 3.00 UNITS

Prerequisite: ESL 3, or appropriate ESL placement results, or by permit.

Class is graded credit/no-credit.

0118 LEC 7:45-10:10 MTWTh Barbato, L CSB 101

## FAMILY AND CONSUMER STUDIES Professional Studies

### 021 NUTRITION (UC:CSU) - 3.00 UNITS

Prerequisite: None

Required for ACF Certificate and Food Production Certificate, meets Natural Science requirement.

Comprehensive scientific nutrition information.

3027 LEC 7:30-9:55 MTWTh Cantrell, E INST 1008

Taught bilingually (English/Spanish)

### 031 MARRIAGE & FAMILY LIFE

(UC:CSU) - 3.00 UNITS

Prerequisite: None

Required for Gerontology, Administration of Justice Certificate, and Family and Consumer Studies AA Degree.

Learn about relationships, communication techniques, sexual attitudes and how to be a complete you.

3119 4:45-7:10 MTWTh Cantrell, E INST 1008

## GEOLOGY Physical Science

Geology 1 is offered through ITV. See page 31.

## GEOGRAPHY Physical Science

Faculty Advisor: Lorraine Manoogian - 818.364.7706

### 001 PHYSICAL GEOGRAPHY (UC:CSU) - 3.00 UNITS

Prerequisite: None

This course covers the changing processes within the Earth's major Geosystems: the Atmosphere, Hydrosphere, Lithosphere and Biosphere. Units of study include weather, climate, landforms, plate tectonics, gradational processes of mass wasting, soil formation, vegetation communities and the human impact of the environment. This course meets university transfer requirements for natural or physical science.

3057 4:40-7:05 MTWTh Manoogian, L INST 1013

### 015 PHYSICAL GEOGRAPHY LABORATORY

(UC:CSU) - 2.00 UNITS

Prerequisite or Corequisite: Geog 1.

This earth environment laboratory emphasizes the scientific method by competing exercises and graphs solve equations, determine measurements, construct diagrams, and make field observations about Earth-Sun relations, weather systems, climate regions, soil classification, rock types and agents of landform modification. This course meets university transfer requirements for the laboratory portion of the Physical Sciences.

3058 LEC 7:30-8:20 MTWTh Rogers, H INST 2014  
AND LAB 8:20-9:55 MTWTh Rogers, H INST 2014

## HEALTH Arts, Health & Physical Education

### 011 PRINCIPLES OF HEALTHFUL LIVING

(UC:CSU) - 3.00 UNITS

Prerequisite: None

Implements the World Health Organization's definition of health that health is the state of physical, mental and social well-being, not merely the absence of disease.

0120 LEC 7:45-10:10 MTWTh Staff CSB 110

3007 LEC 4:45-7:10 MTWTh Staff CSB 110

Health 11 also offered through ITV. See page 31.

## HISTORY Social Sciences

### 002 INTRO TO WESTERN CIVILIZATION II

(UC:CSU) - 3.00 UNITS

Prerequisite: None

A survey of western civilization from the beginning of the 17th century to the present with emphasis upon political, economic, and social forces.

0201 7:45-10:15 MTWTh Cramer, A INST 1017

### 011 POLITICAL & SOCIAL HISTORY OF THE UNITED STATES I (UC:CSU) - 3.00 UNITS

Prerequisite: None

A survey of major events, personages, and themes most significant to the political, economic, and social development of this nation from its New World beginnings through the Civil War. It meets the American History and Institutions requirements for the California State University system and the Social and Behavioral Sciences requirements for all universities.

All sections may be taken for honors credit. See the Honors Counselor.

0123 IND 10:30 hrs TBA Behling, R Internet  
[www.lamission.edu/online](http://www.lamission.edu/online)

History 11 also offered through ITV. See page 31.



Starts 7/14/2008, Ends 8/15/2008.

SESSION III

**012 POLITICAL & SOCIAL HISTORY OF THE UNITED STATES II** (UC:CSU) - 3.00 UNITS

Prerequisite: None

Note: History 11 is not required for this course.

A survey of major events, personages, and themes most significant to the political, economic, and social development of this nation from the Reconstruction Period (1865) to the present.

This section may be taken for honors credit. See the Honors Counselor.

0124 LEC	10:30 hrs	TBA	Sennet, R	Internet
----------	-----------	-----	-----------	----------

[www.lamission.edu/online](http://www.lamission.edu/online)

3031 LEC	7:30-9:55	MTWTh	Behling, R	INST 1010
----------	-----------	-------	------------	-----------

**HUMANITIES**  
*Social Sciences***002 STUDIES IN SELECTED CULTURES**

(UC:CSU) - 3.00 UNITS Rpt 1

Prerequisite: None

0136 LEC	10:30-12:55	MTWTh	Schuster, M	CSB 105
----------	-------------	-------	-------------	---------

**INTERIOR DESIGN**  
*Professional Studies***108A SPACE PLANNING A** - 2.00 UNITS

Advisory: ID 15, or Fam &amp; CS 15.

Residential design including American Disabilities Act compliance, architectural considerations and interior/exterior relationships. Includes professional presentation methods and portfolio development.

6100 LEC	7:00-8:00	TWTh	Weilacher, D	CAC 4
----------	-----------	------	--------------	-------

AND LAB	8:00-9:50	TWTh	Weilacher, D	CAC 4
---------	-----------	------	--------------	-------

**LAW**  
*Business & Law***001 BUSINESS LAW I** (UC:CSU) - 3.00 UNITS

Prerequisite: None

Same as Business 5.

Introductory course in civil law open to all students.

0191 IND	10:30 hrs	TBA	Walker, R	Internet
----------	-----------	-----	-----------	----------

[www.lamission.edu/law](http://www.lamission.edu/law)

0240 IND	8:50 hrs	TBA	Staff	Internet
----------	----------	-----	-------	----------

[www.lamission.edu/law](http://www.lamission.edu/law)

**010 INTRO TO LEGAL ASSISTANT I** 3.00 UNITS

Prerequisite: None

Formalizes the career of the legal assistant, and introduces legal terminology bibliography, including research problems.

0165 IND	10:30 hrs	TBA	Jackman, J	Internet
----------	-----------	-----	------------	----------

[www.lamission.edu/law](http://www.lamission.edu/law)

**012 TORT LAW & CLAIMS INVESTIGATION**

3.00 UNITS

Prerequisite: None

Principles of California tort and insurance law, and the investigation techniques necessary in tort and insurance claims.

0169 IND	10:30 hrs	TBA	Telanoff, A	Internet
----------	-----------	-----	-------------	----------

[www.lamission.edu/law](http://www.lamission.edu/law)

**016 CIVIL & CRIMINAL EVIDENCE** - 3.00 UNITS

Prerequisite: None

Study of the rules of civil and criminal evidence, the admissibility of such evidence in court, deposition comprehension and use in court, and interrogatory summarizing and use in court.

0174 IND	10:30 hrs	TBA	Rose, E	Internet
----------	-----------	-----	---------	----------

[www.lamission.edu/law](http://www.lamission.edu/law)

**017 LEGAL WRITING** - 3.00 UNITS

Prerequisite: None

This course consists of advanced legal drafting and writing, including research and special projects.

0199 IND	10:30 hrs	TBA	Jordan, D	Internet
----------	-----------	-----	-----------	----------

[www.lamission.edu/law](http://www.lamission.edu/law)

**034 LEGAL RESEARCH LABORATORY**

3.00 UNITS

Prerequisite: None

This course is the study of Legal Research. The student learns how to do legal research in a Law Library and Online, along with how to report the results of legal research.

0161 IND	10:30 hrs	TBA	Jordan, D	Internet
----------	-----------	-----	-----------	----------

[www.lamission.edu/law](http://www.lamission.edu/law)

**MATHEMATICS**  
*Mathematics***105 ARITHMETIC** (NDA) - 3.00 UNITS

Prerequisite: Appropriate skill level demonstrated through the Mathematics assessment process, or by permit.

A review of elementary arithmetic.

0314 LEC	7:45-10:10	MTWTh	Staff	BUNG 1
----------	------------	-------	-------	--------

Mathematics 105 also offered through PACE. See page 30.

**112 PRE-ALGEBRA** (NDA) - 3.00 UNITS

Prerequisite: Math 105 with grade of "C" or better, or appropriate skill level demonstrated through the Mathematics assessment process, or by permit.

0193 LEC	10:35-1:00	MTWTh	Tran, L	BUNG 1
----------	------------	-------	---------	--------

0228 LEC	1:15-3:40	MTWTh	Oganyan, K	BUNG 1
----------	-----------	-------	------------	--------

3062 LEC	7:30-9:55	MTWTh	Marsubian, A	BUNG 1
----------	-----------	-------	--------------	--------

Mathematics 112 also offered through PACE. See page 30.

**227 STATISTICS** (UC:CSU) - 4.00 UNITS

Prerequisite: Math 125 with a grade of "C" or better, or appropriate skill level demonstrated through the Mathematics assessment process, or by permit.

Equivalent to Math 225 with an additional hour of laboratory.

3066 LEC	6:40-9:55	MTWTh	Kim, J	BUNG 5
----------	-----------	-------	--------	--------

Mathematics 227 also offered through PACE. See page 30.

**245 COLLEGE ALGEBRA** (UC:CSU) - 3.00 UNITS

Prerequisite: Math 125 with a grade of "C" or better, or appropriate skill level demonstrated through the Mathematics assessment process, or by permit.

0230 LEC	1:25-3:50	MTWTh	Staff	BUNG 3
----------	-----------	-------	-------	--------

## MUSIC

Arts, Health & Physical Education

### 101 FUNDAMENTALS OF MUSIC

(UC:CSU) - 3.00 UNITS

Prerequisite: None

Study of basic elements of music: notation of pitch and rhythm, scales, intervals, key signatures, and triads.

6114 4:45-7:10 MTWTh Staff CAC 6

## OCEANOGRAPHY

Physical Science

Faculty Advisor: Lorraine Manoogian - 818.364.7706

### 001 INTRO TO OCEANOGRAPHY

(UC:CSU) - 3.00 UNITS

Prerequisite: None

An introduction to Oceanography. Topics include the formation and the evolution of the sea floor, islands, coastlines, properties of seawater, motions of the sea (waves, tides and currents) and marine life. Specific reference is made to the Southern California coast.

0225 1:25-3:50 MTWTh Rogers, H INST 1013

## PHILOSOPHY

Social Sciences

Faculty Advisor: Mark Pursley - 818.364.7677

### 001 INTRO TO PHILOSOPHY (UC:CSU) - 3.00 UNITS

Prerequisite: None

A survey of fundamental questions about self, society, and the universe. Primary focus on theories of reality, knowledge, and religion.

3032 LEC 7:30-9:55 MTWTh Gerhardt, S CSB 207  
Philosophy 1 also offered through ITV. See page 31.

### 006 LOGIC IN PRACTICE (UC:CSU) - 3.00 UNITS

Prerequisite: None

Introduces skills of argument identification and evaluation. Students will learn to classify arguments as inductive or deductive and acquire techniques for recognizing valid deductive and strong inductive reasoning. Stresses the application of critical thinking skills to social and political discourses.

All sections may be taken for honors credit. See the Honors counselor.

0176 LEC 10:30 hrs TBA Dyas, D Internet  
Email: david@daviddyas.com

Philosophy 6 is also offered through PACE. See page 30.



## PHYSICAL EDUCATION

Arts, Health & Physical Education

### 295 INDIVIDUAL & DUAL ACTIVITIES -

**ADAPTIVE ACTIVITIES** (UC:CSU) - 1.00 UNIT Rpt 3

Prerequisite: None

Geared toward the disabled students.

2032 LAB 10:35-12:05 MTWTh Paredes, S FOOT 103

### 552 ATHLETICS PRE-SEASON CONDITIONING

(UC:CSU) - 1.00 UNIT Rpt 3

Prerequisite: None

This course is designed to improve and maintain the fitness condition of the athlete in preparation for the competitive season of play. It encompasses the mental aspects of sport performance, sport regulation and eligibility standards.

2023 LAB 10:30 hrs TBA Durazo, S ELCRPARK  
2030 LAB 10:30 hrs TBA Madha, E FOOT 103  
2031 LAB 10:30 hrs TBA Staff ELCRPARK

### 666 BODY CONDITIONING

(UC:CSU) - 1.00 UNITS Rpt 3

Prerequisite: None

The class will include various aerobic activities to enhance cardiovascular conditioning. Weight resistance exercises and stretching exercises will be included to develop muscle strength, endurance, and flexibility. Training principles and concepts along with nutritional information will be introduced.

Emphasis on Power Walking.

2025 LAB 7:45-10:10 MTWTh Klitsner, J ELCRPARK

### 690 WEIGHT TRAINING (UC:CSU) - 1.00 UNIT Rpt 3

Prerequisite: None

Weight Training and Conditioning includes progressive resistance exercises. There is an emphasis on the knowledge, understanding and values of building muscle strength and endurance. Students will develop their own physical fitness program based upon sound physiological principles.

2930 LAB 7:30-9:55 MTWTh Teola, D FOOT 103

## POLITICAL SCIENCE

Social Sciences

Faculty Advisor: Chuck Dirks - 818.364.7675

### 001 THE GOVERNMENT OF THE UNITED STATES

(UC:CSU) - 3.00 UNITS

Prerequisite: None

0140 IND 10:30 hrs TBA Chounlamountry Internet  
Email: chounlam@usc.edu

0150 LEC 7:45-10:10 MTWTh Staff INST 1001  
3083 LEC 7:30-9:55 MTWTh Staff INST 1001

Political Science 1 also offered through ITV. See page 31.

Starts 7/14/2008, Ends 8/15/2008.

SESSION III

## PSYCHOLOGY Social Sciences

### 001 GENERAL PSYCHOLOGY I

(UC:CSU) - 3.00 UNITS

Advisory: English 21 or ESL 6.

This introductory psychology course covers biological foundations of behavior, various theoretical perspectives including learning, personality, and intelligence theories as well as experimental and research methodology.

0143 LEC 7:45-10:10 MTWTh Smardan, C INST 1002

0145 LEC 10:30 hrs TBA McKenna, P Internet

Paul2317-psych1@yahoo.com

Psychology 1 also offered through ITV. See page 31.

## SOCIOLOGY Social Sciences

Faculty Advisor: Myriam Mekelburg - 818.833.3414

### 001 INTRO TO SOCIOLOGY (UC:CSU) - 3.00 UNITS

Prerequisite: None

Develops the sociological perspective that behavior is largely determined by human interactions and by membership in groups.

All sections may be taken for honors credit. See the Honors Counselor.

0148 IND 10:30 hrs TBA Layne, V Internet

Email: proflayne@yahoo.com

0152 IND 10:30 hrs TBA Biondo, J Internet

Email: JillB9191@yahoo.com

3084 LEC 7:30-9:55 MTWTh Raskin, E INST 2004

Sociology 1 also offered through ITV. See page 31.

### 002 AMERICAN SOCIAL PROBLEMS

(UC:CSU) - 3.00 UNITS

Prerequisite: None

Analysis of personal and social disorganization, crime and delinquency, race and ethnic relations, population and urban growth, and individual and societal rights.

0206 IND 10:30 hrs TBA Biondo, J Internet

Email: JillB9191@yahoo.com

### 004 SOCIOLOGICAL ANALYSIS

(UC:CSU) - 3.00 UNITS

Prerequisite: None

This section may be taken for honors credit. See the Honors Counselor.

0207 IND 10:30 hrs TBA Little, D Internet

Email: dominic.little@csun.edu

## SPEECH COMMUNICATION Social Sciences

Faculty Advisor: Margie Long - 818.364.7682

### 101 ORAL COMMUNICATION I

(UC:CSU) - 3.00 UNITS

Prerequisite: None

This introductory speech course emphasizes the techniques of public speaking including the delivery of speeches to inform, persuade, and activate. In this course you will refine your critical thinking, research, organizational, and time management skills. You will learn how to organize and adapt your message to any audience.

0239 10:30-12:55 MTWTh Staff INST 1012

3019 7:30-9:55 MTWTh Staff BUNG 8

Speech 101 also offered through PACE. See page 30.

## SUPERVISED LEARNING Learning Assistance

### 001T SUPERVISED LEARNING ASSISTANCE

(NDA) - 0.00 UNITS Rpt 9

Upon instructor referral, students will receive tutoring in the LAC. It is a non-credit, open-exit course which is non-graded and will not appear on student transcripts.

8952 20:00 hrs TBA Rivera, P Schedule

Starts 7/14/2008, Ends 8/15/2008.

## The LRC Computer Commons



First Floor, Learning Resource Center, The Quad

**Hours of Operation** (subject to change)

Monday - Thursday: 9 AM to 7 PM

Saturdays: 10 AM to 2 PM

More than 70 new ultra-modern computers available for student use

- INSTANT Internet
- FLAT PANEL MONITORS
- DVD ROM
- CD REWRITEABLE & FLOPPY DISK DRIVES
- SPECIALIZED INSTRUCTIONAL PROGRAMS

An ideal place to do your homework and class research!

## ONLINE CLASSES - Session II

### **B** *BUSINESS* Business & Law

#### **001 INTRO TO BUSINESS** (UC:CSU) - 3.00 UNITS

Prerequisite: None

The student will learn the various forms of business organizations. The student will study business management, organization, financing and marketing, and also become acquainted with the risks involved in business and with government's role in business.

0215 LEC 0:30 hrs TBA Bernal, V Internet  
www.lamission.edu/business/bernal

### **B** *BUSINESS - MARKETING* Business & Law

#### **021 PRINCIPLES OF MARKETING** - 3.00 UNITS

Prerequisite: None

Emphasized how concepts and principles of marketing are applied from a marketing manager perspective in selecting an attractive target market.

0242 LEC 10:30 hrs TBA Bernal, V Internet  
www.lamission.edu/business/bernal

### **C** *CHICANO STUDIES* Foreign Languages

#### **002 THE MEXICAN-AMERICAN IN CONTEMPORARY SOCIETY** (UC:CSU) - 3.00 UNITS

Prerequisite: None

0157 LEC 10:30 hrs TBA Maldonado, J Internet  
e-mail:maldonaja@lamission.edu

#### **007 THE MEXICAN-AMERICAN IN THE HISTORY OF THE UNITED STATES I** (UC:CSU) - 3.00 UNITS

Prerequisite: None

Traces the historical evolution of the Mexican- American to 1850.

0159 LEC 10:30 hrs TBA Morales, J Internet  
email:moralejj@lamission.edu

### **C** *CHILD DEVELOPMENT* Professional Studies

#### **001 CHILD GROWTH & DEVELOPMENT**

(UC:CSU) - 3.00 UNITS

Prerequisite: None

Covers the development of a child from the prenatal stage through adolescence.

3005 LEC 4:40-6:45 Th Ruelas, J CSB 102B  
AND LEC 8:15 hrs TBA Ruelas, J Internet  
Taught bilingually (English/ Spanish)

### **H** *HISTORY* Social Sciences

#### **011 POLITICAL & SOCIAL HISTORY OF THE UNITED STATES I** (UC:CSU) - 3.00 UNITS

Prerequisite: None

A survey of major events, personages, and themes most significant to the political, economic, and social development of this nation from its New World beginnings through the Civil War. It meets the American History and Institutions requirements for the California State University system and the Social and Behavioral Sciences requirements for all universities.

All sections may be taken for honors credit. See the Honors Counselor.

0123 IND 10:30 hrs TBA Behling, R Internet  
www.lamission.edu/online

#### **012 POLITICAL & SOCIAL HISTORY OF THE UNITED STATES II** (UC:CSU) - 3.00 UNITS

Prerequisite: None

Note: History 11 is not required for this course.

A survey of major events personages, and themes most significant to the political, economic, and social development of this nation from the Reconstruction Period (1865) to the present.

This section may be taken for honors credit. See the Honors Counselor.

0124 LEC 10:30 hrs TBA Sennet, R Internet  
www.lamission.edu/online

### **L** *LAW* Business & Law

#### **001 BUSINESS LAW I** (UC:CSU) - 3.00 UNITS

Prerequisite: None

Same as Business 5.

Introductory course in civil law open to all students.

0191 IND 10:30 hrs TBA Walker, R Internet  
www.lamission.edu/law  
0240 IND 8:50 hrs TBA Staff Internet  
www.lamission.edu/law

#### **010 INTRO TO LEGAL ASSISTANT I** 3.00 UNITS

Prerequisite: None

Formalizes the career of the legal assistant, and introduces legal terminology bibliography, including research problems.

0165 IND 10:30 hrs TBA Jackman, J Internet  
www.lamission.edu/law

#### **012 TORT LAW & CLAIMS INVESTIGATION**

3.00 UNITS

Prerequisite: None

Principles of California tort and insurance law, and the investigation techniques necessary in tort and insurance claims.

0169 IND 10:30 hrs TBA Telanoff, A Internet  
www.lamission.edu/law

Starts 7/14/2008, Ends 8/15/2008.

SESSION II

## ONLINE CLASSES - Session II

### 016 CIVIL & CRIMINAL EVIDENCE - 3.00 UNITS

Prerequisite: None

Study of the rules of civil and criminal evidence, the admissibility of such evidence in court, deposition comprehension and use in court, and interrogatory summarizing and use in court.

0174 IND 10:30 hrs TBA Rose, E Internet  
www.lamission.edu/law

### 017 LEGAL WRITING - 3.00 UNITS

Prerequisite: None

This course consists of advanced legal drafting and writing, including research and special projects.

0199 IND 10:30 hrs TBA Jordan, D Internet  
www.lamission.edu/law

### 034 LEGAL RESEARCH LABORATORY - 3.00 UNITS

Prerequisite: None

This course is the study of Legal Research. The student learns how to do legal research in a Law Library and Online, along with how to report the results of legal research.

0161 IND 10:30 hrs TBA Jordan, D Internet  
www.lamission.edu/law

## PHILOSOPHY

Social Sciences

Faculty Advisor: Mark Pursley - 818.364.7677

### 006 LOGIC IN PRACTICE (UC:CSU) - 3.00 UNITS

Prerequisite: None

Introduces skills of argument identification and evaluation. Students will learn to classify arguments as inductive or deductive and acquire techniques for recognizing valid deductive and strong inductive reasoning. Stresses the application of critical thinking skills to social and political discourses.

All sections may be taken for honors credit. See the Honors counselor.

0176 LEC 10:30 hrs TBA Dyas, D Internet  
Email: david@daviddyas.com

## POLITICAL SCIENCE

Social Sciences

Faculty Advisor: Chuck Dirks - 818.364.7675

### 001 THE GOVERNMENT OF THE UNITED STATES

(UC:CSU) - 3.00 UNITS

Prerequisite: None

0140 IND 10:30 hrs TBA Chounlamounry Internet  
Email: chounlam@usc.edu

## PSYCHOLOGY

Social Sciences

### 001 GENERAL PSYCHOLOGY I

(UC:CSU) - 3.00 UNITS

Advisory: English 21 or ESL 6.

This introductory psychology course covers biological foundations of behavior, various theoretical perspectives including learning, personality, and intelligence theories as well as experimental and research methodology.

0145 LEC 10:30 hrs TBA McKenna, P Internet  
Paul2317-psych1@yahoo.com

Psychology 1 also offered through ITV. See page 31.

## SOCIOLOGY

Social Sciences

Faculty Advisor: Myriam Mekelburg - 818.833.3414

### 001 INTRO TO SOCIOLOGY (UC:CSU) - 3.00 UNITS

Prerequisite: None

Develops the sociological perspective that behavior is largely determined by human interactions and by membership in groups.

All sections may be taken for honors credit. See the Honors Counselor.

0148 IND 10:30 hrs TBA Layne, V Internet  
Email: proflayne@yahoo.com

0152 IND 10:30 hrs TBA Biondo, J Internet  
Email: JillB9191@yahoo.com

Sociology 1 also offered through ITV. See page 31.

### 002 AMERICAN SOCIAL PROBLEMS

(UC:CSU) - 3.00 UNITS

Prerequisite: None

Analysis of personal and social disorganization, crime and delinquency, race and ethnic relations, population and urban growth, and individual and societal rights.

0206 IND 10:30 hrs TBA Biondo, J Internet  
Email: JillB9191@yahoo.com

### 004 SOCIOLOGICAL ANALYSIS

(UC:CSU) - 3.00 UNITS

Prerequisite: None

This section may be taken for honors credit. See the Honors Counselor.

0207 IND 10:30 hrs TBA Little, D Internet  
Email: dominic.little@csun.edu



# General Policies

This schedule is an official publication of Los Angeles Mission College. It sets forth rules and regulations and, in case of conflict with information previously published, supersedes those publications of earlier date.

## Mission of the Los Angeles Community Colleges

The mission of the Los Angeles Community Colleges is to provide comprehensive lower-division general education, occupational education, transfer education, transitional education, counseling and guidance, community services, and continuing education programs which are appropriate to the communities served and which meet the changing needs of students for academic and occupational preparation, citizenship, and cultural understanding.

IN PURSUIT OF THIS MISSION, WE ENDEAVOR TO:

- Promote equal opportunity for participation;
- Maintain appropriate standards for academic achievement;
- Provide an educational environment which meets the needs of students with varied learning skills;
- Provide support services which contribute to instructional effectiveness and student success;
- Affirm the importance of multi-cultural, international, and intercultural collegiate experiences that foster individual and group understanding; and
- Manage effectively educational and financial resources.

## Students' Statements

Falsification of any record or signed statement, or the withholding of information, subjects the student to immediate suspension or expulsion.

## Instructional Materials

Students may be required to provide instructional and other materials required for a credit or noncredit course. Such materials shall be of continuing value to a student outside of the classroom setting and shall not be solely or exclusively available from the District.

## Withdrawal

Students wishing to drop a class or withdraw from the college during the semester must do so through the Admissions Office or use the telephone system. Failure to withdraw officially may result in an "F" grade. Students must withdraw on or before the 11th week (75%) in order to receive a W. Students in short-term classes must withdraw before 75% of the course is completed. After the 11th week or 75% completion of the course, a student is assigned a letter grade (A through F). Instructors are not obligated to exclude a student for non-attendance. IT IS THE STUDENT'S RESPONSIBILITY TO WITHDRAW OFFICIALLY.

HOW TO DROP CLASSES OR WITHDRAW FROM COLLEGE

1. Dropping classes or withdrawing from the college must be done by the drop date deadline.

2. To drop classes, use the STEP telephone system, or fill out a "Drop Card" and present it, with your registration Fee Receipt, at the Admissions Office. To drop ALL classes (withdrawal), use the STEP System or check item number one on the drop card.

3. The clerk processes the forms and gives you a receipt. Keep your receipt for your records.

4. Fees are not automatically refunded. Fee refunds must be requested from the Business Office if you drop classes or withdraw by the end of the second week.

5. In order to do a complete withdrawal by mail, your request must be sent by Certified Mail with a receipt.

6. You may also withdraw by using the telephone system on or before the 11th week or before 75% of the course is completed.

Students in PACE or other special programs must check withdrawal deadlines with the appropriate program director.

## Withdrawal from Classes

THROUGH THE 3rd WEEK: No notation ("W" or other) will appear on the student's record if the class is dropped during the first three weeks of the semester (or 30% of the class for short-term classes).

THROUGH THE 11TH WEEK: A notation of "W" (withdrawal) is recorded on the student's record for classes dropped during the 4th through the 11th week of the semester.

AFTER THE 11TH WEEK: Students who remain in class beyond the 11th week (or 75% of the class for short term classes) are given a grade by the instructor. THAT GRADE CANNOT BE A "W" (withdrawal).

## Access to Records

The California Legislature passed S.B. 182 (Stull), which codifies provisions of the Education Code and the Federal statutes implementing the Family Education Rights and Privacy Act of 1974 (Buckley Amendment). This permits students to inspect their personally identifiable records maintained by the college, and permits access to these records only upon the student's request (other than to certain specified categories). Information on these laws and college procedures in implementing them may be obtained from the Associate Dean of Admissions, who serves as the College Records Officer. Copies of pertinent State and Federal legislation are available for inspection.

Los Angeles Mission College considers the following information relating to a student to be directory information: student's name, city of residence, date of birth, major field of study, participation in officially recognized activities and sports, weight and height of members of athletic teams, dates of attendance, degrees and awards received, and the most recent previous educational agency or institution attended by the student. Students who do not wish any or all of the above categories of information to be given out should so indicate on their application at time of enrolling. Students are asked to voluntarily provide their student identification number for this purpose.

### Family Educational Rights & Privacy

Act (FERPA) Notification The Family Educational Rights and Privacy Act (FERPA) affords students the following rights with respect to their educational records:

1. The right to inspect and review the student's education records which includes discipline records, within 45 days from the date the College receives a request for access.

- Students may submit to the College Admissions Office written requests that identify the specific record(s) they wish to inspect. Within 45 days, the College Admissions Office will make arrangements for access and will notify the student of the time and place where the records may be inspected.

- Education records are those records that are directly related to students and are maintained by the College. Students may not inspect education records pertaining to parents' financial records and certain confidential letters or recommendations.

2. The right to request an amendment of the student's educational records which the student believes to be inaccurate, misleading or otherwise in violation of the student's privacy rights.

- With the exception of grade grievances which are handled through Administrative Regulation E-55, students may ask the College President, or his/her designee to amend a record that they believe is inaccurate, misleading, or in violation of their privacy rights. A student seeking to amend an educational record should write to the College President and clearly identify the part of the record he/she wants changed and specify why it is inaccurate, misleading, or in violation of his/her privacy rights.

- If the College President, or his designee, decides not to amend the record as requested by the student, the College, in accordance with section 99.21 of the Code of Federal Regulations and section 76232 of the Education Code, will notify the student of the decision and of his/her right to a hearing.

3. The right to consent to disclosures of personally identifiable information contained in the student's educational records, except to the extent that FERPA and California law authorize disclosures without consent.

- If a student authorizes the release of his/her education record to a third party, he/she shall provide a dated written consent to the College Admissions Office authorizing said release with a specific list of the information to be released.

- Federal and California law authorize certain disclosures of personally identifiable information without a student's written consent. One such exception is the disclosure of personally identifiable information to school officials with legitimate educational interests. School officials with legitimate educational interests are employees or agents of the Los Angeles Community College District who need to review educational records in order to fulfill their professional responsibilities.

4. The right to restrict disclosure of personally identifiable information that the College has designated as directory information which may be released without the written consent of the student.

- Directory information may be disclosed without a student's consent unless the student has notified the college that he/she does not want all or portions of the directory information released. To do so, the student must submit the appropriate

District form to the College Admissions Office requesting that some or all of the categories of directory information not be released without his/her consent. This form must be submitted in accordance with College policy.

- Pursuant to Board Rule 5201.10, the Los Angeles Community College District has designated the following student information as directory information:

(a) the student's name, city of residence, participation in officially recognized activities and sports, weight and height of members of athletic teams, dates of attendance, degrees and awards received, and the most previous educational agency or institution attended by the student;

(b) student employee records may be released in order to comply with collective bargaining agreements;

(c) the names, addresses and telephone numbers of students or former students may be released to the foundation for each college for college-related activities at the discretion of the College President, unless the student or former student has informed the College that such information should not be released. The release of this information is conditioned upon the foundation's agreement that such information will be released in accordance with District policy and that information will not be released to third parties;

(d) at the discretion of the College President, the names, addresses and telephone numbers of students from the College may be released to heads of private and/or public institutions of higher education, or their designees, for the purpose of providing information to student regarding transfer opportunities to those institutions, unless the student has indicated that such information should not be released. The release of this information will be conditioned upon the institution's agreement that student privacy rights under federal and state law will be protected and that information will not be released to third parties.

5. The right to file a complaint with the U.S. Department of Education concerning alleged failures by the College to comply with the requirements of FERPA. The name and address of the office that administers FERPA is:

Family Policy Compliance Office  
U.S. Department of Education  
400 Maryland Avenue S.W.  
Washington, DC 20202-4605

### Student Right-to-Know Disclosure

In compliance with the Student Right-to-Know and Campus Security Act of 1990 (Public Law 101-542), it is the policy of the Los Angeles Community College District and Los Angeles Mission College to make available its completion and transfer rates to all current and prospective students. Beginning in Fall, 1996, a cohort of all certificates, degree, and transfer-seeking first-time, full-time students were tracked over a three-year period. Their completion and transfer rates are listed below. These rates do not represent the success rates of the entire student population at all California Community Colleges, nor do they account for student outcomes occurring after this three-year tracking period.

Based upon the cohort defined above, 28.2 percent attained a certificate, degree, or became "transfer-prepared" during a three-year period from Fall 1997 to Spring 2000. Students who

## General Policies

are transfer-prepared have completed 56 transferable units with a GPA of 2.0 or better.

Based upon the cohort defined above, 29.8 percent transferred to another post secondary institution (CSU, UC, or another California Community College) prior to attaining a degree, certificate, or becoming transfer-prepared during a five semester period from Spring 1998 to Spring 2000.

Further information about Student Right-To-Know Rates and how they should be interpreted can be found at the California Community Colleges Chancellor's Office Student Right-To-Know Disclosure Website located at <http://srtk.cccco.edu/index.asp>

### Student Grievance Procedure

The purpose of the Student Grievance Procedure is to provide a prompt and equitable means for resolving student grievances. The grievance procedure may be initiated by a student or group of students who reasonably believe he/she/they have been subject to unjust action or denied rights that adversely affect his/her/their status, rights, or privileges as a student. It is the responsibility of the student(s) to submit proof of alleged unfair or improper action.

Grievances pertaining to grades are subject to California Education Code Section 76224(a) which states:

“When grades are given for any course of instruction taught in a community college district, the grade given to each student shall be the grade determined by the instructor of the course and the determination of the student’s grade by the instructor, in the absence of mistake, fraud, bad faith, or incompetence, shall be final.”

This grievance procedure does not apply to the challenge process for prerequisites, corequisites, advisories, and limitations on enrollment; alleged violations of sexual harassment; actions dealing with student discipline; alleged discrimination on the basis of ethnic group identification, religion, age, sex, color, sexual orientation, physical or mental disability; or an appeal for residency decision; or to eligibility, disqualification, or reinstatement of Financial Aid. Informal resolution is encouraged.

A written Statement of Grievance must be submitted to the Compliance Officer within thirty (30) instructional days of the incident or after the student(s) learns of the basis for the grievance.

### Recording Devices in the Classroom

Section 78907 of the California Education Code prohibits the use of any electronic listening or recording device without prior consent of the instructor. Any student violating this section is subject to disciplinary action. Any non-student who willfully violates this section is guilty of a misdemeanor.

### Standards of Student Conduct & Disciplinary Action

The Standards of Student Conduct and Disciplinary Action for violation of rules were established by the Board of Trustees of the Los Angeles Community College District on September 2, 1969. A student enrolling in one of the Los Angeles Community Colleges may rightfully expect that the

faculty and administrators will maintain an environment in which there is freedom to learn. This requires that there be appropriate conditions and opportunities in the classroom and on the campus. As members of the college community, students should be encouraged to develop the capacity for critical judgment, to engage in a sustained and independent search for truth, and to exercise their rights to free inquiry and speech in a responsible, non-violent manner. Students shall respect and obey civil and criminal law and they shall be subject to legal penalties for violation of laws of the city, county, state, and nation. Student conduct in all of the Los Angeles Community Colleges must conform to District and college rules and regulations.

Violations of such rules are subject to the following types of disciplinary actions, which are to be administered by appropriate college authorities against students who stand in violation. Each of the Los Angeles Community Colleges shall establish due process of law for administration of the penalties enumerated here. Penalties are listed in degree of severity but not as chronological administration. College authorities will determine which type of penalty is appropriate.

1. **WARNING** – Notice to the student that continuation or repetition of specified conduct may be cause for other disciplinary action.
2. **REPRIMAND** – Written reprimand for violation of specified rules. A reprimand serves to place on record that a student’s conduct in a specific instance does not meet the standards expected at the college. A person receiving a reprimand is notified that this is a warning that continued conduct of the type described in the reprimand may result in formal action against the student.
3. **DISCIPLINARY PROBATION** – Exclusion from participation in privileges or extra-curricular college activities set forth in the notice of disciplinary probation for a specified period of time. The imposition of disciplinary probation involves notification in writing of the reason for disciplinary probation to the student(s) or president of the student organization involved.
4. **RESTITUTION** – Reimbursement for damage or for misappropriation of property. Reimbursement may take the form of appropriate service to repair or otherwise compensate for damage.
5. **SUMMARY SUSPENSION** – A Summary Suspension is for purposes of investigation. It is a means of relieving the tension of the student body or individual class due to a serious infraction of student behavior standards, removing a threat to the well-being of the students, or removing for the good order of the college a student or students whose presence would prevent the continued normal conduct of the academic community. Summary Suspension is limited to that period of time necessary to insure that the purposes of the Summary Suspension are accomplished, and in any case, no more than a maximum of 10 school days. Summary Suspension is a type of suspension other than that ordinarily invoked by the instructor in the classroom. The College President, appropriate administrator, or other staff member designated by the President may summarily suspend a student when he deems it necessary for the safety and welfare of the college.
6. **DISCIPLINARY SUSPENSION** – Disciplinary Suspension follows a hearing based on due process of law. It shall be invoked by the College President, appropriate administrator,

## General Policies

or other staff member designated by the President, upon students for misconduct when other corrective measures have failed or when the seriousness of the situation warrants such action.

7. **EXPULSION** – An expulsion is a long-term or permanent denial of all campus privileges including class attendance. The President of the college and/or the Board of Trustees may expel a student who has been convicted of a crime arising out of a campus disturbance or, after a hearing by a campus body, has been found to have willfully disrupted the orderly operation of the campus. The President shall submit periodic reports on all expulsion cases to the Superintendent and the Board of Trustees.

Violations of the Standards of Student Conduct are as follows:

9803.10 **Willful Disobedience:** Willful disobedience to directions of college officials acting in the performance of their duties.

9803.11 **Violation of College Rules and Regulations:** Violation of college rules and regulations, including those concerning student organizations, the use of college facilities, or the time, place, and manner of public expression or distribution of materials.

9803.12 **Dishonesty:** Dishonesty, such as cheating, or knowingly furnishing false information to colleges.

9803.13 **Unauthorized Entry:** Unauthorized entry to or use of the college facilities.

9803.14 **College Documents:** Forgery, alteration, or misuse of college documents, records, or identification.

9803.15 **Disruption of Classes or College Activities:** Obstruction or disruption of classes, administration, disciplinary procedures, or authorized college activities.

9803.16 **Theft of or Damage to Property:** Theft of or damage to property belonging to the college, a member of the college community or a campus visitor.

9803.17 **Interference with Peace of College:** The malicious or willful disturbance of the peace or quiet of any of the Los Angeles Community Colleges by loud or unusual noise, or any threat, challenge to fight, fight, or violation of any rules of conduct as set forth in this Article.

9803.18 **Assault or Battery:** Assault or battery, abuse, or any threat of force or violence directed toward any member of the college community or campus visitor engaged in authorized activities.

9803.19 **Alcohol and Drugs:** Any possession of controlled substances which would constitute a violation of Health and Safety Code section 11350 or Business and Professions Code section 4230; any use of controlled substances the possession of which are prohibited by same, or any possession or use of alcoholic beverages while on any property owned or used by the District or colleges of the District. "Controlled substance," as used in this section includes, but is not limited to, the following drugs and narcotics:

- (a) opiates, opium, and opium derivatives, (b) mescaline,
- (c) hallucinogenic substances, (d) peyote, (e) marijuana,
- (f) stimulants and depressants, (g) cocaine.

9803.20 **Lethal Weapons:** Possession, while on a college campus or at a college-sponsored function, of any object that might be used as a lethal weapon is forbidden by all persons except sworn peace officers, police officers, and other government employees charged with policing responsibilities.

9803.21 **Discriminatory Behavior:** Behavior while on a college campus or at a college-sponsored function, inconsistent with the District's non-discrimination policy, which requires that all programs and activities of the Los Angeles Community College District be operated in a manner which is free of discrimination on the basis of race, color, natural origin, ancestry, religion, creed, sex, pregnancy, marital status, sexual orientation, age, handicap or veteran status.

9803.22 **Unlawful Assembly:** Any assemblage of two or more persons to (1) do an unlawful act, or (2) do a lawful act in a violent, boisterous or tumultuous manner.

9803.23 **Conspiring to Perform Illegal Acts:** Any agreement between two or more persons to perform an illegal act.

9803.24 **Threatening Behavior:** A direct or implied expression of intent to inflict physical or mental/emotional harm and/or actions (such as stalking) which a reasonable person would perceive as a threat to personal safety or property. Threats may include verbal statement, written statements, telephone threats or physical threats.

9803.25 **Disorderly Conduct:** Conduct that may be considered disorderly includes lewd or indecent attire, behavior that disrupts classes or college activities, breach of the peace of the college, aiding or inciting other persons to breach the peace of college premises or functions.

9803.26 **Theft or Abuse of Computer Resources:** Theft or Abuse of Computer Resources including but not limited to the following:

- a. Unauthorized entry into a file to use, read, or change the contents, or for any other purpose.
- b. Unauthorized transfer of a file.
- c. Unauthorized use of another individual's identification or password.
- d. Use of computing facilities to interfere with the work of a student, faculty member or college official, or to alter college or district records.
- e. Use of unlicensed software
- f. Unauthorized copying of software
- g. Use of computing facilities to access, send or engage in messages which are obscene, threatening, defamatory, present a clear and present danger, violate a lawful regulation and /or substantially disrupt the orderly operation of a college campus.
- h. Use of computing facilities to interfere with the regular operation of the college or District computing system.

9804 **Interference with Classes:** Every person who, by physical force, willfully obstructs, or attempts to obstruct, any student or teacher seeking to attend or instruct classes at any of the campuses or facilities owned, controlled or administered by the Board of Trustees of the Los Angeles Community College District, is punishable by a fine not exceeding five

# General Policies

hundred dollars (\$500) or imprisonment in a county jail not exceeding one year, or by both such fine and imprisonment.

9805 Interference with Performance of Duties of Employees: Action to cause, or attempt to cause, any employee of the District to do, or refrain from doing, any act in the performance of his or her duties by means of a threat to inflict any injury upon any person or property.

9805.10 Assault or Abuse of an Instructor: Assault or abuse of any instructor employed by the District in the presence or hearing of a community college student, or in the presence of other community college personnel or students, and at a place which is on District premises or public sidewalks, streets, or other public ways adjacent to school premises, or at some other place where the instructor is required to be in connection with assigned college activities.

9806 Unsafe Conduct: Conduct which poses a threat of harm to the individual and/or to others. This includes, but is not limited to, the following types of conduct: Unsafe conduct in connection with a Health Services Program (e.g., Nursing, Dental Hygiene, etc.); failure to follow safety direction of District and/or college staff; willful disregard of safety rules as adopted by the District and/or college; negligent behavior which creates an unsafe environment.

## Non-Discrimination Policy

All programs and activities of the Los Angeles Community College District shall be operated in a manner which is free of discrimination on the basis of ethnic groups identification, race, color, national origin, ancestry, religion, creed, sex, pregnancy, marital status, medical condition (cancer related), sexual orientation, age, physical or mental disability (including AIDS) or veteran status (Reference: Board Rule 1202).

## Politica No Discriminatoria

Todos los programas y actividades de los colegios de la comunidad de Los Angeles se administrarán de una manera que no discrimine respecto a la identidad de grupos étnicos, raza, color, nacionalidad, origen, ascendencia, religión, credo, sexo, embarazo, estado civil, condición médica (relacionada con cáncer), preferencia sexual, edad, incapacidad mental o física (incluyendo SIDA) o el ser veterano.

## Compliance Procedure

In order to insure nondiscrimination policy compliance at Los Angeles Mission College, please direct inquiries to the Compliance Officer – Title IX/Gender-Equity, and Sexual Harassment 818.364.7701. Matters involving Section 504 may be directed to the Coordinator of Disabled Student's Program at 818.364.7734. In addition, inquiries may be directed to the District Office of Diversity Programs at 213.891.2315.

Politica De Acuerdo Con Los Procedimientos De Igualdad De Oportunidades Para asegurar que se cumpla una política no discriminatoria en Los Angeles Mission College, favor de dirigirse a la oficina de un mediador si se refiere al acoso sexual o a la discriminación – Compliance Officer Title IX/Gender Equity 818.364.7701. Para la Sección 504, diríjase al Coordinador del Programa de Personas Incapacitadas, al 818.364.7734. Además, puede también dirigir sus preguntas a la oficina de Diversity Programs del Distrito, teléfono 213.891.2315.

## Compliance Officer

If students feel they have grounds for a grievance, they may contact the college Compliance Officer, who will help explain college rules and regulations, and, if a problem is resolvable, suggest the best method for resolving the problem. For additional information and a copy of Administrative Regulation E-55 (Student Grievance Procedures) see the Compliance Officer located in the Campus Center, 818.364.7701.

## Sexual Assault Policy

The Los Angeles Community College District is committed to providing a safe environment for students, visitors, and staff. Any incident of sexual assault should be immediately reported to campus police at 818.364.7843. The term "sexual assault" under the California Education Code, Section 67385(d), includes threats of sexual violence.

Anyone charged with campus-related sexual assault may be subject to prosecution under appropriate California criminal statutes; students may also be subject to discipline under the Student Disciplinary Procedures. The Sexual Harassment Policy may also apply, and the Compliance Officer may be contacted at 818.364.7701. Confidentiality shall be maintained. (Reference: Board Rule 16400.11.)

## Sexual Harassment Policy

The policy of the Los Angeles Community College District is to provide an educational, employment and business environment free from unwelcome sexual advances, requests for sexual favors, and other verbal or physical conduct or communications constituting sexual harassment. Employees, students, or other persons acting on behalf of the District who engage in sexual harassment as defined in the policy or by state or federal law shall be subject to discipline, up to and including discharge, expulsion or termination of contract. The specific rules and procedures for reporting charges of sexual harassment and for pursuing available remedies are incorporated in the Board Rules in Chapter 15.

The Los Angeles Community College District has a policy which provides informal and formal procedures for resolving complaints.

Copies of the policy and procedures may be obtained from the Compliance Officer located in the Administration Building, Room 123, 818/364-7701, or by calling the Senior Director of Educational and Student Support Services at 213/891-2279, or the Office of Diversity Programs at 213/891-2315. Any member of the College Community, which includes students, faculty, and staff, who believes, perceives, or actually experienced conduct that may constitute sexual harassment, has the right to seek the help of the College. Every employee has the responsibility to report such conduct when it is directed towards students to the Sexual Harassment Compliance Officer. Potential complainants are advised that administrative and civil law remedies, including but not limited to injunctions, restraining orders or other orders may be made available.

## Diversity Program

The policy of the Los Angeles Community College District is to implement equal opportunity to all qualified employees and applicants for employment without regard to race, color, national origin, ancestry, religion, creed, sex, pregnancy, age,

## General Policies

disability, marital status, medical condition (cancer related), sexual orientation, or veteran status. Positive action will be taken to ensure that this policy is followed in all personnel practices, including recruitment, hiring, placement, upgrading, transfer, demotion, treatment during employment, rate of pay or other forms of compensation, selection for training, layoff, or termination. Inquiries regarding equal opportunity practices at Los Angeles Mission College should be directed to the college Compliance Officer located in the Campus Center, 818.364.7701.

### Drug-Free Environment

Los Angeles Mission College adheres to, supports, and is in full compliance with requirements that maintain our college as a drug-free institution of higher education.

On September 5, 1990, the Board of Trustees adopted the following standards of conduct:

- Students and employees are prohibited from unlawfully possessing, using or distributing illicit drugs and alcohol on District premises, in District vehicles, or as part of any activity of the Los Angeles Community College District.

On April 20, 1989, the Los Angeles Community College District Board of Trustees adopted Rule 9803.19, which prohibits:

- Alcohol and Drugs. Any possession of controlled substances which would constitute a violation of Health and Safety Code section 11350 or Business and Professions Code section 4230, any use of controlled substances, the possession of which are prohibited by the same, or any possession or use of alcoholic beverages while on any property owned or used by the District or colleges of the District. "Controlled substances," as used in this section, include, but are not limited to, the following drugs and narcotics:

- a. opiates, opium and opium derivatives
- b. mescaline
- c. hallucinogenic substances
- d. peyote
- e. marijuana stimulants
- f. depressants and
- g. cocaine.

The Board's policy on the Drug Free Workplace, adopted March 22, 1989, restates these prohibitions.

- Legal Sanctions. Federal laws regarding alcohol and illicit drugs allow for fines and/or imprisonment. Other legal problems include the loss of driver's license and limitations of career choices.
- Health Risks. Health risks associated with the abuse of controlled substances include malnutrition, damage to various organs, hangovers, blackouts, general fatigue, impaired learning, dependency, disability, and death. Both drugs and alcohol may be damaging to the development of an unborn fetus.
- Other Risks. Personal problems include diminished self-esteem, depression, alienation from reality, and suicide. Social problems include loss of friends, academic standing, co- and extra-curricular opportunities, alienation from and

abuse of family members, and chronic conflict with authority. Economic problems include loss of job, financial aid eligibility, homes, savings, and other assets.

Additionally, on June 28, 2000, the Board of Trustees adopted Rules 9803.24 Threatening Behavior, 9803.25 Disorderly Conduct, 9803.26 Theft or Abuse of Computer, and 9806 Unsafe Conduct. Each are fully described in Standards of Student Conduct.

### Campus Security

The campus Sheriff's office personnel are responsible for the safety and well being of staff, faculty and students, and of the security of college property and facilities, 818/364-7843.

### Campus Crime Report

Los Angeles Mission College's general statistics and crime can be viewed at the following URLs:

- General Information

<http://nces.ed.gov/ipeds/cool/InstDetail.asp?UNTID=117867>

- Crime

<http://ope.ed.gov/SECURITY/instDetail.asp?UNTID=117867> then click on Criminal Offenses, Hate Offenses, or Arrests.

### Counseling, Treatment & Rehabilitation

The following resources are available for the treatment of alcohol and drug dependence and abuse:

- Los Angeles Community College District Employee Assistance Program

818.907.7701 or 800.521.9944

- National Council on Alcoholism and Drug Dependence

213.384.0403 or 818.997.0414

- Los Angeles County Drug Abuse Program

213.624.DRUG

- Alcoholics Anonymous

213.387.8316 or 818.988.3001

- Cocaine Anonymous

213.839.1141 or 818.988.1777

- Narcotics Anonymous

213.283.1745 or 818.997.3822

- Families Anonymous

800.736.9805

### Smoking Policy

In accordance with Board Rule 9804, smoking is permitted in designated areas only. A student who violates the rules is subject to the student disciplinary regulations.

## Student Services

In this section you will find information and contact telephone numbers for the wide variety of services available to students.

### Los Angeles Mission College offers these special services to students:

#### Campus Child Development Center

818.364.7863

The Child Development Center provides a developmentally based curriculum for pre-school children aged 3 years through 5 years.\*

#### HOURS OF OPERATION:

Monday through Thursday: 7:30 a.m. to 6 pm  
Friday: 7:30 a.m. to 2 pm

\*Qualified students may receive childcare services with low to no fees.

#### College Ombudsperson

818.364.7690

The college ombudsperson is a faculty member selected by the president to assist students in resolving issues or problems they may have with faculty or the college.

#### Disabled Student Programs and Services

818.364.7732

For students with disabilities the DSP&S office provides special assistance in areas like: registering for courses, specialized tutoring, note-taking, mobility assistance, special instruction, testing assistance, special equipment, special materials, instructor liaisons, community referrals, and job placement.

#### Student Activities

818.364.7820

Student government, student orientations, honors, commencement, student clubs, sports tournaments, dances, special events, video games, and more which enhance the student experience at Los Angeles Mission College.

#### Bookstore

818.364.7798

The Bookstore sells textbooks you need for your courses and supplies like paper, pens, blue books, scantrons, etc. Additionally the bookstore sells backpacks, T-shirts, sweatshirts, hats and more.

#### Bookstore Hours\*

Monday - Thursday 7:45 am - 7:15 pm  
Friday 7:45 am - 1 pm

#### Business Office

818.364.7783

Payment of enrollment fees, refund requests, and other financial transactions are handled in the Business Office.

#### Business Office Hours\*

Monday, Thursday 9 am - 7 pm  
Tuesday, Wednesday, Friday 9 am - 4 pm

\* Hours subject to change

### Extended Opportunity Programs & Services/CARE

818.364.7645

EOP&S provides qualifying students with

academic counseling, peer advisement, peer tutoring, free workshops, free university/cultural tours, transfer assistance, and assistance with books. Single parents on CalWORKs may receive additional assistance through the CARE program.

### Offices which provide services to students include:

#### Admissions & Records

818.833.3322

The Admissions & Records Office keeps all student records. This office is where you apply for admission to the college, register for courses, add or drop courses, request transcripts, and request verification of enrollment.

#### Admission Office Hours\*

Monday - Thursday 8 am - 7 pm  
Friday 8 am - 1 pm

#### Family Child Care Homes Network

818.364.7881

The Family Child Care Homes Network consists of at least 25 licensed family child-care providers, who are located in the community around Los Angeles Mission College. Qualified students may receive child-care services for infants and toddlers, pre-schoolers, school age children, with low or no fees.

#### Library

818.364.7600 Ext. 7106

Online data bases, books, reference materials, periodicals, and information from the Internet – the tools you need to succeed are all available in the Library. One of the reference librarians will help you find information you need. You can study in our quiet individual study areas and small groups can use our study rooms.

#### Library Hours

Check website for hours: [www.lamission.edu/library](http://www.lamission.edu/library)

#### Counseling

818.364.7655 or 818.364.7656

Students are strongly urged to make an appointment with a counselor to develop an Educational Plan. The Educational Plan is tailored to your needs and goals, and enables you to get the most from your studies.

Career planning is an important part of planning for your future. The Counseling Office makes the Eureka computer program available to students. Eureka helps students assess their skills, career interests, and educational decisions, and explore career options. For students interested in completing an Associate degree and transferring to a four-year college, the Transfer Center has the latest information on majors,

## Student Services

transfer requirements, and application procedures at many public and private four-year colleges and universities.

All new students must take the college's assessment of English and Mathematics knowledge. College courses require reading and writing skills at the college level. Some courses require specific math skills. The assessment process is designed to inform students of areas in which they need improvement to be best prepared for success in college. The College Orientation Program is designed for new students to learn about the college, educational programs, services, degree requirements, and the secrets of being a successful college student.

International students have their own counselor at LAMC. The international students counselor assists the students to plan a program of studies that meets the requirements of the student and the federal requirements of the F-1 Visa. Veterans must make an appointment with the Veterans Affairs counselor to apply for VA benefits.

### Learning Center

818.364.7756

Walk-in tutoring in English and math are offered most days and evenings; schedules are available at the learning center. One-on-one and small group tutoring is also available by appointment only on a limited basis in many subject areas. In addition, students can enroll in credit courses to build basic skills in reading, spelling, writing, vocabulary, math and study skills.

### Honors/Transfer Alliance Program

818.364.7683

The Honors Program was created to promote academic excellence, to stimulate discussion of academic issues among students and faculty, to increase awareness of current social issues, to encourage community service, to celebrate cultural diversity, and to prepare students for successful university transfer.

### Completing an Honors Contract

Students receive Honors credit by competing an Honors Contract in any UC transferable course. In consultation with the instructor, the student develops a proposal for an Honors research project. When the final project is completed, the student must submit one copy to the instructor and a second

copy to the Honors Coordinator. If the advisory committee approves the project, the student will receive an Honors notation on her transcript indicating that the course was completed for Honors credit.

### Honors Certification

Students receive Honors Certification by completing a total of six Honors Contracts. Certified students receive access to a variety of scholarship opportunities and priority consideration for admission to UCLA, UCI, UCR, UCSC, Occidental College, Chapman University, Claremont College, Pomona Pitzer, La Sierra University, Whitman College, Pacific University, CSU Fullerton, CSU Stanislaus, and CSU San Diego.

### Applying to the Honors Program

Applications for the Honors Program are available at the Honors/TAP office, which is located on the lower level of the Campus Center. Current LAMC students must be eligible for English 101 and have completed 12 transferable units with a GPA of 3.25 or higher. Entering students must have a high school GPA of 3.5 or higher or an SAT score above 1,000.

Honors Coordinator: Mark Pursley, 818.364.7677

Honors Counselor: Joanne Kalter-Flink, 818.364.7652

### Health Center

818.362.6182

The Student Health Center at LAMC offers a variety of medical and health education services available for all registered Los Angeles Community College District students. The Student Health Center is located in front of the Child Development Center and next to the Campus Police Station. It is open varied hours which are posted on the trailer door. Students may call for an appointment or walk-in during scheduled clinic hours. Appointments can be made by calling 818.362.6182 or 818.837.7881.

This center will be staffed by medical and mental health professionals. Stop by the health center and check on available health services. Services not available at the on-campus center may be accessible through our San Fernando Health center located at 1600 San Fernando Road, and can be reached at 818.365.8086.

We welcome all students to visit and utilize their Student Health Center.



# Campus Map

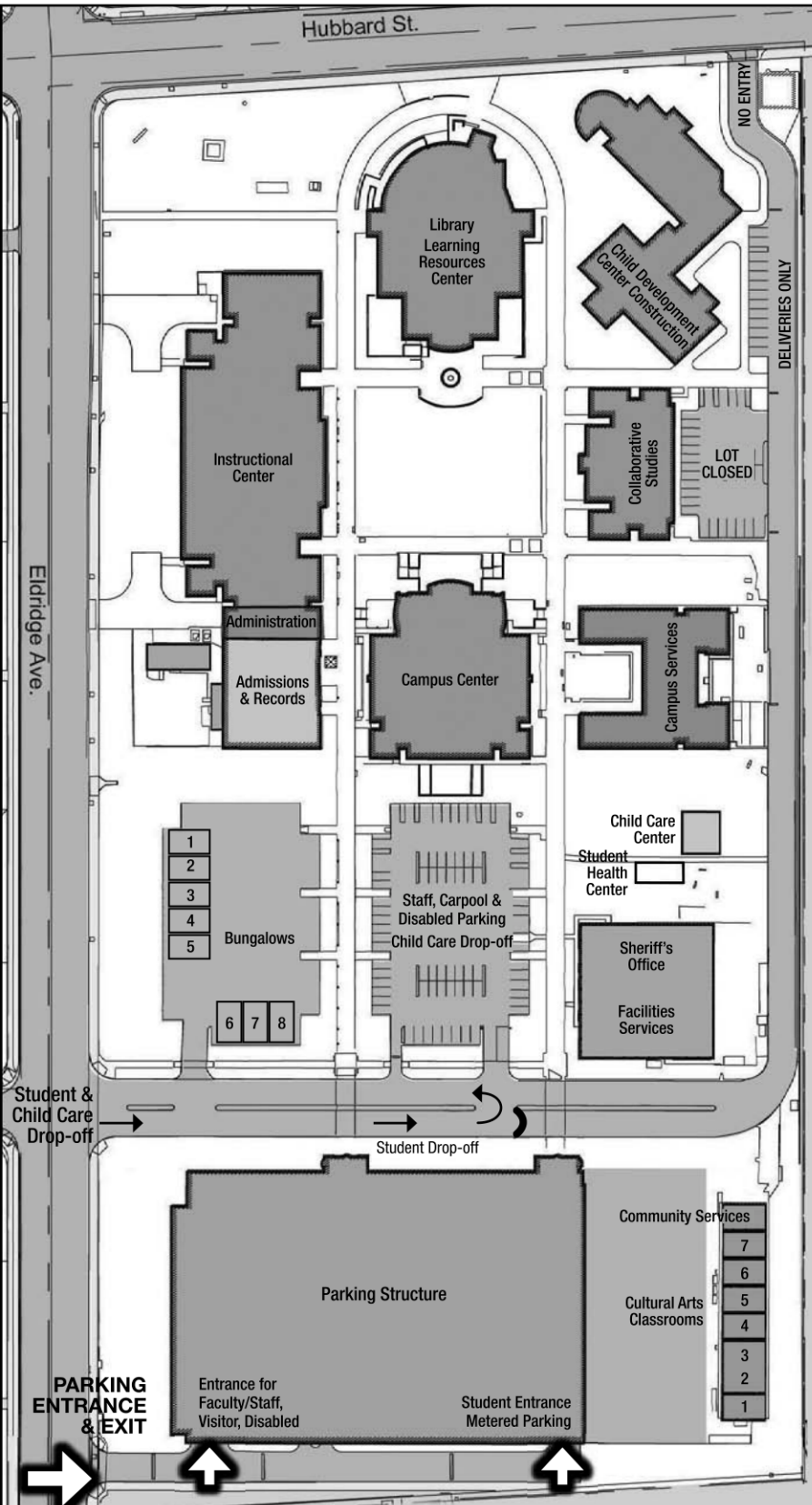

## LIBRARY/LRC

- 1st Floor (Lower level)**
  - Media Production Lab/ Multimedia Labs
- 2nd Floor (Ground level)**
  - Computer-Aided Instruction
  - Electronic Training Rooms
  - Learning Center
  - Teleconference Room
- 3rd Floor (Top level)**
  - Library

## INSTRUCTIONAL

- 1st Floor**
  - Classrooms 1001-1018
  - Child Development Lab
  - Disabled Student Services
  - Engineering Lab
  - Faculty Offices
  - Foods Lab
  - Physics/Astronomy Lab
- 2nd Floor**
  - Classrooms 2001-2003
  - Accounting Lab
  - Chemistry Lab
  - Computer Science Lab
  - Life Sciences Lab
  - Computer & Office Applications Center

## ADMINISTRATION WING

- Office of the President
- Vice President of Academic Affairs
- Academic Affairs
- Admissions & Records
- Counseling
- Financial Aid & Scholarships
- EOP&S
- Information Booth

## BUNGALOWS

- Bungalows 1-8

## COLLABORATIVE STUDIES

- 1st Floor**
  - Classrooms 101-111
  - Faculty Offices
- 2nd Floor**
  - Classrooms 201-208

## CAMPUS CENTER

- 1st Floor (Lower level)**
  - Assessment
  - ASO Office
  - Center for Student Success
  - ITV
  - Math Lab
  - PACE
  - Transfer Center
  - FCCNH Office
- 2nd Floor (Ground level)**
  - Assembly Area
  - Audio-Visual
  - Meeting Rooms 1-6
  - Staff Lounge
  - Student Community Center

## CAMPUS SERVICES

- Vice President of Administrative Services
- Vice President of Student Services
- Bookstore
- Business Office
- Central Supply
- Fiscal Services
- International Students Office
- Reprographics & Mail Room
- Student Activities
- Veterans Office

## FACILITIES SERVICES

- Sheriff's Department
- Plant Facilities

## CULTURAL ARTS

- CAC Classrooms 1-7
- Community Services

# Buildings & Classrooms

## INSTRUCTIONAL BUILDING – 1ST FLOOR

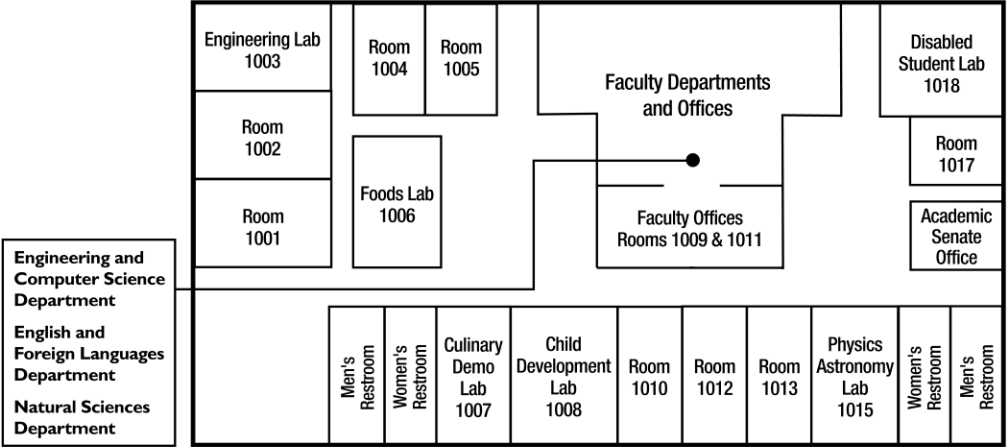

## INSTRUCTIONAL BUILDING – 2ND FLOOR

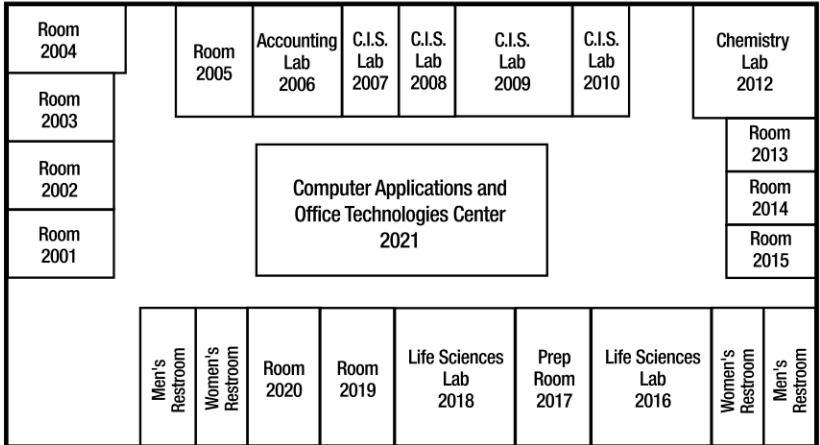

## CAMPUS CENTER BUILDING 2ND FLOOR (Ground Level)

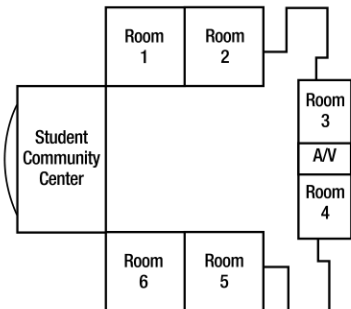

## CAMPUS CENTER BUILDING 1ST FLOOR (Lower Level)

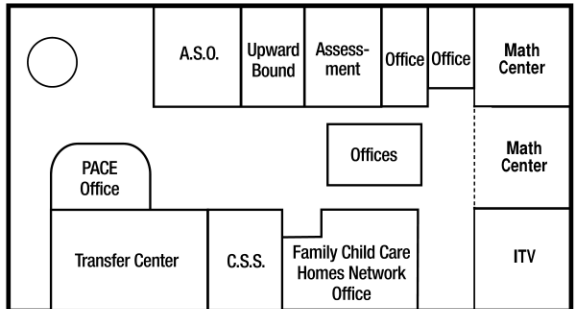

**GUADALUPE S. RAMIREZ  
COLLABORATIVE STUDIES BUILDING – 1ST FLOOR**

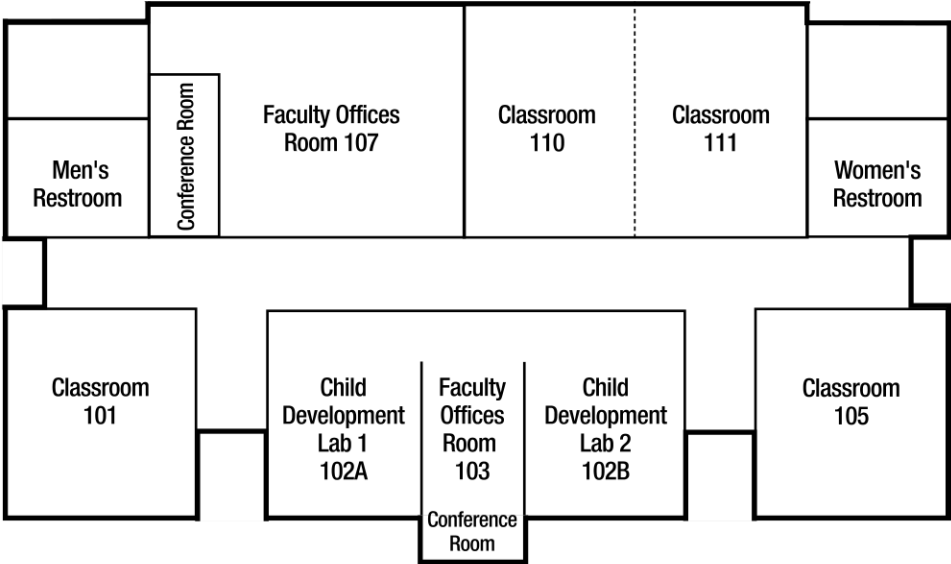

**GUADALUPE S. RAMIREZ  
COLLABORATIVE STUDIES BUILDING – 2ND FLOOR**

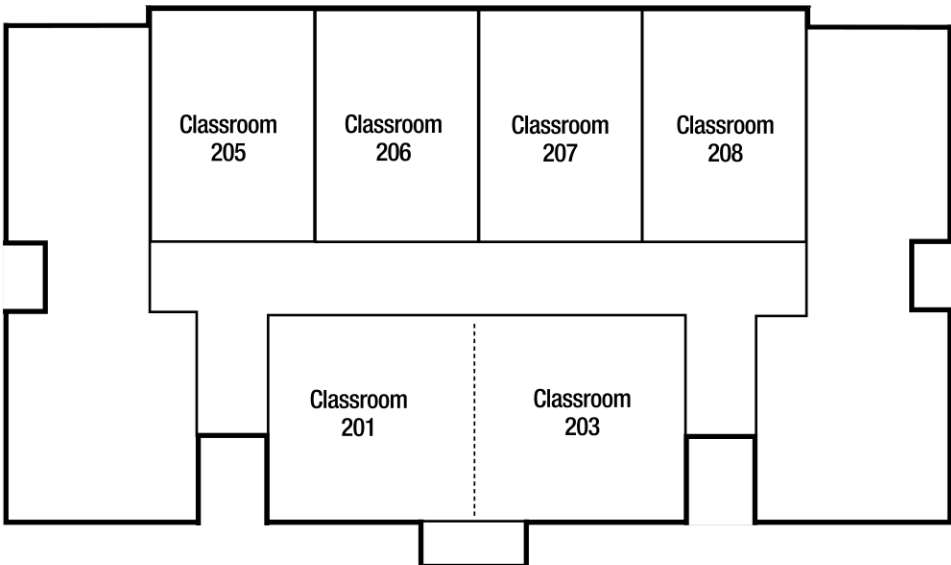

# Directions to Mission College & Outreach Locations



## Freeway Map and Legend

### A / CCRC

Child Care Resource Center  
20001 Prairie Street, Chatsworth

### B / CHAT-HS

Chatsworth High School  
10027 Lurline Avenue, Chatsworth

### C / FOOT

Physical Education Building  
12843 Foothill Boulevard, Suite B, Sylmar

### D / GRAN-HS

Granada High School  
10535 Zelzah Avenue, Granada Hills

### E / MONT-PREP

Montclair College Prep  
8071 Sepulveda Boulevard, Van Nuys

### F / MSSH-BOWL

Mission Hills Bowl  
10430 Sepulveda Boulevard, Mission Hills

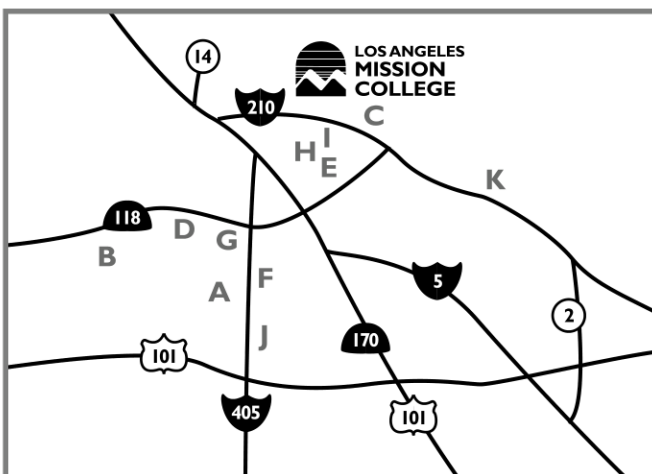

### G / One Stop Career Center

11623 Glenoaks Boulevard, Pacoima

### H / SFDO-HS

San Fernando High School  
11133 O'Melveny Avenue, San Fernando

### I / SYLM

Sylmar High School  
13050 Borden Avenue, Sylmar

### J / VANN-HS

Van Nuys High School  
6535 Cedros Avenue, Van Nuys

### K / VERD

Verdugo Hills High School  
10625 Plainview Avenue, Tujunga



# Emergency Information

## Fire

1. If you smell smoke or see fire, activate the nearest fire alarm pull box. Call the campus sheriff, extension 7845 or 7843 (outside telephone 818.833.3504). If you are unable to contact the sheriff, call 911.
2. When you hear the fire alarm, proceed in an orderly fashion to the designated building evacuation assembly area. The last person to leave the room should close the door.
3. At the assembly area, wait for further instructions from a faculty member or administrator.

## Earthquake

1. At first sign of shaking, get away from any potential falling objects. Try to get under a table or desk.
2. Do not run outside. If you are in a multistory building do not use the elevator.
3. If you are aware of any gas lines or heaters in the area, attempt to shut off the gas line or heater.
4. Wait for a faculty member or administrator to give further instructions.

## Power Outage

1. Try to stay where you are and do not attempt to restore power.
2. Notify plant facilities, extension 7801 (outside telephone 818.364.7801).
3. Wait for the power to come back on or for information/ instruction from plant facilities or an administrator to ascertain the probably length of the outage and to be advised of what to do next.

## Evacuation

1. If you hear the alarm, proceed in an orderly fashion to the nearest exit and assemble at the designated building evacuation assembly area.
2. If you are in a multistory building, do not use the elevator.
3. At the assembly area, wait for further instructions from a faculty member or administrator.

## Other Emergencies

1. In the case of other emergencies, you will be given instructions from a faculty member or administrator on what to do.
2. Please remain calm and follow instructions.

## EMERGENCY PHONE NUMBERS

	CAMPUS PHONES	OUTSIDE PHONES
Sheriffs Station	7843	818.364.7843
President	7795	818.364.7795
Academic Affairs Vice President	7635	818.364.7635
Administrative Services Vice President	7780	818.364.7780
Student Services Vice President	7766	818.364.7766
Plant Facilities	7801	818.364.7801
Los Angeles County:		
Police Department	9 - 911	911
Fire Department	9 - 911	911
Pay Telephones: For any emergency - Press *11 to reach L.A County Sheriffs Office		





# LOS ANGELES COMMUNITY COLLEGE DISTRICT

770 WEST WILSHIRE BOULEVARD  
LOS ANGELES, CALIFORNIA 90017 | 213.891.2000

## DISTRICT ADMINISTRATION

Dr. Marshall E. Drummond  
*Chancellor*

Dr. Adriana D. Barrera  
*Deputy Chancellor*

Gary Colombo  
*Vice Chancellor,  
Institutional Effectiveness*

John Clerx  
*Vice Chancellor, Instructional  
and Student Support Services*

Larry H. Eisenberg  
*Executive Director, Facilities  
Planning and Development*

Camille A. Goulet  
*General Counsel*

Jeanette Gordon  
*Chief Financial Officer/Treasurer*

## BOARD OF TRUSTEES

Sylvia Scott-Hayes  
*President*

Kelly G. Candaele  
*Vice President*

Mona Field

Warren T. Furutani

Georgia L. Mercer

Nancy Pearlman

Angela J. Reddock

Eva Jackson  
*Student Trustee*



# Los Angeles Mission College

13356 ELDRIDGE AVENUE, SYLMAR, CALIFORNIA 91342  
818.364.7600 | TDD 818.364.7861 | [www.lamission.edu](http://www.lamission.edu)

Judith Valles  
*President*

Alma Johnson-Hawkins  
*Vice President, Academic Affairs*

Dr. Karen A. Hoefel  
*Vice President, Administrative Services*

Joe S. Ramirez  
*Vice President, Student Services*

Edgardo E. Zayas  
*Dean, Academic Affairs*

Maury Pearl  
*Dean, Institutional Research, Planning  
and Information Technology*

Alfred Romulo  
*Associate Dean, Academic Affairs,  
Noncredit and Special Academic Programs*

Susan Rhi-Kleinert  
*Assistant Dean, Title V*

Non-Profit Org.  
U.S. Postage  
PAID  
Permit No. 239  
Van Nuys, CA



*New solar panels, new biology  
lab, new child development center,  
signal Mission College's continuing  
commitment to your success.*