

UTELOGY HYFLEX OVERVIEW

A Utelogy Hyflex classroom has a dual PC monitors on the lectern.

One screen is a regular HPE monitor, and the other screen is a Viewsonic Interactive monitor, to allow you to control the Utelogy system via a touch screen.

See PC desktop and find U-Control icon to launch the Hyflex system

You can maximize this screen and send this to the Viewsonic Interactive monitor, to serve as your user interface. That way, you can still use the HPE monitor, as your regular monitor.

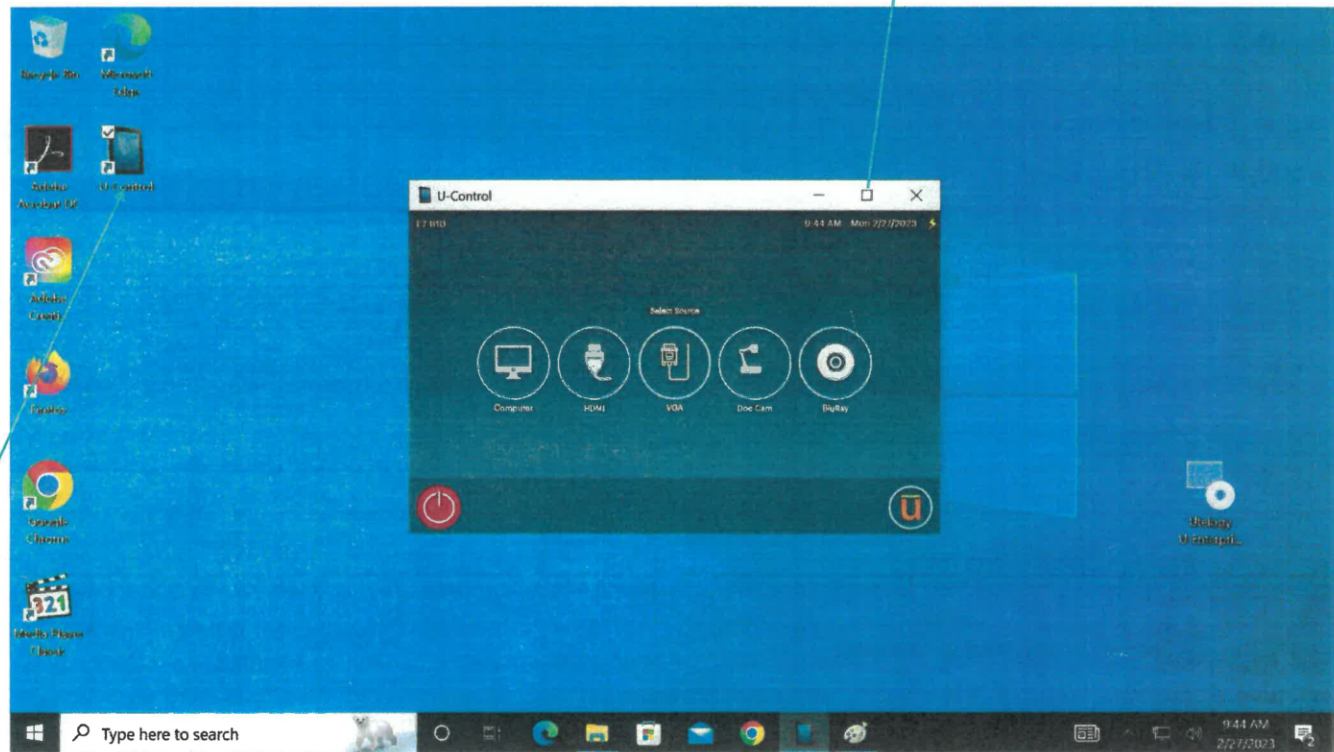

Start using the system

Locate Utology icon from your PC desktop. Click to launch.



Building & Room #

Minimize & Maximize screen

Exit

This is your selection sources

Select Source

Computer HDMI VGA Doc Cam BluRay

Camera Control Display / TV Control Volume Adjustment Volume Advance Setting Blu ray Control Screen Control

Toggle from green to red. On / Off button

E7-B10

9:45 AM Mon 2/27/2023

Type here to search

9:45 AM 2/27/2023

Select Source

Allow you to choose how you would like to display content to the projection screen or the TV

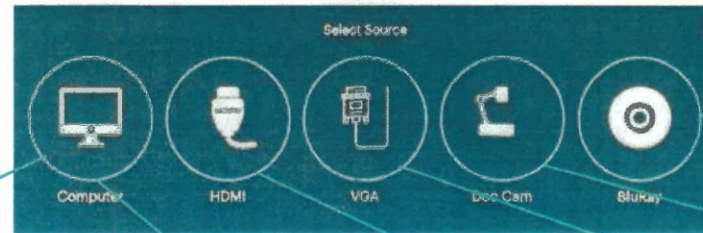

Blu ray

Will display content of the disc loaded to the Blu ray player. Further control comes up to the screen



Computer

Will display video content of the PC connected to the system to either the projection screen or the TV. The audio content will be played to the ceiling speakers.

HDMI

Will display video content of the device connected to the HDMI cable in the cable cubby (see lectern). The audio content will be played to the ceiling speakers.

VGA

Will display video content of the device connected to the VGA cable in the cable cubby (see lectern). The audio content will be played to the ceiling speakers.

DOC CAM

Will display item or document under the document camera lens. The document camera can be further manually controlled.

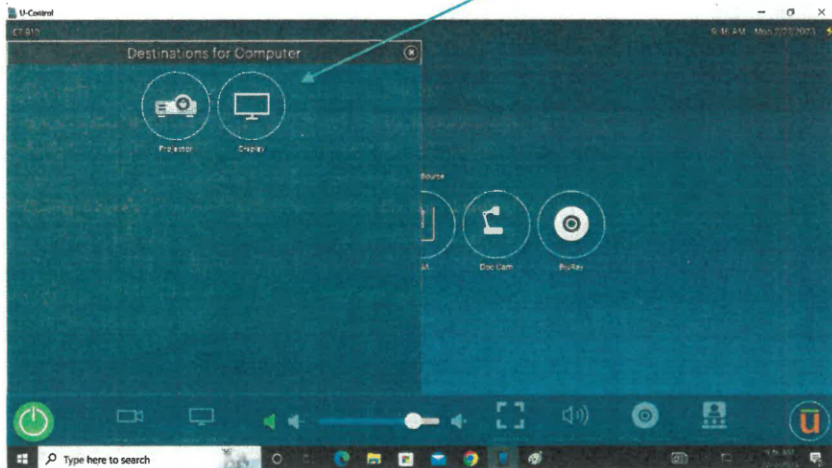

Camera Control

Allow you to control your camera. Zoom in/out, focus and auto tracking on/off

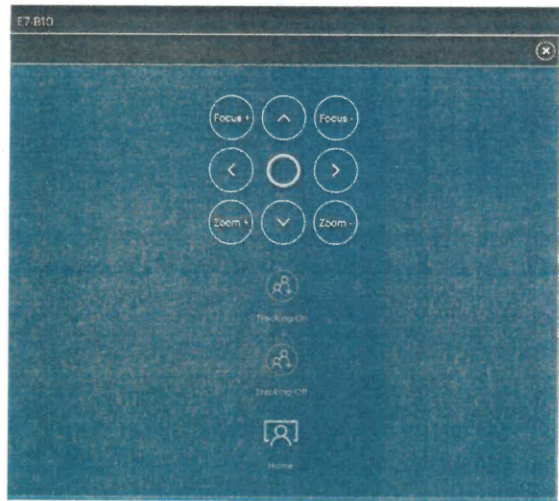

Display Control

Allow you to control the projector. On/off projector or blank out the screen.

Allow you to control the TV too. On/off TV.

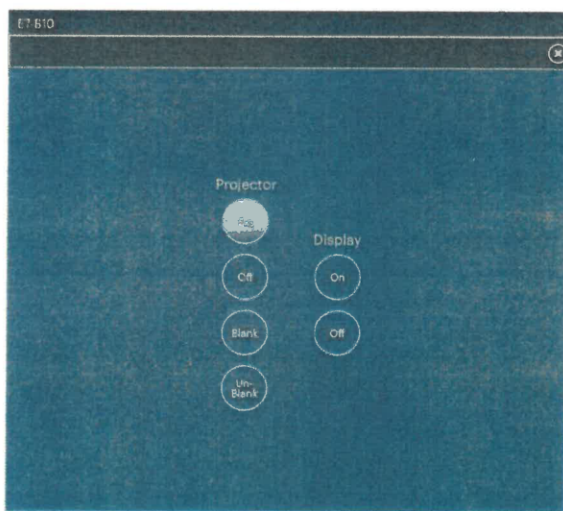

Screen Control

Allow you to control the projection screen. Button UP and DOWN, towards the direction the screen will go

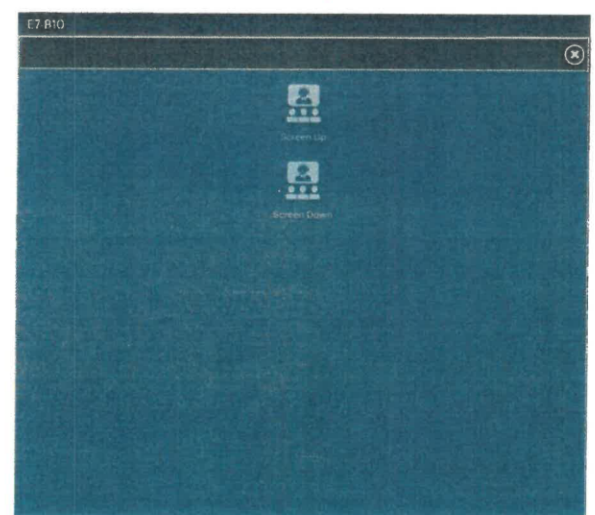

Volume Control

Allow you to control volume of the ceiling speakers and ceiling microphone



**Ceiling Speakers
Volume Control**

Allow you to adjust volume level of the speakers

Ceiling microphone
Allow you to adjust volume level of the ceiling microphone.

Shutting Down the System

Note: Please shut down the system via the toggle button to ensure all other components are shut down.



On/Off Button
Toggle between red and green button

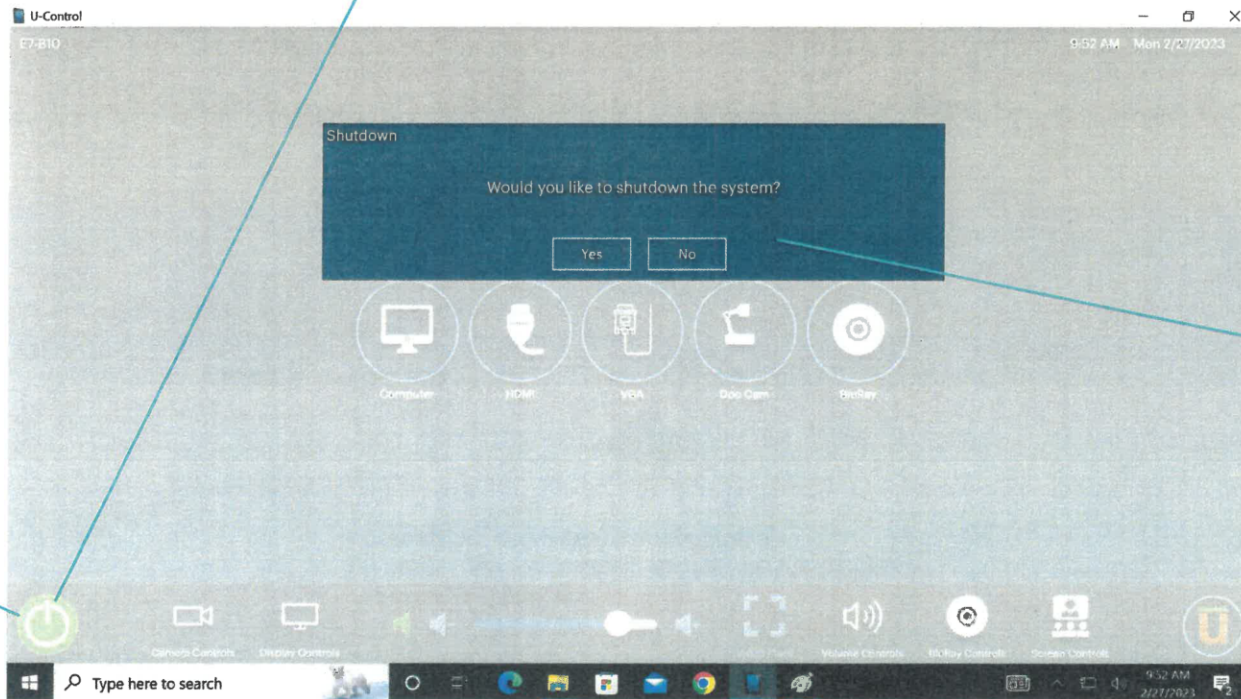

Confirm shut down